

LCS Series Subminiature Sealed Snap-acting Switches



Features/Benefits



- Compact design
- Long life and high electrical capacity
- Quick connect, solder terminals, PC terminals, wire leads
- Wide variety of actuator styles
- RoHS compatible, RoHS compliant
- IP67

Typical Applications

- Motorized equipment
- Sump pump
- Thermostatic controls
- Computers
- Air conditioners



Specifications

CONTACT RATING: 6 AMP, 250 V AC and
5 AMP, 125/250 V AC 
0.1 AMP, 125/250 V AC 

ELECTRICAL LIFE: 10,000 cycles

INSULATION RESISTANCE: 100 M ohm min.

DIELECTRIC STRENGTH: 1,000 VAC

OPERATING TEMPERATURE:

-40°C to +120°C (without wire)

-40°C to +85°C (with UL1007 wire)

-40°C to +105°C (with UL1015 wire)

-40°C to +105°C (with UL1430 wire)

-40°C to +80°C (with UL1061 wire)

-40°C to +120°C (with UL1330 wire)

OPERATING FORCE: (see ACTUATOR'S option sections).

MOUNTING: 2-56 screws, torque 2.3 in/lbs max.

NOTE: Specifications and materials listed above are for switches with standard options.
For information on specific and custom switches, consult Customer Service center.

Materials

SWITCH HOUSING: Thermoplastic polyester or high temperature thermoplastic (PTS) (UL 94V-0).

ACTUATOR BUTTON: Thermoplastic polyester.

SPRING: Copper alloy.

PIVOT: Copper alloy.

MOVABLE CONTACTS: Silver nickel

STATIONARY CONTACTS: Silver nickel on copper alloy.



TERMINALS: Copper alloy.

ACTUATOR LEVEL: Stainless steel.

Snap-acting

Build-A-Switch

To order, simply select desired option from each category and place in the appropriate box. Available options are shown and described on pages J-27 thru J-29. For additional options not shown in catalog, consult Customer Service Center.

<p>Series LCS</p>		<p>Contact Rating</p> <p>05 5 AMP, 125/250 V AC </p> <p>01 0.1 AMP, 125/250 V AC </p>		<p>Operating Force</p> <p>1 150 grams</p> <p>2 203 grams</p>		<p>Actuator</p> <p>P00 Pin plunger</p> <p>T00 11.9 mm short lever</p> <p>T05 17.4 mm short lever</p> <p>T07 19.4 mm short lever</p> <p>T13 25.5 mm lever</p> <p>T19 33.3 mm lever</p> <p>T28 40.7 mm lever</p> <p>T43 55.9 mm lever</p> <p>S26 18.6 mm simulated lever</p> <p>A05 17.2 mm lever roller</p>		<p>Terminations</p> <p>S Solder</p> <p>Q 0.110 Quick Connect</p> <p>P PC Thru Hole</p> <p>W Wire leads potted</p> <p>Z Wire leads non-potted</p>		<p>Wire Type AWG</p> <p>20 20 AWG</p> <p>22 22 AWG</p> <p>24 24 AWG</p> <p>26 26 AWG</p> <p>28 28 AWG</p> <p>30 30 AWG</p>		<p>Wire UL # (when required)</p> <p>A UL1007</p> <p>B UL1015</p> <p>C UL1430</p> <p>D UL1061</p> <p>E UL1330</p>		<p>Circuitry</p> <p>C SPDT</p> <p>W SPST N.C.</p> <p>Y SPST N.O.</p>	
<p>Wire Side (when required)</p> <p>A Wire out the bottom</p> <p>B Wire out the right side</p> <p>C Wire out the left side</p> <p>D None</p>															



Dimensions are shown: mm
Specifications and dimensions subject to change

LCS Series Subminiature Sealed Snap-acting Switches

SERIES

LCS

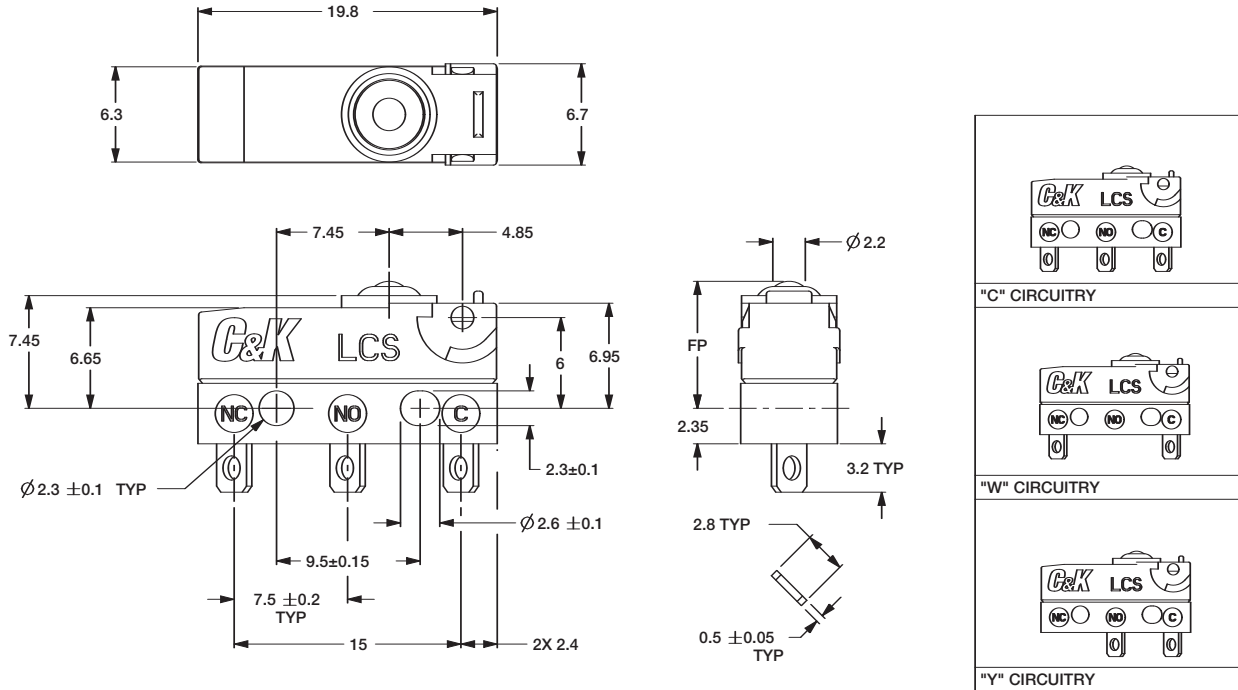

ELECTRICAL RATING

RoHS COMPLIANT *	RoHS COMPATIBLE *	OPTION CODE	ELECTRICAL RATING
YES	YES	05	5 AMP, 125/250 V AC 6 AMP, 250 V AC
YES	YES	01	0.1 AMP, 125/250 V AC

OPERATING FORCE

OPTION CODE	OPERATING FORCES (grams)
1	150 g. max.
2	203 g. max.

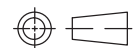

Third Angle Projection

Dimensions are shown: mm
Specifications and dimensions subject to change

LCS Series Subminiature Sealed Snap-acting Switches

ACTUATOR

P00

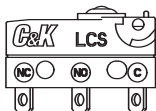

T19

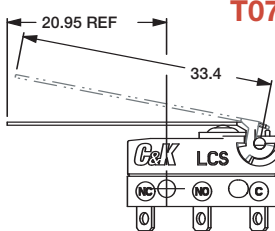

T07

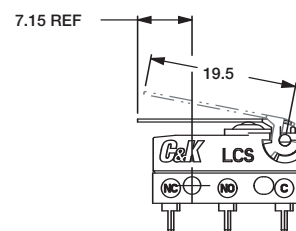

A05

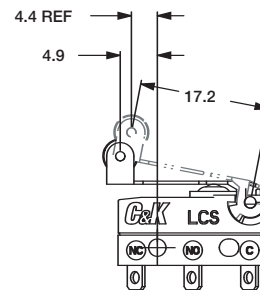

T00

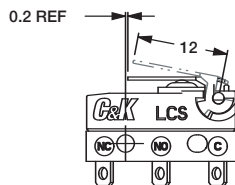

T28

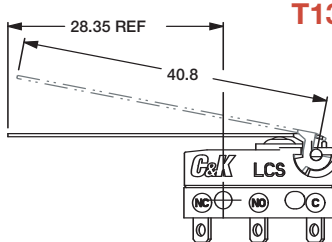

T13

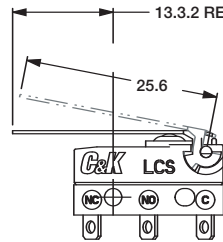

S26

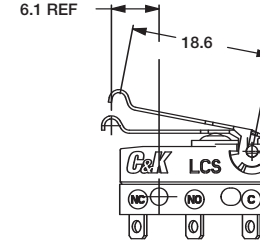

T05

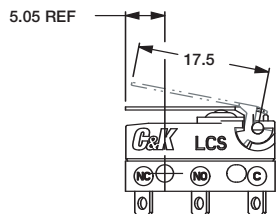

T43

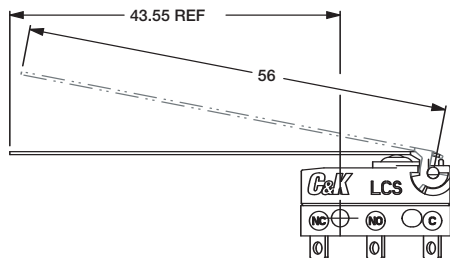

Snap-acting

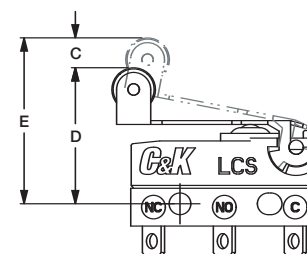
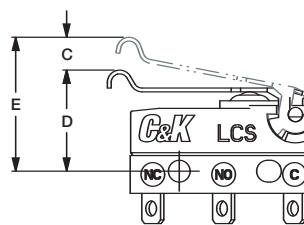
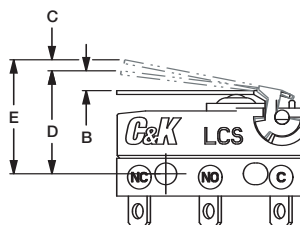
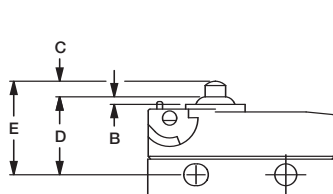

ACTUATOR OPTION CODE	A LENGTH OF LEVER	B OVER TRAVEL (MIN)	C PRE TRAVEL (MAX)	D OPERATING POSITION	E FREE POSITION (MAX)	DIFFERENTIAL MOTION (MAX)		OPERATING FORCE (MIN)		RELEASE FORCE (MIN)	
						150	203	150	203	150	203
P00	N/A	0.6	1.2	8.4 ± 3	9.9	0.2	0.2	150	203	30	50
T00	11.9	0.6	3.2	8.8 ± 9	11.1	0.5	0.5	66	98	10	21
T05	17.40	0.9	4.3	8.8 ± 1.1	12	0.6	0.6	73	82	14	16
T07	19.40	1	4.8	8.8 ± 1.2	12.4	0.7	0.7	55	66	11	13
T13	25.5	1.6	6.3	8.8 ± 1.6	13.5	0.9	0.9	29	54	6	11
T19	33.3	1.95	8	8.8 ± 2.0	15	1.75	1.75	32	40	2	5
T28	40.7	2.1	10.1	8.8 ± 2.6	16.3	2.3	2.3	33	39	1	8
T43	55.9	2.9	13.8	8.8 ± 3.5	19.1	3.6	3.6	23	33	1	7
S26	18.6	1	4.6	10.7 ± 1.2	14.1	0.65	0.65	42	68	7	14
A05	17.20	0.9	4.3	14.5 ± 1.1	17.7	0.6	0.6	60	72	12	15



Third Angle
Projection

Dimensions are shown: mm
Specifications and dimensions subject to change



LCS Series Subminiature Sealed Snap-acting Switches

TERMINATIONS

S SOLDER

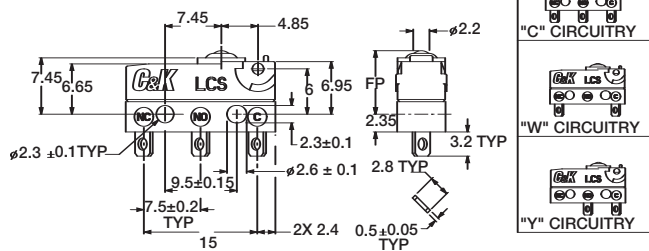

Q QUICK CONNECT 2.8mm / 0.110"

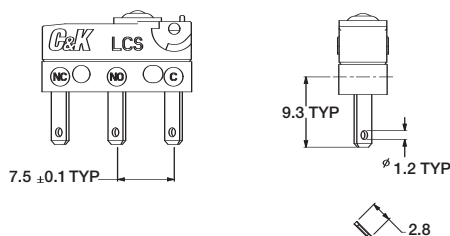

P PC THRU HOLE

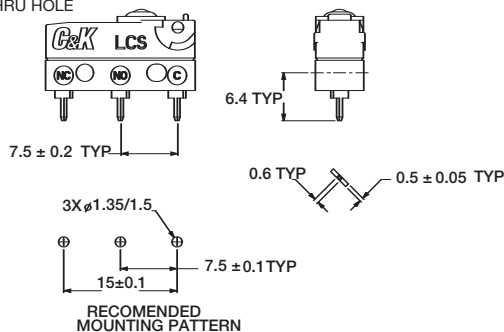

Z or W "A" WIRE ORIENTATION

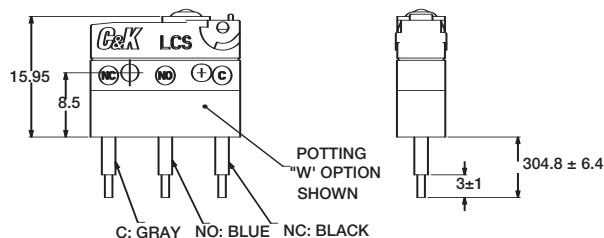

Z or W "B" WIRE ORIENTATION "Y" OR "W" CIRCUITRY

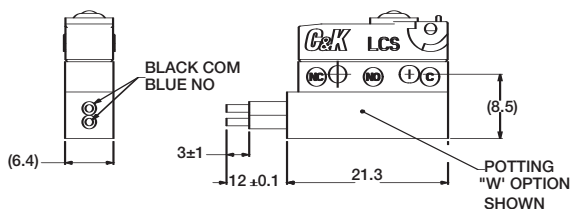

Z or W "C" WIRE ORIENTATION "Y" OR "W" CIRCUITRY

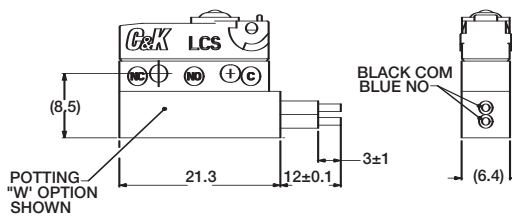

Z or W "B" WIRE ORIENTATION "C" CIRCUITRY

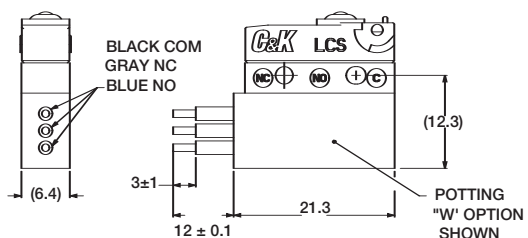

Z or W "C" WIRE ORIENTATION "C" CIRCUITRY

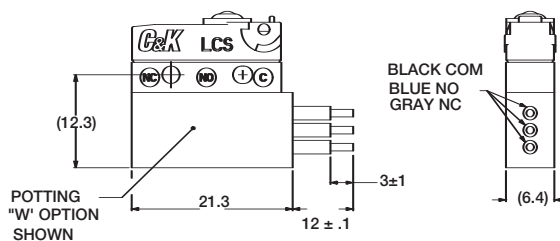

Snap-acting

CIRCUITRY

- C** SPDT (Single Pole, Double Throw)
- W** SPST N.C. (Single Pole, Single Throw, Normally Closed)
- Y** SPST N.O. (Single Pole, Single Throw, Normally Open)

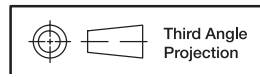

Third Angle
Projection

Dimensions are shown: mm
Specifications and dimensions subject to change



X-ON Electronics

Largest Supplier of Electrical and Electronic Components

Click to view similar products for [Basic / Snap Action Switches](#) category:

Click to view products by [C&K](#) manufacturer:

Other Similar products are found below :

[83228001](#) [01.098.1358.1](#) [602EN1-6B](#) [602EN532](#) [602EN535-RB](#) [602HE5-RB1](#) [604HE162](#) [604HE223-6B](#) [624HE17-RB](#) [6HM89](#) [6PA78-JM](#)
[6SE1](#) [6SX1-H58](#) [70500840](#) [MBD5B1](#) [MBH2731](#) [73-316-0012](#) [79211759](#) [79211923](#) [79218589](#) [7AS12](#) [ML-1155](#) [ML-1376](#) [831010C3.0](#)
[831060C3.TL](#) [831090C2.EL](#) [83131904](#) [84212012](#) [8AS239](#) [8HM73-3](#) [903VB1-PG](#) [914CE1-6G](#) [PL-100](#) [11SM1077-H4](#) [11SM1077-H58](#)
[11SM1-TN107](#) [11SM405](#) [11SM703-T](#) [11SM8423-H2](#) [11SX37-T](#) [11SX48-H58](#) [11SX55-H58](#) [11SM2442-T](#) [11SM76-T](#) [11SM77-H58](#)
[11SM77-T](#) [11SM863-T](#) [11SM866](#) [11SX47-H58](#) [A7CN-1M-1-LEFT](#)