

# CLIFF

## DUALSLIM MINI DISPLAYPORT FEEDTHROUGH CONNECTOR

Can be front or rear mounted in the panel

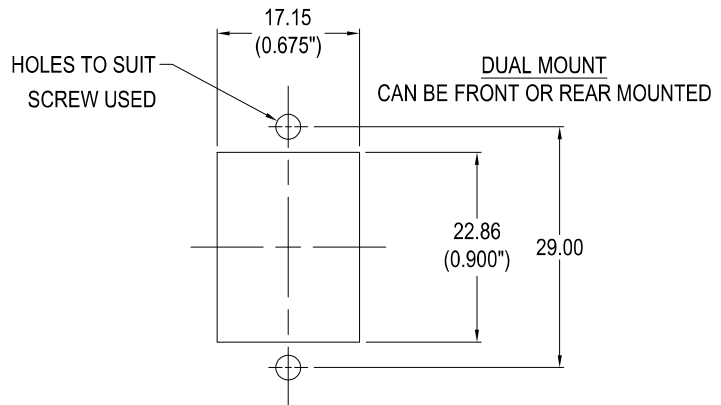
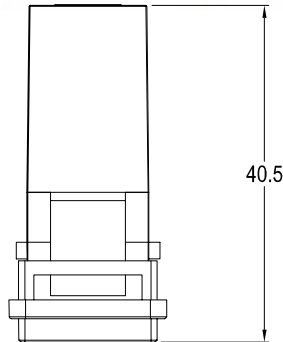

3x HOLE VARIANTS  
Ø3.2mm CSK 90° x Ø5.85  
PLAIN Ø2.5 HOLES  
PLAIN Ø3.2 HOLES

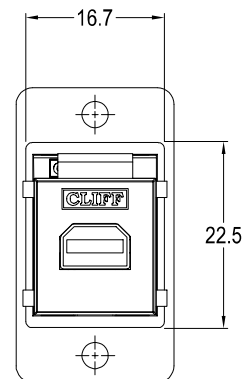
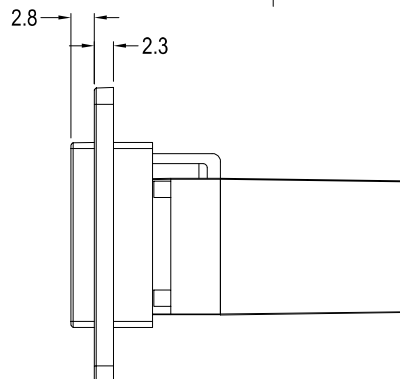
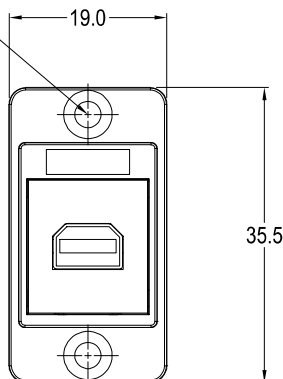

### VARIANTS

Part No.

**CP30702**

DUALSLIM Mini Displayport Black plastic frame, CSK holes

**CP30702X**

DUALSLIM Mini Displayport Black plastic frame, Ø2.5 PLAIN holes

**CP30702X1**

DUALSLIM Mini Displayport Black plastic frame, Ø3.2 PLAIN holes

### Feedthrough Features

- Fits standard rectangular cutout.
- Front or rear mounting through the panel.
- Various hole mounting options.
- No soldering or punch termination. Use standard cable for each connector style.
- Low rear profile.

### Material:

1. Insert: ABS
2. Frame: Polyamide UL94 V2
3. Contacts: Gold Plated

### General:

Please note: Functionality is affected by cable quality, length and cable wiring configuration.

## **X-ON Electronics**

Largest Supplier of Electrical and Electronic Components

*Click to view similar products for [Cliff manufacturer](#):*

Other Similar products are found below :

[CL-SFE/1 FILTERS](#) [CP30173](#) [CP30174](#) [CP30176](#) [CP30178](#) [CP30179](#) [CP30180](#) [CP30182](#) [CP30184](#) [CIH299450](#) [CP30216](#) [CIH29950](#)  
[CP30170](#) [FC68411](#) [CP30183](#) [FCR7366L](#) [CIH3006](#) [CIH29920](#) [CIH29925](#) [FC60955N](#) [FMJ7201FJ2](#) [CL1860](#) [CL2075S](#) [CIH299430](#)  
[CP30150](#) [CL1575](#) [FC68401](#) [CP30172](#) [FCR7365R](#) [CIH3021](#) [CL2075](#) [CL2076S](#) [CIH30241B](#) [CIH30241R](#) [FCR19505RB](#) [CP30116](#)  
[CP30241M](#) [FC681465S](#) [CP30400](#) [CP30175](#) [CP303100](#) [CP303112G](#) [FC60965N](#) [CP30247MB](#) [FCR79011](#) [CIH3007](#) [CL1850](#) [BS300LLL](#)  
[BS3058](#) [CP30225SMB](#)