

| REVISION DATA | | |
|---------------|-------------|------------|
| REV | DESCRIPTION | DATE |
| A0 | NEW DRAWING | 2010-04-01 |

Technical Data

Material:
 Pin(outer sleeve): Brass,machined CuZn38Pb2
 Clip(contact 4 finger): Beryllium copper,heat treated
Plating(outer sleeve):
 Tin plated:2μm/80μ"Ni, 5μm/200μ"Sn
 Gold Plated:2μm/80μ"nickelfull gold
Plating(contact): 2μm/80μ"nickel, gold or Tin plated
 Insulator black(housing): PBT OR PPS (UL94V-0)

Electrical:
 Current rating: 3Amps/contact max.
 Contact resistance: ≤4mΩ/contact
 Insulation resistance: ≥1000MΩ at V=100V
 Operating voltage: 60VAC/DC

Mechanical:
 Average insertion force with steel pin of Ø0.43mm/0.017": <250g
 Average withdrawal force with steel pin of Ø0.43mm/0.017": >90g min.
 Mechanical life cycle:min.200
 Operating temperatures: Gold Plated:-55° C to+105° C
 Tin plated:-40° C to+105° C
 Soldering temperature: +220° C,10s max (PBT)
 +260° C,10s max (PPS)

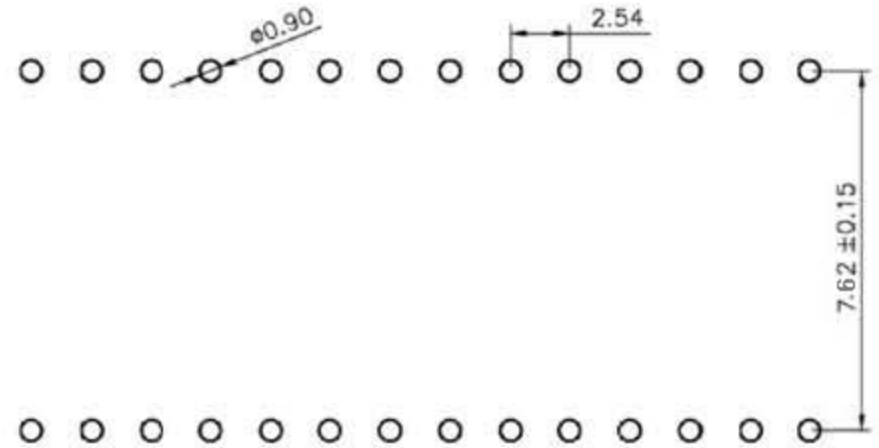
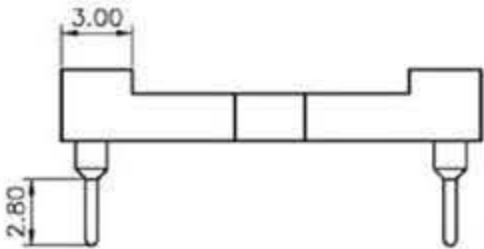
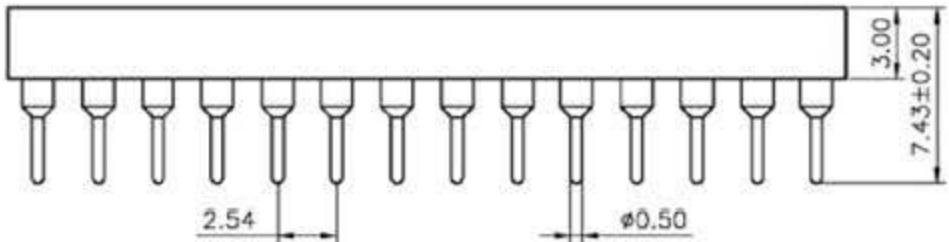
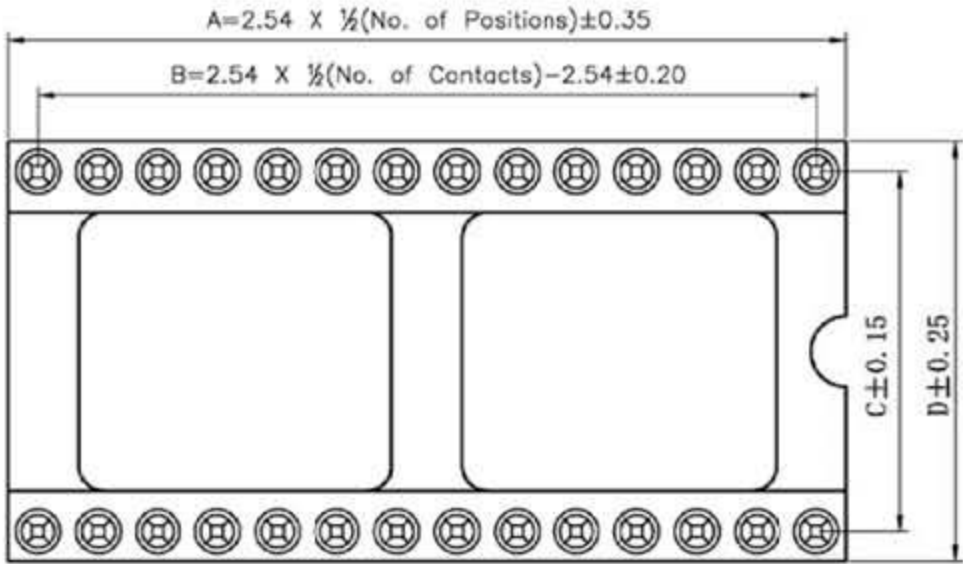

P.C.B LAYOUT

| PIN NO. | DIM A | DIM B | DIM C | DIM D |
|---------|-------|-------|-------|-------|
| 6 | 7.62 | 5.08 | 7.62 | 10.16 |
| 8 | 10.16 | 7.62 | 7.62 | 10.16 |
| 14 | 17.78 | 15.24 | 7.62 | 10.16 |
| 16 | 20.32 | 17.76 | 7.62 | 10.16 |
| 18 | 22.86 | 20.32 | 7.62 | 10.16 |
| 20 | 25.4 | 22.86 | 7.62 | 10.16 |

CnC Tech, LLC Industrial Cable and Connector Technology

| TOLERANCE | PROJECTON | TITLE: |
|--------------|------------|--|
| ANGLE ± 5° | DATE : | 2010-04-01 |
| X.XXX ± 0.10 | DRAWN : | LiKui |
| X.XX ± 0.20 | CHECKED : | |
| X.X ± 0.30 | APPROVED : | |
| X. ± 0.50 | | |
| | | TITLE: 2.54mmPitch IC Sockets Straight DIP Spacing 15.24mm Pin Length 7.43mm |
| | | PART NO: 210-1-XX-003 |
| | | DRAWING NO: |
| | | REV: A0 UNIT: mm SCALE: 3:1 SIZE: A4 |

X-ON Electronics

Largest Supplier of Electrical and Electronic Components

Click to view similar products for [cnc manufacturer](#):

Other Similar products are found below :

[741-20010-00500](#) [DL-5468](#) [2725-2828-01000-T](#) [300-30-40-GR-0250F](#) [743-60012-00300](#) [302-28-50-GR-0250F](#) [302-28-10-GR-0100F](#)
[3020-10-0300-00-TR](#) [FM-213-4](#) [FM-214-4](#) [302-28-26-GR-0250F](#) [302-28-40-GR-0250F](#) [304-28-26-MC-0250F](#) [304-28-40-MC-0250F](#)
[302-28-09-GR-0250F](#) [1002-003-02000](#) [302-28-37-GR-0250F](#) [302-28-25-GR-0250F](#) [3020-10-0300-00](#) [300-30-14-GR-0250F](#) [302-28-14-GR-](#)
[0250F](#) [300-30-04-GR-0250F](#) [300-30-26-GR-0250F](#) [304-28-16-MC-0250F](#) [304-28-26-MC-0100F](#) [302-28-10-GR-0250F](#) [800-1401-2-SJT0-](#)
[BL-00200](#) [300-30-20-GR-0250F](#) [304-28-14-MC-0250F](#) [800-1800-2-SVT0-BL-00100](#) [741-20010-01000](#) [CNC-99-16](#) [302-28-20-GR-0100F](#)
[302-28-26-GR-0100F](#) [304-28-40-MC-0100F](#) [600218](#) [510-26-6600-WH-0007F](#) [610230](#) [3010-10-003-13-00](#) [304-28-14-MC-0100F](#) [302-28-50-](#)
[GR-0100F](#) [3030-16-0102-00](#) [3221-10-0300-00](#) [304-28-16-MC-0100F](#) [610234](#) [302-28-37-GR-0100F](#) [800-12-32D-BL-0008F](#) [FM-215-8](#) [DL-](#)
[1006](#) [304-28-20-MC-0250F](#)