

REV.	DESCRIPTION	DATE
A	RELEASE	2012.11.12

RoHS

NOTES:

Insulator Material: PBT, UL 94V-0
 Contact Plating: TIN, 80-100μ"
 Contact Material: Brass

Current Rating : 1A AC,DC
 Contact Resistance: 20MΩ Max.
 Dielectric Withstanding: AC 500V
 Insulator Resistance: 1000MΩ Min.
 Operating Temp.: -40°C~+105°C

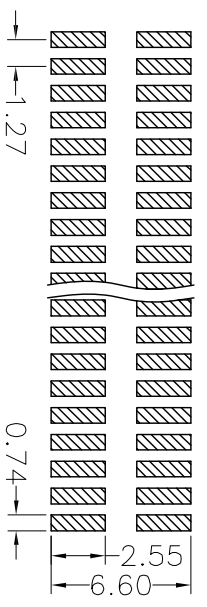
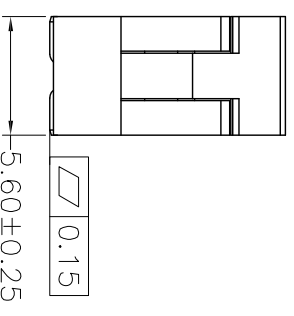
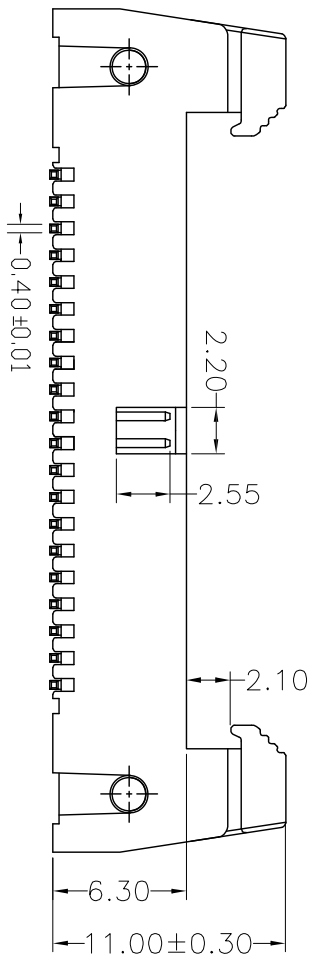
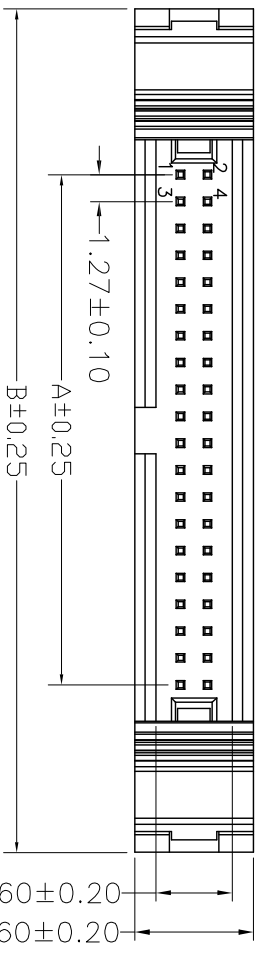

P.C.B LAYOUT

NUMBER OF POSITIONS	DIMENSIONS	
	A	B
06	2.54	18.31
08	3.81	19.58
10	5.08	20.85
12	6.35	22.12
14	7.62	23.39
16	8.89	24.66
18	10.16	25.93
20	11.42	27.20
24	13.97	29.74
26	15.24	31.01
30	17.78	33.55
34	20.32	36.09
40	24.13	39.90
50	30.48	46.25
60	36.83	52.60
64	39.37	55.14

CnC Tech,LLC

3210-XX-003-12-99

UNLESS TOLERANCE		DRAW BY	
GENERAL	ANGLE	DESIGN BY	CHECK BY
X ± 0.30	X° ± 3.0°		
.X ± 0.20	.X° ± 2.0°		
.XX ± 0.15	.XX° ± 1.0°		
.XXX ± 0.08	.XXX ± 0.5°		

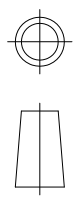

SCALE	SHEET	UNIT
1:1	1/1	MM

DRAW NO: REV: A

X-ON Electronics

Largest Supplier of Electrical and Electronic Components

Click to view similar products for [cnc manufacturer](#):

Other Similar products are found below :

[741-20010-00500](#) [DL-5468](#) [2725-2828-01000-T](#) [300-30-40-GR-0250F](#) [743-60012-00300](#) [302-28-50-GR-0250F](#) [302-28-10-GR-0100F](#)
[3020-10-0300-00-TR](#) [FM-213-4](#) [FM-214-4](#) [302-28-26-GR-0250F](#) [302-28-40-GR-0250F](#) [304-28-26-MC-0250F](#) [304-28-40-MC-0250F](#)
[302-28-09-GR-0250F](#) [1002-003-02000](#) [302-28-37-GR-0250F](#) [302-28-25-GR-0250F](#) [3020-10-0300-00](#) [300-30-14-GR-0250F](#) [302-28-14-GR-](#)
[0250F](#) [300-30-04-GR-0250F](#) [300-30-26-GR-0250F](#) [304-28-16-MC-0250F](#) [304-28-26-MC-0100F](#) [302-28-10-GR-0250F](#) [800-1401-2-SJT0-](#)
[BL-00200](#) [300-30-20-GR-0250F](#) [304-28-14-MC-0250F](#) [800-1800-2-SVT0-BL-00100](#) [741-20010-01000](#) [CNC-99-16](#) [302-28-20-GR-0100F](#)
[302-28-26-GR-0100F](#) [304-28-40-MC-0100F](#) [600218](#) [510-26-6600-WH-0007F](#) [610230](#) [3010-10-003-13-00](#) [304-28-14-MC-0100F](#) [302-28-50-](#)
[GR-0100F](#) [3030-16-0102-00](#) [3221-10-0300-00](#) [304-28-16-MC-0100F](#) [610234](#) [302-28-37-GR-0100F](#) [800-12-32D-BL-0008F](#) [FM-215-8](#) [DL-](#)
[1006](#) [304-28-20-MC-0250F](#)