

CUSTOMER APPROVED:

DATE:

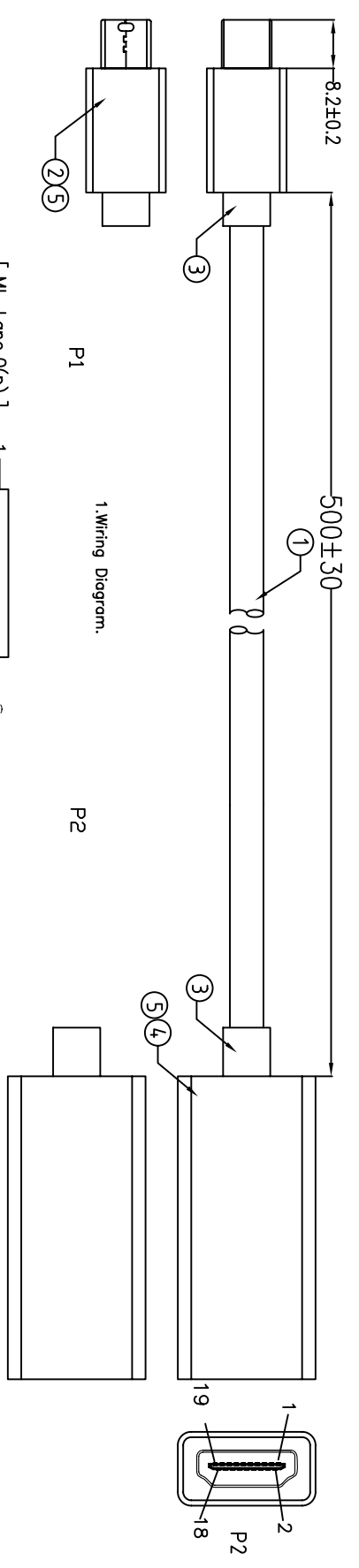
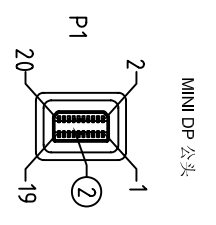

1. Wiring Diagram.

[ML_Lane 0(p)]	1	3	TMDS data2-
[ML_Lane 0(n)]	2	1	TMDS data2+
[GND]	3	2	TMDS data2 Shield
[ML_Lane 1(p)]	4	6	TMDS data1-
[ML_Lane 1(n)]	5	4	TMDS data1+
[GND]	6	5	TMDS data1 Shield
[ML_Lane 2(p)]	7	9	TMDS data0-
[ML_Lane 2(n)]	8	7	TMDS data0+
[GND]	9	8	TMDS data0 Shield
[ML_Lane 3(p)]	10	12	TMDS Clock-
[ML_Lane 3(n)]	11	10	TMDS Clock+
[GND]	12	11	TMDS Clock Shield
[CONFIG 1]	13	13	CEC
[CONFIG 2]	14	14	Reserved
[AUX_CH(p)]	15	14	SCL
[AUX_CH(n)]	16	15	SDA
[GND]	17	16	DDC/CEC Ground
[Hot Plug Detect]	18	17	+5V Power
[Return Dp_PWR]	19	18	Hot Plug Detect
[NC]	20	19	

5	PE	PE INSERMOLDING	10g		
4	CONN	HDMI FEMALE INSULATION WHITE NICKEL PIN G/F W/WHITE COVER W/PCB+IC(NXP3361)	1SET	P2	
3	PVC	45P PVC WHITE OVERMOLD	30g		
2	CONN	MINIDP20 MALE INSULATION WHITE NICKEL PIN G/F W/WHITE HOOD	1SET	P1	
1	CABLE	UL 20276 (32AWG*1P+DW+AL/MY)*5+32AWG*5 C+A+D+B(16/6/0.1AAM) ODS.5 WHITE	1	500MM	
NO.	PART NO.	DESCRIPTION	QTY	UNIT/REF	

REV	2015/04/14	DATE	2015/04/14
REV	A	2015/04/14	INITIAL RELEASE
REV	EDWIN LA	04/14/15	DATE
REV	EDWIN LA	04/14/15	CHECKED
REV	EDWIN LA	04/14/15	DRAWN
REV	EDWIN LA	04/14/15	APPROVAL
REV	EDWIN LA	04/14/15	CUSTOMER P/N:
REV	EDWIN LA	04/14/15	CUSTOMER:
REV	EDWIN LA	04/14/15	TITLE
REV	EDWIN LA	04/14/15	DESCRIPTION
REV	EDWIN LA	04/14/15	DWN NO.
REV	EDWIN LA	04/14/15	743-50010-00050
REV	EDWIN LA	04/14/15	SHEET 1 OF 1
REV	EDWIN LA	04/14/15	MIN DP/M TO HDMI/F
REV	EDWIN LA	04/14/15	Cnc Tech, LLC

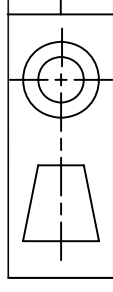

X-ON Electronics

Largest Supplier of Electrical and Electronic Components

Click to view similar products for [cnc manufacturer](#):

Other Similar products are found below :

[741-20010-00500](#) [DL-5468](#) [2725-2828-01000-T](#) [300-30-40-GR-0250F](#) [743-60012-00300](#) [302-28-50-GR-0250F](#) [302-28-10-GR-0100F](#)
[3020-10-0300-00-TR](#) [FM-213-4](#) [FM-214-4](#) [302-28-26-GR-0250F](#) [302-28-40-GR-0250F](#) [304-28-26-MC-0250F](#) [304-28-40-MC-0250F](#)
[302-28-09-GR-0250F](#) [1002-003-02000](#) [302-28-37-GR-0250F](#) [302-28-25-GR-0250F](#) [3020-10-0300-00](#) [300-30-14-GR-0250F](#) [302-28-14-GR-](#)
[0250F](#) [300-30-04-GR-0250F](#) [300-30-26-GR-0250F](#) [304-28-16-MC-0250F](#) [304-28-26-MC-0100F](#) [302-28-10-GR-0250F](#) [800-1401-2-SJT0-](#)
[BL-00200](#) [300-30-20-GR-0250F](#) [304-28-14-MC-0250F](#) [800-1800-2-SVT0-BL-00100](#) [741-20010-01000](#) [CNC-99-16](#) [302-28-20-GR-0100F](#)
[302-28-26-GR-0100F](#) [304-28-40-MC-0100F](#) [600218](#) [510-26-6600-WH-0007F](#) [610230](#) [3010-10-003-13-00](#) [304-28-14-MC-0100F](#) [302-28-50-](#)
[GR-0100F](#) [3030-16-0102-00](#) [3221-10-0300-00](#) [304-28-16-MC-0100F](#) [610234](#) [302-28-37-GR-0100F](#) [800-12-32D-BL-0008F](#) [FM-215-8](#) [DL-](#)
[1006](#) [304-28-20-MC-0250F](#)