

CUSTOMER APPROVED:

DATE:

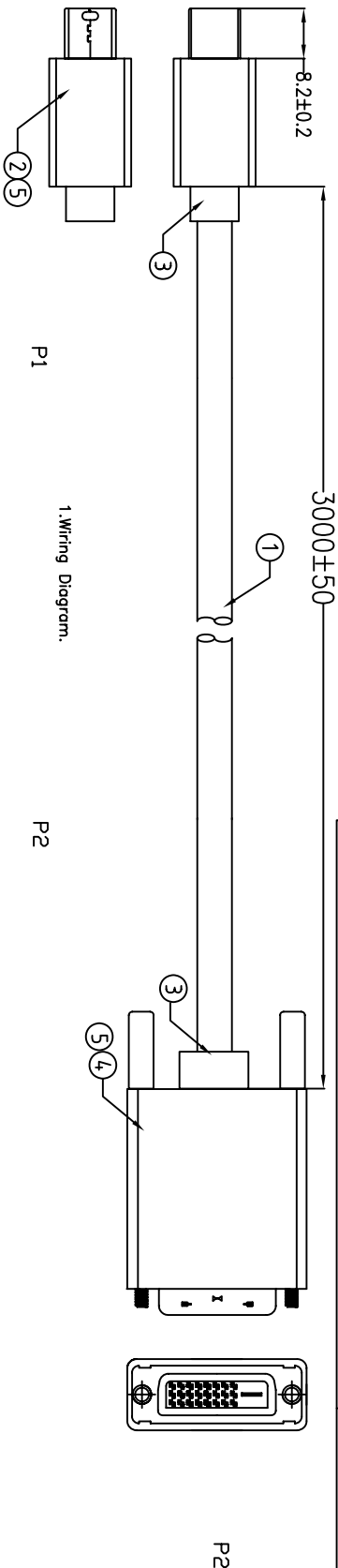
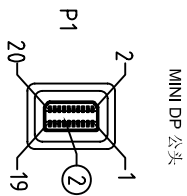

[ ML_Lane 0(p) ]	1	TMDS data2-	1
[ ML_Lane 0(n) ]	3	TMDS data2+	2
[ GND ]	2	TMDS data2 Shield	3
[ ML_Lane 1(p) ]	4	TMDS data1-	9
[ ML_Lane 1(n) ]	6	TMDS data1+	10
[ GND ]	5	TMDS data1 Shield	11
[ ML_Lane 2(p) ]	7	TMDS data0-	17
[ ML_Lane 2(n) ]	9	TMDS data0+	18
[ GND ]	8	TMDS data0 Shield	19
[ ML_Lane 3(p) ]	10	TMDS Clock-	24
[ ML_Lane 3(n) ]	12	TMDS Clock+	23
[ GND ]	11	TMDS Clock Shield	22
[ CONFIG 1 ]	13	DDC Clock	6
[ CONFIG 2 ]	14	(DDC Data)	7
[ AUX_CH(p) ]	15	(Ground)	15
[ AUX_CH(n) ]	17	(+5V Power)	14
[ GND ]	16	(Hot Plug Detect)	16
[ Hot Plug Detect ]	18		
[ Return DP_PWR ]	19		
[ NC ]	20		

SHELL \_\_\_\_\_ SHELL

5	PE	PE INSERMOLDING	10g	
4	CONN	DVI24+1 MALE INSULATION WHITE NICKEL PIN G/F W/WHITE COVER W/PCB+IC W/THUMB SCREWS	1SET	P2
3	PVC	45P PVC WHITE OVERMOLD	30g	
2	CONN	MINIDP20 MALE INSULATION WHITE NICKEL PIN G/F W/WHITE HOOD	1SET	P1
1	CABLE	UL20276 (32AWG*1P+DW+AL/MY)*5+32AWG*5 C+A+D+B(16/6/0.1AAM) ODS.5 WHITE	1	3000MM
NO.	PART NO.	DESCRIPTION	QTY	UNIT/REF
BILL OF MATERIAL				

A 20150414 INITIAL RELEASE 2015/04/14

REV ECN# DESCRIPTION DATE

Cnc Tech, LLC

DRAWN EDWIN LAI DATE 04/14/15

TITLE MINI DP/M TO DVI24+1/M CONNECTOR WITH 3.0MM DWN NO. 743-60011-00300 REV A

CHECKED APPROVAL

CUSTOMER P/N:

SHEET 1 OF 1

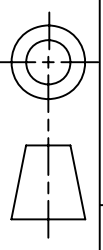

## X-ON Electronics

Largest Supplier of Electrical and Electronic Components

*Click to view similar products for [cnc manufacturer](#):*

Other Similar products are found below :

[741-20010-00500](#) [DL-5468](#) [2725-2828-01000-T](#) [300-30-40-GR-0250F](#) [743-60012-00300](#) [302-28-50-GR-0250F](#) [302-28-10-GR-0100F](#)  
[3020-10-0300-00-TR](#) [FM-213-4](#) [FM-214-4](#) [302-28-26-GR-0250F](#) [302-28-40-GR-0250F](#) [304-28-26-MC-0250F](#) [304-28-40-MC-0250F](#)  
[302-28-09-GR-0250F](#) [1002-003-02000](#) [302-28-37-GR-0250F](#) [302-28-25-GR-0250F](#) [3020-10-0300-00](#) [300-30-14-GR-0250F](#) [302-28-14-GR-](#)  
[0250F](#) [300-30-04-GR-0250F](#) [300-30-26-GR-0250F](#) [304-28-16-MC-0250F](#) [304-28-26-MC-0100F](#) [302-28-10-GR-0250F](#) [800-1401-2-SJT0-](#)  
[BL-00200](#) [300-30-20-GR-0250F](#) [304-28-14-MC-0250F](#) [800-1800-2-SVT0-BL-00100](#) [741-20010-01000](#) [CNC-99-16](#) [302-28-20-GR-0100F](#)  
[302-28-26-GR-0100F](#) [304-28-40-MC-0100F](#) [600218](#) [510-26-6600-WH-0007F](#) [610230](#) [3010-10-003-13-00](#) [304-28-14-MC-0100F](#) [302-28-50-](#)  
[GR-0100F](#) [3030-16-0102-00](#) [3221-10-0300-00](#) [304-28-16-MC-0100F](#) [610234](#) [302-28-37-GR-0100F](#) [800-12-32D-BL-0008F](#) [FM-215-8](#) [DL-](#)  
[1006](#) [304-28-20-MC-0250F](#)