

| REV. | ECN NO. | DESCRIPTION | DATE | DESIGN |
|------|---------|----------------|----------|--------|
| A | | 增加2P的图、变更2P的尺寸 | 17.07.10 | 苏亮 |

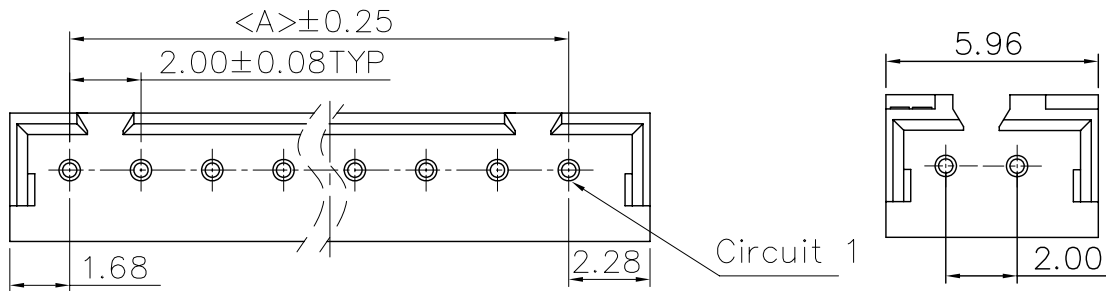

2P 专用

Specifications:

Current rating: 4A AC/DC.

Voltage rating: 125V AC/DC

Temperature range: $-40^{\circ}\text{C} \sim +105^{\circ}\text{C}$.

Contact resistance: $10\text{M}\Omega$ Max.

Insulation resistance: $1000\text{M}\Omega$ Min.

Withstanding voltage: 1000V AC/minute.

Material: PA66.UL94V-0.

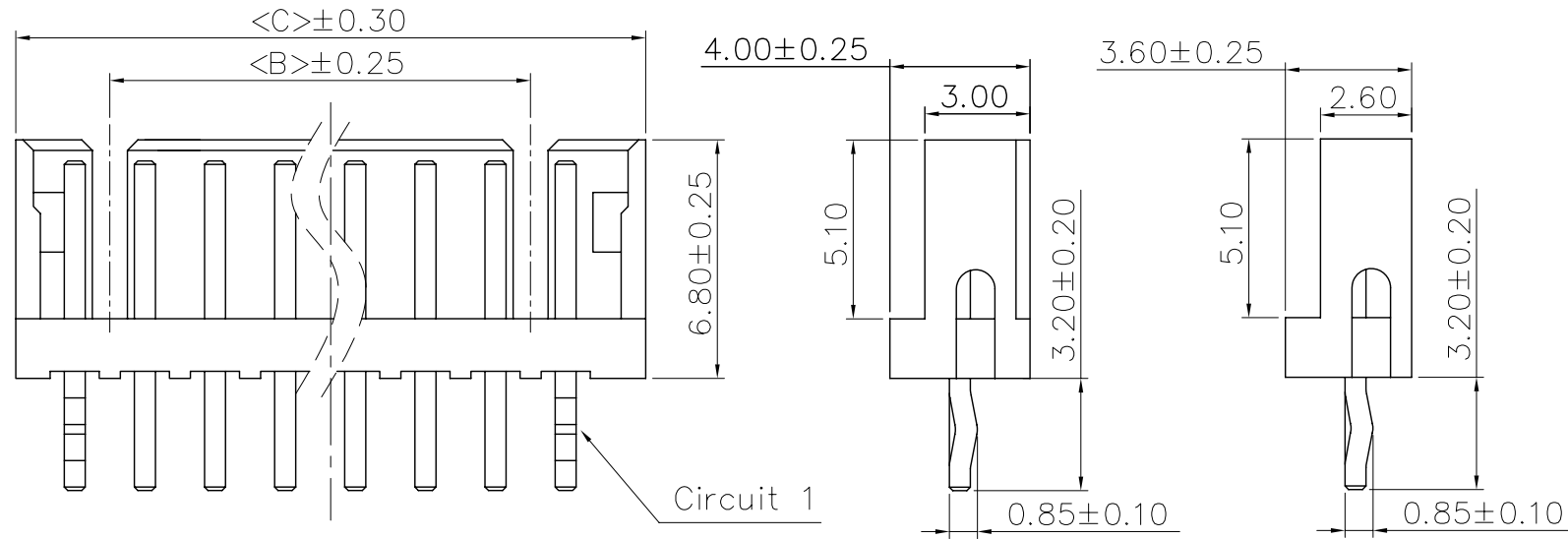

2P 专用

Recommended P.C.B Layout(Top Side)

P.C.B Thickness = 1.20mm (Tolerance= ± 0.05)

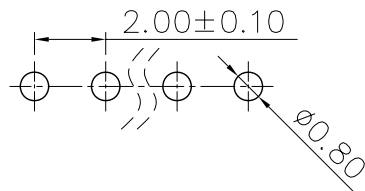

| PART NO. | Dimensions | | |
|-------------|------------|-------|-------|
| | A | B | C |
| A2007WV-02P | 2.00 | | 5.96 |
| A2007WV-03P | 4.00 | | 7.95 |
| A2007WV-04P | 6.00 | 4.00 | 9.96 |
| A2007WV-05P | 8.00 | 6.00 | 11.96 |
| A2007WV-06P | 10.00 | 8.00 | 13.96 |
| A2007WV-07P | 12.00 | 10.00 | 15.96 |
| A2007WV-08P | 14.00 | 12.00 | 17.96 |
| A2007WV-09P | 16.00 | 14.00 | 19.96 |
| A2007WV-10P | 18.00 | 16.00 | 21.96 |
| A2007WV-11P | 20.00 | 18.00 | 23.96 |
| A2007WV-12P | 22.00 | 20.00 | 25.96 |
| A2007WV-13P | 24.00 | 22.00 | 27.96 |
| A2007WV-14P | 26.00 | 24.00 | 29.96 |
| A2007WV-15P | 28.00 | 26.00 | 31.96 |

CNJM Joint More Precision electronics Co.,Ltd.

| DRAW NO. | DATE | P/N NO: | DRAW NAME: |
|-------------|------------|------------|-----------------------|
| DESIGN: 陈雪峰 | 2017.06.03 | A2007WV-NP | 2.0mm pitch 180°wafer |
| CHECK: 杨 焯 | | | |
| REVIEW: | | REV. A/1 | SCALE 1: 1 |

| DIM | TOL | DIM | TOL |
|-------|------|--------|-----|
| X. | / | X* | / |
| X.X | 0.25 | X.X* | |
| X.XX | 0.15 | X.XX* | |
| X.XXX | 0.10 | X.XXX* | / |

UNIT: mm SHEET: 1 OF 1

X-ON Electronics

Largest Supplier of Electrical and Electronic Components

Click to view similar products for [Headers & Wire Housings](#) category:

Click to view products by [CNJM](#) manufacturer:

Other Similar products are found below :

[57102-F02-18ULF](#) [58102-G61-06LF](#) [582553-1](#) [009176003701906](#) [01.001.5753.1](#) [0050291907](#) [02.125.8002.8](#) [609-3404](#) [61062-3](#)
[CSU011177004](#) [622-0430](#) [622-3653LF](#) [63453-116](#) [636-1030](#) [636-1427](#) [636-3427](#) [636-4007](#) [641938-9](#) [65495-038](#) [65692-001LF](#) [65781-018](#)
[65781-047](#) [65817-010LF](#) [65817-015LF](#) [66207-023LF](#) [67095-007LF](#) [67601157](#) [68631-112](#) [699319-000](#) [M90C108951C](#) [70.362.1628.0](#) [70-](#)
[4210](#) [70-4226B](#) [70-4853B](#) [707-5028](#) [71.350.2428.0](#) [71961-016LF](#) [733-134](#) [733-162](#) [754199-000](#) [760-3052](#) [80.063.4001.1](#) [800-90-001-10-](#)
[001000](#) [801-43-002-10-013000](#) [801-43-006-10-002000](#) [803-41-018-10-001000](#) [803-43-024-10-001000](#) [803-93-012-10-001000](#) [8-1437020-4](#)
[819-22-004-30-001101](#)