

COM-KNOBS

Order data on pages 192-193

OKW
GEHÄUSE
SYSTEME



MODERN APPEARANCE

Sizes (mm)

ø 16, ø 20, ø 23, ø 31, ø 40, ø 50

Fastening

with collet fixture system for rotary potentiometer with shaft ends according to DIN 41591

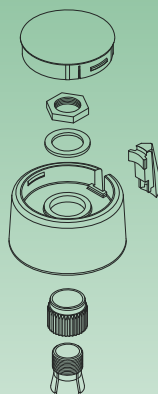

THE PRODUCT

Outstanding appearance is characteristic of the COM-KNOBS.

Aesthetic design and a modern selection of colours in pastel tones give the appliances a high-quality appearance.

Different sizes and combinations also provide a wide selection of attractive tuning knobs with the tried and tested collet fixture system.

YOUR ADVANTAGE

Knob design for a modern, innovative image for your equipment.

Reliable operation with the tried and tested collet fixture system: convenient assembly of knobs from the front and tight fitting on the axis.

Without/with marking element.

For size 40 and larger, the cover is also available with a finger recess for rational handling during adjustment.



detailed drawings see our website
www.okw.com



COM-KNOBS WITH RECESS / WITHOUT RECESS

COVER

PA 6 reinforced



PA 6 reinforced

without/
with
finger
recess

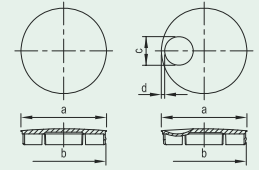

Knob Ø	Dim. in mm		Borehole D	Knob variants				COVER		
	without recess	with recess		with recess	without recess	with recess	with finger recess	without finger recess		
16			4 mm, without chamfer	A 30 16 049	A 31 16 049	A 30 16 048	A 31 16 048	a = 11.5 b = 11.0	<ul style="list-style-type: none"> ● A 32 16 003 ● A 32 16 004 ● A 32 16 005 ● A 32 16 006 ● A 32 16 007 ● A 32 16 009 	
			6 mm, with chamfer	A 30 16 069	A 31 16 069	A 30 16 068	A 31 16 068			
			1/4", with chamfer	A 30 16 639	A 31 16 639	A 30 16 638	A 31 16 638			
20			4 mm, without chamfer	A 30 20 049	A 31 20 049	A 30 20 048	A 31 20 048	a = 14.0 b = 13.5	<ul style="list-style-type: none"> ● A 32 20 003 ● A 32 20 004 ● A 32 20 005 ● A 32 20 006 ● A 32 20 007 ● A 32 20 009 	
			6 mm, with chamfer	A 30 20 069	A 31 20 069	A 30 20 068	A 31 20 068			
			1/4", with chamfer	A 30 20 639	A 31 20 639	A 30 20 638	A 31 20 638			
23			4 mm, without chamfer	A 30 23 049	A 31 23 049	A 30 23 048	A 31 23 048	a = 17.0 b = 16.5	<ul style="list-style-type: none"> ● A 32 23 003 ● A 32 23 004 ● A 32 23 005 ● A 32 23 006 ● A 32 23 007 ● A 32 23 009 	
			6 mm, without chamfer	A 30 23 069	A 31 23 069	A 30 23 068	A 31 23 068			
			1/4", without chamfer	A 30 23 639	A 31 23 639	A 30 23 638	A 31 23 638			
31			6 mm, without chamfer	A 30 31 069	A 31 31 069	A 30 31 068	A 31 31 068	a = 25.0 b = 24.5	<ul style="list-style-type: none"> ● A 32 31 003 ● A 32 31 004 ● A 32 31 005 ● A 32 31 006 ● A 32 31 007 ● A 32 31 009 	
			1/4", without chamfer	A 30 31 639	A 31 31 639	A 30 31 638	A 31 31 638			
40			6 mm, without chamfer	A 30 40 069	A 31 40 069	A 30 40 068	A 31 40 068	a = 34.0 b = 33.5 c = 11.4 d = 1.3	<ul style="list-style-type: none"> ● A 32 40 003 ● A 32 40 004 ● A 32 40 005 ● A 32 40 006 ● A 32 40 007 ● A 32 40 009 	A 32 40 103
			8 mm, without chamfer	A 30 40 089	A 31 40 089	A 30 40 088	A 31 40 088			
50			6 mm, without chamfer	A 30 50 069	A 31 50 069	A 30 50 068	A 31 50 068	a = 44.0 b = 43.5 c = 12.9 d = 2.8	<ul style="list-style-type: none"> ● A 32 50 003 ● A 32 50 004 ● A 32 50 005 ● A 32 50 006 ● A 32 50 007 ● A 32 50 009 	A 32 50 103
			8 mm, without chamfer	A 30 50 089	A 31 50 089	A 30 50 088	A 31 50 088			



PEAK	DISK	DIAL	STATOR	NUT COVER
<p>PA 6 reinforced only for COM-KNOBS with recess</p>	<p>ABS ...010 = marking white</p>	<p>Polycarbonate ...0 = symbols black ...9 = symbols silver</p>	<p>Aluminium marking black</p>	<p>ABS ...010 = marking white ...018 = marking black</p>
<p>a = 3.9</p> <ul style="list-style-type: none"> A 33 16 003 A 33 16 004 A 33 16 005 A 33 16 006 A 33 16 007 A 33 16 009 	<p>a = 23.0 b = 10.0 c = 1.3</p>	<p>a = 31.0 b = 14.5 c = 10.0 d = 2.5 e = 1.7</p> <p>(ø 16 with moulded-on nut cover)</p>	<p>a = 16.0 b = 10.1 c = 15.5</p>	<p>a = 19.3 b = 17.6 c = 10.0 d = 3.3 e = 4.3</p> <p>a = 16.4 b = 14.6 c = 10.0 c = 3.3 e = 4.3 f = 10.2</p>
<p>a = 4.0</p> <ul style="list-style-type: none"> A 33 20 003 A 33 20 004 A 33 20 005 A 33 20 006 A 33 20 007 A 33 20 009 		<p>a = 36.0 b = 12.0 c = 1.5</p>	<p>a = 20.0 b = 10.1 c = 18.0</p>	
<p>a = 4.0</p> <ul style="list-style-type: none"> A 33 20 003 A 33 20 004 A 33 20 005 A 33 20 006 A 33 20 007 A 33 20 009 	<p>a = 31.0 b = 16.5 c = 1.3</p>	<p>a = 40.0 b = 16.3 c = 1.3</p>	<p>a = 23.0 b = 10.2 c = 20.0</p>	
<p>a = 4.0</p> <ul style="list-style-type: none"> A 33 20 003 A 33 20 004 A 33 20 005 A 33 20 006 A 33 20 007 A 33 20 009 	<p>a = 40.0 b = 16.5 c = 1.6</p>	<p>a = 49.9 b = 16.5 c = 1.5</p>		
<p>a = 4.0</p> <ul style="list-style-type: none"> A 33 20 003 A 33 20 004 A 33 20 005 A 33 20 006 A 33 20 007 A 33 20 009 	<p>a = 50.1 b = 24.0 c = 1.8</p>			
<p>a = 4.0</p> <ul style="list-style-type: none"> A 33 20 003 A 33 20 004 A 33 20 005 A 33 20 006 A 33 20 007 A 33 20 009 				

Standard colours COM-KNOBS

- COM-KNOBS
- Nero
 - Volcano
- Covers without/with finger recess
- Marking element "Peak"
- Coral
 - Beach
 - Lagoon
 - Sky
 - Mineral
 - Nero
- Disk, Nut cover
- Black, RAL 9005
 - Dust grey, RAL 7037
- Dial
- Transparent, bright surface with/without marking

X-ON Electronics

Largest Supplier of Electrical and Electronic Components

Click to view similar products for [Knobs & Dials](#) category:

Click to view products by [OKW ENCLOSURES](#) manufacturer:

Other Similar products are found below :

[61-9028.20](#) [61-9028.9](#) [8529](#) [8573](#) [9-1437622-4](#) [11K5015-EMNB](#) [11K5019-ECNB](#) [11K5020-KLAB](#) [11K5028-JMNG](#) [11K5048-KMNB](#)
[11K5014-EMNB](#) [11K5015-EMNG](#) [11K5019-EMNB](#) [11K5029-KMNG](#) [P400S-08-D6-N](#) [K6510](#) [KNSL500B1/8](#) [AL811BA18](#) [420031B18](#)
[5006](#) [KB700BA1/4](#) [KS700B14](#) [411](#) [4-1437621-3](#) [420065A14AL](#) [5149A](#) [028-1-11](#) [52-928.20](#) [52-928.60](#) [52-928.9](#) [8517](#) [8546](#) [8570](#) [8572](#)
[H-516-3A](#) [P861H-0X-S6](#) [8544](#) [11K5014-JMNG](#) [11K5014-KMNG](#) [11K5014-ECNG](#) [5700E](#) [KA500B18](#) [KFS600B14](#) [KN900AB14](#)
[KFS500B14](#) [KNS501B18](#) [PKD60B1018](#) [PK1100B18](#) [PKES140B14](#) [PKES150B14](#)