

CJ2301-HF

P-Channel
RoHS Device
Halogen Free

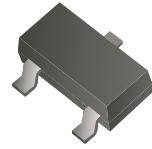

V(BR)DSS	RDS(on)MAX	ID
-20V	112mΩ @ -4.5V	-2.3A
	142mΩ @ -2.5V	

Features

- P-Channel 20-V(D-S) MOSFET
- Trench FET Power MOSFET.
- Load Switch for Portable Devices.
- DC/DC Converter.

Mechanical data

- Case: SOT-23, molded plastic.
- Terminals: Solderable per MIL-STD-750, method 2026.
- Weight: 0.008 grams(approx.).

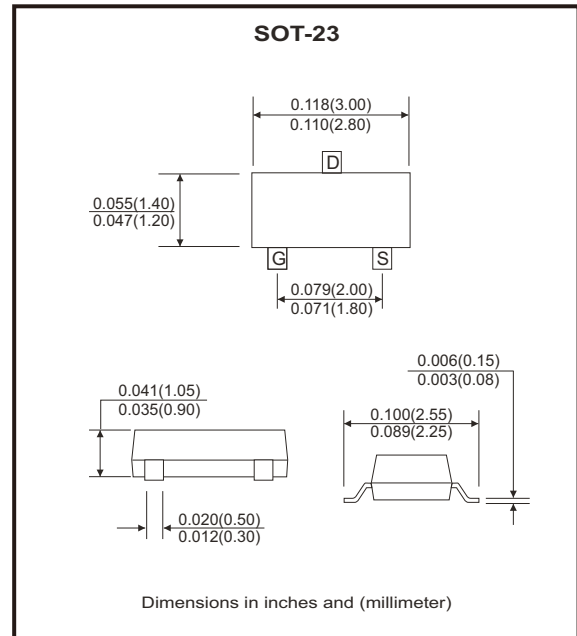

Circuit diagram

- G : Gate
- S : Source
- D : Drain

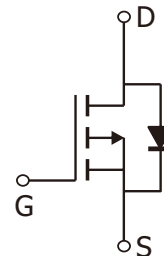

Maximum Ratings (at Ta=25 °C unless otherwise noted)

Parameter	Symbol	Value	Units
Drain-source voltage	V _{DS}	-20	V
Gate-source voltage	V _{GS}	±8	V
Continuous drain current	I _D	-2.3	A
Pulsed drain current	I _{DM}	-10	
Continuous source-drain diode current	I _S	-0.72	
Maximum power dissipation	P _D	400	mW
Thermal resistance from junction to ambient (t<5s)	R _{θJA}	312.5	°C/W
Junction temperature range	T _J	150	°C
Storage temperature range	T _{STG}	-55 to +150	°C

Electrical Characteristics (at T_A=25°C unless otherwise noted)

Parameter	Symbol	Conditions	Min	Typ	Max	Units
Static						
Drain-source breakdown voltage	V _{(BR) DSS}	V _{GS} =0V , I _D =-250μA	-20			V
Gate-source threshold voltage	V _{GS(th)}	V _{DS} =V _{GS} , I _D =-250μA	-0.4		-1	
Gate-source leakage	I _{GSS}	V _{DS} =0V , V _{GS} =±8V			±100	nA
Zero gate voltage drain current	I _{DSS}	V _{DS} =-20V , V _{GS} =0V			-1	μA
Drain-source on-state resistance (Note a)	R _{DS(on)}	V _{GS} =-4.5V , I _D =-2.8A		0.090	0.112	Ω
		V _{GS} =-2.5V , I _D =-2.0A		0.110	0.142	
Forward transconductance (Note a)	g _{fs}	V _{DS} =-5V , I _D =-2.8A		6.5		S
Dynamic (Note b)						
Input capacitance	C _{iss}	V _{DS} =-10V , V _{GS} =0V, f=1MHz		405		pF
Output capacitance	C _{oss}			75		
Reverse transfer capacitance	C _{rss}			55		
Total gate charge	Q _g	V _{DS} =-10V , V _{GS} =-4.5V, I _D =-3A		5.5	10	nC
				3.3	6	
Gate-source charge	Q _{gs}	V _{DS} =-10V , V _{GS} =-2.5V, I _D =-3A		0.7		
Gate-drain charge	Q _{gd}			1.3		
Gate resistance	R _g	f=1MHz		6.0		Ω
Turn-on delay time	t _{d(on)}	V _{DD} =-10V , R _L =10Ω , I _D =-1A V _{GEN} =-4.5V R _g =1Ω		11	20	nS
Rise time	t _r			35	60	
Turn-off delay time	t _{d(off)}			30	50	
Fall time	t _f			10	20	
Drain-source body diode characteristics						
Continuous source-drain diode current	I _S	T _C =25°C			-1.3	A
Pulse diode forward current (Note a)	I _{SM}				-10	
Body diode voltage	V _{SD}	I _S =-0.7A		-0.8	-1.2	V

Notes:

- Pulse test: Pulse width <300μs, Duty cycle ≤ 2%
- Guaranteed by design, not subject to production testing.

RATING AND CHARACTERISTIC CURVES (CJ2301-HF)

Fig.1 - Output Characteristics

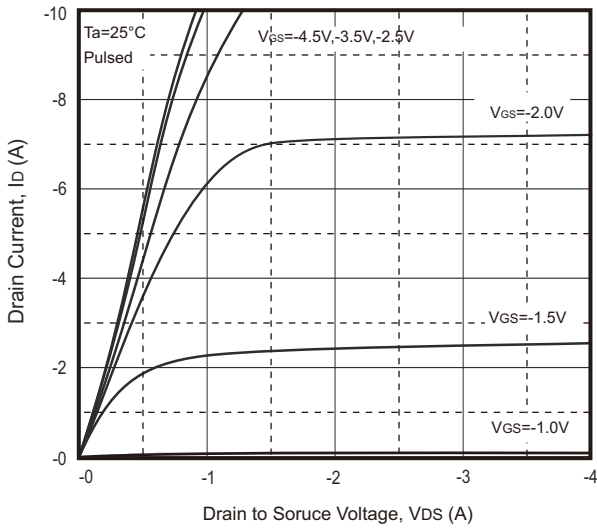

Fig.2 - Transfer Characteristics

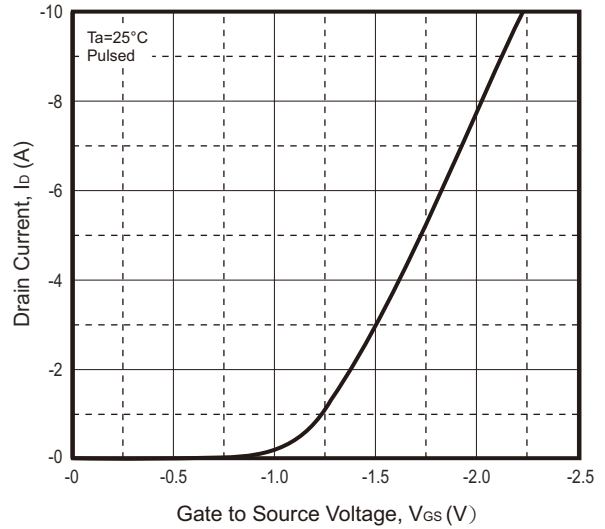

Fig.3 - $R_{DS(ON)} - I_D$

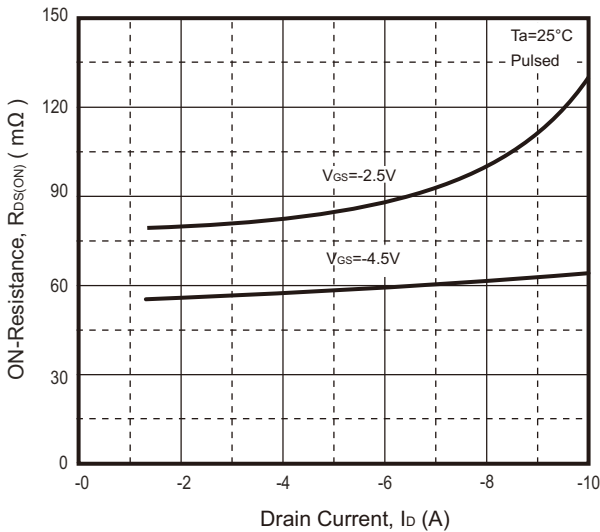

Fig.4 - $R_{DS(ON)} - V_{GS}$

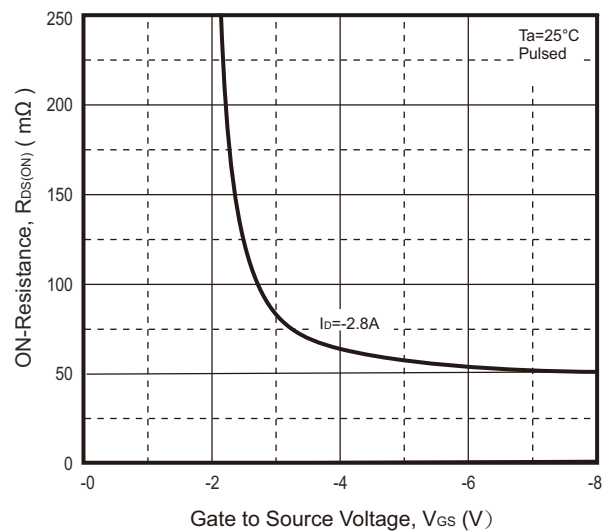
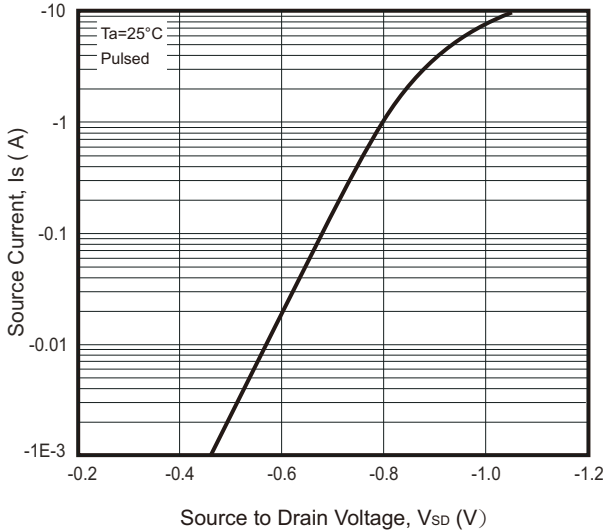
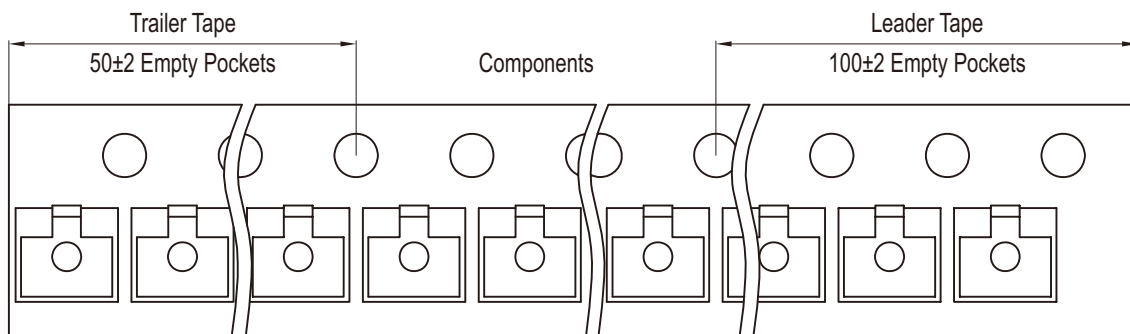
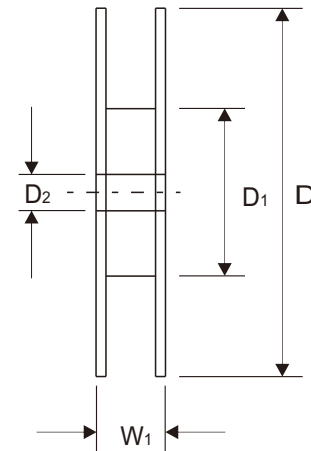
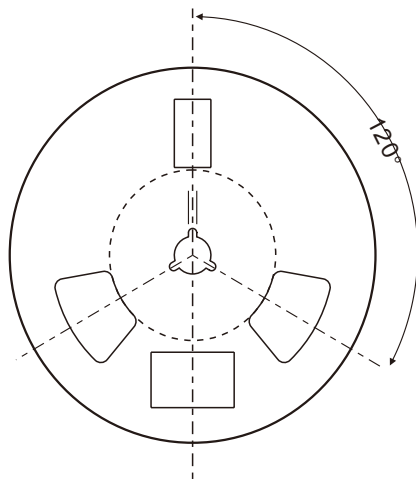
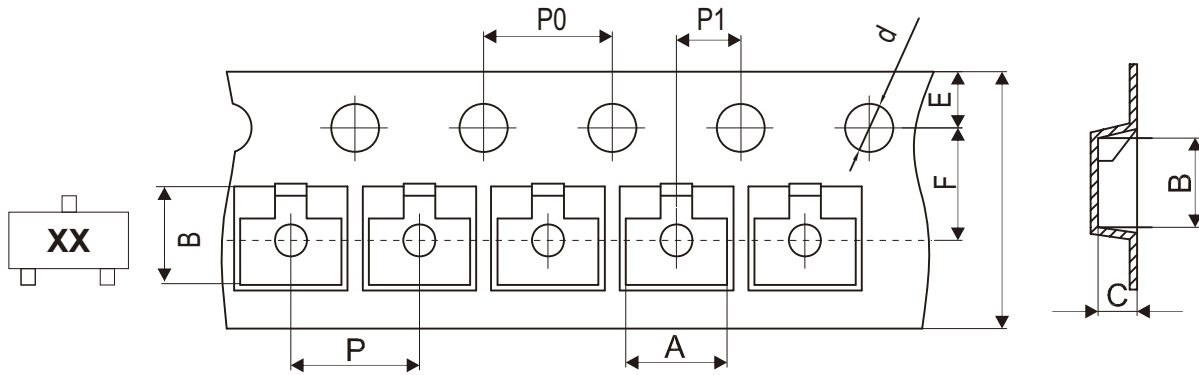

Fig.5 - $I_S - V_{SD}$



Reel Taping Specification



SOT-23	SYMBOL	A	B	C	d	D	D1	D2
	(mm)	3.15 ± 0.10	2.77 ± 0.10	1.22 ± 0.10	1.50 ± 0.10	178.00 ± 2.00	54.40 ± 1.00	13.00 ± 1.00
	(inch)	0.124 ± 0.004	0.109 ± 0.004	0.048 ± 0.004	0.059 ± 0.004	7.008 ± 0.079	2.142 ± 0.039	0.512 ± 0.039

SOT-23	SYMBOL	E	F	P	P0	P1	W	W1
	(mm)	1.75 ± 0.10	3.50 ± 0.10	4.00 ± 0.10	4.00 ± 0.10	2.00 ± 0.10	8.00 + 0.30 / - 0.10	12.30 ± 1.00
	(inch)	0.069 ± 0.004	0.138 ± 0.004	0.157 ± 0.004	0.157 ± 0.004	0.079 ± 0.004	0.315 + 0.012 / - 0.004	0.484 ± 0.039

Company reserves the right to improve product design , functions and reliability without notice.

Marking Code

Part Number	Marking Code
CJ2301-HF	S1

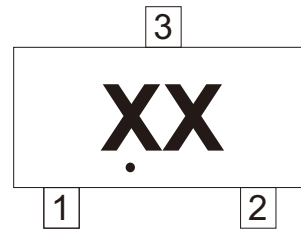

xx = Product type marking code

Suggested PAD Layout

SIZE	SOT-23	
	(mm)	(inch)
A	0.80	0.031
B	0.60	0.024
C	1.90	0.075
D	2.02	0.080
E	2.82	0.111

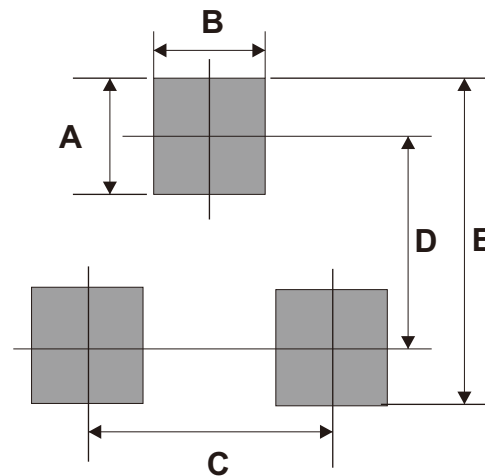

Standard Packaging

Case Type	Qty Per Reel	Reel Size
	(Pcs)	(inch)
SOT-23	3,000	7

X-ON Electronics

Largest Supplier of Electrical and Electronic Components

Click to view similar products for [MOSFET](#) category:

Click to view products by [Comchip](#) manufacturer:

Other Similar products are found below :

[IRFD120](#) [JANTX2N5237](#) [BUK455-60A/B](#) [BUZ80](#) [MIC4420CM-TR](#) [VN1206L](#) [NDP4060](#) [SI4482DY](#) [IPS70R2K0CEAKMA1](#) [SQD23N06-31L-GE3](#) [TK16J60W,S1VQ\(O](#) [2SK2614\(TE16L1,Q\)](#) [DMN1017UCP3-7](#) [DMN1053UCP4-7](#) [SQJ469EP-T1-GE3](#) [NTE2384](#)
[DMC2700UDMQ-7](#) [DMN2080UCB4-7](#) [DMN61D9UWQ-13](#) [US6M2GTR](#) [DMN31D5UDJ-7](#) [DMP22D4UFO-7B](#) [DMN1006UCA6-7](#)
[DMN16M9UCA6-7](#) [STF5N65M6](#) [IRF40H233XTMA1](#) [STU5N65M6](#) [DMN6022SSD-13](#) [DMN13M9UCA6-7](#) [DMTH10H4M6SPS-13](#)
[DMN2990UFB-7B](#) [IPB80P04P405ATMA2](#) [2N7002W-G](#) [MCAC30N06Y-TP](#) [MCQ7328-TP](#) [NTMC083NP10M5L](#) [NVMFS2D3P04M8LT1G](#)
[BXP7N65D](#) [BXP4N65F](#) [AOL1454G](#) [WMJ80N60C4](#) [BXP2N20L](#) [BXP2N65D](#) [BXT1150N10J](#) [BXT1700P06M](#) [TSM60NB380CP](#) [ROG](#)
[RQ7L055BGTGR](#) [DMNH15H110SK3-13](#) [SLF10N65ABV2](#) [BSO203SP](#)