

HER301G-G Thru. HER308G-G

Voltage: 50 to 1000 V

Current: 3.0 A

RoHS Device

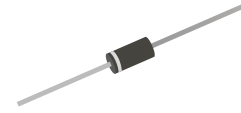

Features

- Glass passivated chip.
- Low forward voltage.
- High reliability.
- High surge current capability.
- High speed switching.

Mechanical data

- Case: JEDEC DO-27 molded plastic.
- Epoxy: UL 94V-0 rate flame retardant.
- Polarity: Color band denotes cathode end.
- Lead: Solderable per MIL-STD-202, method 208 guaranteed.
- Mounting position: Any
- Weight: 0.844 grams

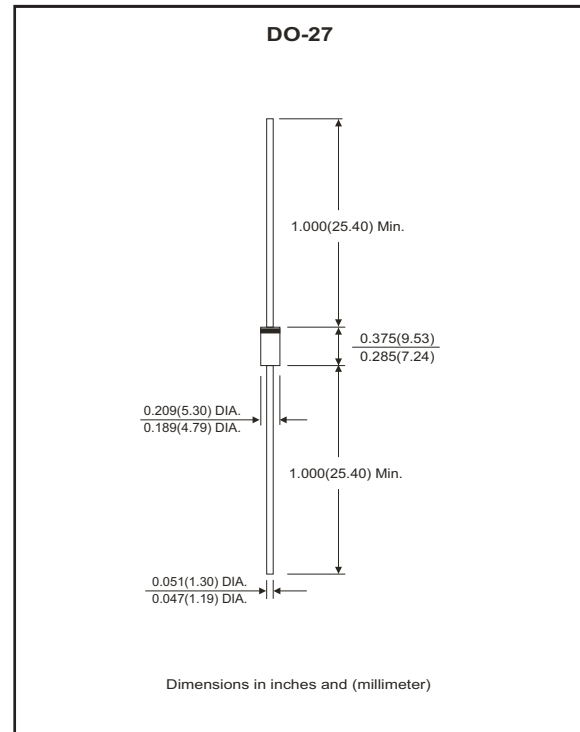

Electrical Characteristics (at $T_A=25^\circ\text{C}$ unless otherwise noted)

Ratings at 25°C ambient temperature unless otherwise specified.

Single phase, half wave, 60Hz, resistive or inductive load.

For capacitive load derate current by 20%.

Parameter	Symbol	HER 301G-G	HER 302G-G	HER 303G-G	HER 304G-G	HER 305G-G	HER 306G-G	HER 307G-G	HER 308G-G	Unit
Maximum repetitive peak reverse voltage @ $I_T = 5\mu\text{A}$	V_{RRM}	50	100	200	300	400	600	800	1000	V
Maximum RMS voltage	V_{RMS}	35	70	140	210	280	420	560	700	V
Maximum DC blocking voltage	V_{DC}	50	100	200	300	400	600	800	1000	V
Maximum average forward rectified current @ $T_A=25^\circ\text{C}$	$I_{(AV)}$	3.0								A
Maximum instantaneous forward voltage at specified current	V_F	1.0			1.3		1.7			V
Maximum DC reverse current	I_R	5.0								μA
Maximum reverse recovery time (Note 1)	t_{rr}	50					75			ns
Operating temperature range	T_J	-55 ~ +150								$^\circ\text{C}$
Storage temperature range	T_{STG}	-55 ~ +150								$^\circ\text{C}$

NOTES:

1. Reverse recovery test conditions: $I_F=0.5\text{A}$, $I_R=1.0\text{A}$, $I_{RR}=0.25\text{A}$ (RGI circuit)

Rating and Characteristic Curves (HER301G-G Thru. HER308G-G)

Fig.1- Forward Current Derating Curve

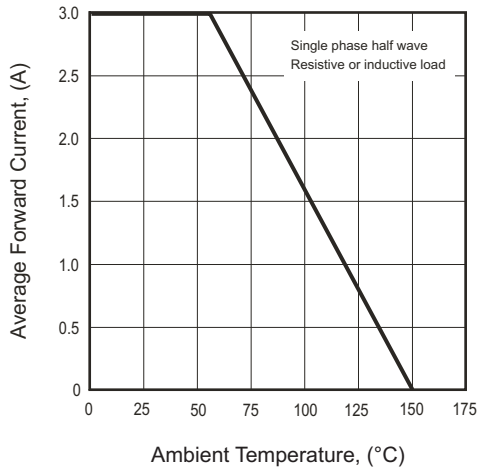

Fig.2- Typical Forward Characteristics

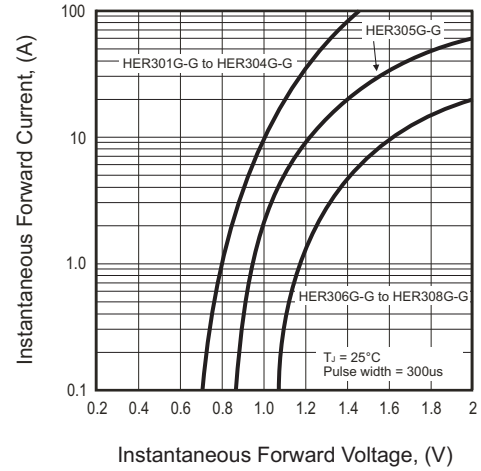

Fig.3- Peak Forward Surge Current

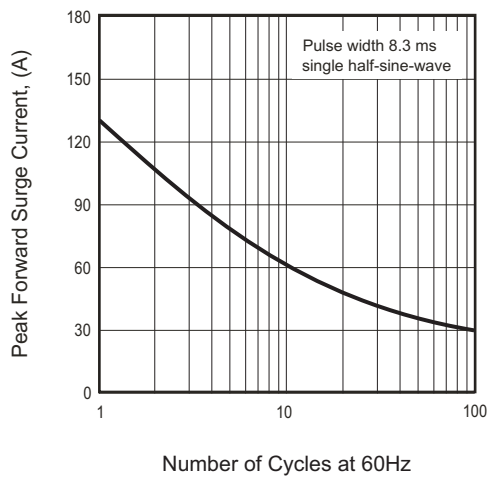
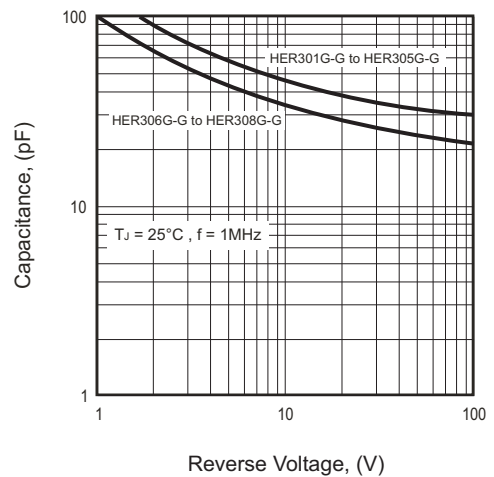
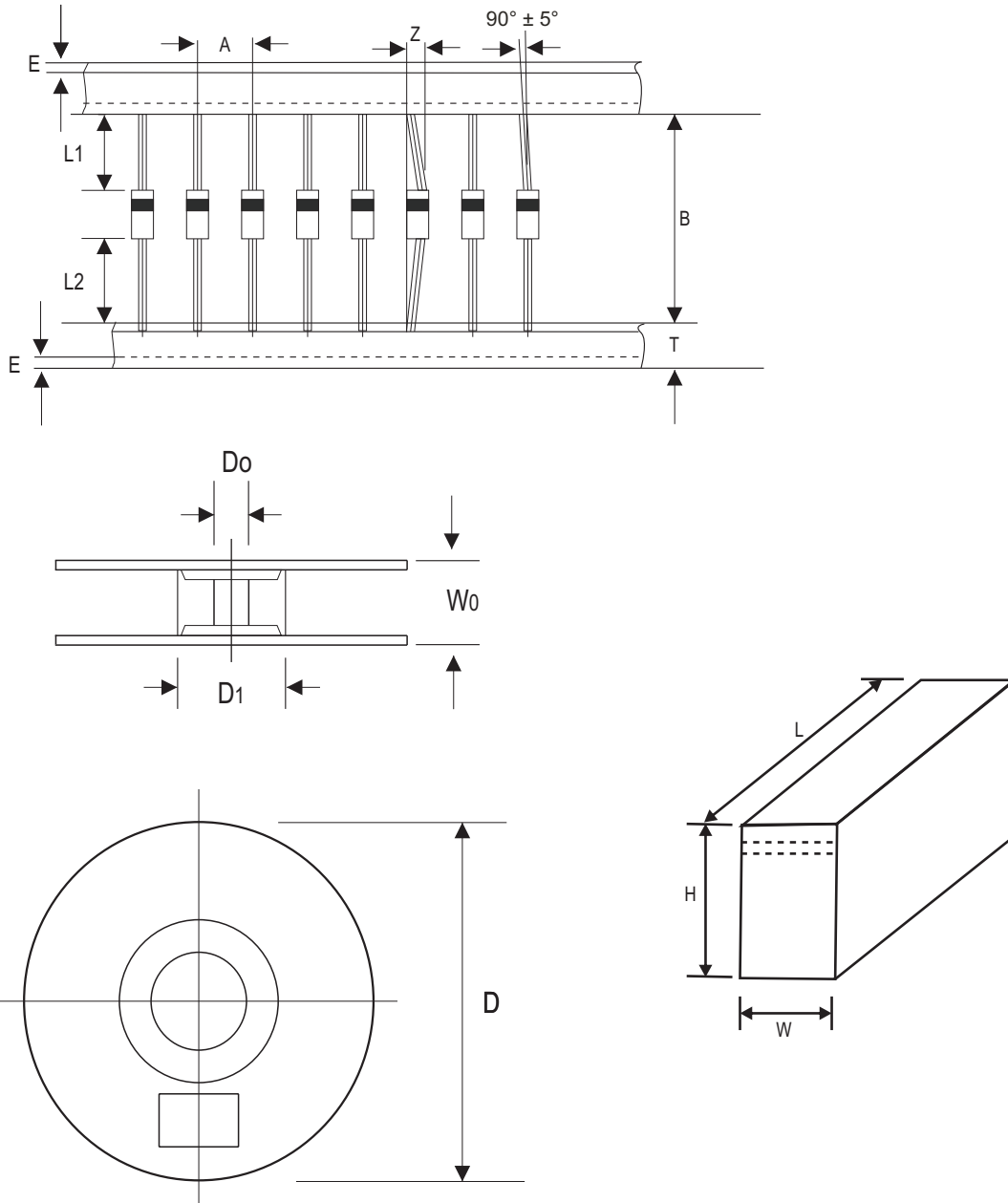

Fig.4- Typical Junction Capacitance



Taping Specification For Axial Lead Diodes



DO-27	SYMBOL	A	B	Z	T	E	L1	L2
	(mm)	10.00 ± 0.50	52.00 ± 0.50	1.20 (max)	6.00 ± 0.40	1.00 (max)	1.00 (max)	1.00 (max)
	(inch)	0.394 ± 0.020	2.047 ± 0.020	0.047 (max)	0.236 ± 0.016	0.039 (max)	0.039 (max)	0.039 (max)

DO-27	SYMBOL	D1	D0	D	W0	L	W	H
	(mm)	85.70 ± 0.30	16.60 ± 0.40	330.00	72.00 ± 3.00	260.00	75.00	145.00
	(inch)	3.374 ± 0.012	0.654 ± 0.016	13.000	2.835 ± 0.118	10.236	2.953	5.709

Marking Code

Part Number	Marking code	Packaging
HER301G-G	HER301	AMMO
HER302G-G	HER302	AMMO
HER303G-G	HER303	AMMO
HER304G-G	HER304	AMMO
HER305G-G	HER305	AMMO
HER306G-G	HER306	AMMO
HER307G-G	HER307	AMMO
HER308G-G	HER308	AMMO
HER301GB-G	HER301	BULK
HER302GB-G	HER302	BULK
HER303GB-G	HER303	BULK
HER304GB-G	HER304	BULK
HER305GB-G	HER305	BULK
HER306GB-G	HER306	BULK
HER307GB-G	HER307	BULK
HER308GB-G	HER308	BULK
HER301GT-G	HER301	REEL
HER302GT-G	HER302	REEL
HER303GT-G	HER303	REEL
HER304GT-G	HER304	REEL
HER305GT-G	HER305	REEL
HER306GT-G	HER306	REEL
HER307GT-G	HER307	REEL
HER308GT-G	HER308	REEL



XXX = Product type marking code

Note:

1) Suffix code after part number to specify packaging item .

Packaging	Code
AMMO PACK	NA
BULK PACK	B
REEL PACK	T

Standard Packaging

Case Type	AMMO PACK	
	BOX (pcs)	CARTON (pcs)
DO-27	1,200	12,000

Case Type	BULK PACK	
	BOX (pcs)	CARTON (pcs)
DO-27	200	10,000
	500	12,000

Case Type	REEL PACK	
	REEL (pcs)	Reel Size (inch)
DO-27	1,200	13

X-ON Electronics

Largest Supplier of Electrical and Electronic Components

Click to view similar products for [Rectifiers](#) category:

Click to view products by [Comchip](#) manufacturer:

Other Similar products are found below :

[70HFR40](#) [RL252-TP](#) [150KR30A](#) [1N5397](#) [NTE5841](#) [NTE6038](#) [SCF5000](#) [1N4002G](#) [1N4005-TR](#) [JANS1N6640US](#) [VS-80-7161](#) [481235F](#)
[RRE02VS6SGTR](#) [067907F](#) [MS306](#) [70HF40](#) [T85HFL60S02](#) [US2JFL-TP](#) [A1N5404G-G](#) [CRS04\(T5L,TEMQ\)](#) [ACGRA4007-HF](#)
[ACGRB207-HF](#) [CLH03\(TE16L,Q\)](#) [ACGRC307-HF](#) [ACEFC304-HF](#) [NTE6356](#) [NTE6359](#) [NTE6002](#) [NTE6023](#) [NTE6039](#) [NTE6077](#)
[85HFR60](#) [40HFR60](#) [1N1186RA](#) [70HF120](#) [85HFR80](#) [D126A45C](#) [SCF7500](#) [D251N08B](#) [SCHJ22.5K](#) [SM100](#) [SCPA2](#) [SCH10000](#) [SDHD5K](#)
[VS-12FL100S10](#) [ACGRA4001-HF](#) [D1821SH45T PR](#) [D1251S45T](#) [NTE5990](#) [NTE6358](#)