

Features

Switching	Direct
Output	MOS-FET
Input	DC
Applications	Resistive, capacitive and inductive DC loads

Technical data

WG F8...	50 D 08	60 D 10	100 D 05	200 D 03	400 D 01
Input circuit					
Control voltage range	3...32 VDC				
Control current max	25 mA				
Turn-off voltage min..	1 VDC				
Input resistance	Constant current				
Output Circuit					
Load voltage range	1...50 VDC	1...60VDC	1...100 VDC	1...200 VDC	1...400 VDC
Peak-off-state voltage	50 Vdrm	60 Vdrm	100 Vdrm	200 Vdrm	400 Vdrm
Off-state leakage Current	0,1 mA eff.				
Load current range	0...8 A	0...10A	0...5 A	0...3 A	0...1,5 A
Surge current.2ms max.	80 A	100A	50 A	35 A	15 A
On-state resistance max.	36 mΩ	25mΩ	150 mΩ	360 mΩ	1100 mΩ
General data					
Turn-on time max.	2 ms				
Turn-off time max.	0,1 ms				
PWM frequency max	250 Hz				
Isolation volt. between input/output	1.500 VDC				
Isolation resistance	50 MΩ				
Operating temperature	-20...+80 °C				
We recommend external contact protection (diode, RC-snubber) for inductive loads					

Dimensions in mm & circuit diagram

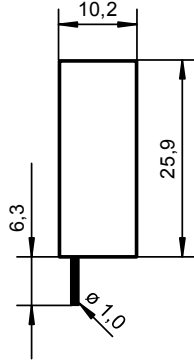
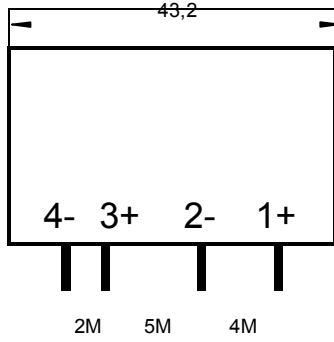

Bottom view

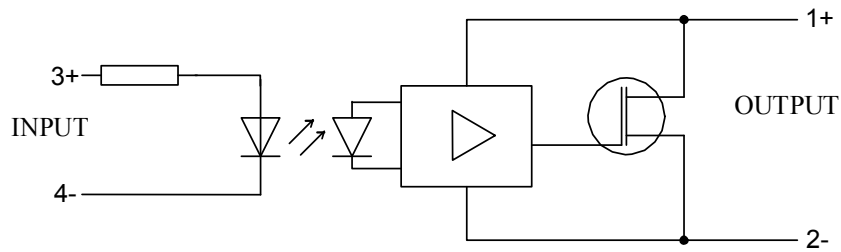
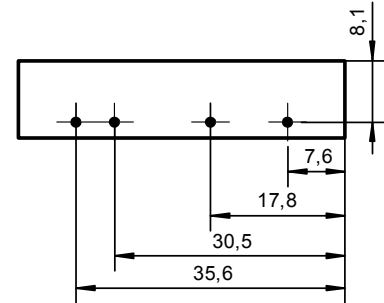

Housing specifications

Weight	Approx. 20 g
Housing material	Glass filled polyester
Potting compound	Thermally conductive epoxy
Terminals	Solder pins

Derating-diagrams

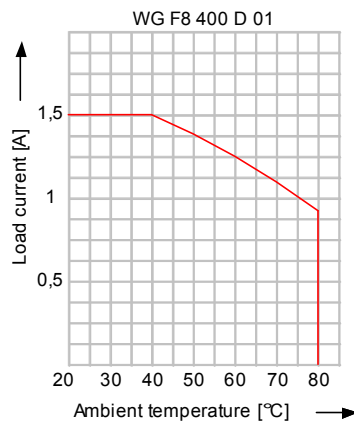
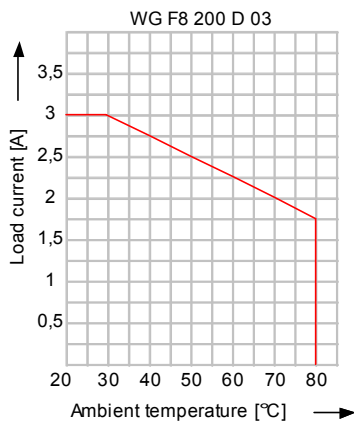
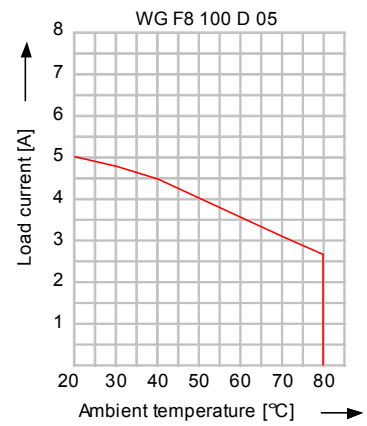
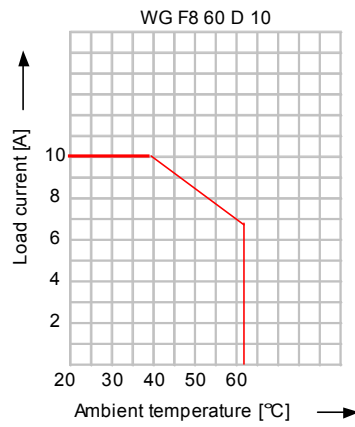
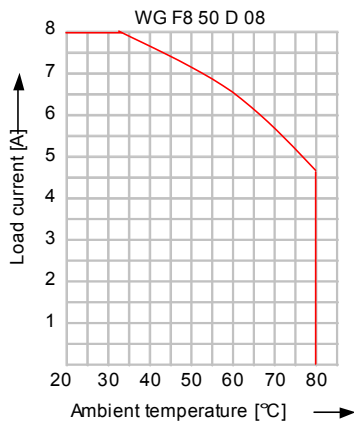

Ordering

Ordering partnumber	Voltage	Current
WG F8 50 D 8	50 VDC	0...8 A
WG F8 60 D 10	60 VDC	0...10 A
WG F8 100 D 05	100 VDC	0...5 A
WG F8 200 D 03	200 VDC	0...3 A
WG F8 400 D 01	400 VDC	0...1,5 A

X-ON Electronics

Largest Supplier of Electrical and Electronic Components

Click to view similar products for [Solid State Relays - PCB Mount](#) category:

Click to view products by [Comus](#) manufacturer:

Other Similar products are found below :

[M86F-2W](#) [M90F-2Y](#) [G2-1A07-ST](#) [G2-1A07-TT](#) [G2-1B02-TT](#) [G2-DA06-ST](#) [923812OCAS](#) [PLA134S](#) [DS11-1005](#) [AQV212J](#)
[AQY412EHAJ](#) [EFR1200480A150](#) [901-7](#) [LCA220](#) [LCB110S](#) [1618400-5](#) [SR75-1ST](#) [AQH2213AJ](#) [AQV112KLJ](#) [AQV212AJ](#) [AQV212SXJ](#)
[AQV238AD01](#) [AQW414TS](#) [AQY221N2SYD01](#) [AQY221R2VJ](#) [AQY275AXJ](#) [AQY414SXE01](#) [G2-1A02-ST](#) [G2-1A03-ST](#) [G2-1A03-TT](#)
[G2-1A05-ST](#) [G2-1A06-TT](#) [G2-1A23-TT](#) [G2-1B01-ST](#) [G2-1B01-TT](#) [G2-1B02-ST](#) [G2-DA03-ST](#) [G2-DA03-TT](#) [G2-DA06-TT](#) [CPC1333GR](#)
[3-1617776-2](#) [CTA2425](#) [TLP3131\(F\)](#) [LBA110S](#) [LBB110S](#) [LCA110LSTR](#) [LCB126S](#) [WPPM-0626D](#) [WPPM-3526D](#) [WPPM-3588D](#)