

# TYPE C/2

Male connector – straight and angled – 16, 32 and 48 positions

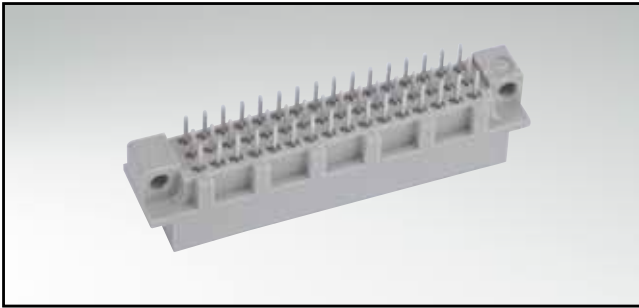

RoHS compliant

### DESCRIPTION

- Solder pin
- Quality class 3 (also available in quality class 2 or 1)
- Premating contacts in row "a", "b" and "c" available
- Special assembly on request

### PRODUCT DRAWING

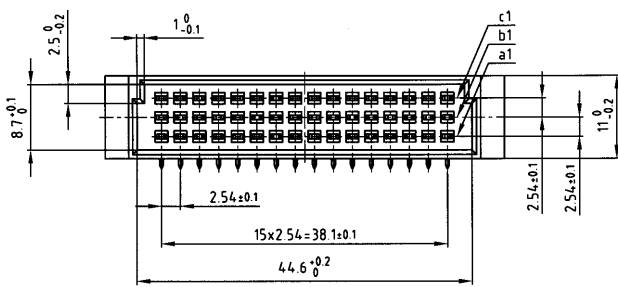

### PCB-hole pattern

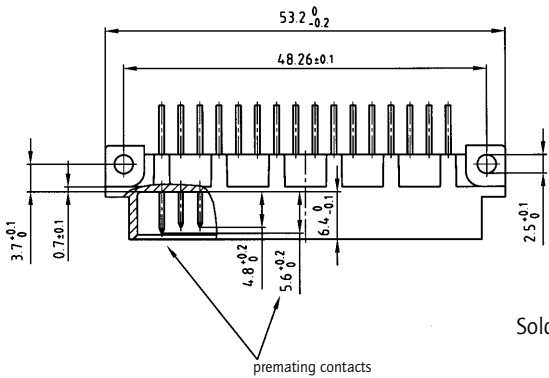
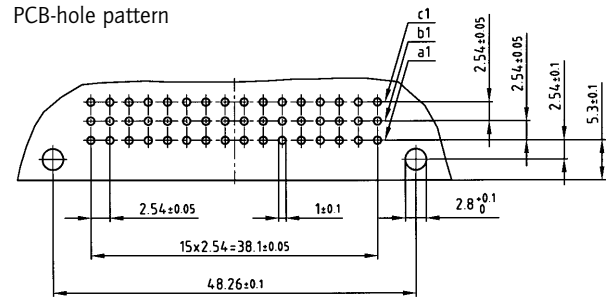

Solder pin angled

Solder pin straight

Solder pin angled with clip

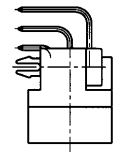
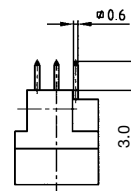
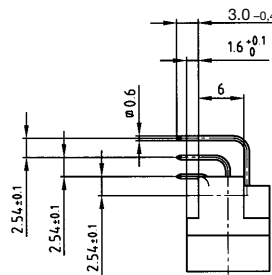

(Dim. = mm)

### ORDER DATA

| No. of Pos. | Row | • = contact, + = no contact |   |   |   |   |   | Solder pin angled | Solder pin straight | Solder pin angled with clip |
|-------------|-----|-----------------------------|---|---|---|---|---|-------------------|---------------------|-----------------------------|
|             |     | Pos.                        | 1 | 2 | 3 | 4 | 5 |                   |                     |                             |
| 16          | c   |                             | + | + | + | + | + | 121 A 10349 X     | 121 A 10399 X       | 121 A 20929 X               |
|             | b   |                             | + | + | + | + | + |                   |                     |                             |
|             | a   |                             | • | • | • | • | • |                   |                     |                             |
| 16          | c   |                             | + | • | • | • | • | 121 A 10359 X     | 121 A 10409 X       | 121 A 20939 X               |
|             | b   |                             | + | + | + | + | + |                   |                     |                             |
|             | a   |                             | + | • | • | • | • |                   |                     |                             |
| 32          | c   |                             | • | • | • | • | • | 121 A 10379 X     | 121 A 10429 X       | 121 A 20959 X               |
|             | b   |                             | + | + | + | + | + |                   |                     |                             |
|             | a   |                             | • | • | • | • | • |                   |                     |                             |
| 48          | c   |                             | • | • | • | • | • | 121 A 10389 X     | 121 A 10439 X       | 121 A 20969 X               |
|             | b   |                             | • | • | • | • | • |                   |                     |                             |
|             | a   |                             | • | • | • | • | • |                   |                     |                             |

Clip for hole diameter 2.8 + 0.1 mm, PCB thickness = 1.6 mm

## X-ON Electronics

Largest Supplier of Electrical and Electronic Components

*Click to view similar products for [DIN 41612 Connectors](#) category:*

*Click to view products by [CONEC](#) manufacturer:*

Other Similar products are found below :

[004.767](#) [608489050008049](#) [691327-1](#) [74670-0732](#) [74680-0340](#) [75880-0015](#) [76453-0014](#) [86093159ALF](#) [9732967801](#) [QLC260R](#)  
[120X10019X](#) [120X10089X](#) [122A10249X](#) [122A11089X](#) [122A13089X](#) [122A10089X](#) [122A10129X](#) [122A10349X](#) [122A13359X](#) [1377391-4](#)  
[DIN-048CPC-SR1-MH](#) [1393583-2](#) [1393726-7](#) [140X10129X](#) [143-1913-000](#) [143-1908-000](#) [1484472-1](#) [2110070-1](#) [2110070-2](#) [CBC20T00-](#)  
[008FDS5-0-1-002VR](#) [172699-5036](#) [2-1393557-4](#) [2-1437084-2](#) [394506](#) [419-2080-402](#) [419-2085-302](#) [V42254B2202C968](#) [419-2086-201](#) [419-](#)  
[2087-002](#) [448657-1](#) [448847-3](#) [5-1393755-9](#) [02990000004](#) [033020](#) [043619](#) [054302](#) [043556](#) [0760557108](#) [09062483201750](#) [0850033067](#)