

| | |
|--|------------|
| plating item 1 | part no. |
| GOLD FLASH over NICKEL | 131A12059X |
| 30µin HARD GOLD over min. 50µin NICKEL | 131C12059X |

| | | | | |
|-----|-----|----------------|--------------|---------------|
| 3 | 1 | RETAINING RING | COPPER ALLOY | NICKEL PLATED |
| 2 | 1 | REAR SIDE | COPPER ALLOY | TIN PLATED |
| 1 | 1 | MATING SIDE | COPPER ALLOY | SEE TABLE |
| pos | qty | description | material | plating |

| | | | | | | | | |
|---|----------|--|-------|-------------|------------|--------------|---|--------------|
| THIS DRAWING MAY NOT BE COPIED OR REPRODUCED IN ANY WAY, AND MAY NOT BE PASSED ON TO A THIRD PARTY WITHOUT WRITTEN PERMISSION. OWNERSHIP AND COPYRIGHT OF CONEC GmbH DO NOT ALTER CAD DRAWING BY HAND | partlist | | | tolerance | dim. in mm | scale: | 10:1 | |
| | | | | date | | name | material: | see partlist |
| | | | | drawn | 23.03.1998 | Barcinski | HIGH POWER CONTACT MALE SOLDER PIN STRAIGHT / d=3,75 / 40A D-SUB COMBINATION | |
| | | | | appd. | 23.03.1998 | Mickenbecker | | |
| | | | | norm | | | | |
| | | | | d-old | | | dwg no: | |
| | | | 3 x b | A5637 | 05.05.15 | M.H. | | DIN-A3 |
| | | | rev. | description | date | name | part no: | sh: 1 |

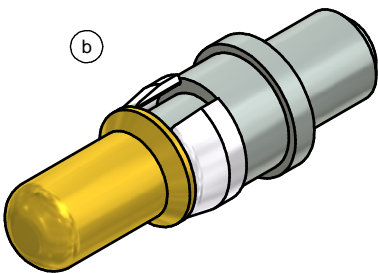

RoHS compliant

CONEC

13K11D9A

part no: see table

X-ON Electronics

Largest Supplier of Electrical and Electronic Components

Click to view similar products for [D-Sub Contacts](#) category:

Click to view products by [CONEC](#) manufacturer:

Other Similar products are found below :

[D02-22-26S-10000](#) [8656352067LF](#) [131A15029X](#) [132A11019X](#) [132J22039X](#) [132A11029X](#) [132A11049X](#) [1757912-1](#) [188582-000](#)
[162A11889X](#) [1757913-1](#) [212558-1](#) [030-1955-000](#) [053744-0098](#) [053744-0099](#) [053745-0105](#) [053745-0111](#) [601098N003](#) [86303057NLF](#)
[131A11019X](#) [162A11819X](#) [40-9854MP](#) [1-208778-5](#) [FC120N2](#) [MC7526D/AA](#) [MC8122D/AA](#) [FC4010D-15](#) [FC4006D](#) [121A05329A](#)
[164C16669X](#) [86566620064LF](#) [C330-8997-101H](#) [131A13019X](#) [DLS3XS5AK40X](#) [09692825723](#) [030-1954-000](#) [L17DM53744207](#)
[L17RRD1M11400](#) [030-1952-000](#) [1655496](#) [030-1953-000](#) [030-1953-030](#) [132C11039X](#) [132J15019X](#) [132C15019X](#) [132C11019X](#)
[131A10029X](#) [8638PSC2006LF](#) [8656453067LF](#) [86566520064LF](#)