

Shellsize	A	B	C	Ø D	E	F	* G ± 1	Cable Ø	Part-No.
2	48	33,3	22 A/F	25	36	21	54,6	9 - 11	15-004670
3	62	47,04	24 A/F	27	44	21	67,7	10 - 12	15-004680
4	78	63,5	28 A/F	31	53	25,2	77,2	14 - 16	15-004690
5	75,6	61,1	28 A/F	31	53	23,8	77,2	14 - 16	15-004700

(1:1)

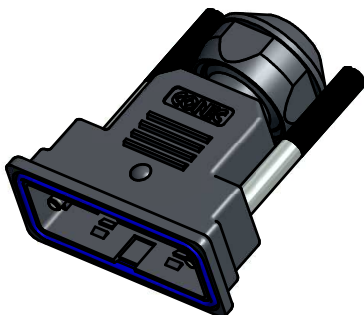

* COMPLETELY TIGHTENED

NOTES:

- MATERIALS:
HOOD: PBT GF UL94 V-0 BLACK
FRONTSEALING: SILICONE VMQ BLUE
SCREW: STAINLESS STEEL
O-RING: NBR BLACK
- TEMPERATURE RANGE: -30°C TO +90°C
- RECOMMENDED TORQUE FOR SCREW:
35Ncm (3.1 in.LB)
MAX. TORQUE: 68Ncm (6 in.LB)
- SINGLE PACKED

Directive 2002/95/EC RoHS compliant

THIS DRAWING MAY NOT BE COPIED OR REPRODUCED IN ANY WAY, AND MAY NOT BE PASSED ON TO A THIRD PARTY WITHOUT WRITTEN PERMISSION. OWNERSHIP AND COPYRIGHT OF CONEC GmbH DO NOT ALTER CAD DRAWING BY HAND	tolerance ± 0,3 unless otherw. specified		dim. in mm		scale: 1,5:1 (1:1)
	date		name		material: SEE NOTES
	drawn	19.09.12	Huether		title: WATER RESISTANT D-SUB HOOD 15-50 POS. JACKSCREW 4-40UNC STAINLESS STEEL
	appd.	11.10.12	Kuehle		
	norm				
	d-old				dwg no:
a	Origin			15K1A1152	DIN-A3
rev.	description			date	name

X-ON Electronics

Largest Supplier of Electrical and Electronic Components

Click to view similar products for [D-Sub Tools & Hardware](#) category:

Click to view products by [CONEC](#) manufacturer:

Other Similar products are found below :

[000-01-09-132](#) [000-01-21-132](#) [000-01-31-162](#) [572019-00105-70](#) [000-01-37-162](#) [621-250-113-115](#) [D110550-2](#) [D20418-137](#) [780-518-50SG6-WS](#) [86552009](#) [86553115TLF](#) [86553117TLF](#) [1230032-1](#) [1-5021101-2](#) [1589283-4](#) [160-000-005R031](#) [16-000230](#) [160-025-004R031](#) [160-000-137R000](#) [160-020-209R000](#) [164C03939A](#) [177-505-A-2-2](#) [1-966830-8](#) [21018-6](#) [21028-2](#) [2-1393560-9](#) [JS-1000](#) [L17D204182M3E](#) [L17D53018](#) [300X10779X](#) [160X10189X](#) [160X10419X](#) [160X10959X](#) [162-000-050R000](#) [21018-5](#) [212561-3](#) [248C21550X](#) [CF15P](#) [QLOCKPOST-2](#) [D110277](#) [500-008NF1K-01](#) [500-008NF3R3KS-01](#) [500-017M09FN](#) [500-017M15MHN](#) [500-024M1](#) [500-068M3](#) [5-1393561-5](#) [C115373-0001](#) [C115373-0002](#) [3342-4-KIT](#)