

used for: D-SUB

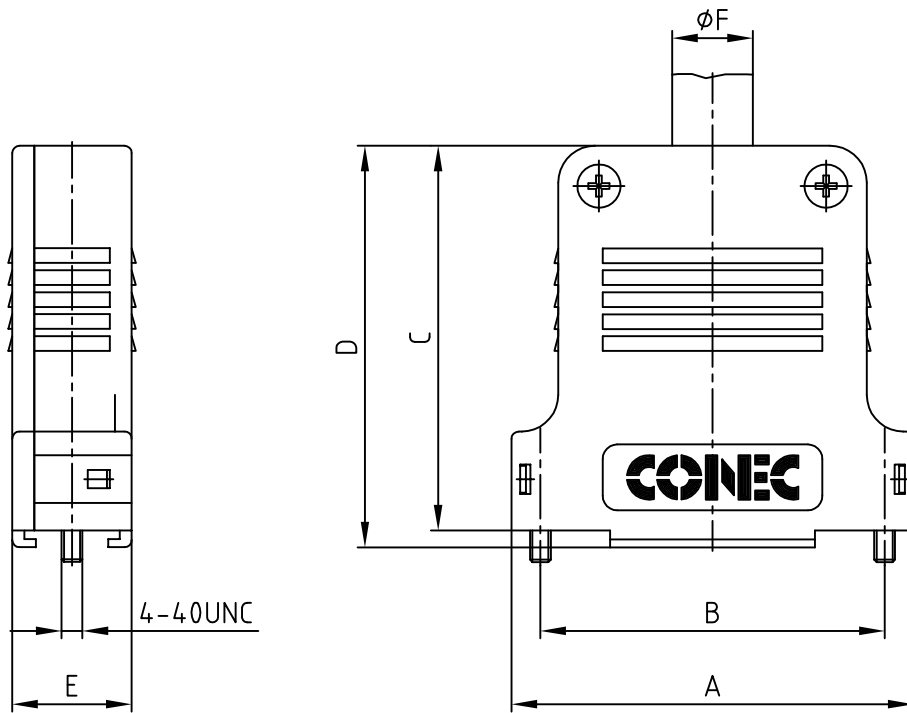

No. of pos.	A	B	C	D	E	ØF	Part-NO.	
9	32.9	25.0	39.5	41.8	16.3	11.0	165X13369X	600X10009XS
15	41.2	33.3	45.5	47.8	16.3	11.0	165X13379X	600X10015XS
25	54.9	47.0	52.5	54.8	16.3	12.0	165X13389X	600X10025XS
37	71.4	63.5	55.0	57.8	18.7	15.0	165X13399X	
50	69.0	61.1	55.0	57.8	19.5	14.0	165X13409X	

(b)

APPROVAL # FREIGABE # DEBLOCAGE # AUTORIZACION # APPROVAL

CUSTOMER APPROVAL DATE:

NAME: TITLE:

COMPANY NAME:

APPROVAL # FREIGABE # DEBLOCAGE # AUTORIZACION # APPROVAL

TECHNICAL DATA:
 MATERIAL: PBT UL 94 V-0
 COLOUR: BLACK
 TEMPERATURE RANGE: -55°C to + 140°C

(b) Directive 2002/95/EC RoHS compliant

THIS DRAWING MAY NOT BE COPIED OR REPRODUCED IN ANY WAY, AND MAY NOT BE PASSED ON TO A THIRD PARTY WITHOUT WRITTEN PERMISSION.
 OWNERSHIP AND COPYRIGHT OF CONEC GmbH
 DO NOT ALTER CAD DRAWING BY HAND

tolerance		scale: 1:1	
2002	date	material: SEE TECHNICAL DATA	
drawn	08.07.	title: PLASTIC HOOD	
appd.	08.07.	9-50pos.	
norm	E. Mickenbecker	with straight cable exit	
d-old		dwg no: AutoCAD 2000	
2 x b	Ä5307	DIN-A	
a	Original	4	
rev.	description	sh: 1/1	
	date	part no: SEE TABLE	
	name		



X-ON Electronics

Largest Supplier of Electrical and Electronic Components

Click to view similar products for [D-Sub Backshells](#) category:

Click to view products by [CONEC](#) manufacturer:

Other Similar products are found below :

[M85049/6-38N](#) [M85049/86-12N03](#) [M85049/90-13P03](#) [70.350.0636.4](#) [70.350.2435.1](#) [72.350.1035.2](#) [72.352.2435.1](#) [73.359.4035.3](#) [829472-1](#)
[PCS-E20W](#) [970-015-040R011](#) [970-025-040R011](#) [971-009-030R121](#) [971-009-040R011](#) [971-015-040R011](#) [1437013-9](#) [1484402-8](#) [156-3025-](#)
[EX](#) [16-500800](#) [165X02659X](#) [165X03329A](#) [165X03399A](#) [165X10259X](#) [165X11759X](#) [165X11889X](#) [165X13019X](#) [165X13029X](#)
[165X13169X](#) [165X13199X](#) [165X13239X](#) [165X13389X](#) [165X13489X](#) [165X14219X](#) [165X14449X](#) [165X17409X](#) [165X17439X](#)
[165X17569X](#) [165X17599X](#) [165X17609X](#) [165X17889X](#) [165X17979X](#) [L171373](#) [971-025-030R121](#) [300X10989X](#) [165X02609X](#)
[165X02639X](#) [165X02689X](#) [165X04219A](#) [165X10469X](#) [165X11279X](#)