

C-FILTER D-SUB STANDARD

Solder pin – Straight – Precision machined contacts



RoHS compliant – CSA listed, File No.: LR 115000-1 – UL listed, File No.: E202784

DESCRIPTION

- Mounting styles:
 - with 4-40 UNC or M3 threaded rear spacer
 - with 4-40 UNC or M3 front and threaded rear spacer
- Quality class 3 (also available in quality class 1)
- Shell: Steel tin plated (brass tin plated on request)

SOCKET CONNECTOR

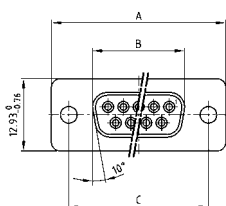

No. of pos.	A -0.76	B -0.25	C
09	31.19	16.46	25.00 ^{+0.12} / _{-0.13}
15	39.52	24.79	33.30 ^{+0.15} / _{-0.10}
25	53.42	38.50	47.04 ^{+0.13} / _{-0.10}
37	69.70	54.96	63.50 ^{+0.13} / _{-0.10}
50	67.31	52.55	61.10 ^{+0.14} / _{-0.11}

PCB layout: Kat1kFUA

Mounting style: Threaded rear spacer

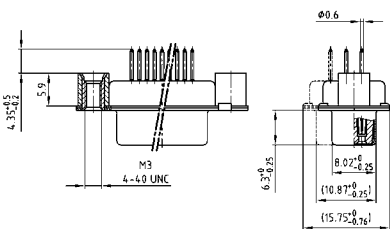

Mounting style: Threaded rear spacer, front spacer

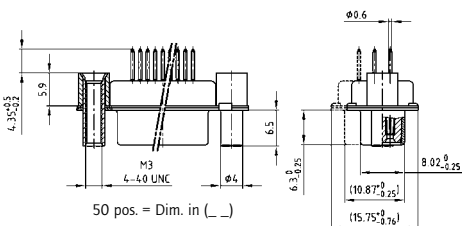

PLUG CONNECTOR

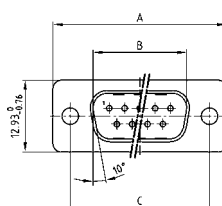

No. of pos.	A -0.76	B -0.25	C	D -0.3
09	31.19	16.79	25.00 ^{+0.12} / _{-0.13}	6.12
15	39.52	25.12	33.30 ^{+0.15} / _{-0.10}	6.12
25	53.42	38.84	47.04 ^{+0.13} / _{-0.10}	5.99
37	69.70	55.30	63.50 ^{+0.13} / _{-0.10}	5.99
50	67.31	52.68	61.10 ^{+0.14} / _{-0.11}	5.99

PCB layout: Kat1kFUA

Mounting style: Threaded rear spacer

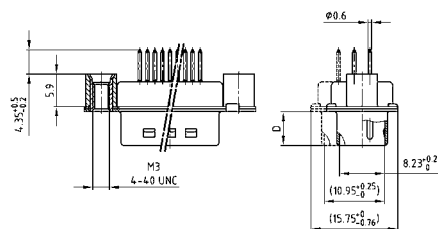

Mounting style: Threaded rear spacer, front spacer

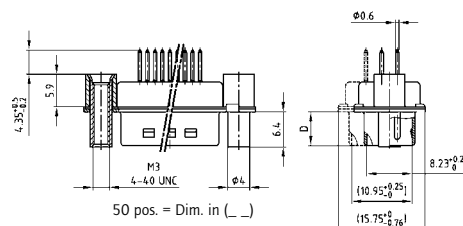

ORDER DATA

Capacitance 180 pF

SOCKET CONNECTOR

No. of pos.	Mounting style	Part Number
09	4-40 UNC Threaded rear spacer	242 A 16210 X
15	4-40 UNC Threaded rear spacer	242 A 16220 X
25	4-40 UNC Threaded rear spacer	242 A 16230 X
37	4-40 UNC Threaded rear spacer	242 A 16240 X
50	4-40 UNC Threaded rear spacer	242 A 16250 X
09	M3 Threaded rear spacer	242 A 16260 X
15	M3 Threaded rear spacer	242 A 16270 X
25	M3 Threaded rear spacer	242 A 16280 X
37	M3 Threaded rear spacer	242 A 16290 X
50	M3 Threaded rear spacer	242 A 16300 X
09	4-40 UNC Front / Threaded rear spacer	242 A 16310 X
15	4-40 UNC Front / Threaded rear spacer	242 A 16320 X
25	4-40 UNC Front / Threaded rear spacer	242 A 16330 X
37	4-40 UNC Front / Threaded rear spacer	242 A 16340 X
50	4-40 UNC Front / Threaded rear spacer	242 A 16350 X
09	M3 Front / Threaded rear spacer	242 A 16360 X
15	M3 Front / Threaded rear spacer	242 A 16370 X
25	M3 Front / Threaded rear spacer	242 A 16380 X
37	M3 Front / Threaded rear spacer	242 A 16390 X
50	M3 Front / Threaded rear spacer	242 A 16400 X

PLUG CONNECTOR

No. of pos.	Mounting style	Part Number
09	4-40 UNC Threaded rear spacer	241 A 18830 X
15	4-40 UNC Threaded rear spacer	241 A 18840 X
25	4-40 UNC Threaded rear spacer	241 A 18850 X
37	4-40 UNC Threaded rear spacer	241 A 18860 X
50	4-40 UNC Threaded rear spacer	241 A 18870 X
09	M3 Threaded rear spacer	241 A 18880 X
15	M3 Threaded rear spacer	241 A 18890 X
25	M3 Threaded rear spacer	241 A 18900 X
37	M3 Threaded rear spacer	241 A 18910 X
50	M3 Threaded rear spacer	241 A 18920 X
09	4-40 UNC Front / Threaded rear spacer	241 A 18930 X
15	4-40 UNC Front / Threaded rear spacer	241 A 18940 X
25	4-40 UNC Front / Threaded rear spacer	241 A 18950 X
37	4-40 UNC Front / Threaded rear spacer	241 A 18960 X
50	4-40 UNC Front / Threaded rear spacer	241 A 18970 X
09	M3 Front / Threaded rear spacer	241 A 18980 X
15	M3 Front / Threaded rear spacer	241 A 18990 X
25	M3 Front / Threaded rear spacer	241 A 19000 X
37	M3 Front / Threaded rear spacer	241 A 19010 X
50	M3 Front / Threaded rear spacer	241 A 19020 X

C-FILTER D-SUB STANDARD

Solder pin – Straight – Precision machined contacts

ORDER DATA

Capacitance 370 pF			
SOCKET CONNECTOR			PLUG CONNECTOR
No. of pos.	Mounting style	Part Number	Part Number
09	4-40 UNC Threaded rear spacer	242 A 10370 X	241 A 10370 X
15	4-40 UNC Threaded rear spacer	242 A 10380 X	241 A 10380 X
25	4-40 UNC Threaded rear spacer	242 A 10390 X	241 A 10390 X
37	4-40 UNC Threaded rear spacer	242 A 10400 X	241 A 10400 X
50	4-40 UNC Threaded rear spacer	242 A 15670 X	241 A 15780 X
09	M3 Threaded rear spacer	242 A 10490 X	241 A 10490 X
15	M3 Threaded rear spacer	242 A 10500 X	241 A 10500 X
25	M3 Threaded rear spacer	242 A 10510 X	241 A 10510 X
37	M3 Threaded rear spacer	242 A 10520 X	241 A 10520 X
50	M3 Threaded rear spacer	242 A 15700 X	241 A 15810 X
09	4-40 UNC Front / Threaded rear spacer	242 A 10610 X	241 A 10610 X
15	4-40 UNC Front / Threaded rear spacer	242 A 10620 X	241 A 10620 X
25	4-40 UNC Front / Threaded rear spacer	242 A 10630 X	241 A 10630 X
37	4-40 UNC Front / Threaded rear spacer	242 A 10640 X	241 A 10640 X
50	4-40 UNC Front / Threaded rear spacer	242 A 15730 X	241 A 15840 X
09	M3 Front / Threaded rear spacer	242 A 10730 X	241 A 10730 X
15	M3 Front / Threaded rear spacer	242 A 10740 X	241 A 10740 X
25	M3 Front / Threaded rear spacer	242 A 10750 X	241 A 10750 X
37	M3 Front / Threaded rear spacer	242 A 10760 X	241 A 10760 X
50	M3 Front / Threaded rear spacer	242 A 15760 X	241 A 15870 X

Capacitance 830 pF			
SOCKET CONNECTOR			PLUG CONNECTOR
No. of pos.	Mounting style	Part Number	Part Number
09	4-40 UNC Threaded rear spacer	242 A 10450 X	241 A 10450 X
15	4-40 UNC Threaded rear spacer	242 A 10460 X	241 A 10460 X
25	4-40 UNC Threaded rear spacer	242 A 10470 X	241 A 10470 X
37	4-40 UNC Threaded rear spacer	242 A 10480 X	241 A 10480 X
50	4-40 UNC Threaded rear spacer	242 A 15690 X	241 A 15800 X
09	M3 Threaded rear spacer	242 A 10570 X	241 A 10570 X
15	M3 Threaded rear spacer	242 A 10580 X	241 A 10580 X
25	M3 Threaded rear spacer	242 A 10590 X	241 A 10590 X
37	M3 Threaded rear spacer	242 A 10600 X	241 A 10600 X
50	M3 Threaded rear spacer	242 A 15720 X	241 A 15830 X
09	4-40 UNC Front / Threaded rear spacer	242 A 10690 X	241 A 10690 X
15	4-40 UNC Front / Threaded rear spacer	242 A 10700 X	241 A 10700 X
25	4-40 UNC Front / Threaded rear spacer	242 A 10710 X	241 A 10710 X
37	4-40 UNC Front / Threaded rear spacer	242 A 10720 X	241 A 10720 X
50	4-40 UNC Front / Threaded rear spacer	242 A 15750 X	241 A 15860 X
09	M3 Front / Threaded rear spacer	242 A 10810 X	241 A 10810 X
15	M3 Front / Threaded rear spacer	242 A 10820 X	241 A 10820 X
25	M3 Front / Threaded rear spacer	242 A 10830 X	241 A 10830 X
37	M3 Front / Threaded rear spacer	242 A 10840 X	241 A 10840 X
50	M3 Front / Threaded rear spacer	242 A 15780 X	241 A 15890 X

Capacitance 1300 pF			
SOCKET CONNECTOR			PLUG CONNECTOR
No. of pos.	Mounting style	Part Number	Part Number
09	4-40 UNC Threaded rear spacer	242 A 10410 X	241 A 10410 X
15	4-40 UNC Threaded rear spacer	242 A 10420 X	241 A 10420 X
25	4-40 UNC Threaded rear spacer	242 A 10430 X	241 A 10430 X
37	4-40 UNC Threaded rear spacer	242 A 10440 X	241 A 10440 X
50	4-40 UNC Threaded rear spacer	242 A 15680 X	241 A 15790 X
09	M3 Threaded rear spacer	242 A 10530 X	241 A 10530 X
15	M3 Threaded rear spacer	242 A 10540 X	241 A 10540 X
25	M3 Threaded rear spacer	242 A 10550 X	241 A 10550 X
37	M3 Threaded rear spacer	242 A 10560 X	241 A 10560 X
50	M3 Threaded rear spacer	242 A 15710 X	241 A 15820 X
09	4-40 UNC Front / Threaded rear spacer	242 A 10650 X	241 A 10650 X
15	4-40 UNC Front / Threaded rear spacer	242 A 10660 X	241 A 10660 X
25	4-40 UNC Front / Threaded rear spacer	242 A 10670 X	241 A 10670 X
37	4-40 UNC Front / Threaded rear spacer	242 A 10680 X	241 A 10680 X
50	4-40 UNC Front / Threaded rear spacer	242 A 15740 X	241 A 15850 X
09	M3 Front / Threaded rear spacer	242 A 10770 X	241 A 10770 X
15	M3 Front / Threaded rear spacer	242 A 10780 X	241 A 10780 X
25	M3 Front / Threaded rear spacer	242 A 10790 X	241 A 10790 X
37	M3 Front / Threaded rear spacer	242 A 10800 X	241 A 10800 X
50	M3 Front / Threaded rear spacer	242 A 15770 X	241 A 15880 X

X-ON Electronics

Largest Supplier of Electrical and Electronic Components

Click to view similar products for [D-Sub Standard Connectors](#) category:

Click to view products by [CONEC](#) manufacturer:

Other Similar products are found below :

[56F711-015](#) [012-9507-004](#) [LV242999-142T12](#) [015-0341-000](#) [015-0349-000](#) [015-0372-005](#) [015-0372-008](#) [015-8755-001](#) [020419-0104](#) [012-0467-000](#) [012-0515-000](#) [012-9507-034](#) [012-9507-114](#) [020745-0008](#) [609-25P](#) [M24308315F](#) [CT2-14S-2PCA34](#) [CT2-18-11PCAU](#) [CT2-36-15SC](#) [CT6-14S-2SC](#) [CT6E14SA7SC](#) [CT6E22-14PC](#) [CT6E22-14PS](#) [CT6E22-22PS](#) [M83513/01-FC](#) [M85049/48-3-2F](#) [6STD09PCM99B70X](#) [6STD09SCM99B30X](#) [6STD09SCT99S40X](#) [6STD15PCT99S40X](#) [6STD15SCM99B30X](#) [6STD15SCT99S40X](#) [6STF09PCM05B70X](#) [7-135760-9](#) [MC11E-10-6SN](#) [747552-3](#) [MD1-21PS](#) [MDM-15SCBRM7-F222](#) [MDM96517-699](#) [MDM96521-744](#) [MDVB1-21SL1](#) [MIK0-1-7SH003](#) [MIKQ6-7SH076](#) [MIKQ7-7PH077](#) [MIKQ7-7PH11](#) [MIKQ7-7PH32](#) [MIKQ9-7PH003](#) [MJSV-28SL61](#) [MKJ4A1F14-55S](#) [8-135760-3](#)