

C-FILTER D-SUB HIGH DENSITY

Solder pin – Straight – Precision machined contacts



RoHS compliant – CSA listed, File No.: LR 115000-1 – UL listed, File No.: E202784

DESCRIPTION

- Mounting styles:
 - with 4-40 UNC or M3 threaded rear spacer
 - with 4-40 UNC or M3 front and threaded rear spacer
- Quality class 3 (also available in quality class 1)
- Shell: Steel tin plated (brass tin plated on request)

SOCKET CONNECTOR

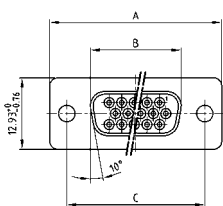

| No. of pos. | A -0.76 | B -0.25 | C |
|-------------|---------|---------|---|
| 15 | 31.19 | 16.46 | 25.00 ^{+0.12} / _{-0.13} |
| 26 | 39.52 | 24.79 | 33.30 ^{+0.15} / _{-0.10} |
| 44 | 53.42 | 38.50 | 47.04 ^{+0.13} / _{-0.13} |
| 62 | 69.70 | 54.96 | 63.50 ^{+0.13} / _{-0.13} |

PCB layout: Kat1i19A

Mounting style: Threaded rear spacer

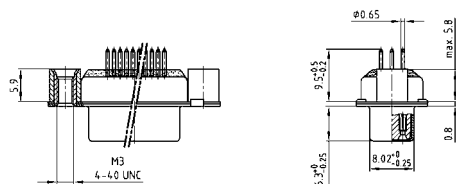

Mounting style: Front and threaded rear spacer

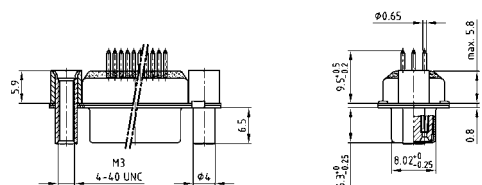

PLUG CONNECTOR

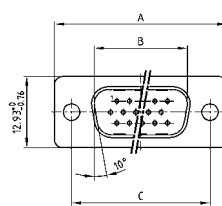

| No. of pos. | A -0.76 | B +0.25 | C | D -0.3 |
|-------------|---------|---------|---|--------|
| 15 | 31.19 | 16.79 | 25.00 ^{+0.12} / _{-0.13} | 6.12 |
| 26 | 39.52 | 25.12 | 33.30 ^{+0.15} / _{-0.10} | 6.12 |
| 44 | 53.42 | 38.84 | 47.04 ^{+0.13} / _{-0.13} | 5.99 |
| 62 | 69.70 | 55.30 | 63.50 ^{+0.13} / _{-0.13} | 5.99 |

PCB layout: Kat1iU0A

Mounting style: Threaded rear spacer

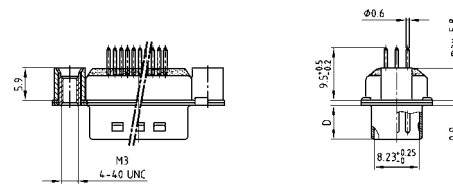

Mounting style: Front and threaded rear spacer

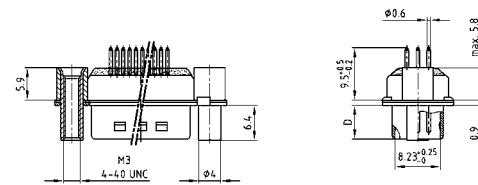

ORDER DATA

Capacitance 180 pF

| SOCKET CONNECTOR | | |
|------------------|-------------------------------------|---------------|
| No. of pos. | Mounting style | Part Number |
| 15 | 4-40 UNC Threaded rear spacer | 242 A 27500 X |
| 26 | 4-40 UNC Threaded rear spacer | 242 A 27510 X |
| 44 | 4-40 UNC Threaded rear spacer | 242 A 27520 X |
| 62 | 4-40 UNC Threaded rear spacer | 242 A 27530 X |
| 15 | M3 Threaded rear spacer | 242 A 27540 X |
| 26 | M3 Threaded rear spacer | 242 A 27550 X |
| 44 | M3 Threaded rear spacer | 242 A 27560 X |
| 62 | M3 Threaded rear spacer | 242 A 27570 X |
| 15 | 4-40 UNC Front/Threaded rear spacer | 242 A 27580 X |
| 26 | 4-40 UNC Front/Threaded rear spacer | 242 A 27590 X |
| 44 | 4-40 UNC Front/Threaded rear spacer | 242 A 27600 X |
| 62 | 4-40 UNC Front/Threaded rear spacer | 242 A 27610 X |
| 15 | M3 Front/Threaded rear spacer | 242 A 27620 X |
| 26 | M3 Front/Threaded rear spacer | 242 A 27630 X |
| 44 | M3 Front/Threaded rear spacer | 242 A 27640 X |
| 62 | M3 Front/Threaded rear spacer | 242 A 27650 X |

| PLUG CONNECTOR | | |
|----------------|-------------------------------------|---------------|
| No. of pos. | Mounting style | Part Number |
| 15 | 4-40 UNC Threaded rear spacer | 241 A 27600 X |
| 26 | 4-40 UNC Threaded rear spacer | 241 A 27610 X |
| 44 | 4-40 UNC Threaded rear spacer | 241 A 27620 X |
| 62 | 4-40 UNC Threaded rear spacer | 241 A 27630 X |
| 15 | M3 Threaded rear spacer | 241 A 27640 X |
| 26 | M3 Threaded rear spacer | 241 A 27650 X |
| 44 | M3 Threaded rear spacer | 241 A 27660 X |
| 62 | M3 Threaded rear spacer | 241 A 27670 X |
| 15 | 4-40 UNC Front/Threaded rear spacer | 241 A 27680 X |
| 26 | 4-40 UNC Front/Threaded rear spacer | 241 A 27690 X |
| 44 | 4-40 UNC Front/Threaded rear spacer | 241 A 27700 X |
| 62 | 4-40 UNC Front/Threaded rear spacer | 241 A 27710 X |
| 15 | M3 Front/Threaded rear spacer | 241 A 27720 X |
| 26 | M3 Front/Threaded rear spacer | 241 A 27730 X |
| 44 | M3 Front/Threaded rear spacer | 241 A 27740 X |
| 62 | M3 Front/Threaded rear spacer | 241 A 27750 X |

C-FILTER D-SUB HIGH DENSITY

Solder pin – Straight – Precision machined contacts

ORDER DATA

Capacitance 370 pF

| SOCKET CONNECTOR | | | PLUG CONNECTOR | | |
|------------------|-------------------------------------|---------------|----------------|-------------------------------------|---------------|
| No. of pos. | Mounting style | Part Number | No. of pos. | Mounting style | Part Number |
| 15 | 4-40 UNC Threaded rear spacer | 242 A 18220 X | 15 | 4-40 UNC Threaded rear spacer | 241 A 16620 X |
| 26 | 4-40 UNC Threaded rear spacer | 242 A 18230 X | 26 | 4-40 UNC Threaded rear spacer | 241 A 16630 X |
| 44 | 4-40 UNC Threaded rear spacer | 242 A 18240 X | 44 | 4-40 UNC Threaded rear spacer | 241 A 16640 X |
| 62 | 4-40 UNC Threaded rear spacer | 242 A 18250 X | 62 | 4-40 UNC Threaded rear spacer | 241 A 16650 X |
| 15 | M3 Threaded rear spacer | 242 A 18300 X | 15 | M3 Threaded rear spacer | 241 A 16700 X |
| 26 | M3 Threaded rear spacer | 242 A 18310 X | 26 | M3 Threaded rear spacer | 241 A 16710 X |
| 44 | M3 Threaded rear spacer | 242 A 18320 X | 44 | M3 Threaded rear spacer | 241 A 16720 X |
| 62 | M3 Threaded rear spacer | 242 A 18330 X | 62 | M3 Threaded rear spacer | 241 A 16730 X |
| 15 | 4-40 UNC Front/Threaded rear spacer | 242 A 18380 X | 15 | 4-40 UNC Front/Threaded rear spacer | 241 A 16780 X |
| 26 | 4-40 UNC Front/Threaded rear spacer | 242 A 18390 X | 26 | 4-40 UNC Front/Threaded rear spacer | 241 A 16790 X |
| 44 | 4-40 UNC Front/Threaded rear spacer | 242 A 18400 X | 44 | 4-40 UNC Front/Threaded rear spacer | 241 A 16800 X |
| 62 | 4-40 UNC Front/Threaded rear spacer | 242 A 18410 X | 62 | 4-40 UNC Front/Threaded rear spacer | 241 A 16810 X |
| 15 | M3 Front/Threaded rear spacer | 242 A 18460 X | 15 | M3 Front/Threaded rear spacer | 241 A 16860 X |
| 26 | M3 Front/Threaded rear spacer | 242 A 18470 X | 26 | M3 Front/Threaded rear spacer | 241 A 16870 X |
| 44 | M3 Front/Threaded rear spacer | 242 A 18480 X | 44 | M3 Front/Threaded rear spacer | 241 A 16880 X |
| 62 | M3 Front/Threaded rear spacer | 242 A 18490 X | 62 | M3 Front/Threaded rear spacer | 241 A 16890 X |

Capacitance 830 pF

| SOCKET CONNECTOR | | | PLUG CONNECTOR | | |
|------------------|-------------------------------------|---------------|----------------|-------------------------------------|---------------|
| No. of pos. | Mounting style | Part Number | No. of pos. | Mounting style | Part Number |
| 15 | 4-40 UNC Threaded rear spacer | 242 A 18260 X | 15 | 4-40 UNC Threaded rear spacer | 241 A 16660 X |
| 26 | 4-40 UNC Threaded rear spacer | 242 A 18270 X | 26 | 4-40 UNC Threaded rear spacer | 241 A 16670 X |
| 44 | 4-40 UNC Threaded rear spacer | 242 A 18280 X | 44 | 4-40 UNC Threaded rear spacer | 241 A 16680 X |
| 62 | 4-40 UNC Threaded rear spacer | 242 A 18290 X | 62 | 4-40 UNC Threaded rear spacer | 241 A 16690 X |
| 15 | M3 Threaded rear spacer | 242 A 18340 X | 15 | M3 Threaded rear spacer | 241 A 16740 X |
| 26 | M3 Threaded rear spacer | 242 A 18350 X | 26 | M3 Threaded rear spacer | 241 A 16750 X |
| 44 | M3 Threaded rear spacer | 242 A 18360 X | 44 | M3 Threaded rear spacer | 241 A 16760 X |
| 62 | M3 Threaded rear spacer | 242 A 18370 X | 62 | M3 Threaded rear spacer | 241 A 16770 X |
| 15 | 4-40 UNC Front/Threaded rear spacer | 242 A 18420 X | 15 | 4-40 UNC Front/Threaded rear spacer | 241 A 16820 X |
| 26 | 4-40 UNC Front/Threaded rear spacer | 242 A 18430 X | 26 | 4-40 UNC Front/Threaded rear spacer | 241 A 16830 X |
| 44 | 4-40 UNC Front/Threaded rear spacer | 242 A 18440 X | 44 | 4-40 UNC Front/Threaded rear spacer | 241 A 16840 X |
| 62 | 4-40 UNC Front/Threaded rear spacer | 242 A 18450 X | 62 | 4-40 UNC Front/Threaded rear spacer | 241 A 16850 X |
| 15 | M3 Front/Threaded rear spacer | 242 A 18500 X | 15 | M3 Front/Threaded rear spacer | 241 A 16900 X |
| 26 | M3 Front/Threaded rear spacer | 242 A 18510 X | 26 | M3 Front/Threaded rear spacer | 241 A 16910 X |
| 44 | M3 Front/Threaded rear spacer | 242 A 18520 X | 44 | M3 Front/Threaded rear spacer | 241 A 16920 X |
| 62 | M3 Front/Threaded rear spacer | 242 A 18530 X | 62 | M3 Front/Threaded rear spacer | 241 A 16930 X |

X-ON Electronics

Largest Supplier of Electrical and Electronic Components

Click to view similar products for [D-Sub High Density Connectors](#) category:

Click to view products by [CONEC](#) manufacturer:

Other Similar products are found below :

[97-3250-11](#) [163A17089X](#) [164A17199X](#) [164C18629X](#) [L717HDB44POL2R210](#) [L717HDEH15POL2](#) [L777HDE15P](#) [L77HDE15SC309](#)
[163A16759X](#) [163A16839X](#) [163A16989X](#) [163A17079X](#) [164A17329X](#) [164A18219X](#) [241A16440X](#) [241A16550X](#) [241A16680X](#)
[241A20810X](#) [241A25740X](#) [CT25-44P](#) [MDBE15PE766](#) [L177HDE15SOL2RM23](#) [L177HRC62SVFM](#) [L177HRCG62S](#)
[L717HDEG15POL2RM5](#) [L77HDA26SVF](#) [L77HDE15SD1CO](#) [L77HDEH15SOL2RM832](#) [DAMA-15S-WS](#) [443895-3](#) [106698-1](#) [280-](#)
[012K2C](#) [DBMV13H3SNA197](#) [L177HRB44S](#) [164A17039X](#) [09562004701510](#) [L777HRC62P](#) [241A17960X](#) [164A18269X](#) [280-019S1S9MEN](#)
[L777HDEG15P](#) [280-018P3S25MEGN](#) [206504-2](#) [40-9415HDSP](#) [40-9515HDSP](#) [2057140-1](#) [C115370-6002](#) [DFMA104SNMBFR172FR022](#)
[HDC9F200E2S](#) [L717HDAG26POL2RM8](#)