

π-FILTER D-SUB STANDARD

Solder pin – Straight – Precision machined contacts



RoHS compliant – CSA listed, File No.: LR 115000-1 – UL listed, File No.: E202784

DESCRIPTION

- Mounting style: with 4-40 UNC or M3 threaded rear spacer with PCB clip
- Quality class 3 (also available in quality class 1)
- Shell: Steel tin plated (brass tin plated on request)

SOCKET CONNECTOR

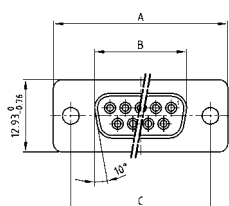

No. of pos.	A -0.76	B -0.25	C
09	31.19	16.46	25.00 ^{+0.12} / _{-0.13}
15	39.52	24.79	33.30 ^{+0.15} / _{-0.10}
25	53.42	38.50	47.04 ^{+0.13} / _{-0.13}
37	69.70	54.96	63.50 ^{+0.13} / _{-0.13}

PCB layout: Kat1kFUA

PLUG CONNECTOR

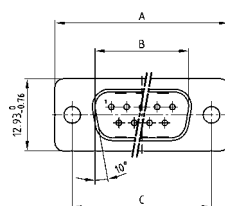

No. of pos.	A -0.76	B +0.25	C	D -0.3
09	31.19	16.79	25.00 ^{+0.12} / _{-0.13}	6.12
15	39.52	25.12	33.30 ^{+0.15} / _{-0.10}	6.12
25	53.42	38.84	47.04 ^{+0.13} / _{-0.13}	5.99
37	69.70	55.30	63.50 ^{+0.13} / _{-0.13}	5.99

PCB layout: Kat1kFUA

Mounting style: Threaded rear spacer with PCB clip

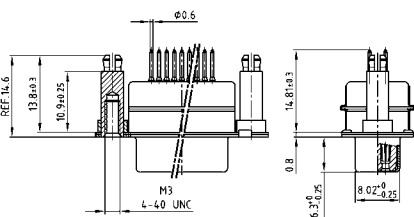

Mounting style: Threaded rear spacer with PCB clip

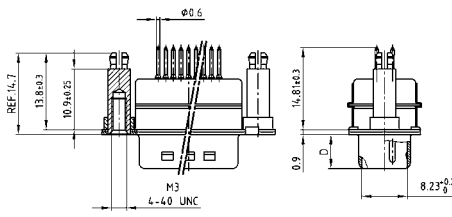

ORDER DATA

Capacitance 2 x 180 pF

SOCKET CONNECTOR

No. of pos.	Mounting style	Part Number
09	4-40 UNC Threaded rear spacer PCB clip	242 A 26260 X
15	4-40 UNC Threaded rear spacer PCB clip	242 A 26270 X
25	4-40 UNC Threaded rear spacer PCB clip	242 A 26280 X
37	4-40 UNC Threaded rear spacer PCB clip	242 A 26290 X
09	M3 Threaded rear spacer PCB clip	242 A 26420 X
15	M3 Threaded rear spacer PCB clip	242 A 26430 X
25	M3 Threaded rear spacer PCB clip	242 A 26440 X
37	M3 Threaded rear spacer PCB clip	242 A 26450 X

PLUG CONNECTOR

No. of pos.	Mounting style	Part Number
09	4-40 UNC Threaded rear spacer PCB clip	241 A 26360 X
15	4-40 UNC Threaded rear spacer PCB clip	241 A 26370 X
25	4-40 UNC Threaded rear spacer PCB clip	241 A 26380 X
37	4-40 UNC Threaded rear spacer PCB clip	241 A 26390 X
09	M3 Threaded rear spacer PCB clip	241 A 26520 X
15	M3 Threaded rear spacer PCB clip	241 A 26530 X
25	M3 Threaded rear spacer PCB clip	241 A 26540 X
37	M3 Threaded rear spacer PCB clip	241 A 26550 X

PCB clip .122"/3.1 ± .004"/0.10 mm hole diameter and .063"/1.6 mm circuit board thickness

π-FILTER D-SUB STANDARD

Solder pin – Straight – Precision machined contacts

ORDER DATA

Capacitance 2 x 370 pF

SOCKET CONNECTOR			PLUG CONNECTOR		
No. of pos.	Mounting style	Part Number	No. of pos.	Mounting style	Part Number
09	4-40 UNC Threaded rear spacer PCB clip	242 A 26300 X	09	4-40 UNC Threaded rear spacer PCB clip	241 A 26400 X
15	4-40 UNC Threaded rear spacer PCB clip	242 A 26310 X	15	4-40 UNC Threaded rear spacer PCB clip	241 A 26410 X
25	4-40 UNC Threaded rear spacer PCB clip	242 A 26320 X	25	4-40 UNC Threaded rear spacer PCB clip	241 A 26420 X
37	4-40 UNC Threaded rear spacer PCB clip	242 A 26330 X	37	4-40 UNC Threaded rear spacer PCB clip	241 A 26430 X
09	M3 Threaded rear spacer PCB clip	242 A 26460 X	09	M3 Threaded rear spacer PCB clip	241 A 26560 X
15	M3 Threaded rear spacer PCB clip	242 A 26470 X	15	M3 Threaded rear spacer PCB clip	241 A 26570 X
25	M3 Threaded rear spacer PCB clip	242 A 26480 X	25	M3 Threaded rear spacer PCB clip	241 A 26580 X
37	M3 Threaded rear spacer PCB clip	242 A 26490 X	37	M3 Threaded rear spacer PCB clip	241 A 26590 X

Capacitance 2 x 830 pF

SOCKET CONNECTOR			PLUG CONNECTOR		
No. of pos.	Mounting style	Part Number	No. of pos.	Mounting style	Part Number
09	4-40 UNC Threaded rear spacer PCB clip	242 A 26340 X	09	4-40 UNC Threaded rear spacer PCB clip	241 A 26440 X
15	4-40 UNC Threaded rear spacer PCB clip	242 A 26350 X	15	4-40 UNC Threaded rear spacer PCB clip	241 A 26450 X
25	4-40 UNC Threaded rear spacer PCB clip	242 A 26360 X	25	4-40 UNC Threaded rear spacer PCB clip	241 A 26460 X
37	4-40 UNC Threaded rear spacer PCB clip	242 A 26370 X	37	4-40 UNC Threaded rear spacer PCB clip	241 A 26470 X
09	M3 Threaded rear spacer PCB clip	242 A 26500 X	09	M3 Threaded rear spacer PCB clip	241 A 26600 X
15	M3 Threaded rear spacer PCB clip	242 A 26510 X	15	M3 Threaded rear spacer PCB clip	241 A 26610 X
25	M3 Threaded rear spacer PCB clip	242 A 26520 X	25	M3 Threaded rear spacer PCB clip	241 A 26620 X
37	M3 Threaded rear spacer PCB clip	242 A 26530 X	37	M3 Threaded rear spacer PCB clip	241 A 26630 X

Capacitance 2 x 1300 pF

SOCKET CONNECTOR			PLUG CONNECTOR		
No. of pos.	Mounting style	Part Number	No. of pos.	Mounting style	Part Number
09	4-40 UNC Threaded rear spacer PCB clip	242 A 26380 X	09	4-40 UNC Threaded rear spacer PCB clip	241 A 26480 X
15	4-40 UNC Threaded rear spacer PCB clip	242 A 26390 X	15	4-40 UNC Threaded rear spacer PCB clip	241 A 26490 X
25	4-40 UNC Threaded rear spacer PCB clip	242 A 26400 X	25	4-40 UNC Threaded rear spacer PCB clip	241 A 26500 X
37	4-40 UNC Threaded rear spacer PCB clip	242 A 26410 X	37	4-40 UNC Threaded rear spacer PCB clip	241 A 26510 X
09	M3 Threaded rear spacer PCB clip	242 A 26540 X	09	M3 Threaded rear spacer PCB clip	241 A 26640 X
15	M3 Threaded rear spacer PCB clip	242 A 26550 X	15	M3 Threaded rear spacer PCB clip	241 A 26650 X
25	M3 Threaded rear spacer PCB clip	242 A 26560 X	25	M3 Threaded rear spacer PCB clip	241 A 26660 X
37	M3 Threaded rear spacer PCB clip	242 A 26570 X	37	M3 Threaded rear spacer PCB clip	241 A 26670 X

PCB clip .122"/3.1 ± .004"/0.10 mm hole diameter and .063"/1.6 mm circuit board thickness

X-ON Electronics

Largest Supplier of Electrical and Electronic Components

Click to view similar products for [D-Sub Standard Connectors](#) category:

Click to view products by [CONEC](#) manufacturer:

Other Similar products are found below :

[56F711-015](#) [012-9507-004](#) [LV242999-142T12](#) [015-0341-000](#) [015-0349-000](#) [015-0372-005](#) [015-0372-008](#) [015-8755-001](#) [020419-0104](#) [012-0467-000](#) [012-0515-000](#) [012-9507-034](#) [012-9507-114](#) [020745-0008](#) [609-25P](#) [M24308/2-23Z](#) [M24308315F](#) [CT2-14S-2PCA34](#) [CT2-18-11PCAU](#) [CT2-36-15SC](#) [CT6-14S-2SC](#) [CT6E14SA7SC](#) [CT6E22-14PC](#) [CT6E22-14PS](#) [CT6E22-22PS](#) [M83513/01-FC](#) [M85049/48-3-2F](#) [6STD09PCM99B70X](#) [6STD09SCM99B30X](#) [6STD09SCT99S40X](#) [6STD15PCT99S40X](#) [6STD15SCM99B30X](#) [6STD15SCT99S40X](#) [6STF09PCM05B70X](#) [7-135760-9](#) [MC11E-10-6SN](#) [747552-3](#) [MD1-21PS](#) [MDM-15SCBRM7-F222](#) [MDM96517-699](#) [MDM96521-744](#) [MDVB1-21SL1](#) [MIK0-1-7SH003](#) [MIKQ6-7SH076](#) [MIKQ7-7PH077](#) [MIKQ7-7PH11](#) [MIKQ7-7PH32](#) [MIKQ9-7PH003](#) [MJSV-28SL61](#) [MKJ4A1F14-55S](#)