

C-FILTER D-SUB HIGH DENSITY

Solder pin – Straight – Precision machined contacts



RoHS compliant – CSA listed, File No.: LR 115000-1 – UL listed, File No.: E202784

SOCKET CONNECTOR

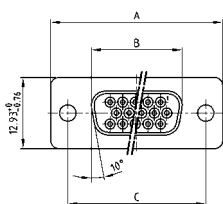

No. of pos.	A -0.76	B -0.25	C
15	31.19	16.46	25.00 ^{+0.12} / _{-0.13}
26	39.52	24.79	33.30 ^{+0.15} / _{-0.10}
44	53.42	38.50	47.04 ^{+0.13} / _{-0.13}
62	69.70	54.96	63.50 ^{+0.13} / _{-0.13}

PCB layout: Kat1i19A

Mounting style: Threaded rear spacer with PCB clip

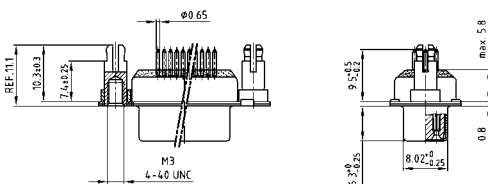

Mounting style: Front and threaded rear spacer with PCB clip

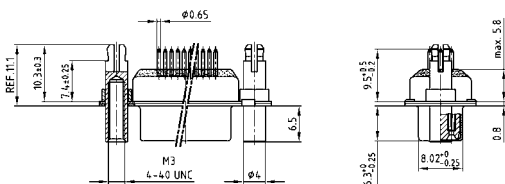

DESCRIPTION

- Mounting styles:
 - with 4-40 UNC or M3 threaded rear spacer with PCB clip
 - with 4-40 UNC or M3 front and threaded rear spacer with PCB clip
- Quality class 3 (also available in quality class 1)
- Shell: Steel tin plated (brass tin plated on request)

PLUG CONNECTOR

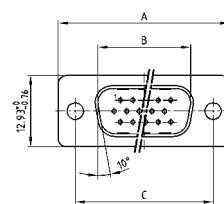

No. of pos.	A -0.76	B -0.25	C	D -0.3
15	31.19	16.79	25.00 ^{+0.12} / _{-0.13}	6.12
26	39.52	25.12	33.30 ^{+0.15} / _{-0.10}	6.12
44	53.42	38.84	47.04 ^{+0.13} / _{-0.13}	5.99
62	69.70	55.30	63.50 ^{+0.13} / _{-0.13}	5.99

PCB layout: Kat1iU0A

Mounting style: Threaded rear spacer with PCB clip

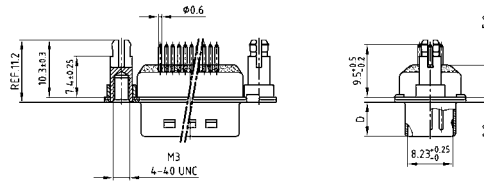

Mounting style: Front and threaded rear spacer with PCB clip

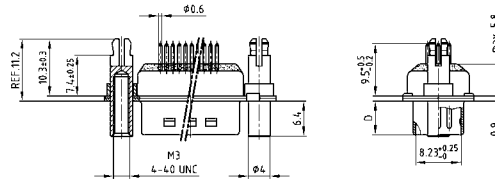

ORDER DATA

Capacitance 180 pF

SOCKET CONNECTOR

No. of pos.	Mounting style	Part Number
15	4-40 UNC Threaded rear spacer PCB clip	242 A 27700 X
26	4-40 UNC Threaded rear spacer PCB clip	242 A 27710 X
44	4-40 UNC Threaded rear spacer PCB clip	242 A 27720 X
62	4-40 UNC Threaded rear spacer PCB clip	242 A 27730 X
15	M3 Threaded rear spacer PCB clip	242 A 27740 X
26	M3 Threaded rear spacer PCB clip	242 A 27750 X
44	M3 Threaded rear spacer PCB clip	242 A 27760 X
62	M3 Threaded rear spacer PCB clip	242 A 27770 X
15	4-40 UNC Front/Threaded rear spacer PCB clip	242 A 27780 X
26	4-40 UNC Front/Threaded rear spacer PCB clip	242 A 27790 X
44	4-40 UNC Front/Threaded rear spacer PCB clip	242 A 27800 X
62	4-40 UNC Front/Threaded rear spacer PCB clip	242 A 27810 X
15	M3 Front/Threaded rear spacer PCB clip	242 A 27820 X
26	M3 Front/Threaded rear spacer PCB clip	242 A 27830 X
44	M3 Front/Threaded rear spacer PCB clip	242 A 27840 X
62	M3 Front/Threaded rear spacer PCB clip	242 A 27850 X

PLUG CONNECTOR

No. of pos.	Mounting style	Part Number
15	4-40 UNC Threaded rear spacer PCB clip	241 A 27800 X
26	4-40 UNC Threaded rear spacer PCB clip	241 A 27810 X
44	4-40 UNC Threaded rear spacer PCB clip	241 A 27820 X
62	4-40 UNC Threaded rear spacer PCB clip	241 A 27830 X
15	M3 Threaded rear spacer PCB clip	241 A 27840 X
26	M3 Threaded rear spacer PCB clip	241 A 27850 X
44	M3 Threaded rear spacer PCB clip	241 A 27860 X
62	M3 Threaded rear spacer PCB clip	241 A 27870 X
15	4-40 UNC Front/Threaded rear spacer PCB clip	241 A 27880 X
26	4-40 UNC Front/Threaded rear spacer PCB clip	241 A 27890 X
44	4-40 UNC Front/Threaded rear spacer PCB clip	241 A 27900 X
62	4-40 UNC Front/Threaded rear spacer PCB clip	241 A 27910 X
15	M3 Front/Threaded rear spacer PCB clip	241 A 27920 X
26	M3 Front/Threaded rear spacer PCB clip	241 A 27930 X
44	M3 Front/Threaded rear spacer PCB clip	241 A 27940 X
62	M3 Front/Threaded rear spacer PCB clip	241 A 27950 X

PCB clip .122"/3.1 ± .004"/0.10 mm hole diameter and .063"/1.6 mm circuit board thickness

C-FILTER D-SUB HIGH DENSITY

Solder pin – Straight – Precision machined contacts

ORDER DATA

Capacitance 370 pF

SOCKET CONNECTOR			PLUG CONNECTOR		
No. of pos.	Mounting style	Part Number	No. of pos.	Mounting style	Part Number
15	4-40 UNC Threaded rear spacer PCB clip	242 A 20610 X	15	4-40 UNC Threaded rear spacer PCB clip	241 A 20760 X
26	4-40 UNC Threaded rear spacer PCB clip	242 A 20620 X	26	4-40 UNC Threaded rear spacer PCB clip	241 A 20770 X
44	4-40 UNC Threaded rear spacer PCB clip	242 A 20630 X	44	4-40 UNC Threaded rear spacer PCB clip	241 A 20780 X
62	4-40 UNC Threaded rear spacer PCB clip	242 A 20640 X	62	4-40 UNC Threaded rear spacer PCB clip	241 A 20790 X
15	M3 Threaded rear spacer PCB clip	242 A 20690 X	15	M3 Threaded rear spacer PCB clip	241 A 20840 X
26	M3 Threaded rear spacer PCB clip	242 A 20700 X	26	M3 Threaded rear spacer PCB clip	241 A 20850 X
44	M3 Threaded rear spacer PCB clip	242 A 20710 X	44	M3 Threaded rear spacer PCB clip	241 A 20860 X
62	M3 Threaded rear spacer PCB clip	242 A 20720 X	62	M3 Threaded rear spacer PCB clip	241 A 20870 X
15	4-40 UNC Front/Threaded rear spacer PCB clip	242 A 20770 X	15	4-40 UNC Front/Threaded rear spacer PCB clip	241 A 20920 X
26	4-40 UNC Front/Threaded rear spacer PCB clip	242 A 20780 X	26	4-40 UNC Front/Threaded rear spacer PCB clip	241 A 20930 X
44	4-40 UNC Front/Threaded rear spacer PCB clip	242 A 20790 X	44	4-40 UNC Front/Threaded rear spacer PCB clip	241 A 20940 X
62	4-40 UNC Front/Threaded rear spacer PCB clip	242 A 20800 X	62	4-40 UNC Front/Threaded rear spacer PCB clip	241 A 20950 X
15	M3 Front/Threaded rear spacer PCB clip	242 A 20850 X	15	M3 Front/Threaded rear spacer PCB clip	241 A 21480 X
26	M3 Front/Threaded rear spacer PCB clip	242 A 20860 X	26	M3 Front/Threaded rear spacer PCB clip	241 A 21490 X
44	M3 Front/Threaded rear spacer PCB clip	242 A 20870 X	44	M3 Front/Threaded rear spacer PCB clip	241 A 21500 X
62	M3 Front/Threaded rear spacer PCB clip	242 A 20880 X	62	M3 Front/Threaded rear spacer PCB clip	241 A 21510 X

Capacitance 830 pF

SOCKET CONNECTOR			PLUG CONNECTOR		
No. of pos.	Mounting style	Part Number	No. of pos.	Mounting style	Part Number
15	4-40 UNC Threaded rear spacer PCB clip	242 A 20650 X	15	4-40 UNC Threaded rear spacer PCB clip	241 A 20800 X
26	4-40 UNC Threaded rear spacer PCB clip	242 A 20660 X	26	4-40 UNC Threaded rear spacer PCB clip	241 A 20810 X
44	4-40 UNC Threaded rear spacer PCB clip	242 A 20670 X	44	4-40 UNC Threaded rear spacer PCB clip	241 A 20820 X
62	4-40 UNC Threaded rear spacer PCB clip	242 A 20680 X	62	4-40 UNC Threaded rear spacer PCB clip	241 A 20830 X
15	M3 Threaded rear spacer PCB clip	242 A 20730 X	15	M3 Threaded rear spacer PCB clip	241 A 20880 X
26	M3 Threaded rear spacer PCB clip	242 A 20740 X	26	M3 Threaded rear spacer PCB clip	241 A 20890 X
44	M3 Threaded rear spacer PCB clip	242 A 20750 X	44	M3 Threaded rear spacer PCB clip	241 A 20900 X
62	M3 Threaded rear spacer PCB clip	242 A 20760 X	62	M3 Threaded rear spacer PCB clip	241 A 20910 X
15	4-40 UNC Front/Threaded rear spacer PCB clip	242 A 20810 X	15	4-40 UNC Front/Threaded rear spacer PCB clip	241 A 20960 X
26	4-40 UNC Front/Threaded rear spacer PCB clip	242 A 20820 X	26	4-40 UNC Front/Threaded rear spacer PCB clip	241 A 20970 X
44	4-40 UNC Front/Threaded rear spacer PCB clip	242 A 20830 X	44	4-40 UNC Front/Threaded rear spacer PCB clip	241 A 20980 X
62	4-40 UNC Front/Threaded rear spacer PCB clip	242 A 20840 X	62	4-40 UNC Front/Threaded rear spacer PCB clip	241 A 20990 X
15	M3 Front/Threaded rear spacer PCB clip	242 A 20890 X	15	M3 Front/Threaded rear spacer PCB clip	241 A 21520 X
26	M3 Front/Threaded rear spacer PCB clip	242 A 20900 X	26	M3 Front/Threaded rear spacer PCB clip	241 A 21530 X
44	M3 Front/Threaded rear spacer PCB clip	242 A 20910 X	44	M3 Front/Threaded rear spacer PCB clip	241 A 21540 X
62	M3 Front/Threaded rear spacer PCB clip	242 A 20920 X	62	M3 Front/Threaded rear spacer PCB clip	241 A 21550 X

PCB clip .122"/3.1 ± .004"/0.10 mm hole diameter and .063"/1.6 mm circuit board thickness

X-ON Electronics

Largest Supplier of Electrical and Electronic Components

Click to view similar products for [D-Sub High Density Connectors](#) category:

Click to view products by [CONEC](#) manufacturer:

Other Similar products are found below :

[97-3250-11](#) [163A17089X](#) [164A17199X](#) [164C18629X](#) [L717HDB44POL2R210](#) [L717HDEH15POL2](#) [L777HDE15P](#) [L77HDE15SC309](#)
[163A16759X](#) [163A16839X](#) [163A16989X](#) [163A17079X](#) [164A17329X](#) [164A18219X](#) [241A16440X](#) [241A16550X](#) [241A16680X](#)
[241A20810X](#) [241A25740X](#) [CT25-44P](#) [MDBE15PE766](#) [L177HDE15SOL2RM23](#) [L177HRC62SVFM](#) [L177HRCG62S](#)
[L717HDEG15POL2RM5](#) [L77HDA26SVF](#) [L77HDE15SD1CO](#) [L77HDEH15SOL2RM832](#) [DAMA-15S-WS](#) [443895-3](#) [106698-1](#) [280-](#)
[012K2C](#) [DBMV13H3SNA197](#) [L177HRB44S](#) [164A17039X](#) [09562004701510](#) [L777HRC62P](#) [241A17960X](#) [164A18269X](#) [280-019S1S9MEN](#)
[L777HDEG15P](#) [280-018P3S25MEGN](#) [206504-2](#) [40-9415HDSP](#) [40-9515HDSP](#) [2057140-1](#) [C115370-6002](#) [DFMA104SNMBFR172FR022](#)
[HDC9F200E2S](#) [L717HDAG26POL2RM8](#)