

C-FILTER D-SUB STANDARD

Solder pin – Straight – Precision machined contacts

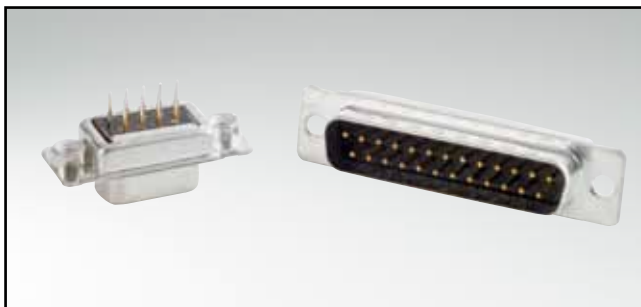

RoHS compliant – CSA listed, File No.: LR 115000-1 – UL listed, File No.: E202784

DESCRIPTION

- Mounting styles:
 - with through-hole, $\varnothing .118"/3 \text{ mm}$
 - with 4-40 UNC or M3 threaded insert
- Quality class 3 (also available in quality class 1)
- Shell: Steel tin plated (brass tin plated on request)

SOCKET CONNECTOR

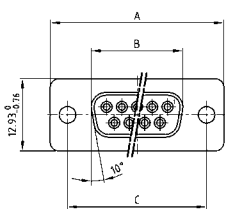

No. of pos.	A -0.76	B -0.25	C
09	31.19	16.46	25.00 $^{+0.12}_{-0.13}$
15	39.52	24.79	33.30 $^{+0.15}_{-0.10}$
25	53.42	38.50	47.04 ± 0.13
37	69.70	54.96	63.50 ± 0.13
50	67.31	52.55	61.10 $^{+0.14}_{-0.11}$

PCB layout: Kat1kFUA

Mounting style: Through-hole

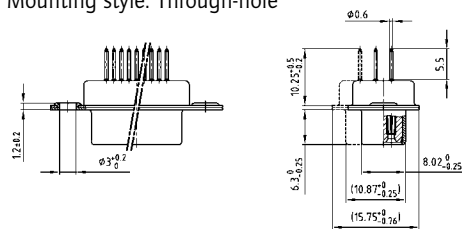

Mounting style: Threaded insert

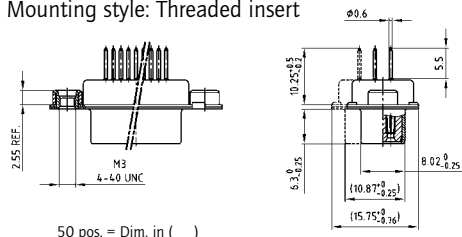

50 pos. = Dim. in (_)

PLUG CONNECTOR

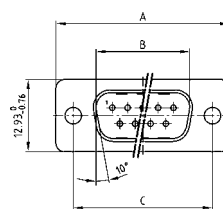

No. of pos.	A -0.76	B -0.25	C	D -0.3
09	31.19	16.79	25.00 $^{+0.12}_{-0.13}$	6.12
15	39.52	25.12	33.30 $^{+0.15}_{-0.10}$	6.12
25	53.42	38.84	47.04 ± 0.13	5.99
37	69.70	55.30	63.50 ± 0.13	5.99
50	67.31	52.68	61.10 $^{+0.14}_{-0.11}$	5.99

PCB layout: Kat1kFUA

Mounting style: Through-hole

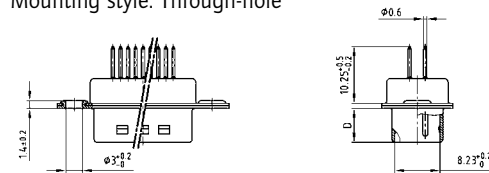

Mounting style: Threaded insert

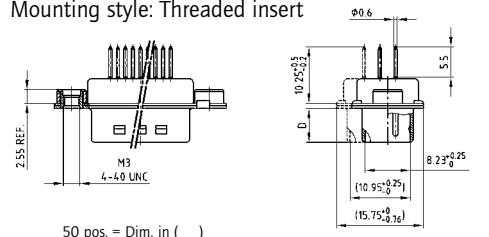

50 pos. = Dim. in (_)

ORDER DATA

Capacitance 180 pF

SOCKET CONNECTOR

No. of pos.	Mounting style	Part Number
09	Through-hole	242 A 16060 X
15	Through-hole	242 A 16070 X
25	Through-hole	242 A 16080 X
37	Through-hole	242 A 16090 X
50	Through-hole	242 A 16100 X
09	4-40 UNC Threaded insert	242 A 16110 X
15	4-40 UNC Threaded insert	242 A 16120 X
25	4-40 UNC Threaded insert	242 A 16130 X
37	4-40 UNC Threaded insert	242 A 16140 X
50	4-40 UNC Threaded insert	242 A 16150 X
09	M3 Threaded insert	242 A 16160 X
15	M3 Threaded insert	242 A 16170 X
25	M3 Threaded insert	242 A 16180 X
37	M3 Threaded insert	242 A 16190 X
50	M3 Threaded insert	242 A 16200 X

PLUG CONNECTOR

No. of pos.	Mounting style	Part Number
09	Through-hole	241 A 18680 X
15	Through-hole	241 A 18690 X
25	Through-hole	241 A 18700 X
37	Through-hole	241 A 18710 X
50	Through-hole	241 A 18720 X
09	4-40 UNC Threaded insert	241 A 18730 X
15	4-40 UNC Threaded insert	241 A 18740 X
25	4-40 UNC Threaded insert	241 A 18750 X
37	4-40 UNC Threaded insert	241 A 18760 X
50	4-40 UNC Threaded insert	241 A 18770 X
09	M3 Threaded insert	241 A 18780 X
15	M3 Threaded insert	241 A 18790 X
25	M3 Threaded insert	241 A 18800 X
37	M3 Threaded insert	241 A 18810 X
50	M3 Threaded insert	241 A 18820 X

C-FILTER D-SUB STANDARD

Solder pin – Straight – Precision machined contacts

ORDER DATA

Capacitance 370 pF			
SOCKET CONNECTOR			PLUG CONNECTOR
No. of pos.	Mounting style	Part Number	No. of pos. Mounting style Part Number
09	Through-hole	242 A 10010 X	09 Through-hole 241 A 10010 X
15	Through-hole	242 A 10020 X	15 Through-hole 241 A 10020 X
25	Through-hole	242 A 10030 X	25 Through-hole 241 A 10030 X
37	Through-hole	242 A 10040 X	37 Through-hole 241 A 10040 X
50	Through-hole	242 A 15580 X	50 Through-hole 241 A 15690 X
09	4-40 UNC Threaded insert	242 A 10130 X	09 4-40 UNC Threaded insert 241 A 10130 X
15	4-40 UNC Threaded insert	242 A 10140 X	15 4-40 UNC Threaded insert 241 A 10140 X
25	4-40 UNC Threaded insert	242 A 10150 X	25 4-40 UNC Threaded insert 241 A 10150 X
37	4-40 UNC Threaded insert	242 A 10160 X	37 4-40 UNC Threaded insert 241 A 10160 X
50	4-40 UNC Threaded insert	242 A 15610 X	50 4-40 UNC Threaded insert 241 A 15720 X
09	M3 Threaded insert	242 A 10250 X	09 M3 Threaded insert 241 A 10250 X
15	M3 Threaded insert	242 A 10260 X	15 M3 Threaded insert 241 A 10260 X
25	M3 Threaded insert	242 A 10270 X	25 M3 Threaded insert 241 A 10270 X
37	M3 Threaded insert	242 A 10280 X	37 M3 Threaded insert 241 A 10280 X
50	M3 Threaded insert	242 A 15640 X	50 M3 Threaded insert 241 A 15750 X

Capacitance 830 pF			
SOCKET CONNECTOR			PLUG CONNECTOR
No. of pos.	Mounting style	Part Number	No. of pos. Mounting style Part Number
09	Through-hole	242 A 10090 X	09 Through-hole 241 A 10090 X
15	Through-hole	242 A 10100 X	15 Through-hole 241 A 10100 X
25	Through-hole	242 A 10110 X	25 Through-hole 241 A 10110 X
37	Through-hole	242 A 10120 X	37 Through-hole 241 A 10120 X
50	Through-hole	242 A 15600 X	50 Through-hole 241 A 15710 X
09	4-40 UNC Threaded insert	242 A 10210 X	09 4-40 UNC Threaded insert 241 A 10210 X
15	4-40 UNC Threaded insert	242 A 10220 X	15 4-40 UNC Threaded insert 241 A 10220 X
25	4-40 UNC Threaded insert	242 A 10230 X	25 4-40 UNC Threaded insert 241 A 10230 X
37	4-40 UNC Threaded insert	242 A 10240 X	37 4-40 UNC Threaded insert 241 A 10240 X
50	4-40 UNC Threaded insert	242 A 15630 X	50 4-40 UNC Threaded insert 241 A 15740 X
09	M3 Threaded insert	242 A 10330 X	09 M3 Threaded insert 241 A 10330 X
15	M3 Threaded insert	242 A 10340 X	15 M3 Threaded insert 241 A 10340 X
25	M3 Threaded insert	242 A 10350 X	25 M3 Threaded insert 241 A 10350 X
37	M3 Threaded insert	242 A 10360 X	37 M3 Threaded insert 241 A 10360 X
50	M3 Threaded insert	242 A 15660 X	50 M3 Threaded insert 241 A 15770 X

Capacitance 1300 pF			
SOCKET CONNECTOR			PLUG CONNECTOR
No. of pos.	Mounting style	Part Number	No. of pos. Mounting style Part Number
09	Through-hole	242 A 10050 X	09 Through-hole 241 A 10050 X
15	Through-hole	242 A 10060 X	15 Through-hole 241 A 10060 X
25	Through-hole	242 A 10070 X	25 Through-hole 241 A 10070 X
37	Through-hole	242 A 10080 X	37 Through-hole 241 A 10080 X
50	Through-hole	242 A 15590 X	50 Through-hole 241 A 15700 X
09	4-40 UNC Threaded insert	242 A 10170 X	09 4-40 UNC Threaded insert 241 A 10170 X
15	4-40 UNC Threaded insert	242 A 10180 X	15 4-40 UNC Threaded insert 241 A 10180 X
25	4-40 UNC Threaded insert	242 A 10190 X	25 4-40 UNC Threaded insert 241 A 10190 X
37	4-40 UNC Threaded insert	242 A 10200 X	37 4-40 UNC Threaded insert 241 A 10200 X
50	4-40 UNC Threaded insert	242 A 15620 X	50 4-40 UNC Threaded insert 241 A 15730 X
09	M3 Threaded insert	242 A 10290 X	09 M3 Threaded insert 241 A 10290 X
15	M3 Threaded insert	242 A 10300 X	15 M3 Threaded insert 241 A 10300 X
25	M3 Threaded insert	242 A 10310 X	25 M3 Threaded insert 241 A 10310 X
37	M3 Threaded insert	242 A 10320 X	37 M3 Threaded insert 241 A 10320 X
50	M3 Threaded insert	242 A 15650 X	50 M3 Threaded insert 241 A 15760 X

X-ON Electronics

Largest Supplier of Electrical and Electronic Components

Click to view similar products for [D-Sub Standard Connectors](#) category:

Click to view products by [CONEC](#) manufacturer:

Other Similar products are found below :

[56F711-015](#) [012-9507-004](#) [LV242999-142T12](#) [015-0341-000](#) [015-0349-000](#) [015-0372-005](#) [015-0372-008](#) [015-8755-001](#) [020419-0104](#) [012-0467-000](#) [012-0515-000](#) [012-9507-034](#) [012-9507-114](#) [020745-0008](#) [609-25P](#) [M24308/2-23Z](#) [M24308315F](#) [CT2-14S-2PCA34](#) [CT2-18-11PCAU](#) [CT2-36-15SC](#) [CT6-14S-2SC](#) [CT6E14SA7SC](#) [CT6E22-14PC](#) [CT6E22-14PS](#) [CT6E22-22PS](#) [M83513/01-FC](#) [M85049/48-3-2F](#) [6STD09PCM99B70X](#) [6STD09SCM99B30X](#) [6STD09SCT99S40X](#) [6STD15PCT99S40X](#) [6STD15SCM99B30X](#) [6STD15SCT99S40X](#) [6STF09PCM05B70X](#) [7-135760-9](#) [MC11E-10-6SN](#) [747552-3](#) [MD1-21PS](#) [MDM-15SCBRM7-F222](#) [MDM96517-699](#) [MDM96521-744](#) [MDVB1-21SL1](#) [MIK0-1-7SH003](#) [MIKQ6-7SH076](#) [MIKQ7-7PH077](#) [MIKQ7-7PH11](#) [MIKQ7-7PH32](#) [MIKQ9-7PH003](#) [MJSV-28SL61](#) [MKJ4A1F14-55S](#)