

C-FILTER D-SUB STANDARD

Solder pin – Angled – .370" / 9.4 mm – Precision machined contacts – Plastic bracket

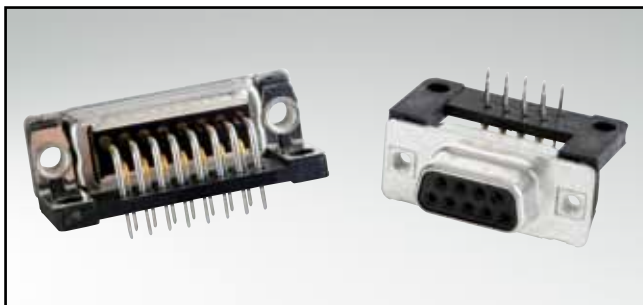

RoHS compliant – CSA listed, File No.: LR 115000-1 – UL listed, File No.: E202784

DESCRIPTION

- Mounting styles:
 - Mounting bracket, grounding strap with through-hole \varnothing .118" / 3.0 mm
 - Mounting bracket, grounding strap with 4-40 UNC or M3 threaded insert
- Quality class 3 (also available in quality class 1)
- Shell: Steel tin plated (brass tin plated on request)

SOCKET CONNECTOR

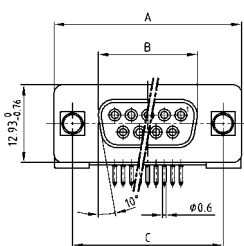

No. of pos.	A -0.76	B -0.25	C
09	31.19	16.46	25.00 $^{+0.12}_{-0.13}$
15	39.52	24.79	33.30 $^{+0.15}_{-0.10}$
25	53.42	38.50	47.04 $^{+0.13}$
37	69.70	54.96	63.50 $^{+0.13}$

PCB layout: Kat1kGGA

Mounting style: Through-hole

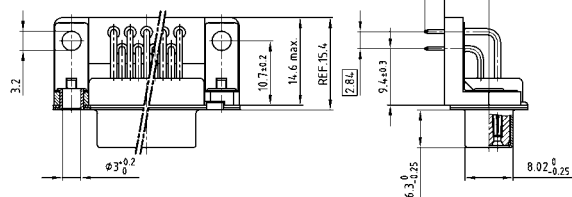

Mounting style: Threaded insert

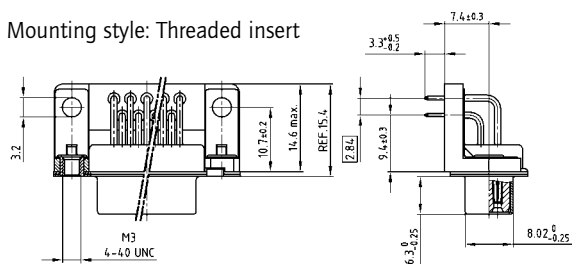

PLUG CONNECTOR

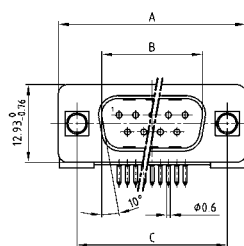

No. of pos.	A -0.76	B +0.25	C	D -0.3
09	31.19	16.79	25.00 $^{+0.12}_{-0.13}$	6.12
15	39.52	25.12	33.30 $^{+0.15}_{-0.10}$	6.12
25	53.42	38.84	47.04 $^{+0.13}$	5.99
37	69.70	55.30	63.50 $^{+0.13}$	5.99

PCB layout: Kat1kGHA

Mounting style: Through-hole

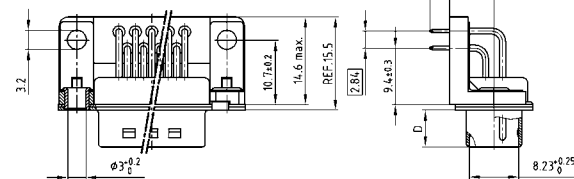

Mounting style: Threaded insert

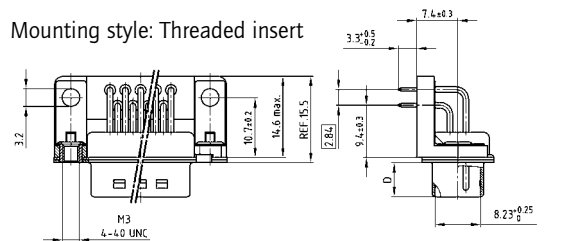

ORDER DATA

Capacitance 180 pF

SOCKET CONNECTOR

No. of pos.	Mounting style	Part Number
09	Through-hole	242 A 16780 X
15	Through-hole	242 A 16790 X
25	Through-hole	242 A 16800 X
37	Through-hole	242 A 16810 X
09	Grounding strap / 4-40 UNC Threaded insert	242 A 16820 X
15	Grounding strap / 4-40 UNC Threaded insert	242 A 16830 X
25	Grounding strap / 4-40 UNC Threaded insert	242 A 16840 X
37	Grounding strap / 4-40 UNC Threaded insert	242 A 16850 X
09	Grounding strap / M3 Threaded insert	242 A 16860 X
15	Grounding strap / M3 Threaded insert	242 A 16870 X
25	Grounding strap / M3 Threaded insert	242 A 16880 X
37	Grounding strap / M3 Threaded insert	242 A 16890 X

PLUG CONNECTOR

No. of pos.	Mounting style	Part Number
09	Through-hole	241 A 19400 X
15	Through-hole	241 A 19410 X
25	Through-hole	241 A 19420 X
37	Through-hole	241 A 19430 X
09	Grounding strap / 4-40 UNC Threaded insert	241 A 19440 X
15	Grounding strap / 4-40 UNC Threaded insert	241 A 19450 X
25	Grounding strap / 4-40 UNC Threaded insert	241 A 19460 X
37	Grounding strap / 4-40 UNC Threaded insert	241 A 19470 X
09	Grounding strap / M3 Threaded insert	241 A 19480 X
15	Grounding strap / M3 Threaded insert	241 A 19490 X
25	Grounding strap / M3 Threaded insert	241 A 19500 X
37	Grounding strap / M3 Threaded insert	241 A 19510 X

C-FILTER D-SUB STANDARD

Solder pin – Angled – .370" / 9.4 mm – Precision machined contacts – Plastic bracket

ORDER DATA

Capacitance 370 pF

SOCKET CONNECTOR			PLUG CONNECTOR		
No. of pos.	Mounting style	Part Number	No. of pos.	Mounting style	Part Number
09	Through-hole	242 A 10970 X	09	Through-hole	241 A 10970 X
15	Through-hole	242 A 10980 X	15	Through-hole	241 A 10980 X
25	Through-hole	242 A 10990 X	25	Through-hole	241 A 10990 X
37	Through-hole	242 A 11000 X	37	Through-hole	241 A 11000 X
09	Grounding strap / 4-40 UNC Threaded insert	242 A 11090 X	09	Grounding strap / 4-40 UNC Threaded insert	241 A 11090 X
15	Grounding strap / 4-40 UNC Threaded insert	242 A 11100 X	15	Grounding strap / 4-40 UNC Threaded insert	241 A 11100 X
25	Grounding strap / 4-40 UNC Threaded insert	242 A 11110 X	25	Grounding strap / 4-40 UNC Threaded insert	241 A 11110 X
37	Grounding strap / 4-40 UNC Threaded insert	242 A 11120 X	37	Grounding strap / 4-40 UNC Threaded insert	241 A 11120 X
09	Grounding strap / M3 Threaded insert	242 A 11210 X	09	Grounding strap / M3 Threaded insert	241 A 11210 X
15	Grounding strap / M3 Threaded insert	242 A 11220 X	15	Grounding strap / M3 Threaded insert	241 A 11220 X
25	Grounding strap / M3 Threaded insert	242 A 11230 X	25	Grounding strap / M3 Threaded insert	241 A 11230 X
37	Grounding strap / M3 Threaded insert	242 A 11240 X	37	Grounding strap / M3 Threaded insert	241 A 11240 X

Capacitance 830 pF

SOCKET CONNECTOR			PLUG CONNECTOR		
No. of pos.	Mounting style	Part Number	No. of pos.	Mounting style	Part Number
09	Through-hole	242 A 11050 X	09	Through-hole	241 A 11050 X
15	Through-hole	242 A 11060 X	15	Through-hole	241 A 11060 X
25	Through-hole	242 A 11070 X	25	Through-hole	241 A 11070 X
37	Through-hole	242 A 11080 X	37	Through-hole	241 A 11080 X
09	Grounding strap / 4-40 UNC Threaded insert	242 A 11170 X	09	Grounding strap / 4-40 UNC Threaded insert	241 A 11170 X
15	Grounding strap / 4-40 UNC Threaded insert	242 A 11180 X	15	Grounding strap / 4-40 UNC Threaded insert	241 A 11180 X
25	Grounding strap / 4-40 UNC Threaded insert	242 A 11190 X	25	Grounding strap / 4-40 UNC Threaded insert	241 A 11190 X
37	Grounding strap / 4-40 UNC Threaded insert	242 A 11200 X	37	Grounding strap / 4-40 UNC Threaded insert	241 A 11200 X
09	Grounding strap / M3 Threaded insert	242 A 11290 X	09	Grounding strap / M3 Threaded insert	241 A 11290 X
15	Grounding strap / M3 Threaded insert	242 A 11300 X	15	Grounding strap / M3 Threaded insert	241 A 11300 X
25	Grounding strap / M3 Threaded insert	242 A 11310 X	25	Grounding strap / M3 Threaded insert	241 A 11310 X
37	Grounding strap / M3 Threaded insert	242 A 11320 X	37	Grounding strap / M3 Threaded insert	241 A 11320 X

Capacitance 1300 pF

SOCKET CONNECTOR			PLUG CONNECTOR		
No. of pos.	Mounting style	Part Number	No. of pos.	Mounting style	Part Number
09	Through-hole	242 A 11010 X	09	Through-hole	241 A 11010 X
15	Through-hole	242 A 11020 X	15	Through-hole	241 A 11020 X
25	Through-hole	242 A 11030 X	25	Through-hole	241 A 11030 X
37	Through-hole	242 A 11040 X	37	Through-hole	241 A 11040 X
09	Grounding strap / 4-40 UNC Threaded insert	242 A 11130 X	09	Grounding strap / 4-40 UNC Threaded insert	241 A 11130 X
15	Grounding strap / 4-40 UNC Threaded insert	242 A 11140 X	15	Grounding strap / 4-40 UNC Threaded insert	241 A 11140 X
25	Grounding strap / 4-40 UNC Threaded insert	242 A 11150 X	25	Grounding strap / 4-40 UNC Threaded insert	241 A 11150 X
37	Grounding strap / 4-40 UNC Threaded insert	242 A 11160 X	37	Grounding strap / 4-40 UNC Threaded insert	241 A 11160 X
09	Grounding strap / M3 Threaded insert	242 A 11250 X	09	Grounding strap / M3 Threaded insert	241 A 11250 X
15	Grounding strap / M3 Threaded insert	242 A 11260 X	15	Grounding strap / M3 Threaded insert	241 A 11260 X
25	Grounding strap / M3 Threaded insert	242 A 11270 X	25	Grounding strap / M3 Threaded insert	241 A 11270 X
37	Grounding strap / M3 Threaded insert	242 A 11280 X	37	Grounding strap / M3 Threaded insert	241 A 11280 X

X-ON Electronics

Largest Supplier of Electrical and Electronic Components

Click to view similar products for [D-Sub Standard Connectors](#) category:

Click to view products by [CONEC](#) manufacturer:

Other Similar products are found below :

[56F711-015](#) [012-9507-004](#) [LV242999-142T12](#) [015-0341-000](#) [015-0349-000](#) [015-0372-005](#) [015-0372-008](#) [015-8755-001](#) [020419-0104](#) [012-0467-000](#) [012-0515-000](#) [012-9507-034](#) [012-9507-114](#) [020745-0008](#) [609-25P](#) [M24308/2-23Z](#) [M24308315F](#) [CT2-14S-2PCA34](#) [CT2-18-11PCAU](#) [CT2-36-15SC](#) [CT6-14S-2SC](#) [CT6E14SA7SC](#) [CT6E22-14PC](#) [CT6E22-14PS](#) [CT6E22-22PS](#) [M83513/01-FC](#) [M85049/48-3-2F](#) [6STD09PCM99B70X](#) [6STD09SCM99B30X](#) [6STD09SCT99S40X](#) [6STD15PCT99S40X](#) [6STD15SCM99B30X](#) [6STD15SCT99S40X](#) [6STF09PCM05B70X](#) [7-135760-9](#) [MC11E-10-6SN](#) [747552-3](#) [MD1-21PS](#) [MDM-15SCBRM7-F222](#) [MDM96517-699](#) [MDM96521-744](#) [MDVB1-21SL1](#) [MIK0-1-7SH003](#) [MIKQ6-7SH076](#) [MIKQ7-7PH077](#) [MIKQ7-7PH11](#) [MIKQ7-7PH32](#) [MIKQ9-7PH003](#) [MJSV-28SL61](#) [MKJ4A1F14-55S](#)