

C-FILTER D-SUB STANDARD

Solder pin – Angled – .318" / 7.19 mm – Precision machined contacts – Metal bracket

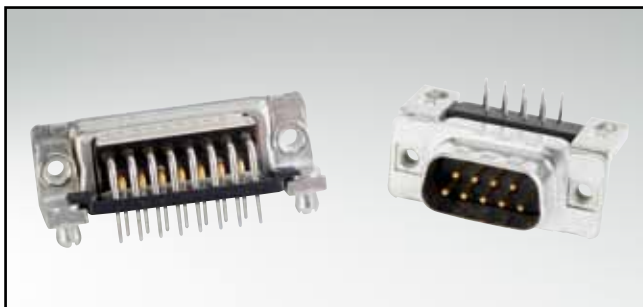

RoHS compliant – CSA listed, File No.: LR 115000-1 – UL listed, File No.: E202784

DESCRIPTION

- Mounting styles:
 - with mounting bracket and 4-40 UNC threaded insert
 - with mounting bracket, PCB clip and 4-40 UNC threaded insert
- Quality class 3 (also available in quality class 1)
- Shell: Steel tin plated (brass tin plated on request)

SOCKET CONNECTOR

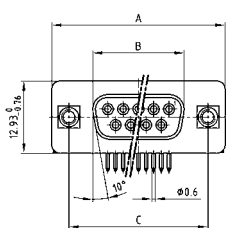

No. of pos.	A -0.76	B -0.25	C
09	31.19	16.46	25.00 ^{+0.12} / _{-0.13}
15	39.52	24.79	33.30 ^{+0.15} / _{-0.10}
25	53.42	38.50	47.04 ^{+0.13} / _{-0.10}
37	69.70	54.96	63.50 ^{+0.13} / _{-0.10}

PCB layout: Kat1kGEA

Mounting style: Threaded insert

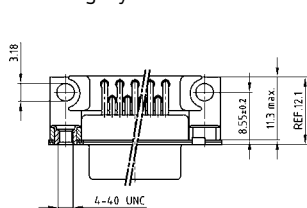

Mounting style: PCB clip, threaded insert

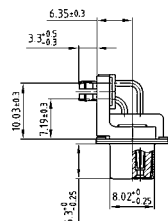
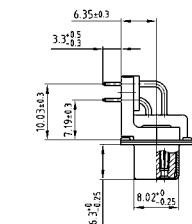
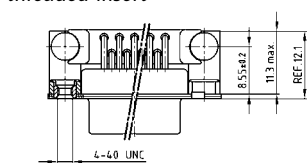

PLUG CONNECTOR

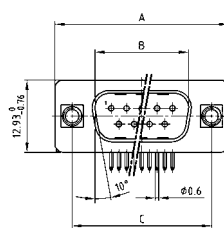

No. of pos.	A -0.76	B +0.25	C	D -0.3
09	31.19	16.79	25.00 ^{+0.12} / _{-0.13}	6.12
15	39.52	25.12	33.30 ^{+0.15} / _{-0.10}	6.12
25	53.42	38.84	47.04 ^{+0.13} / _{-0.10}	5.99
37	69.70	55.30	63.50 ^{+0.13} / _{-0.10}	5.99

PCB layout: Kat1kGFA

Mounting style: Threaded insert

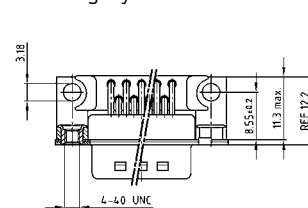

Mounting style: PCB clip, threaded insert

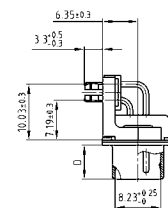
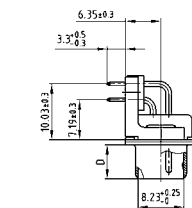
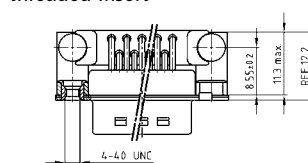

ORDER DATA

Capacitance 180 pF

SOCKET CONNECTOR			PLUG CONNECTOR		
No. of pos.	Mounting style 4-40 UNC	Part Number	No. of pos.	Mounting style 4-40 UNC	Part Number
09	Threaded insert	242 A 17180 X	09	Threaded insert	241 A 19800 X
15	Threaded insert	242 A 17190 X	15	Threaded insert	241 A 19810 X
25	Threaded insert	242 A 17200 X	25	Threaded insert	241 A 19820 X
37	Threaded insert	242 A 17210 X	37	Threaded insert	241 A 19830 X
09	PCB clip / Threaded insert	242 A 17780 X	09	PCB clip / Threaded insert	241 A 16180 X
15	PCB clip / Threaded insert	242 A 17790 X	15	PCB clip / Threaded insert	241 A 16190 X
25	PCB clip / Threaded insert	242 A 17800 X	25	PCB clip / Threaded insert	241 A 16200 X
37	PCB clip / Threaded insert	242 A 17810 X	37	PCB clip / Threaded insert	241 A 16210 X

PCB clip .122"/3.1 ± .004"/0.10 mm hole diameter and .063"/1.6 mm circuit board thickness

C-FILTER D-SUB STANDARD

Solder pin – Angled – .318" / 7.19 mm – Precision machined contacts – Metal bracket

ORDER DATA

Capacitance 370 pF					
SOCKET CONNECTOR			PLUG CONNECTOR		
No. of pos.	Mounting style 4-40 UNC	Part Number	No. of pos.	Mounting style 4-40 UNC	Part Number
09	Threaded insert	242 A 12340 X	09	Threaded insert	241 A 12320 X
15	Threaded insert	242 A 12350 X	15	Threaded insert	241 A 12330 X
25	Threaded insert	242 A 12360 X	25	Threaded insert	241 A 12340 X
37	Threaded insert	242 A 12370 X	37	Threaded insert	241 A 12350 X
09	PCB clip / Threaded insert	242 A 17740 X	09	PCB clip / Threaded insert	241 A 16140 X
15	PCB clip / Threaded insert	242 A 17750 X	15	PCB clip / Threaded insert	241 A 16150 X
25	PCB clip / Threaded insert	242 A 17760 X	25	PCB clip / Threaded insert	241 A 16160 X
37	PCB clip / Threaded insert	242 A 17770 X	37	PCB clip / Threaded insert	241 A 16170 X

Capacitance 830 pF					
SOCKET CONNECTOR			PLUG CONNECTOR		
No. of pos.	Mounting style 4-40 UNC	Part Number	No. of pos.	Mounting style 4-40 UNC	Part Number
09	Threaded insert	242 A 12420 X	09	Threaded insert	241 A 12400 X
15	Threaded insert	242 A 12430 X	15	Threaded insert	241 A 12410 X
25	Threaded insert	242 A 12440 X	25	Threaded insert	241 A 12420 X
37	Threaded insert	242 A 12450 X	37	Threaded insert	241 A 12430 X
09	PCB clip / Threaded insert	242 A 17700 X	09	PCB clip / Threaded insert	241 A 16100 X
15	PCB clip / Threaded insert	242 A 17710 X	15	PCB clip / Threaded insert	241 A 16110 X
25	PCB clip / Threaded insert	242 A 17720 X	25	PCB clip / Threaded insert	241 A 16120 X
37	PCB clip / Threaded insert	242 A 17730 X	37	PCB clip / Threaded insert	241 A 16130 X

Capacitance 1300 pF					
SOCKET CONNECTOR			PLUG CONNECTOR		
No. of pos.	Mounting style 4-40 UNC	Part Number	No. of pos.	Mounting style 4-40 UNC	Part Number
09	Threaded insert	242 A 12380 X	09	Threaded insert	241 A 12360 X
15	Threaded insert	242 A 12390 X	15	Threaded insert	241 A 12370 X
25	Threaded insert	242 A 12400 X	25	Threaded insert	241 A 12380 X
37	Threaded insert	242 A 12410 X	37	Threaded insert	241 A 12390 X
09	PCB clip / Threaded insert	242 A 17660 X	09	PCB clip / Threaded insert	241 A 16060 X
15	PCB clip / Threaded insert	242 A 17670 X	15	PCB clip / Threaded insert	241 A 16070 X
25	PCB clip / Threaded insert	242 A 17680 X	25	PCB clip / Threaded insert	241 A 16080 X
37	PCB clip / Threaded insert	242 A 17690 X	37	PCB clip / Threaded insert	241 A 16090 X

PCB clip .122" / 3.1 ± .004" / 0.10 mm hole diameter and .063" / 1.6 mm circuit board thickness

X-ON Electronics

Largest Supplier of Electrical and Electronic Components

Click to view similar products for [D-Sub Standard Connectors](#) category:

Click to view products by [CONEC](#) manufacturer:

Other Similar products are found below :

[56F711-015](#) [012-9507-004](#) [LV242999-142T12](#) [015-0341-000](#) [015-0349-000](#) [015-0372-005](#) [015-0372-008](#) [015-8755-001](#) [020419-0104](#) [012-0467-000](#) [012-0515-000](#) [012-9507-034](#) [012-9507-114](#) [020745-0008](#) [609-25P](#) [M24308315F](#) [CT2-14S-2PCA34](#) [CT2-18-11PCAU](#) [CT2-36-15SC](#) [CT6-14S-2SC](#) [CT6E14SA7SC](#) [CT6E22-14PC](#) [CT6E22-14PS](#) [CT6E22-22PS](#) [M83513/01-FC](#) [M85049/48-3-2F](#) [6STD09PCM99B70X](#) [6STD09SCM99B30X](#) [6STD09SCT99S40X](#) [6STD15PCT99S40X](#) [6STD15SCM99B30X](#) [6STD15SCT99S40X](#) [6STF09PCM05B70X](#) [7-135760-9](#) [MC11E-10-6SN](#) [747552-3](#) [MD1-21PS](#) [MDM-15SCBRM7-F222](#) [MDM96517-699](#) [MDM96521-744](#) [MDVB1-21SL1](#) [MIK0-1-7SH003](#) [MIKQ6-7SH076](#) [MIKQ7-7PH077](#) [MIKQ7-7PH11](#) [MIKQ7-7PH32](#) [MIKQ9-7PH003](#) [MJSV-28SL61](#) [MKJ4A1F14-55S](#) [8-135760-3](#)