

C-FILTER D-SUB HIGH DENSITY

Solder pin – Straight – Precision machined contacts



RoHS compliant – CSA listed, File No.: LR 115000-1 – UL listed, File No.: E202784

DESCRIPTION

- Mounting styles:
 - with through-hole, $\varnothing .118"/3 \text{ mm}$
 - with 4-40 UNC or M3 threaded insert
- Quality class 3 (also available in quality class 1)
- Shell: Steel tin plated (brass tin plated on request)

SOCKET CONNECTOR

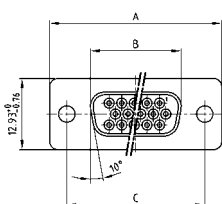

No. of pos.	A -0.76	B -0.25	C
15	31.19	16.46	25.00 $+0.12$ -0.13
26	39.52	24.79	33.30 $+0.15$ -0.10
44	53.42	38.50	47.04 ± 0.13
62	69.70	54.96	63.50 ± 0.13

PCB layout: Kat1i19A

Mounting style: Through-hole

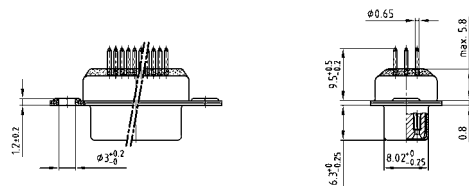

Mounting style: Threaded insert

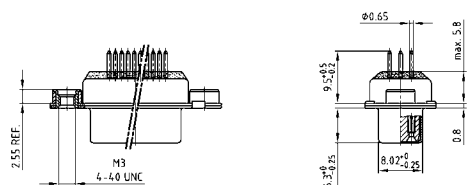

PLUG CONNECTOR

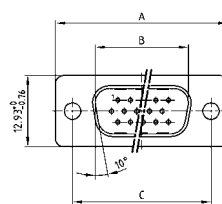

No. of pos.	A -0.76	B +0.25	C	D -0.3
15	31.19	16.79	25.00 $+0.12$ -0.13	6.12
26	39.52	25.12	33.30 $+0.15$ -0.10	6.12
44	53.42	38.84	47.04 ± 0.13	5.99
62	69.70	55.30	63.50 ± 0.13	5.99

PCB layout: Kat1iU0A

Mounting style: Through-hole

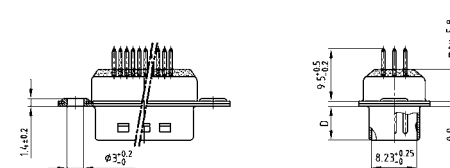

Mounting style: Threaded insert

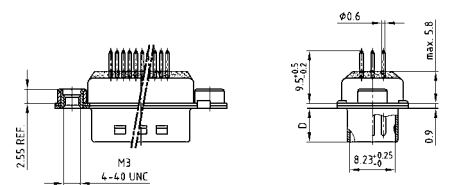

ORDER DATA

Capacitance 180 pF

SOCKET CONNECTOR

No. of pos.	Mounting style	Part Number
15	Through-hole	242 A 27380 X
26	Through-hole	242 A 27390 X
44	Through-hole	242 A 27400 X
62	Through-hole	242 A 27410 X
15	4-40 UNC Threaded insert	242 A 27420 X
26	4-40 UNC Threaded insert	242 A 27430 X
44	4-40 UNC Threaded insert	242 A 27440 X
62	4-40 UNC Threaded insert	242 A 27450 X
15	M3 Threaded insert	242 A 27460 X
26	M3 Threaded insert	242 A 27470 X
44	M3 Threaded insert	242 A 27480 X
62	M3 Threaded insert	242 A 27490 X

PLUG CONNECTOR

No. of pos.	Mounting style	Part Number
15	Through-hole	241 A 27480 X
26	Through-hole	241 A 27490 X
44	Through-hole	241 A 27500 X
62	Through-hole	241 A 27510 X
15	4-40 UNC Threaded insert	241 A 27520 X
26	4-40 UNC Threaded insert	241 A 27530 X
44	4-40 UNC Threaded insert	241 A 27540 X
62	4-40 UNC Threaded insert	241 A 27550 X
15	M3 Threaded insert	241 A 27560 X
26	M3 Threaded insert	241 A 27570 X
44	M3 Threaded insert	241 A 27580 X
62	M3 Threaded insert	241 A 27590 X

C-FILTER D-SUB HIGH DENSITY

Solder pin – Straight – Precision machined contacts

ORDER DATA

Capacitance 370 pF

SOCKET CONNECTOR			PLUG CONNECTOR		
No. of pos.	Mounting style	Part Number	No. of pos.	Mounting style	Part Number
15	Through-hole	242 A 17980 X	15	Through-hole	241 A 16380 X
26	Through-hole	242 A 17990 X	26	Through-hole	241 A 16390 X
44	Through-hole	242 A 18000 X	44	Through-hole	241 A 16400 X
62	Through-hole	242 A 18010 X	62	Through-hole	241 A 16410 X
15	4-40 UNC Threaded insert	242 A 18060 X	15	4-40 UNC Threaded insert	241 A 16460 X
26	4-40 UNC Threaded insert	242 A 18070 X	26	4-40 UNC Threaded insert	241 A 16470 X
44	4-40 UNC Threaded insert	242 A 18080 X	44	4-40 UNC Threaded insert	241 A 16480 X
62	4-40 UNC Threaded insert	242 A 18090 X	62	4-40 UNC Threaded insert	241 A 16490 X
15	M3 Threaded insert	242 A 18140 X	15	M3 Threaded insert	241 A 16540 X
26	M3 Threaded insert	242 A 18150 X	26	M3 Threaded insert	241 A 16550 X
44	M3 Threaded insert	242 A 18160 X	44	M3 Threaded insert	241 A 16560 X
62	M3 Threaded insert	242 A 18170 X	62	M3 Threaded insert	241 A 16570 X

Capacitance 830 pF

SOCKET CONNECTOR			PLUG CONNECTOR		
No. of pos.	Mounting style	Part Number	No. of pos.	Mounting style	Part Number
15	Through-hole	242 A 18020 X	15	Through-hole	241 A 16420 X
26	Through-hole	242 A 18030 X	26	Through-hole	241 A 16430 X
44	Through-hole	242 A 18040 X	44	Through-hole	241 A 16440 X
62	Through-hole	242 A 18050 X	62	Through-hole	241 A 16450 X
15	4-40 UNC Threaded insert	242 A 18100 X	15	4-40 UNC Threaded insert	241 A 16500 X
26	4-40 UNC Threaded insert	242 A 18110 X	26	4-40 UNC Threaded insert	241 A 16510 X
44	4-40 UNC Threaded insert	242 A 18120 X	44	4-40 UNC Threaded insert	241 A 16520 X
62	4-40 UNC Threaded insert	242 A 18130 X	62	4-40 UNC Threaded insert	241 A 16530 X
15	M3 Threaded insert	242 A 18180 X	15	M3 Threaded insert	241 A 16580 X
26	M3 Threaded insert	242 A 18190 X	26	M3 Threaded insert	241 A 16590 X
44	M3 Threaded insert	242 A 18200 X	44	M3 Threaded insert	241 A 16600 X
62	M3 Threaded insert	242 A 18210 X	62	M3 Threaded insert	241 A 16610 X

X-ON Electronics

Largest Supplier of Electrical and Electronic Components

Click to view similar products for [D-Sub High Density Connectors](#) category:

Click to view products by [CONEC](#) manufacturer:

Other Similar products are found below :

[97-3250-11](#) [163A17089X](#) [164A17199X](#) [164C18629X](#) [L717HDB44POL2R210](#) [L717HDEH15POL2](#) [L777HDE15P](#) [L77HDE15SC309](#)
[163A16759X](#) [163A16839X](#) [163A16989X](#) [163A17079X](#) [164A17329X](#) [164A18219X](#) [241A16440X](#) [241A16550X](#) [241A16680X](#)
[241A20810X](#) [241A25740X](#) [CT25-44P](#) [MDBE15PE766](#) [L177HDE15SOL2RM23](#) [L177HRC62SVFM](#) [L177HRCG62S](#)
[L717HDEG15POL2RM5](#) [L77HDA26SVF](#) [L77HDE15SD1CO](#) [L77HDEH15SOL2RM832](#) [DAMA-15S-WS](#) [443895-3](#) [106698-1](#) [280-](#)
[012K2C](#) [DBMV13H3SNA197](#) [L177HRB44S](#) [164A17039X](#) [09562004701510](#) [L777HRC62P](#) [241A17960X](#) [164A18269X](#) [280-019S1S9MEN](#)
[L777HDEG15P](#) [280-018P3S25MEGN](#) [206504-2](#) [40-9515HDSP](#) [2057140-1](#) [C115370-6002](#) [DFMA104SNMBFR172FR022](#) [HDC9F200E2S](#)
[L717HDAG26POL2RM8](#) [241A28180X](#)