

# C-FILTER D-SUB HIGH DENSITY

Solder pin – Angled – .350" / 7.98 mm – Precision machined contacts – Metal bracket

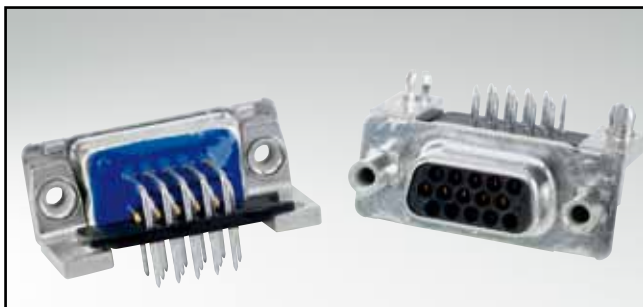

RoHS compliant – CSA listed, File No.: LR 115000-1 – UL listed, File No.: E202784

## DESCRIPTION

- Mounting styles:
  - with mounting bracket and 4-40 UNC or M3 threaded insert
  - with mounting bracket, PCB clip and 4-40 UNC or M3 threaded insert
- Quality class 3 (also available in quality class 1)
- Shell: Steel tin plated (brass tin plated on request)

## SOCKET CONNECTOR

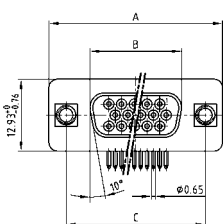

No. of pos.	A -0.76	B -0.25	C
15	31.19	16.46	25.00 <sup>+0.12</sup> / <sub>-0.13</sub>
26	39.52	24.79	33.30 <sup>+0.15</sup> / <sub>-0.10</sub>
44	53.42	38.50	47.04 <sup>+0.13</sup> / <sub>-0.10</sub>
62	69.70	54.96	63.50 <sup>+0.13</sup> / <sub>-0.10</sub>

PCB layout: Kat1iU1A

Mounting style: Threaded insert

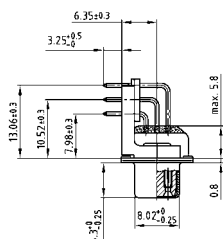
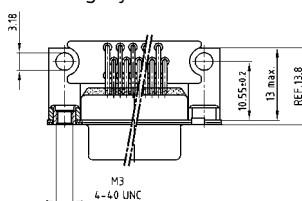

Mounting style: PCB clip, threaded insert

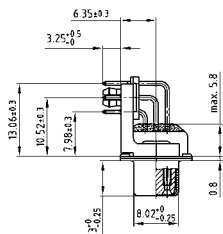
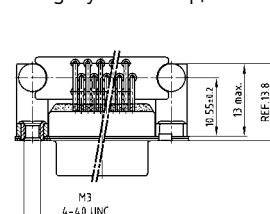

## PLUG CONNECTOR

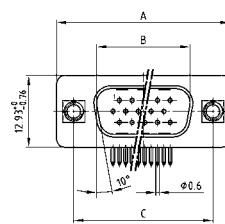

No. of pos.	A -0.76	B -0.25	C	D -0.3
15	31.19	16.79	25.00 <sup>+0.12</sup> / <sub>-0.13</sub>	6.12
26	39.52	25.12	33.30 <sup>+0.15</sup> / <sub>-0.10</sub>	6.12
44	53.42	38.84	47.04 <sup>+0.13</sup> / <sub>-0.10</sub>	5.99
62	69.70	55.30	63.50 <sup>+0.13</sup> / <sub>-0.10</sub>	5.99

PCB layout: Kat1iU2A

Mounting style: Threaded insert

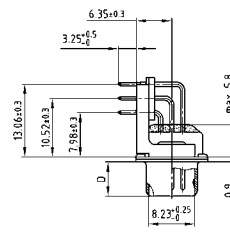
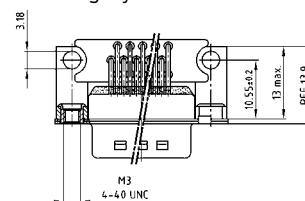

Mounting style: PCB clip, threaded insert

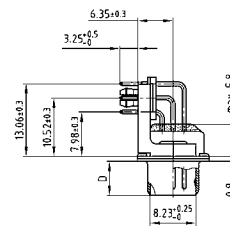
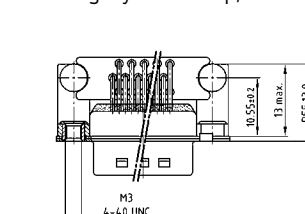

## ORDER DATA

### Capacitance 180 pF

#### SOCKET CONNECTOR

No. of pos.	Mounting style	Part Number
15	4-40 UNC Threaded insert	242 A 28020 X
26	4-40 UNC Threaded insert	242 A 28030 X
44	4-40 UNC Threaded insert	242 A 28040 X
62	4-40 UNC Threaded insert	242 A 28050 X
15	M3 Threaded insert	242 A 28060 X
26	M3 Threaded insert	242 A 28070 X
44	M3 Threaded insert	242 A 28080 X
62	M3 Threaded insert	242 A 28090 X
15	PCB clip / 4-40 UNC Threaded insert	242 A 28180 X
26	PCB clip / 4-40 UNC Threaded insert	242 A 28190 X
44	PCB clip / 4-40 UNC Threaded insert	242 A 28200 X
62	PCB clip / 4-40 UNC Threaded insert	242 A 28210 X
15	PCB clip / M3 Threaded insert	242 A 28220 X
26	PCB clip / M3 Threaded insert	242 A 28230 X
44	PCB clip / M3 Threaded insert	242 A 28240 X
62	PCB clip / M3 Threaded insert	242 A 28250 X

#### PLUG CONNECTOR

No. of pos.	Mounting style	Part Number
15	4-40 UNC Threaded insert	241 A 28120 X
26	4-40 UNC Threaded insert	241 A 28130 X
44	4-40 UNC Threaded insert	241 A 28140 X
62	4-40 UNC Threaded insert	241 A 28150 X
15	M3 Threaded insert	241 A 28160 X
26	M3 Threaded insert	241 A 28170 X
44	M3 Threaded insert	241 A 28180 X
62	M3 Threaded insert	241 A 28190 X
15	PCB clip / 4-40 UNC Threaded insert	241 A 28280 X
26	PCB clip / 4-40 UNC Threaded insert	241 A 28290 X
44	PCB clip / 4-40 UNC Threaded insert	241 A 28300 X
62	PCB clip / 4-40 UNC Threaded insert	241 A 28310 X
15	PCB clip / M3 Threaded insert	241 A 28320 X
26	PCB clip / M3 Threaded insert	241 A 28330 X
44	PCB clip / M3 Threaded insert	241 A 28340 X
62	PCB clip / M3 Threaded insert	241 A 28350 X

PCB clip .122" / 3.1 ± .004" / 0.10 mm hole diameter and .063" / 1.6 mm circuit board thickness

# C-FILTER D-SUB HIGH DENSITY

Solder pin – Angled – .350" / 7.98 mm – Precision machined contacts – Metal bracket

**ORDER DATA**

**Capacitance 370 pF**

SOCKET CONNECTOR			PLUG CONNECTOR		
No. of pos.	Mounting style	Part Number	No. of pos.	Mounting style	Part Number
15	4-40 UNC Threaded insert	242 A 19810 X	15	4-40 UNC Threaded insert	241 A 18220 X
26	4-40 UNC Threaded insert	242 A 19820 X	26	4-40 UNC Threaded insert	241 A 18230 X
44	4-40 UNC Threaded insert	242 A 19830 X	44	4-40 UNC Threaded insert	241 A 18240 X
62	4-40 UNC Threaded insert	242 A 19840 X	62	4-40 UNC Threaded insert	241 A 18250 X
15	M3 Threaded insert	242 A 19890 X	15	M3 Threaded insert	241 A 18300 X
26	M3 Threaded insert	242 A 19900 X	26	M3 Threaded insert	241 A 18310 X
44	M3 Threaded insert	242 A 19910 X	44	M3 Threaded insert	241 A 18320 X
62	M3 Threaded insert	242 A 19920 X	62	M3 Threaded insert	241 A 18330 X
15	PCB clip / 4-40 UNC Threaded insert	242 A 19490 X	15	PCB clip / 4-40 UNC Threaded insert	241 A 17900 X
26	PCB clip / 4-40 UNC Threaded insert	242 A 19500 X	26	PCB clip / 4-40 UNC Threaded insert	241 A 17910 X
44	PCB clip / 4-40 UNC Threaded insert	242 A 19510 X	44	PCB clip / 4-40 UNC Threaded insert	241 A 17920 X
62	PCB clip / 4-40 UNC Threaded insert	242 A 19520 X	62	PCB clip / 4-40 UNC Threaded insert	241 A 17930 X
15	PCB clip / M3 Threaded insert	242 A 19570 X	15	PCB clip / M3 Threaded insert	241 A 17980 X
26	PCB clip / M3 Threaded insert	242 A 19580 X	26	PCB clip / M3 Threaded insert	241 A 17990 X
44	PCB clip / M3 Threaded insert	242 A 19590 X	44	PCB clip / M3 Threaded insert	241 A 18000 X
62	PCB clip / M3 Threaded insert	242 A 19600 X	62	PCB clip / M3 Threaded insert	241 A 18010 X

**Capacitance 830 pF**

SOCKET CONNECTOR			PLUG CONNECTOR		
No. of pos.	Mounting style	Part Number	No. of pos.	Mounting style	Part Number
15	4-40 UNC Threaded insert	242 A 19850 X	15	4-40 UNC Threaded insert	241 A 18260 X
26	4-40 UNC Threaded insert	242 A 19860 X	26	4-40 UNC Threaded insert	241 A 18270 X
44	4-40 UNC Threaded insert	242 A 19870 X	44	4-40 UNC Threaded insert	241 A 18280 X
62	4-40 UNC Threaded insert	242 A 19880 X	62	4-40 UNC Threaded insert	241 A 18290 X
15	M3 Threaded insert	242 A 19930 X	15	M3 Threaded insert	241 A 18340 X
26	M3 Threaded insert	242 A 19940 X	26	M3 Threaded insert	241 A 18350 X
44	M3 Threaded insert	242 A 19950 X	44	M3 Threaded insert	241 A 18360 X
62	M3 Threaded insert	242 A 19960 X	62	M3 Threaded insert	241 A 18370 X
15	PCB clip / 4-40 UNC Threaded insert	242 A 19530 X	15	PCB clip / 4-40 UNC Threaded insert	241 A 17940 X
26	PCB clip / 4-40 UNC Threaded insert	242 A 19540 X	26	PCB clip / 4-40 UNC Threaded insert	241 A 17950 X
44	PCB clip / 4-40 UNC Threaded insert	242 A 19550 X	44	PCB clip / 4-40 UNC Threaded insert	241 A 17960 X
62	PCB clip / 4-40 UNC Threaded insert	242 A 19560 X	62	PCB clip / 4-40 UNC Threaded insert	241 A 17970 X
15	PCB clip / M3 Threaded insert	242 A 19610 X	15	PCB clip / M3 Threaded insert	241 A 18020 X
26	PCB clip / M3 Threaded insert	242 A 19620 X	26	PCB clip / M3 Threaded insert	241 A 18030 X
44	PCB clip / M3 Threaded insert	242 A 19630 X	44	PCB clip / M3 Threaded insert	241 A 18040 X
62	PCB clip / M3 Threaded insert	242 A 19640 X	62	PCB clip / M3 Threaded insert	241 A 18050 X

PCB clip .122" / 3.1 ± .004" / 0.10 mm hole diameter and .063" / 1.6 mm circuit board thickness

## X-ON Electronics

Largest Supplier of Electrical and Electronic Components

*Click to view similar products for [D-Sub High Density Connectors](#) category:*

*Click to view products by [CONEC](#) manufacturer:*

Other Similar products are found below :

[97-3250-11](#) [163A17089X](#) [164A17199X](#) [164C18629X](#) [L717HDB44POL2R210](#) [L717HDEH15POL2](#) [L777HDE15P](#) [L77HDE15SC309](#)  
[163A16759X](#) [163A16839X](#) [163A16989X](#) [163A17079X](#) [164A17329X](#) [164A18219X](#) [241A16440X](#) [241A16550X](#) [241A16680X](#)  
[241A20810X](#) [241A25740X](#) [CT25-44P](#) [MDBE15PE766](#) [L177HDE15SOL2RM23](#) [L177HRC62SVFM](#) [L177HRCG62S](#)  
[L717HDEG15POL2RM5](#) [L77HDA26SVF](#) [L77HDE15SD1CO](#) [L77HDEH15SOL2RM832](#) [DAMA-15S-WS](#) [443895-3](#) [106698-1](#) [280-](#)  
[012K2C](#) [DBMV13H3SNA197](#) [L177HRB44S](#) [164A17039X](#) [09562004701510](#) [L777HRC62P](#) [241A17960X](#) [164A18269X](#) [280-019S1S9MEN](#)  
[L777HDEG15P](#) [280-018P3S25MEGN](#) [206504-2](#) [40-9415HDSP](#) [40-9515HDSP](#) [2057140-1](#) [C115370-6002](#) [DFMA104SNMBFR172FR022](#)  
[HDC9F200E2S](#) [L717HDAG26POL2RM8](#)