

High Density D-Sub Surface Mount 15 position Female Type

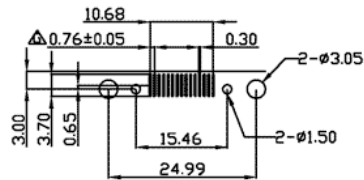

Pin Number :  
6 11 1 7 12 2 8 13 3 9 14 4 10 15 5  
Recommended PCB Layout

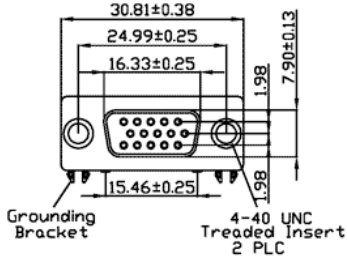
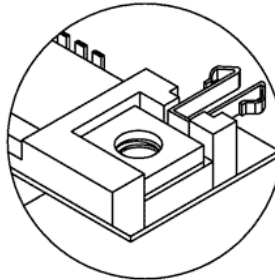
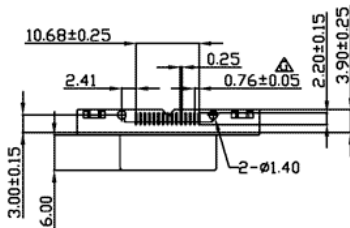
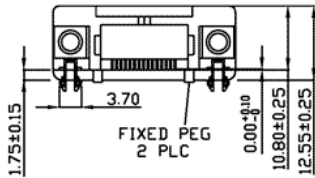

Fork Board Lock Type

Material And Finish	
Shell	Steel tin plated over nickel
Bracket	Brass strip -H nickel plated
Screw	Brass nickel plated
Insulator	Nylon 6T Fiber reinforced UL - 94VO, Color black
Contact Material ( socket )	Phosphor bronze Duplex Plated As Follows: A - 30μ" gold on mating area. Tin plated over nickel on termination area. B - 15μ" gold on mating area. Tin plated over nickel on termination area. C - Gold flash on mating area. Tin plated over nickel on termination area.
Specifications	
Rated Current	3A
Rated Voltage	300V DC
Withstanding Voltage	500V(r.m.s) AC for 1 minute
Insulation Resistance	more than 1000M ohm at 500V DC
Contact Resistance	13M ohm Max.
Dielectric Strength	1000V AC Min. for 1 minute
Temperature	-55 °C ~ +105 °C

Part Numbers

Part Number	Duplex Plated
-------------	---------------

33DSMT1-E15SNAT	30 $\mu$ " gold on mating area. Tin plated over nickel on termination area.
33DSMT1-E15SNBT	15 $\mu$ " gold on mating area. Tin plated over nickel on termination area.
33DSMT1-E15SNCT	Gold flash on mating area. Tin plated over nickel on termination area.

## X-ON Electronics

Largest Supplier of Electrical and Electronic Components

*Click to view similar products for [D-Sub Mixed Contact Connectors](#) category:*

*Click to view products by [CONEC](#) manufacturer:*

Other Similar products are found below :

[790-025SF-5P5NMN](#) [790-025SJ-7P7NML](#) [DAM-7W2PC](#) [L717TWB5W5P3R](#) [L717TWB5W5PRM84](#) [L717TWP3W3P](#)  
[3003W3PXX56N40X](#) [3005W5PXX99E40X](#) [3005W5SXX99A30X](#) [3005W5SXX99E40X](#) [3013W6SCM99A10X](#) [3036W4PCM41A10X](#)  
[3036W4SCM99A10X](#) [FCE17-E2W2SS-2N0](#) [212522-7](#) [PII-468-1](#) [3003W3PXX43A10X](#) [3003W3SXX56N40X](#) [3005W5PXX88N40X](#)  
[3008W8SXX57A30X](#) [3009W4PCT57P20X](#) [3017W2SAR69C40X](#) [3024W7SCM99A10X](#) [302W2CPXX56N40X](#) [321WA4PXK99A60X](#)  
[321WA4SCT56N40X](#) [3F3SSC22S41A30X](#) [L717TWA7W2PP2SY3R](#) [DBM-17W2S-1A8N-A190-A197-1](#) [421WA4PCR50E20X](#)  
[09693009176](#) [09693909015](#) [6017W2PCM41B30X](#) [790-061SH-36W2NMNA](#) [790-044SE-7P3MNPB](#) [790-043PE-11P2MPA](#) [790-043PB-](#)  
[2P2MPB](#) [790-029SB-2P2MEPA](#) [790-028PK-9P9MPA](#) [790-028PH-54P2MGA](#) [790-028PH-36P2MNA](#) [790-028PB-2P2MPA](#) [790-027SH-](#)  
[5W5MTEP](#) [790-026PH-54P2ZNUG](#) [790-026PH-54P2MP](#) [790-026PH-36P2ZNUG](#) [790-026PH-36P2MG](#) [790-026PD-3P3MP](#) [790-025SJ-](#)  
[7P7EMS](#) [790-025SH-36W2NMT](#)