

used for:

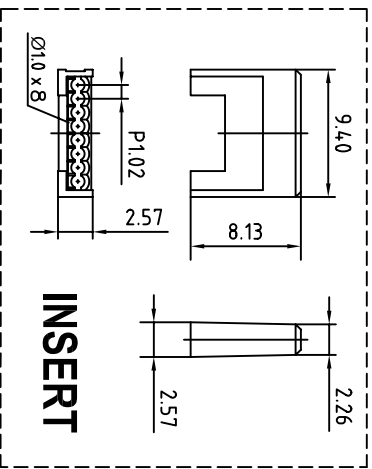
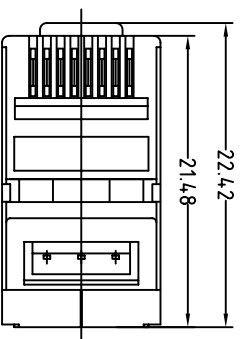
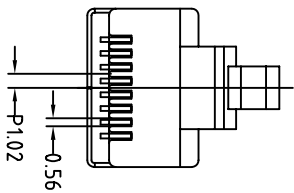
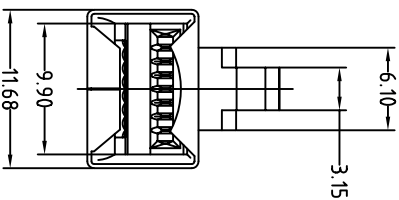
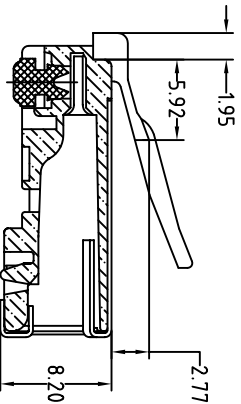
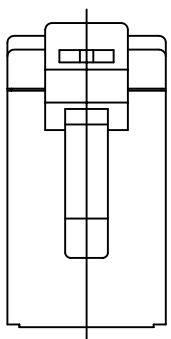

INSERT

Notes:

1. Electrical Specifications:

- Meets TIA/EIA-606-B.2 and IEC60603-7-3 Specifications
- Contact Resistance: 20 mOhm max.
- Termination Resistance: 35 mOhm max.
- Insulation Resistance: 500 MOhm min @ 100V DC
- Current Rating 1.5A max @ 25°C
- DWV: 1000V DC/60s Contact to Contact
- 1500V DC/60s Contact to Metal Shell
- Operation Temperature: -40°C to +125°C.

2. Material and Finish:

- ⓑ Housing: Polycarbonate, UL94 V-0, Color: Transparency
- Shell: Copper Alloy with 50u" min Nickel Plating
- Contact: Phosphor Bronze.
- Contact Finish: 50u" Au min over 50u" min Nickel

3. Suitable for AWG24 - 26 Stranded and Solid Wires

4. Cable Tensile Strength: 7.7kg

5. RoHS compliant



THIS DRAWING MAY NOT BE COPIED OR REPRODUCED IN ANY WAY, AND MAY NOT BE PASSED ON TO A THIRD PARTY WITHOUT WRITTEN PERMISSION. OWNERSHIP AND COPYRIGHT OF CONEC CORPORATION

DO NOT ALTER CAD DRAWING BY HAND

tolerance unless otherwise specified tolerance shall be as follow

Decimal: X .44.25

xx .48.10

Angles: 3°

rev	a	b	origin	date	name
			May/15/07		Vincent Ke

finish

2006

date

name

draw: Vincent Ke

appd: J. Chaudry

norm

d-did

scale:

material: SEE NOTES

title: Shielded Cat. 5e RJ45 Plug with one Insert with 2 prongs pin for both stranded & solid wires

RoHS compliant

drawing no.: AutoCAD 2005

part no.: 39K1A270

391J00039X

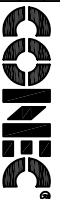

DIN A3 Sheet 1/1

X-ON Electronics

Largest Supplier of Electrical and Electronic Components

Click to view similar products for [Modular Connectors / Ethernet Connectors](#) category:

Click to view products by [CONEC](#) manufacturer:

Other Similar products are found below :

[8949-H88/06BLKA/SN](#) [74441-0010/BKN](#) [MP1010RX-1000](#) [MP44RX-1000](#) [PHJ-4P4C-1-V-4](#) [PHP-6P6C-5](#) [GAX-3-66](#) [GAX-8-62](#) [GDCX-PA-66-50](#) [GDCX-PN-64](#) [GDCX-PN-66](#) [GDCX-PN-66-50](#) [GDLX-A-66](#) [GDLX-N-66](#) [GDLX-S-66](#) [GDLX-S-88K](#) [GDLX-SMT-S-88](#) [GDTX-S-88-50](#) [GDX-PA-1010](#) [GLX-N-1010M-BLK](#) [GLX-S-88M-BLK](#) [GMX-N-1010](#) [GMX-S-1010](#) [GMX-S-66](#) [GMX-SMT4-N-88](#) [GPX-2-64](#) [GSGX-N-2-88](#) [GSGX-N-4-88](#) [GSX-NS2-88-3.05](#) [GSX-NS2-88-3.05-50](#) [GSX-NS-88-3.05-50](#) [PT-108A-8C-UL](#) [PT-J951-8C](#) [PTS-J531-8CS-50UL](#) [1-1775629-2](#) [A-2014-0-4](#) [GWLX-S-88-GR](#) [GWLX-S9-88-YG](#) [DC-1021-8-WH-6](#) [1300530003](#) [1324640-4](#) [RJ11FTVC2G](#) [RJ11FTVC2N](#) [RJFTVX2SA1G](#) [132764-001](#) [1413235](#) [MP88X-1000](#) [MPS88RX-5000](#) [E5288-S000K3-L](#) [E5908-15A242-L](#)