

**Technical specification:**

Rated voltage: IEC 60664-1	300 V
Overvoltage category: IEC 60664-1	2
Overvoltage: IEC 60664-1	2,7 kV
Current rating: IEC 60512-3 at 40°C	0,75mm <sup>2</sup> 1,5mm <sup>2</sup> 8 A 10 A
Insulation resistance: IEC 60512	>=100 MΩ
Pollution degree: IEC 60664-1	3/2
Degree of protection: IEC 60529	IP 68, in mated condition
Temperature range: IEC 60664-1	-30°C ... +80°C
Mating cycles: IEC 60512-9a	>=100
Termination:	crimped

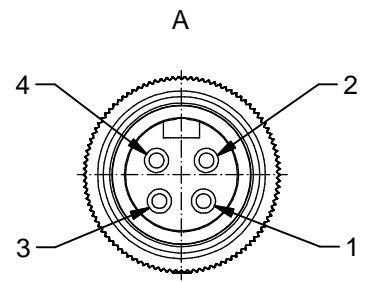

**Contact assignment:**

- 1 ■ brown
- 2 ■ white
- 3 ■ blue
- 4 ■ black

**Materials:**

Contact:	CuZn
Contact plating:	Nickel, gold plated
Contact carrier:	TPU, UL 94
Coupling screw:	CuZn, nickel plated
Moulding body:	TPU, UL 94, grey

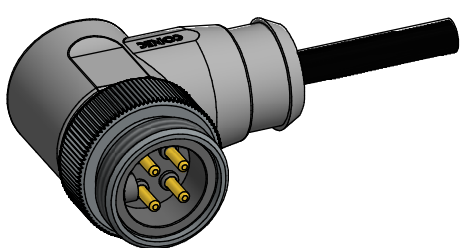

Part no:	Description:	Length L:	Cable:
41-01060	SAL - 7/8 - RSW4 - 2 / K1	2m	TPU, UL 20549, black, 4x0,75mm <sup>2</sup> Cable: 781-K1740G
41-01061	SAL - 7/8 - RSW4 - 3 / K1	3m	
41-01062	SAL - 7/8 - RSW4 - 5 / K1	5m	
41-01063	SAL - 7/8 - RSW4 - 10 / K1	10m	
41-xxxxx	SAL - 7/8 - RSW4 - x / K1	x	
41-01157	SAL - 7/8 - RSW4 - 2 / K1 / 150	2m	TPU, UL 20549, black, 4x1,50mm <sup>2</sup> Cable: 781-K1840G
41-01158	SAL - 7/8 - RSW4 - 3 / K1 / 150	3m	
41-01159	SAL - 7/8 - RSW4 - 5 / K1 / 150	5m	
41-01160	SAL - 7/8 - RSW4 - 10 / K1 / 150	10m	
41-xxxxx	SAL - 7/8 - RSW4 - x / K1 / 150	x	

D see data sheet cable

DO NOT ALTER CAD DRAWING BY HAND Directive 2002/95/EC RoHS compliant	Index: c 02.09.10 KH Ä3736 technical specification changed, part no. cable in table added, neutral line added	dim. in mm	title: <h2 style="margin: 0;">Male connector 7/8" angled</h2>							
	tolerance of cable: L ≤ 4m: L + 40mm L > 4m: L + 1%	<table border="1" style="width: 100%; border-collapse: collapse;"> <tr> <td style="width: 30px;">date</td> <td style="width: 100px;">name</td> </tr> <tr> <td>drawn 11.10.07</td> <td>Franz</td> </tr> <tr> <td>appd. 11.10.07</td> <td>Mankopf</td> </tr> </table>			date	name	drawn 11.10.07	Franz	appd. 11.10.07	Mankopf
	date	name								
	drawn 11.10.07	Franz								
appd. 11.10.07	Mankopf									
general tolerance: 0 ± 0,50mm 0,0 ± 0,25mm 0,00 ± 0,10mm										
THIS DRAWING MAY NOT BE COPIED OR REPRODUCED IN ANY WAY, AND MAY NOT BE PASSED ON TO A THIRD PARTY WITHOUT WRITTEN PERMISSION. OWNERSHIP AND COPYRIGHT OF CONEC GmbH			part no: <h2 style="margin: 0;">see table</h2>							

## X-ON Electronics

Largest Supplier of Electrical and Electronic Components

*Click to view similar products for [Sensor Cables / Actuator Cables](#) category:*

*Click to view products by [CONEC](#) manufacturer:*

Other Similar products are found below :

[60963](#) [60964](#) [703000D02F2002](#) [703000D02F300](#) [703001D02F0602](#) [703001D02F1201](#) [703001D02F300](#) [704000D02F120](#) [773032K02F030](#)  
[802027107404-1](#) [802027213811-1](#) [804001A09M150](#) [805001A09M0502](#) [84914-0235](#) [84914-0237](#) [885030A09M020](#) [1200651332](#)  
[1200651713](#) [1200660844](#) [1200660845](#) [1200661173](#) [1200680071](#) [1200720053](#) [1200720081](#) [1200720099](#) [1200720217](#) [1200800231](#)  
[1200860125](#) [1200870123](#) [1200980102](#) [1200650267](#) [1200650298](#) [1200660183](#) [1200660782](#) [1200660849](#) [1200661295](#) [1200661297](#)  
[1200661342](#) [1200661343](#) [1200670080](#) [1200670220](#) [1200680331](#) [1200720252](#) [1200720255](#) [1200730184](#) [1200860344](#) [1200870359](#)  
[1200870643](#) [1200980008](#) [1200980031](#)