

# D-SUB STANDARD – DUAL PORT

Solder pin – Angled – Stamped contacts – .625" / 15.88 mm Connector spacing



RoHS compliant – CSA listed, File No.: LR 115000-1 – UL listed, File No.: E202784

## DESCRIPTION

- Variations: pin – pin; socket – socket; pin – socket
- Mounting style:  
with mounting bracket, PCB clip and  
4-40 UNC threaded insert
- Quality class 3 (other quality classes on request)
- Shell: Steel tin plated

## PRODUCT DRAWING

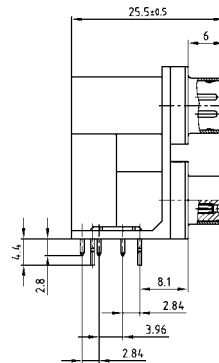
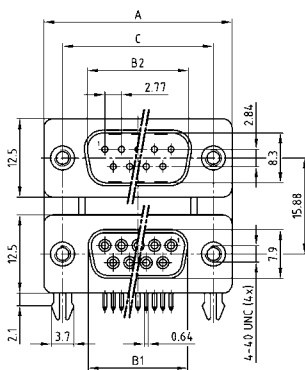

No. of pos.	A	B1	B2	C
2X 09	30.80	16.30	16.92	25.00
2X 15	39.20	24.60	25.25	33.30
2X 25	53.10	38.30	38.96	47.04
2X 37	69.40	54.80	55.42	63.50

Graphically representation of only one variant!

Mounting style: PCB clip, threaded insert

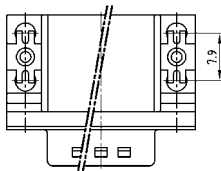

# D-SUB STANDARD – DUAL PORT VARIATIONS

Solder pin – Angled – Stamped contacts – .625" / 15.88 mm Connector spacing

## ORDER DATA

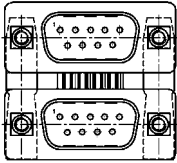

No. of pos.	Mounting style 4-40 UNC	Part Number
09 / 09	PCB clip/Threaded insert	DLS 1PP5AN21 X
15 / 15	PCB clip/Threaded insert	DLS 2PP5AN21 X
25 / 25	PCB clip/Threaded insert	DLS 3PP5AN21 X
37 / 37	PCB clip/Threaded insert	DLS 4PP5AN21 X

Variation:  
plug upper –  
plug bottom

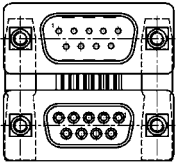

No. of pos.	Mounting style 4-40 UNC	Part Number
09 / 09	PCB clip/Threaded insert	DLS 1PS5AN21 X
15 / 15	PCB clip/Threaded insert	DLS 2PS5AN21 X
25 / 25	PCB clip/Threaded insert	DLS 3PS5AN21 X
37 / 37	PCB clip/Threaded insert	DLS 4PS5AN21 X

Variation:  
plug upper –  
socket bottom

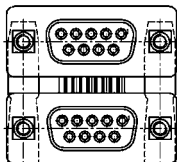

No. of pos.	Mounting style 4-40 UNC	Part Number
09 / 09	PCB clip/Threaded insert	DLS 1SS5AN21 X
15 / 15	PCB clip/Threaded insert	DLS 2SS5AN21 X
25 / 25	PCB clip/Threaded insert	DLS 3SS5AN21 X
37 / 37	PCB clip/Threaded insert	DLS 4SS5AN21 X

Variation:  
socket upper –  
socket bottom

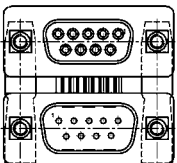

No. of pos.	Mounting style 4-40 UNC	Part Number
09 / 09	PCB clip/Threaded insert	DLS 1SP5AN21 X
15 / 15	PCB clip/Threaded insert	DLS 2SP5AN21 X
25 / 25	PCB clip/Threaded insert	DLS 3SP5AN21 X
37 / 37	PCB clip/Threaded insert	DLS 4SP5AN21 X

PCB clip .122" / 3.1 ± .004" / 0.10 mm hole diameter and .063" / 1.6 mm circuit board thickness

Variation:  
socket upper –  
plug bottom

## X-ON Electronics

Largest Supplier of Electrical and Electronic Components

*Click to view similar products for [D-Sub Dualport Connectors](#) category:*

*Click to view products by [CONEC](#) manufacturer:*

Other Similar products are found below :

[787672-3](#) [164A15909X](#) [K42X-E15S/S-A4NJ](#) [K42X-E9SS-A4NJ](#) [242A14060X](#) [164A15819X](#) [DLS2SS5AN21X](#) [241A22450X](#) [242A14180X](#)  
[241A14190X](#) [DLS4SS5AN21X](#) [178-037-513R491](#) [178-037-613R491](#) [178-009-413R571](#) [178-009-513R571](#) [178-009-613R491](#) [178-009-613R691](#) [178-015-513R571](#) [178-015-613R571](#) [178-025-513R571](#) [179-009-513R571](#) [179-009-613R571](#) [179-025-513R571](#) [179-037-513R571](#)  
[K42X-E15S/S-A4N](#) [K42X-E9S/P-A4N](#) [L17H2220131](#) [178-015-513R491](#) [178-025-613R481](#) [178-025-613R571](#) [178-037-513R571](#) [178-037-513R671](#) [L17H2220120](#) [L17H2ED0130](#) [L17H1440130](#) [L17H1770231](#) [L17H2110120](#) [L17H2440120TM](#) [L17H1431134](#) [L17H1212130](#)  
[L17H2212120](#) [L17H1222134](#) [L17H2662120TM](#) [L17H2550120](#) [L17H2440120](#) [L17H2440121](#) [L17H1120134](#) [L17H2120120](#) [L17H2120230](#)  
[L17H1440134](#)