

used for:

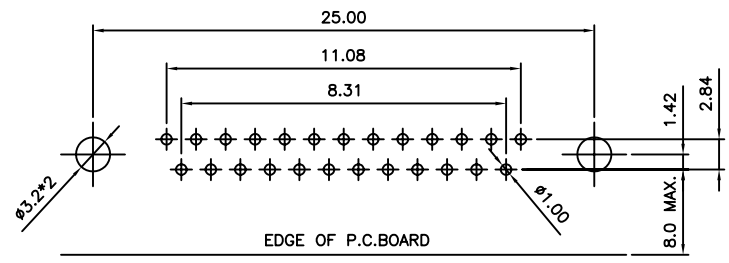
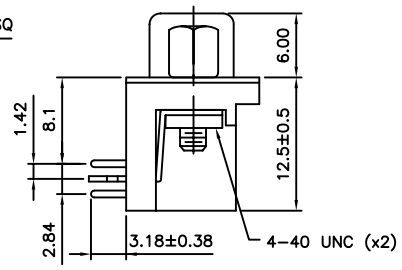
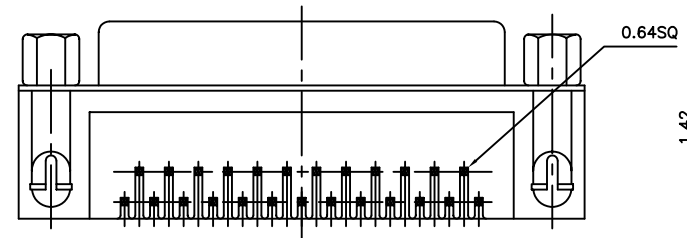
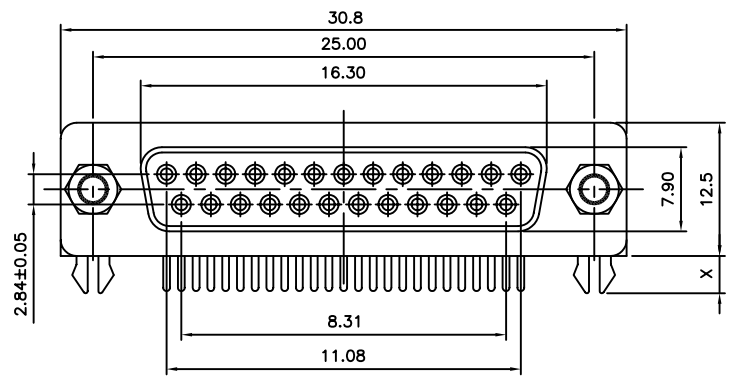

RECOMMENDED P.C.B LAYOUT (TOP VIEW)
TOLERANCES: ±0.05mm

SPECIFICATION

MATERIAL

Insulator: Thermal Plastic UL94V-0
Contacts: Copper Alloy
Shell: Steel
Rivet, Boardlock: Copper Alloy

CONTACT PLATING

Underplate: 50u" Nickel
Contact Area: Selective Gold
Solder Tails Area: 100u" Tin/Lead Free

ELECTRICAL

Operation Voltage: 250 VAC Max.
Current Rating: 3 Amps Max.
Contact Resistance: 15 mohms Max.
Insulation Resistance: 3000 Mohms Min @ 500 VDC
Dielectric Withstanding Voltage: 1000 VAC / Minute
Operating Temperature: -55°C To +105°C

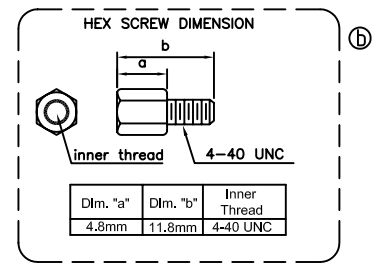

THIS DRAWING MAY NOT BE COPIED OR REPRODUCED IN ANY WAY, AND MAY NOT BE PASSED ON TO A THIRD PARTY WITHOUT WRITTEN PERMISSION. OWNERSHIP AND COPYRIGHT OF CONEC CORPORATION. DO NOT ALTER CAD DRAWING BY HAND.

tolerance		finish	
unless otherwise specified tolerance shall be as follow			
Decimal:	x .±0.50		
	.x ±0.30		
	.xx ±0.20		
Angles: ±5°		Dim. in mm	
rev.	description	date	name
b	Dec/14/07	Vincent Ke	
a	origin		

2005	date	name
draw.	Oct. 03	Vincent Ke
appd.	Oct. 03	Kathy
norm		
d-old		



scale:	
material:	SEE NOTES
title:	D-Sub R/A 7.2mm 9pos. female
	RoHS compliant
drawing no.:	AutoCAD 2005
	C0510K01A
part no.:	DLS1XS5AK40X

DIN A3 sheet 1/1

X-ON Electronics

Largest Supplier of Electrical and Electronic Components

Click to view similar products for [D-Sub Standard Connectors](#) category:

Click to view products by [CONEC](#) manufacturer:

Other Similar products are found below :

[56F711-015](#) [012-9507-004](#) [LV242999-142T12](#) [015-0341-000](#) [015-0349-000](#) [015-0372-005](#) [015-0372-008](#) [015-8755-001](#) [020419-0104](#) [012-0467-000](#) [012-0515-000](#) [012-9507-034](#) [012-9507-114](#) [020745-0008](#) [609-25P](#) [M24308315F](#) [CT2-14S-2PCA34](#) [CT2-18-11PCAU](#) [CT2-36-15SC](#) [CT6-14S-2SC](#) [CT6E14SA7SC](#) [CT6E22-14PC](#) [CT6E22-14PS](#) [CT6E22-22PS](#) [M83513/01-FC](#) [M85049/48-3-2F](#) [6STD09PCM99B70X](#) [6STD09SCM99B30X](#) [6STD09SCT99S40X](#) [6STD15PCT99S40X](#) [6STD15SCM99B30X](#) [6STD15SCT99S40X](#) [6STF09PCM05B70X](#) [7-135760-9](#) [MC11E-10-6SN](#) [747552-3](#) [MD1-21PS](#) [MDM-15SCBRM7-F222](#) [MDM96517-699](#) [MDM96521-744](#) [MDVB1-21SL1](#) [MIK0-1-7SH003](#) [MIKQ6-7SH076](#) [MIKQ7-7PH077](#) [MIKQ7-7PH11](#) [MIKQ7-7PH32](#) [MIKQ9-7PH003](#) [MJSV-28SL61](#) [MKJ4A1F14-55S](#) [8-135760-3](#)