

used for: DUAL-PORT

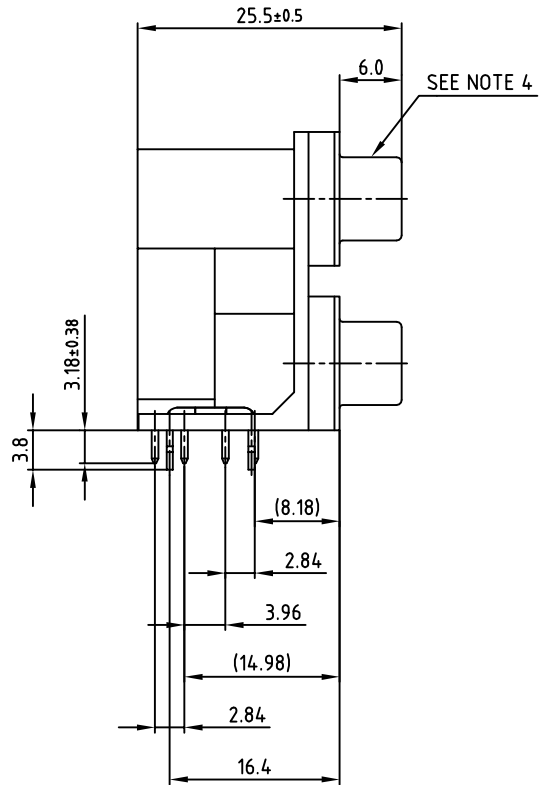
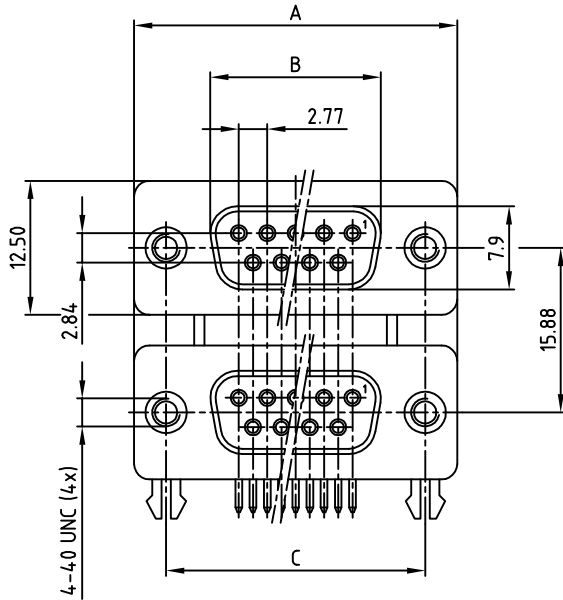
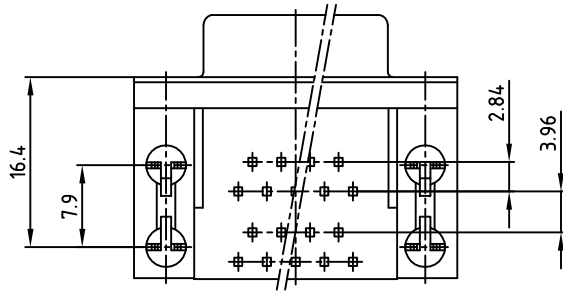

No. of pos.	A	B	C	Part No.
2 x 9	30.8	16.30	25.00	DLS1SS5AN21X
2 x 15	39.2	24.60	33.30	DLS2SS5AN21X
2 x 25	53.1	38.30	47.10	DLS3SS5AN21X
2 x 37	69.4	54.80	63.50	DLS4SS5AN21X

SPECIFICATION:

1. MATERIAL:

INSULATOR: THERMAL PLASTIC UL 94 V-0
 CONTACTS: COPPER ALLOY
 SHELL: STEEL
 RIVET, BOARDLOCK: COPPER ALLOY

2. CONTACT PLATING:

UNDERPLATE: 50µin ~ 100µin NICKEL
 CONTACT AREA: GOLD FLASH
 SOLDER TAILS AREA: GOLD PLATED

3. ELECTRICAL:

OPERATION VOLTAGE: 250 VAC max.
 CURRENT RATING: 3 A max.
 CONTACT RESISTANCE: 25 mOHM max.
 INSULATION RESISTANCE: 3000 MOHM min. @ 500 VDC
 DIELECTRIC WITHSTANDING VOLTAGE: 1000 VAC / MINUTE
 TEMPERATURE RANGE: -55°C TO +105°C

4. CONNECTOR IS PART MARKED: [PART-NO. CONEC ABC]

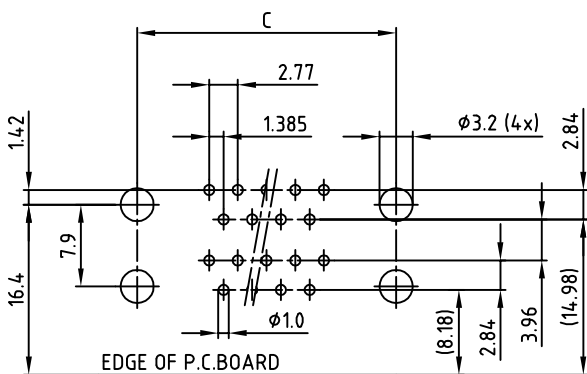

RECOMMENDED P.C.B. LAYOUT (TOP VIEW)
 TOLERANCES: ±0.05mm

THIS DRAWING MAY NOT BE COPIED OR REPRODUCED IN ANY WAY, AND MAY NOT BE PASSED ON TO A THIRD PARTY, WITHOUT WRITTEN PERMISSION. OWNERSHIP AND COPYRIGHT OF CONEC Gmbh DO NOT ALTER CAD DRAWING BY HAND

UNLESS OTHERWISE SPECIFIED TOLERANCE		name	
mm	inch	date	name
±0.5	±0.02	2013	Lehmenkühler
0.6	±0.3	drawn	20.03.
0.00	±0.2	appd.	20.03.
		norm	
		d-old	C041K07D
1 x b	Ä4983	11.11.2013	Lehmen
a	Original		
rev.	description	date	name

scale:	2:1
material:	SEE SPECIFICATION
title:	DUAL-PORT 15.88mm FEMALE / FEMALE 2x9pos. - 2x37pos. with PCB Clips
dwg no:	AutoCAD 2013
part no:	SEE TABLE
DIN-A	3
sh:	1/1

Directive 2002/95/EC RoHS compliant



X-ON Electronics

Largest Supplier of Electrical and Electronic Components

Click to view similar products for [D-Sub Dualport Connectors](#) category:

Click to view products by [CONEC](#) manufacturer:

Other Similar products are found below :

[787672-3](#) [164A15909X](#) [K42X-E15S/S-A4NJ](#) [K42X-E9SS-A4NJ](#) [242A14060X](#) [164A15819X](#) [DLS2SS5AN21X](#) [241A22450X](#) [242A14180X](#)
[241A14190X](#) [DLS4SS5AN21X](#) [178-037-513R491](#) [178-037-613R491](#) [178-009-413R571](#) [178-009-513R571](#) [178-009-613R491](#) [178-009-613R691](#) [178-015-513R571](#) [178-015-613R571](#) [178-025-513R571](#) [179-009-513R571](#) [179-009-613R571](#) [179-025-513R571](#) [179-037-513R571](#)
[K42X-E15S/S-A4N](#) [K42X-E9S/P-A4N](#) [L17H2220131](#) [178-015-513R491](#) [178-025-613R481](#) [178-025-613R571](#) [178-037-513R571](#) [178-037-513R671](#) [L17H2220120](#) [L17H2ED0130](#) [L17H1440130](#) [L17H1770231](#) [L17H2110120](#) [L17H2440120TM](#) [L17H1431134](#) [L17H1212130](#)
[L17H2212120](#) [L17H1222134](#) [L17H2662120TM](#) [L17H2550120](#) [L17H2440120](#) [L17H2440121](#) [L17H1120134](#) [L17H2120120](#) [L17H2120230](#)
[L17H1440134](#)