

Semi-Rigid
Cable -Direct
Solder Attachment

Finish: gold plated center contact & body
Insulation: Teflon

Ordering Code	Applicable Cable RG/U	Notes
SMA-50SAG7812BRX	RG 402/U (.141")	
SMA-50SAG7813BRX	RG 405/U (.085")	

7. SMA Straight Plug Clamp

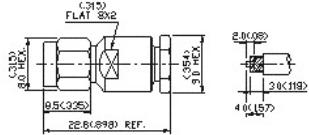

Flexible
Cable -Clamp
Attachment

Finish: gold plated center contact & body
Insulation: Teflon

Ordering Code	Applicable Cable RG/U	Notes
SMA-50PAG0704BRX	RG 402/U (.141")	
SMA-50PAG0702BRX	RG 405/U (.085")	

8. SMA Right Angle Plug Crimp

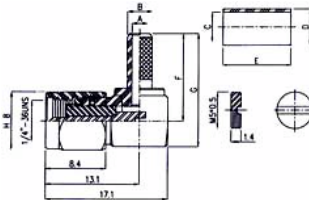

Flexible
Cable -Clamp
Attachment

Finish: gold plated center contact & body
Insulation: Teflon

Ordering Code	Applicable Cable RG/U	Notes
SMA-50PAG0404BRX	58,58A,141A	
SMA-50PAG0402BRX	174,188A,316	
SMA-50PAG0416BRX	142B/U	

9. SMA Stright Plug Crimp

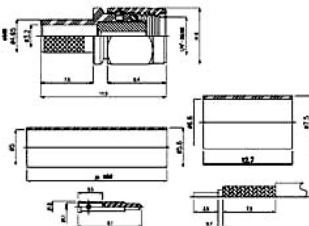
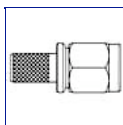

Finish: gold plated center contact & body
Insulation: Teflon

Ordering Code	Applicable Cable RG/U	Notes
SMA-50PAG0321BRX	RG-142/U.223	

10. SMA Straight Plug Crimp

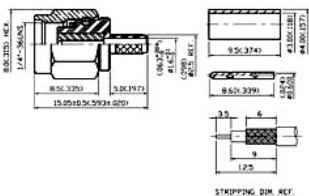

Flexible
Cable -Clamp
Attachment

Finish: gold plated center contact & body
Insulation: Teflon

Ordering Code	Applicable Cable RG/U	Notes
SMA-50PAG0304BRX	58,58A,141A	L=17.8mm
SMA-50PAG0302BRX	174,188A,316	L=16.3mm
SMA-50PAG0316BRX	142B/U	L=17.8mm

Finish: gold plated center contact & body
Insulation: Teflon

Ordering Code
SMA-50SAG5999BRX

17. SMA Square Flange Jack Receptacle (Exposed Teflon)

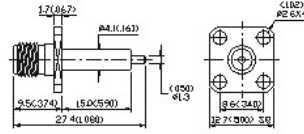

Panel Mount
Receptacle
(Exposed Teflon)

Finish: gold plated center contact & body
Insulation: Teflon

Ordering Code
SMA-50SAG6999BRX

18. SMA 2 Hole Flange Jack Receptacle (Exposed Teflon)

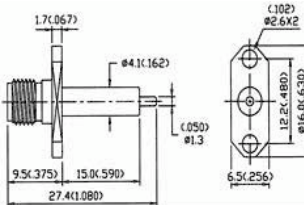

Panel Mount
Receptacle (Exposed
Teflon)

Finish: gold plated center contact & body
Insulation: Teflon

Ordering Code
SMA-50SAG6199BRX
SMA-50SAG6152BRX

19. SMA Square Flange Plug Receptacle (Tab Contact)

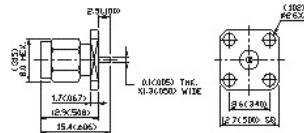

Panel Mount
Receptacle (Tab
Contact)

Finish: gold plated center contact & body
Insulation: Teflon

Ordering Code
SMA-50PAG6299BRX

20. SMA Square Flange Jack Receptacle (Tab Contact)



Click on the picture
for a detailed view

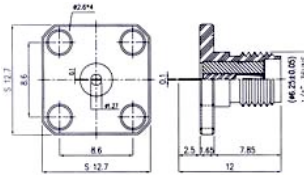

Panel Mount
Receptacle (Tab
Contact)

Finish: gold plated center contact & body
Insulation: Teflon

Ordering Code
SMA-50SAG6299BRX

21. SMA 2 Hole Flange Plug Receptacle (Tab Contact)

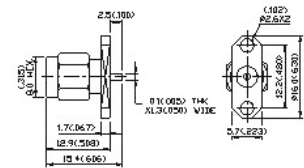

Panel Mount
Receptacle (Tab
Contact)

Finish: gold plated center contact & body
Insulation: Teflon

Ordering Code
SMA-50PAG6399BRX

22. SMA 2 Hole Flange Jack Receptacle (Tab Contact)

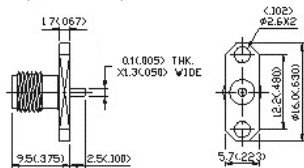

Panel Mount
Receptacle (Tab
Contact)

Finish: gold plated center contact & body
Insulation: Teflon

Ordering Code
SMA-50SAG6399BRX

23. SMA Square Flange Plug Receptacle (For Microstrip Line Circuits)

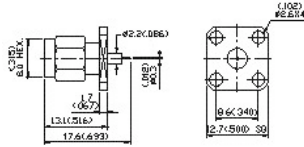

Panel Mount Receptacle (For Microstrip Line Circuits)

Finish: gold plated center contact & body
Insulation: Teflon

Ordering Code
SMA-50PAG5599BRX

24. SMA Square Flange Plug Receptacle (For Microstrip Line Circuits)

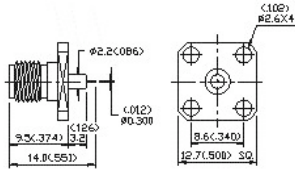

Panel Mount Receptacle (For Microstrip Line Circuits)

Finish: gold plated center contact & body
Insulation: Teflon

Ordering Code
SMA-50SAG5599BRX

25. SMA 2 Hole Flange Jack Receptacle (For Microstrip Line Circuits)

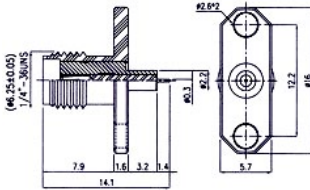

Panel Mount Receptacle (For Microstrip Line Circuits)

Finish: gold plated center contact & body
Insulation: Teflon

Ordering Code
SMA-50SAG5499BRX

26. SMA Square Flange Jack Receptacle (For Microstrip Line Circuits)

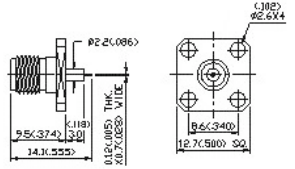

Panel Mount Receptacle (For Microstrip Line Circuits)

Finish: gold plated center contact & body
Insulation: Teflon

Ordering Code
SMA-50SAG6250BRX

27. SMA 2 Hole Flange Jack Receptacle (For Microstrip Line Circuits)

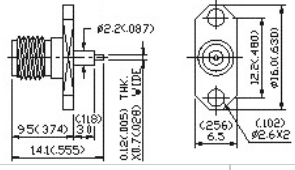

Panel Mount Receptacle (For Microstrip Line Circuits)

Finish: gold plated center contact & body
Insulation: Teflon

Ordering Code	Contact horizontal to panel
SMA-50SAG6354BRX	

28. SMA Right Angle Square Flange Jack Receptacle (Exposed Teflon)

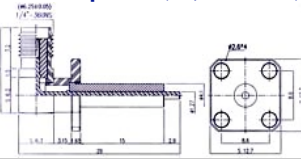

Panel Mount Receptacle (Exposed Teflon)

Finish: gold plated center contact & body
Insulation: Teflon

Ordering Code
SMA-50SAG6956BRX

29. SMA Square Flange Jack Receptacle (Blunt Post Contact)

35. SMA Straight PCB Mount Jack Receptacle

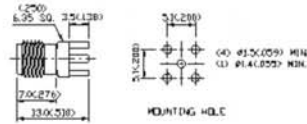

Printed Circuit Board
Receptacle

Finish: gold plated center contact & body
Insulation: Teflon

Ordering Code
SMA-50SAG5199BRX

36. SMA Right Angle PCB Mount Jack Receptacle

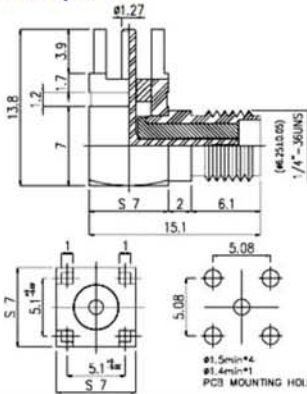

Printed Circuit Board
Receptacle

Finish: gold plated center contact & body
Insulation: Teflon

Ordering Code
SMA-50SAG7599BRX

37. SMA Straight Surface Mount Jack Receptacle

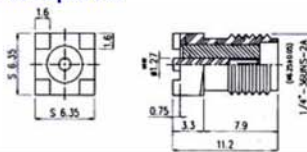

Surface Mount
Receptacle

Finish: gold plated center contact & body
Insulation: Teflon

Ordering Code
SMA-50SAG7650BRX

38. SMA Right Angle Surface Mount Jack Receptacle

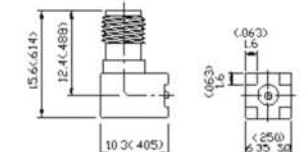

Surface Mount
Receptacle

Finish: gold plated center contact & body
Insulation: Teflon

Ordering Code
SMA-50SAG7656BRX

39. SMA End Launch Jack Receptacle

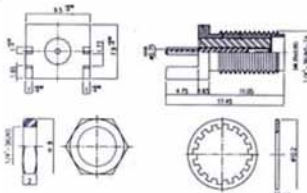

End Launch Jack
Receptacle

Finish: gold plated center contact & body
Insulation: Teflon

Ordering Code	Notes
SMA-50SJG7762BRX	center contact 50 μ" gold plated
SMA-50SAG7762BRX	center contact 8 μ" gold plated*

* Datasheet C0411D11A

40. SMA Bulkhead Jack-Jack In-series Adapter



Finish: gold plated center contact & body
Insulation: Teflon

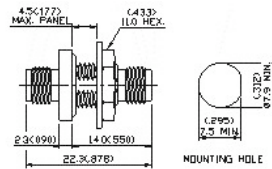

In-Series Adapter

Ordering Code
SMAS-SMASAG02X

41. SMA Plug-Plug In-series Adapter



Finish: gold plated center contact & body
Insulation: Teflon

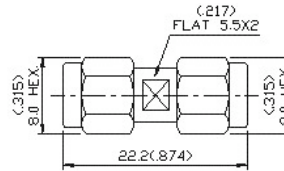

In-Series Adapter

Ordering Code
SMAP-SMAPAG01X

42. SMA Jack-Jack In-series Adapter



Finish: gold plated center contact & body
Insulation: Teflon

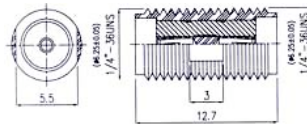

In-Series Adapter

Ordering Code
SMAS-SMASAG01X

For other plating options contact factory

43. SMA Right Angle PCB Mount Jack Receptacle



Finish: gold plated center contact & body
Insulation: Teflon

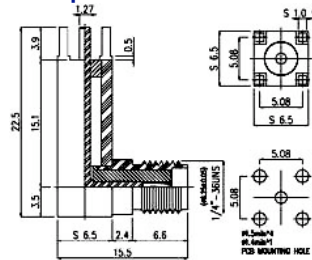

Printed Circuit Board
Receptacle

Ordering Code
SMA-50SAG7567BRX

For other plating options contact factory

X-ON Electronics

Largest Supplier of Electrical and Electronic Components

Click to view similar products for [RF Connectors](#) / [Coaxial Connectors](#) category:

Click to view products by [CONEC](#) manufacturer:

Other Similar products are found below :

[8915-1511-000](#) [89674-0827](#) [6001-7071-019](#) [6002-7051-003](#) [6002-7551-202](#) [6059674-1](#) [619550-1](#) [630059-000](#) [M39030/3-01N](#) [6500-7071-046](#) [6769](#) [CX050L2AQ](#) [7002-1541-010](#) [7002-1542-011](#) [7004-1512-000](#) [7009-1511-004](#) [7010-1511-000](#) [7029-1511-060](#) [7101-1541-010](#) [7101-1571-002](#) [7145-1521-002](#) [7203-1571-003](#) [7209-1511-011](#) [7210-1511-015](#) [7210-1511-019](#) [73137-5015](#) [73216-2241](#) [73404-2300](#) [7405-1521-005](#) [7405-1521-802](#) [8527](#) [8547](#) [FS11V](#) [877931](#) [9049-9513-000](#) [9074-9513-000](#) [9101-9573-002](#) [910A205F](#) [9130-9573-002](#) [PL11SC-026](#) [PL375-33](#) [PL40-5](#) [PL74C-221](#) [PL75MC-217](#) [PL803-7](#) [980-8666-005](#) [1200690078](#) [1-201144-1](#) [R107003010W](#) [R110A172100](#)