

## Cord Grips

High Performance | Standard | Accessories | General Information  
 Reductions

### Range of Products

- Terminal Blocks
- PCB Terminal Blocks
- ▶ Cord Grips
- Enclosure Systems
- Conta Strips
- Ferrules / Crimping
- Tools / Screwdrivers
- Metal Cable Trays
- Marking Systems
- Electronics
- Splice Connectors
- Power Distribution
- Blocks
- Shield Connection Clips
- tele
- Automation Control
- Components

### News

### Product Search

### Quality

### Literature Request

### Accessories- Reductions PG to PG Thread

**MATERIAL:**  
Polyamide (PA)

**TEMPERATURE RANGE:**  
-20 to 100°C (-4 to 212°F)

**COLOR:**  
Light Gray

**SEAL RINGS:**  
Order Separately

**REDUCTIONS Polyamide (PA)**



External Thread	Internal Thread	Cat. No.	Dimensions mm*			Std. Pk.
			A	B	C	
PG11	PG7	22931.9	8.0	12.0	22.0	100
PG13.5	PG7	22933.9	9.0	12.0	24.0	100
PG13.5	PG9	22934.9	9.0	12.0	24.0	100
PG16	PG9	22936.9	10.0	12.0	27.0	100
PG16	PG11	22937.9	10.0	15.0	27.0	100
PG21	PG11	22939.9	10.5	15.0	32.0	100
PG21	PG13.5	22940.9	10.5	15.5	32.0	100
PG21	PG16	22941.9	10.5	16.0	32.0	100
PG29	PG13.5	22942.9	12.0	17.0	39.0	50
PG29	PG16	22943.9	12.0	17.5	39.0	50
PG29	PG21	22944.9	12.0	18.5	40.0	50
PG36	PG16	22945.9	13.0	16.0	50.0	50
PG36	PG21	22946.9	13.0	18.5	50.0	50
PG36	PG29	22947.9	18.0	22.5	50.0	50
PG42	PG21	22948.9	16.0	22.5	55.0	25
PG42	PG29	22949.9	16.0	18.5	55.0	25
PG42	PG36	22950.9	17.0	25.5	55.0	25
PG48	PG29	22951.9	17.0	24.0	60.0	10
PG48	PG36	22952.9	17.0	25.5	60.0	10
PG48	PG42	22953.9	17.0	26.0	60.0	10
-	-	-	-	-	-	-
-	-	-	-	-	-	-

**MATERIAL:**  
Nickel Plated Brass (NPB)

**TEMPERATURE RANGE:**  
-40 to 300°C (-40 to 572°F)

**COLOR:**  
-

**SEAL RINGS:**  
Factory Installed

**REDUCTIONS Nickel Plated Brass (NPB)**



External Thread	Internal Thread	Cat. No.	Dimensions mm*			Std. Pk.
			A	B	C	
PG9	PG7	22800.9	6.0	8.5	18.0	100
PG11	PG7	22801.9	6.0	8.5	20.0	100
PG11	PG9	22802.9	6.0	8.5	20.0	100
PG13.5	PG7	22803.9	6.5	9.5	20.0	100
PG13.5	PG9	22804.9	6.5	9.5	24.0	100
PG13.5	PG11	22805.9	6.5	9.5	24.0	100
PG16	PG7	22806.9	6.5	9.5	24.0	100
PG16	PG9	22807.9	6.5	9.5	24.0	100
PG16	PG11	22808.9	6.5	9.5	24.0	100
PG16	PG13.5	22809.9	6.5	9.5	24.0	100
PG21	PG11	22810.9	7.0	10.0	32.0	100
PG21	PG13.5	22811.9	7.0	10.0	32.0	100
PG21	PG16	22812.9	7.0	10.0	32.0	50
PG29	PG13.5	22813.9	8.0	11.5	41.0	50
PG29	PG16	22814.9	8.0	11.5	41.0	50
PG29	PG21	22815.9	8.0	11.5	41.0	50
PG36	PG21	22816.9	9.0	12.5	50.0	25
PG36	PG29	22817.9	9.0	12.5	50.0	25
PG42	PG29	22818.9	10.0	14.0	60.0	25
PG42	PG36	22819.9	10.0	14.0	60.0	25
PG48	PG29	22820.9	10.0	14.0	64.0	10
PG48	PG36	22821.9	10.0	14.0	64.0	10

### Reductions Metric to Metric Thread

External Thread	Internal Thread	Cat. No. L. Gray	Cat. No. Black	A mm	B mm	C mm	Std. Pk.
M16	M12	25518.9	25560.9	8.0	12.0	24.0	100
M20	M12	25821.9	25561.9	8.0	12.0	24.0	100
M20	M16	25519.9	25562.9	8.0	12.0	24.0	100
M25	M12	25520.9	25563.9	8.0	14.0	29.0	100
M25	M16	25521.9	25564.9	8.0	14.0	29.0	100
M25	M20	25522.9	25565.9	8.0	14.0	29.0	100
M32	M12	25523.9	25566.9	10.0	16.0	36.0	50
M32	M16	25524.9	25567.9	10.0	16.0	36.0	50
M32	M20	25525.9	25568.9	10.0	16.0	36.0	50
M32	M25	25526.9	25569.9	10.0	16.0	36.0	50
M40	M16	25527.9	25570.9	10.0	16.0	46.0	50
M40	M20	25528.9	25571.9	10.0	16.0	46.0	50
M40	M25	25529.9	25572.9	10.0	16.0	46.0	50
M40	M32	25530.9	25573.9	10.0	16.0	46.0	50
M50	M20	25531.9	25574.9	12.0	18.0	55.0	25
M50	M25	25532.9	25575.9	12.0	18.0	55.0	25
M50	M32	25533.9	25576.9	12.0	18.0	55.0	25
M50	M40	25534.9	25577.9	12.0	18.0	55.0	25
M63	M25	25535.9	25578.9	12.0	18.0	68.0	25
M63	M32	25536.9	25579.9	12.0	18.0	68.0	25
M63	M40	25537.9	25580.9	12.0	18.0	68.0	25
M63	M50	25538.9	25581.9	12.0	18.0	68.0	25

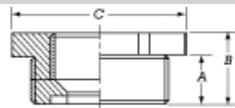

\*Millimeter (mm) to Inch Conversion: mm ÷ 25.4 = inches, inches x 25.4 = mm

External Thread	Internal Thread	Cat. No.	A mm	B mm	C mm	Std. Pk.
M16	M12	25610.9	5.0	8.0	17.0	100
M20	M12	25611.9	6.0	9.0	22.0	100
M20	M16	25612.9	6.0	9.0	22.0	100
M25	M16	25613.9	7.0	10.0	27.0	100
M25	M20	25614.9	7.0	10.0	27.0	100
M32	M16	25800.9	8.0	11.0	34.0	50
M32	M20	25615.9	8.0	11.0	34.0	50
M32	M25	25616.9	8.0	11.0	34.0	50
M40	M20	25801.9	8.0	12.0	43.0	50
M40	M25	25617.9	8.0	12.0	43.0	50
M40	M32	25618.9	8.0	12.0	43.0	50
M50	M25	25802.9	9.0	13.0	55.0	25
M50	M32	25619.9	9.0	13.0	55.0	25
M50	M40	25620.9	9.0	13.0	55.0	25
M63	M32	25621.9	10.0	14.0	65.0	25
M63	M40	25622.9	10.0	14.0	65.0	25
M63	M50	25623.9	10.0	14.0	65.0	25



\*Millimeter (mm) to Inch Conversion: mm ÷ 25.4 = inches, inches x 25.4 = mm

## X-ON Electronics

Largest Supplier of Electrical and Electronic Components

*Click to view similar products for [Other Tools](#) category:*

*Click to view products by [Conta-Clip Verbindungstechnik](#) manufacturer:*

Other Similar products are found below :

[CR-05FL7--150R](#) [CR-05FL7--698K](#) [899-2-KT46](#) [899-5-KT46](#) [CR-0AFL4--332K](#) [CR-12FP4--260R](#) [CRCW04021100FRT7](#)  
[CRCW04021961FRT7](#) [5800-0090](#) [CRCW04024021FRT7](#) [CRCW040254R9FRT7](#) [CRCW0603102JRT5](#) [59065-5](#) [00-8273-RDPP](#) [00-8729-](#)  
[WHPP](#) [593033](#) [593058](#) [593072](#) [593564100](#) [593575](#) [593591](#) [593593](#) [011349-000](#) [LTLA506SBLAMNBL](#) [CRCW08052740FRT1](#) [LUC-](#)  
[012S070DSM](#) [LUC-018S070DSP](#) [599-2021-3-NME](#) [599-JJ-2021-03](#) [00-5080-YWPP](#) [5E4750/01-20R0-T/R](#) [LW1A-L1-GL](#) [LW1A-P1-GD](#)  
[LW1L-A1C10V-GL](#) [LW1L-M1C70-A](#) [0202-0173](#) [00-9089-RDPP](#) [00-9300-RDPP](#) [CRCW2010331JR02](#) [01-1003W-8/32-10](#) [601-GP-08-](#)  
[KT39](#) [601-JJ-06](#) [601-SPB](#) [601YSY](#) [602-JJ-03](#) [602SPB](#) [602Z](#) [603-JJ-07-FP](#) [603-JJY-04](#) [604J](#)