

# HC3A

## High Power Resonant Capacitors



### FEATURES

High AC Voltage - High current

### APPLICATIONS

Induction Heating - Tank Circuits

KVAR	300
CAPACITANCE TOLERANCE	+/-10%
MAXIMUM CORE TEMPERATURE	+85°C
SURFACE TEMPERATURE	+45°C (Above 45°C the KVAR rating must be de-rated by 2.25%/°C)
CONSTRUCTION	Self-healing
SELF INDUCTANCE	< 3 nH
DIELECTRIC	Polypropylene
FLAME RETARDANT	UL94V0

### Standard part listing

Capacitance (µF)	VAC	IC part number	Maximum RMS current (A)	MAX power kvar	Frequency range (kHz)	ESR (mΩ) 100kHz, +25°C	Dimensions (mm)			Terminal Style
							B	H	L	
0.10	1000	<a href="#">104HC3A102K2SM6</a>	300	300	478	1.5	30.2	30	68	2SM6
0.17	1000	<a href="#">174HC3A102K2SM6</a>	300	300	281	1.4	30.2	30	68	2SM6
0.33	800	<a href="#">334HC3A800K2SM6</a>	400	300	225-256	1.2	30.2	30	68	2SM6
0.50	800	<a href="#">504HC3A800K2SM6</a>	400	300	149-170	1.1	30.2	30	68	2SM6
0.66	700	<a href="#">664HC3A700K2SM6</a>	450	300	147-163	1.0	30.2	30	68	2SM6
1.33	600	<a href="#">135HC3A600K2SM6</a>	500	300	99	0.9	30.2	30	68	2SM6
2.40	500	<a href="#">245HC3A500K2SM6</a>	600	300	79	0.8	30.2	30	68	2SM6

Americas / EU  
 Phone: 1-508-996-8561  
 Email: cdena@cde.com



Asia  
 Phone: 852-2793-0931  
 Email: cdeasia@cde.com

# HC3A

High Power Resonant Capacitors



TERMINAL STYLE: 2SM6

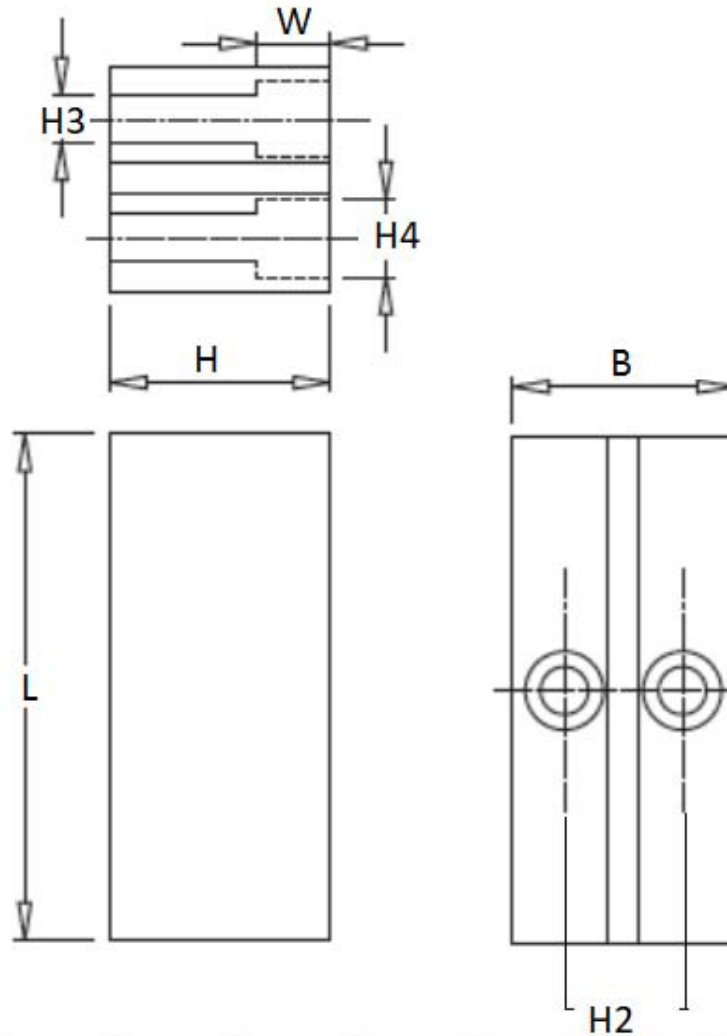

L	H	B	H2	H3	H4	W
68±0.5	30±0.5	30.2±0.1	16	6.5	10.5	10
Tightening torque: 15Nm MAX						

Americas / EU  
 Phone: 1-508-996-8561  
 Email: cdena@cde.com



Asia  
 Phone: 852-2793-0931  
 Email: cdeasia@cde.com  
 Sep-20

# HC3A

## High Power Resonant Capacitors



### Frequency Derating

—●— Voltage    —■— Current    —▲— Power

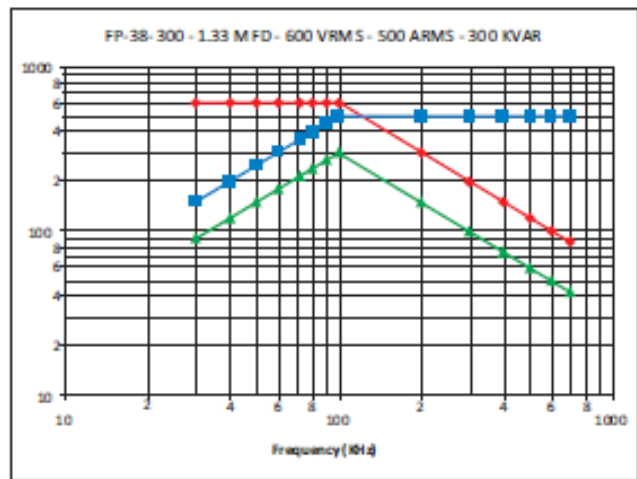
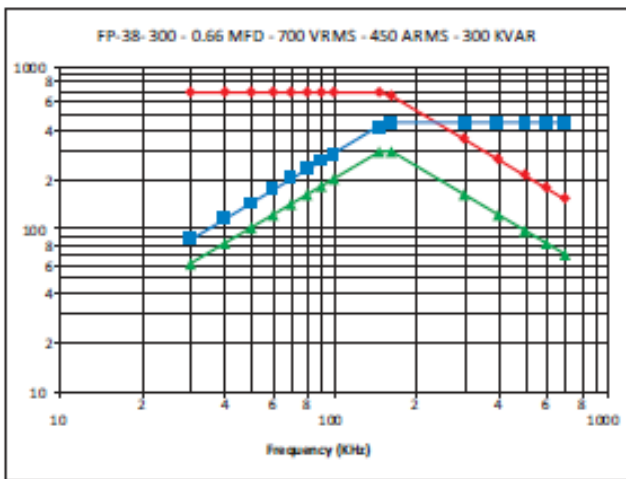
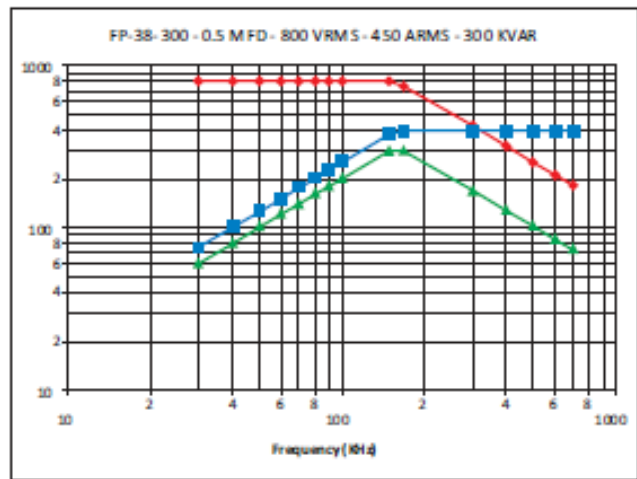
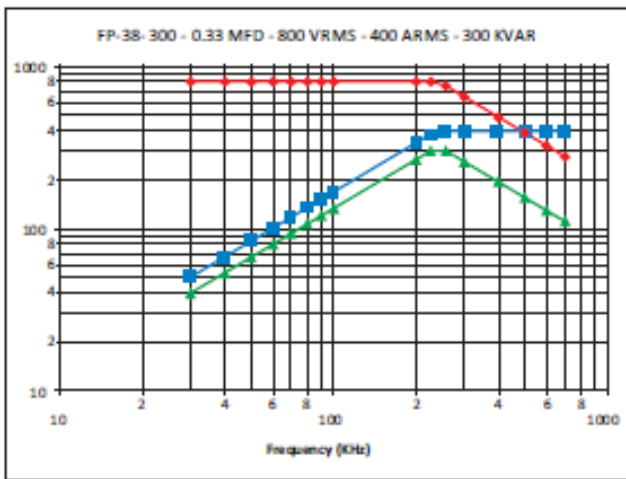
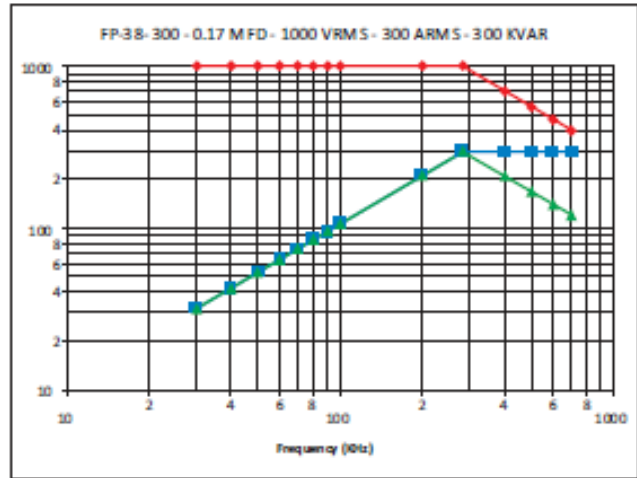
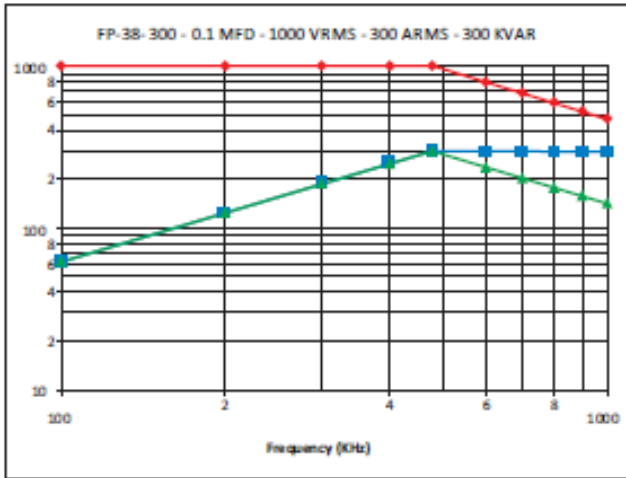

Americas / EU  
Phone: 1-508-996-8561  
Email: cdena@cde.com



**CORNELL  
DUBILIER**



Asia  
Phone: 852-2793-0931  
Email: cdeasia@cde.com

# HC3A

## High Power Resonant Capacitors



### Frequency Derating

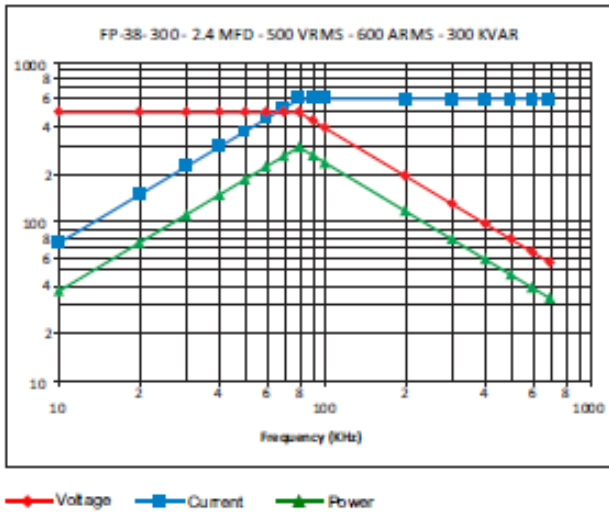

Americas / EU  
Phone: 1-508-996-8561  
Email: cdena@cde.com



Asia  
Phone: 852-2793-0931  
Email: cdeasia@cde.com

Sep-20

## X-ON Electronics

Largest Supplier of Electrical and Electronic Components

*Click to view similar products for [Film Capacitors](#) category:*

*Click to view products by [Cornell Dubilier](#) manufacturer:*

Other Similar products are found below :

[F450KG153J250ALH0J](#) [750-1018](#) [FKP1-1000160010P15](#) [FKP1-1500160010P15](#) [82EC1100DQ50K](#) [MMWAF150KME](#)  
[PFR5101J100J11L16.5TA18](#) [PME261JB5220KR19T0](#) [A521HH333M035C](#) [QXJ2E474KTPT](#) [QXL2B333KTPT](#) [QXM2G104K](#) [DMT2P22](#)  
[EEC2G505HQA406](#) [B32520C6332K000](#) [B32522C6104K000](#) [B32523Q3155J](#) [B32676E6755K](#) [C3B2AD44400B20K](#) [217-0716-001](#) [KP1830-](#)  
[247/061-G](#) [SCD105K122A3-22](#) [2N3155](#) [F601BL225K063CL60A](#) [FKP1-2202KV5P15](#) [FKS3-680040010P10](#) [445450-1](#) [B32523Q0475K000](#)  
[46KR415050M1K](#) [4BSNBX4100ZBFJ](#) [4DCNAQ4450ZA0J](#) [MKP383510063JKP2T0](#) [MKT 1813-368-015](#) [MKT182022263473](#) [4055292001](#)  
[WMC08P22](#) [WMF1S15](#) [WMF4S68](#) [EEC2E106HQA405](#) [EEC2G805HQA415](#) [82DC3100DQ50J](#) [82DC4100AA60K](#) [82EC2150DQ50K](#)  
[WMF4D68](#) [WMF1D68](#) [PHE841ED6150MR17T0](#) [B25620B118K883](#) [B25620B158K883](#) [66MD2100CK7AK](#) [97F8038](#)