

Type 300/301 –55 °C to 105 °C Long-Life, Switching Power Grade Radial

High Capacitance and Ultra-Low ESR



The Types 300 and 301 are the wide-temperature, low-ESR capacitors for power-supply outputs and UPS battery stiffening. The exceptionally low ESRs enable high ripple-current capability. With series inductance of 12 to 16 nH and ripple currents to 16 amps one of these capacitors can save by replacing three or four of the 12.5 mm diameter capacitors routinely at the output of switching power supplies. Type 300 has three leads for rugged, reverse-proof mounting, and Type 301 has two leads. Types 300R and 301R deliver even lower ESR and higher ripple.

Highlights

- 4000 hour load life
- Ripple Current to 16 amps
- ESRs to 6 mΩ
- > 90% capacitance at –40 °C
- Replaces multiple capacitors

[RoHS Certificate](#)

Specifications

| | | | | | | | | |
|----------------------------|-----------------------------------------------------|--------------|--------------|---------------|---------------|--------------|---------------|------------------------|
| Temperature Range | –55 °C to +105 °C | | | | | | | |
| Rated Voltage Range | 6.3 to 250 Vdc | | | | | | | |
| Capacitance Range | 8.2 µF to 33,000 µF | | | | | | | |
| Capacitance Tolerance | 6.3 to 100 Vdc; –10 + 75%, 160 to 250 Vdc; –10 +50% | | | | | | | |
| Leakage Current | ≤0.5 \sqrt{CV} µA, 4 mA max, 5 minutes | | | | | | | |
| Ripple Current Multipliers | Ambient Temperature | | | | | | | |
| | 45 °C | 55 °C | 65 °C | 75 °C | 85 °C | 95 °C | 105 °C | |
| | 1.66 | 1.52 | 1.37 | 1.20 | 1.00 | 0.75 | 0.36 | |
| | Frequency | | | | | | | |
| | | 50 Hz | 60 Hz | 120 Hz | 360 Hz | 1 kHz | 5 kHz | 10 kHz & up |
| | Less than .77" Diameter | | | | | | | |
| | 6.3 & 7.5 V | 0.76 | 0.81 | 1.00 | 1.23 | 1.35 | 1.41 | 1.43 |
| | 10 to 40 V | 0.74 | 0.79 | 1.00 | 1.29 | 1.46 | 1.55 | 1.57 |
| | 50V | 0.72 | 0.78 | 1.00 | 1.33 | 1.54 | 1.67 | 1.69 |
| | 63 & 75 V | 0.71 | 0.76 | 1.00 | 1.38 | 1.64 | 1.82 | 1.86 |
| 100 to 250 V | 0.68 | 0.74 | 1.00 | 1.51 | 2.00 | 2.51 | 2.67 | |
| .77" Diameter | | | | | | | | |
| 6.3 & 7.5 V | 0.82 | 0.86 | 1.00 | 1.15 | 1.21 | 1.24 | 1.25 | |
| 10 to 40 V | 0.78 | 0.83 | 1.00 | 1.20 | 1.30 | 1.35 | 1.36 | |
| 50V | 0.76 | 0.81 | 1.00 | 1.25 | 1.38 | 1.45 | 1.47 | |
| 63 & 75 V | 0.74 | 0.80 | 1.00 | 1.28 | 1.43 | 1.52 | 1.54 | |
| 100 to 250 V | 0.76 | 0.81 | 1.00 | 1.24 | 1.37 | 1.44 | 1.46 | |
| .895" Diameter | | | | | | | | |
| 6.3 & 7.5 V | 0.82 | 0.86 | 1.00 | 1.14 | 1.20 | 1.23 | 1.24 | |
| 10 to 40 V | 0.80 | 0.84 | 1.00 | 1.17 | 1.25 | 1.29 | 1.30 | |
| 50V | 0.75 | 0.80 | 1.00 | 1.27 | 1.42 | 1.50 | 1.52 | |
| 63 & 75 V | 0.75 | 0.80 | 1.00 | 1.26 | 1.40 | 1.48 | 1.50 | |
| 100 to 250 V | 0.76 | 0.81 | 1.00 | 1.25 | 1.38 | 1.46 | 1.48 | |
| 1.02" Diameter | | | | | | | | |
| 6.3 & 7.5 V | 0.84 | 0.88 | 1.00 | 1.12 | 1.17 | 1.19 | 1.20 | |
| 10 to 40 V | 0.81 | 0.86 | 1.00 | 1.15 | 1.22 | 1.25 | 1.26 | |
| 50V | 0.76 | 0.81 | 1.00 | 1.23 | 1.35 | 1.42 | 1.44 | |
| 63 & 75 V | 0.77 | 0.81 | 1.00 | 1.23 | 1.35 | 1.42 | 1.44 | |
| 100 to 250 V | 0.76 | 0.81 | 1.00 | 1.24 | 1.37 | 1.44 | 1.46 | |

Type 300/301 -55 °C to 105 °C Long-Life, Switching Power Grade Radial

High Capacitance and Ultra-Low ESR

| | |
|---------------------------------------------------------------|--------------------------------------------------------------------------------------------------------------------------------------------------------------|
| Load Life RoHS, ≥ .77" RoHS, < .77" Non-RoHS, < .77" | 4000 h at full load at 85 °C 2000 h at full load at 85 °C 4000 h at full load at 85 °C Δ Capacitance ±20% ESR 200% of limit DCL 100% of limit |
| Shelf Life Test | 500 h at 105 °C, capacitance, ESR and DCL, initial requirements |
| Vibration | 10 to 55 Hz, 0.06" and 10 g max, 2 h each plane |

Part Numbering System

| | | | | | | | |
|-------------------|----------------------------------------------------------------------------------------------------------------|--------------------------------|-----------------------------------------|----------------------------------------------|-----------|-----------------------------------------------------------------------------------------------------------------------------------|-------------------------------|
| NR | 301R | 333 | U | 6R3 | JS | 2 | E |
| RoHS | Type | Capacitance | Tolerance | Voltage | Case Code | Insulation | Epoxy |
| Blank = Compliant | 300 - 3 leads 300R - 3 leads, low ESR 301 - 2 leads 301R - 2 leads, low ESR 301A - Laydown 3 leads | 152 = 1500 μF 102 = 1000 μF | M = ±20 T = 10% +50% U = -10 +75% | 6R3 = 6.3 V 063 = 63 Vdc 100 = 100 Vdc | | 0 = bare can 1 = Polyester 2 = PVC 8 = PVC w/standoffs* 9 = Polyester w/standoffs* *Not available in .77" diameter | E = epoxy Blank = no epoxy |

Outline Drawing

0.77", 0.895" and 1.02" Diameters

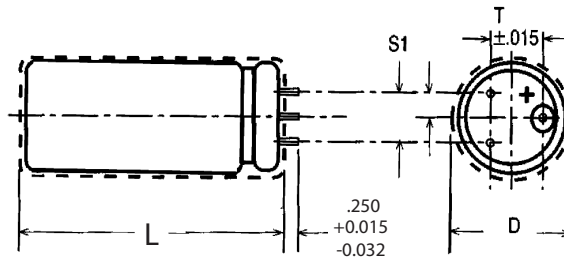

Type
300/300R
Three
Leads

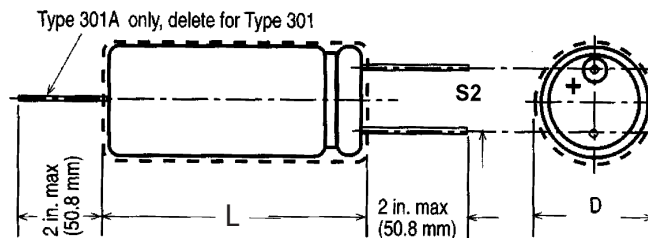

Type
301/301R
Two
Leads

Type 300/301 –55 °C to 105 °C Long-Life, Switching Power Grade Radial

High Capacitance and Ultra-Low ESR

Case Dimensions

| Case Code | Insulated D ± 0.015 (0.4 mm) L ± 0.062 (1.6 mm) D x L | Epoxy endseal L Max | Bare Can D ± 0.015 (0.4 mm) L ± 0.030 (0.8 mm) D x L | Lead Spacing | | Lead Diameter dia. | AWG |
|---------------------------------------|----------------------------------------------------------------|------------------------|---------------------------------------------------------------|----------------------------------|----------------------------------|-----------------------|-----|
| | | | | Type 300 S1 ±0.020(0.5 mm) | Type 301 S2 ±0.020(0.5 mm) | | |
| Case Dimensions in Inches | | | | | | | |
| GE | .765 x 1.150 | 1.212 | 0.750 x 1.125 | 0.200 | 0.300 | 0.040 | 18 |
| GJ | .765 x 1.650 | 1.712 | 0.750 x 1.625 | 0.200 | 0.300 | 0.040 | 18 |
| GL | .765 x 2.150 | 2.212 | 0.750 x 2.125 | 0.200 | 0.300 | 0.040 | 18 |
| GP | .765 x 2.650 | 2.712 | 0.750 x 2.625 | 0.200 | 0.300 | 0.040 | 18 |
| GS | .765 x 3.150 | 3.212 | 0.750 x 3.125 | 0.200 | 0.300 | 0.040 | 18 |
| GT | .765 x 3.650 | 3.712 | 0.750 x 3.625 | 0.200 | 0.300 | 0.040 | 18 |
| HE | .890 x 1.150 | 1.212 | 0.875 x 1.125 | 0.300 | 0.400 | 0.040 | 18 |
| HJ | .890 x 1.650 | 1.712 | 0.875 x 1.625 | 0.300 | 0.400 | 0.040 | 18 |
| HL | .890 x 2.150 | 2.212 | 0.875 x 2.125 | 0.300 | 0.400 | 0.040 | 18 |
| HP | .890 x 2.650 | 2.712 | 0.875 x 2.625 | 0.300 | 0.400 | 0.040 | 18 |
| HS | .890 x 3.150 | 3.212 | 0.875 x 3.125 | 0.300 | 0.400 | 0.040 | 18 |
| HT | .890 x 3.650 | 3.712 | 0.875 x 3.625 | 0.300 | 0.400 | 0.040 | 18 |
| JE | 1.015 x 1.150 | 1.212 | 1.000 x 1.125 | 0.300 | 0.400 | 0.040 | 18 |
| JJ | 1.015 x 1.650 | 1.712 | 1.000 x 1.625 | 0.300 | 0.400 | 0.040 | 18 |
| JL | 1.015 x 2.150 | 2.212 | 1.000 x 2.125 | 0.300 | 0.400 | 0.040 | 18 |
| JP | 1.015 x 2.650 | 2.712 | 1.000 x 2.625 | 0.300 | 0.400 | 0.040 | 18 |
| JS | 1.015 x 3.150 | 3.212 | 1.000 x 3.125 | 0.300 | 0.400 | 0.040 | 18 |
| JT | 1.015 x 3.650 | 3.712 | 1.000 x 3.625 | 0.300 | 0.400 | 0.040 | 18 |
| Case Dimensions in Millimeters | | | | | | | |
| EG | 13.0 x 21.5 | 23 | 12.5 x 20.0 | 5.00 | 2.50 | 0.81 | 20 |
| EK | 13.0 x 26.5 | 29.0 | 12.5 x 25.0 | 5.00 | 2.50 | 0.81 | 20 |
| EM | 13.0 x 28.0 | 29.5 | 12.5 x 26.5 | 5.00 | 2.50 | 0.81 | 20 |
| EN | 13.0 x 35.0 | 36.0 | 12.5 x 33.5 | 5.00 | 2.50 | 0.81 | 20 |
| ER | 13.0 x 44.0 | 45.5 | 12.5 x 42.5 | 5.00 | 2.50 | 0.81 | 20 |
| FK | 16.5 x 26.5 | 27.9 | 16.0 x 25.0 | 7.50 | 3.75 | 0.81 | 20 |
| FF | 16.5 x 33.5 | 36.0 | 16.0 x 32.0 | 7.50 | 3.75 | 0.81 | 20 |
| FQ | 16.5 x 37.5 | 40.0 | 16.0 x 36.0 | 7.50 | 3.75 | 0.81 | 20 |
| FV | 16.5 x 41.5 | 42.4 | 16.0 x 40.0 | 7.50 | 3.75 | 0.81 | 20 |
| LQ | 18.5 x 37.5 | 40.0 | 18.0 x 36.0 | 7.50 | 3.75 | 0.81 | 20 |
| LV | 18.5 x 41.5 | 43.0 | 18.0 x 40.0 | 7.50 | 3.75 | 0.81 | 20 |
| GE | 19.4 x 29.2 | 30.8 | 19.1 x 28.6 | 5.08 | 7.62 | 1.02 | 18 |
| GJ | 19.4 x 41.9 | 43.5 | 19.1 x 41.3 | 5.08 | 7.62 | 1.02 | 18 |
| GL | 19.4 x 54.6 | 56.2 | 19.1 x 54.0 | 5.08 | 7.62 | 1.02 | 18 |
| GP | 19.4 x 67.3 | 68.9 | 19.1 x 66.7 | 5.08 | 7.62 | 1.02 | 18 |
| GS | 19.4 x 80.0 | 81.6 | 19.1 x 79.4 | 5.08 | 7.62 | 1.02 | 18 |
| GT | 19.4 x 92.7 | 94.3 | 19.1 x 92.1 | 5.08 | 7.62 | 1.02 | 18 |
| HE | 22.6 x 29.2 | 30.8 | 22.2 x 28.6 | 7.62 | 10.16 | 1.02 | 18 |
| HJ | 22.6 x 41.9 | 43.5 | 22.2 x 41.3 | 7.62 | 10.16 | 1.02 | 18 |
| HL | 22.6 x 54.6 | 56.2 | 22.2 x 54.0 | 7.62 | 10.16 | 1.02 | 18 |
| HP | 22.6 x 67.3 | 68.9 | 22.2 x 66.7 | 7.62 | 10.16 | 1.02 | 18 |
| HS | 22.6 x 80.0 | 81.6 | 22.2 x 79.4 | 7.62 | 10.16 | 1.02 | 18 |
| HT | 22.6 x 92.7 | 94.3 | 22.2 x 92.1 | 7.62 | 10.16 | 1.02 | 18 |
| JE | 25.8 x 29.2 | 30.8 | 25.4 x 28.6 | 7.62 | 10.16 | 1.02 | 18 |
| JJ | 25.8 x 41.9 | 43.5 | 25.4 x 41.3 | 7.62 | 10.16 | 1.02 | 18 |
| HL | 25.8 x 54.6 | 56.2 | 25.4 x 54.0 | 7.62 | 10.16 | 1.02 | 18 |
| JP | 25.8 x 67.3 | 68.9 | 25.4 x 66.7 | 7.62 | 10.16 | 1.02 | 18 |
| JS | 25.8 x 80.0 | 81.6 | 25.4 x 79.4 | 7.62 | 10.16 | 1.02 | 18 |
| JT | 25.8 x 92.7 | 94.3 | 25.4 x 92.1 | 7.62 | 10.16 | 1.02 | 18 |

Type 300/301 –55 °C to 105 °C Long-Life, Switching Power Grade Radial

High Capacitance and Ultra-Low ESR Ratings

| Cap. (µF) | Catalog Part Number | ESR MAX @ 25°C | | Ripple MAX @ 85°C | | Nom Size Insulated D x L (in) | Cap. (µF) | Catalog Part Number | ESR MAX @ 25°C | | Ripple MAX @ 85°C | | Nom Size Insulated D x L (in) |
|------------------------------|------------------------|-------------------|----------------|----------------------|----------------|----------------------------------------|-------------------------------|------------------------|-------------------|----------------|----------------------|----------------|----------------------------------------|
| | | 120 Hz | 20 kHz (mΩ) | 120 Hz | 20 kHz (mΩ) | | | | 120 Hz | 20 kHz (mΩ) | 120 Hz | 20 kHz (mΩ) | |
| 6.3 Vdc (9 Vdc Surge) | | | | | | | 7.5 Vdc (10 Vdc Surge) | | | | | | |
| 2700 | 301272U6R3GE2 | 143.0 | 81.5 | 1.71 | 2.13 | .77 x 1.15 | 2200 | 301222U7R5GE2 | 147.0 | 80.8 | 1.69 | 2.14 | .77 x 1.15 |
| 2700 | 301R272U6R3GE2 | 124.0 | 70.6 | 1.84 | 2.29 | .77 x 1.15 | 2200 | 301R222U7R5GE2 | 127.0 | 70.0 | 1.81 | 2.30 | .77 x 1.15 |
| 3900 | 301392U6R3HE2 | 100.0 | 61.1 | 2.24 | 2.71 | .895 x 1.15 | 3900 | 301392U7R5HE2 | 103.0 | 61.6 | 2.21 | 2.69 | .895 x 1.15 |
| 3900 | 301R392U6R3HE2 | 86.8 | 50.3 | 2.41 | 2.98 | .895 x 1.15 | 3900 | 301R392U7R5HE2 | 88.9 | 48.9 | 2.38 | 3.02 | .895 x 1.15 |
| 4700 | 301472U6R3GJ2 | 72.5 | 41.3 | 2.65 | 3.30 | .77 x 1.65 | 4700 | 301472U7R5GJ2 | 74.5 | 41.0 | 2.61 | 3.32 | .77 x 1.65 |
| 4700 | 301R472U6R3GJ2 | 62.8 | 35.8 | 2.84 | 3.55 | .77 x 1.65 | 4700 | 301R472U7R5GJ2 | 64.5 | 35.5 | 2.80 | 3.56 | .77 x 1.65 |
| 5600 | 301562U6R3JE2 | 83.8 | 57.0 | 2.56 | 2.92 | 1.02 x 1.15 | 5600 | 301562U7R5JE2 | 85.5 | 56.5 | 2.53 | 2.94 | 1.02 x 1.15 |
| 5600 | 301R562U6R3JE2 | 72.7 | 41.4 | 2.75 | 3.43 | 1.02 x 1.15 | 5600 | 301R562U7R5JE2 | 74.1 | 41.5 | 2.72 | 3.42 | 1.02 x 1.15 |
| 8200 | 301822U6R3GL2 | 49.2 | 28.1 | 4.02 | 5.02 | .77 x 2.15 | 6800 | 301682U7R5GL2 | 50.6 | 27.8 | 3.97 | 5.05 | .77 x 2.15 |
| 8200 | 301R822U6R3GL2 | 42.7 | 24.3 | 4.32 | 5.40 | .77 x 2.15 | 6800 | 301R682U7R5GL2 | 43.8 | 24.1 | 4.26 | 5.42 | .77 x 2.15 |
| 8200 | 301822U6R3HJ2 | 51.1 | 31.2 | 3.71 | 4.48 | .895 x 1.65 | 6800 | 301682U7R5HJ2 | 52.4 | 31.4 | 3.67 | 4.46 | .895 x 1.65 |
| 8200 | 301R822U6R3HJ2 | 44.3 | 25.7 | 3.99 | 4.93 | .895 x 1.65 | 6800 | 301R682U7R5HJ2 | 45.4 | 25.0 | 3.94 | 5.01 | .895 x 1.65 |
| 10000 | 301103U6R3GP2 | 37.8 | 21.5 | 5.12 | 6.39 | .77 x 2.65 | 8200 | 301822U7R5GP2 | 38.7 | 21.3 | 5.05 | 6.42 | .77 x 2.65 |
| 10000 | 301R103U6R3GP2 | 32.7 | 18.7 | 5.50 | 6.86 | .77 x 2.65 | 8200 | 301R822U7R5GP2 | 33.6 | 18.5 | 5.43 | 6.90 | .77 x 2.65 |
| 12000 | 301123U6R3GS2 | 31.0 | 17.7 | 6.17 | 7.70 | .77 x 3.15 | 10000 | 301103U7R5HL2 | 35.8 | 21.5 | 5.14 | 6.25 | .895 x 2.15 |
| 12000 | 301R123U6R3GS2 | 26.8 | 15.3 | 6.62 | 8.27 | .77 x 3.15 | 10000 | 301R103U7R5HL2 | 26.2 | 14.4 | 6.01 | 7.64 | .895 x 2.15 |
| 12000 | 301123U6R3HL2 | 35.0 | 21.3 | 5.20 | 6.27 | .895 x 2.15 | 10000 | 301103U7R5JJ2 | 43.8 | 28.9 | 4.35 | 5.05 | 1.02 x 1.65 |
| 12000 | 301R123U6R3HL2 | 25.5 | 14.8 | 6.09 | 7.54 | .895 x 2.15 | 10000 | 301R103U7R5JJ2 | 38.0 | 21.3 | 4.67 | 5.89 | 1.02 x 1.65 |
| 12000 | 301123U6R3JJ2 | 43.0 | 29.2 | 4.39 | 5.02 | 1.02 x 1.65 | 12000 | 301123U7R5GS2 | 31.8 | 17.5 | 6.09 | 7.74 | .77 x 3.15 |
| 12000 | 301R123U6R3JJ2 | 37.2 | 21.2 | 4.72 | 5.89 | 1.02 x 1.65 | 12000 | 301R123U7R5GS2 | 27.5 | 15.1 | 6.54 | 8.31 | .77 x 3.15 |
| 15000 | 301153U6R3GT2 | 26.6 | 15.1 | 7.10 | 8.86 | .77 x 3.65 | 12000 | 301123U7R5GT2 | 27.2 | 15.0 | 7.01 | 8.91 | .77 x 3.65 |
| 15000 | 301R153U6R3GT2 | 23.0 | 13.1 | 7.62 | 9.52 | .77 x 3.65 | 12000 | 301R123U7R5GT2 | 23.6 | 13.0 | 7.53 | 9.57 | .77 x 3.65 |
| 15000 | 301153U6R3HP2 | 27.1 | 16.5 | 6.57 | 7.93 | .895 x 2.65 | 15000 | 301153U7R5HP2 | 27.7 | 16.6 | 6.50 | 7.91 | .895 x 2.65 |
| 15000 | 301R153U6R3HP2 | 19.5 | 11.3 | 7.75 | 9.60 | .895 x 2.65 | 15000 | 301R153U7R5HP2 | 20.0 | 11.0 | 7.65 | 9.73 | .895 x 2.65 |
| 18000 | 301183U6R3JL2 | 29.6 | 20.1 | 6.08 | 6.95 | 1.02 x 2.15 | 15000 | 301153U7R5JL2 | 30.1 | 19.9 | 6.02 | 6.99 | 1.02 x 2.15 |
| 18000 | 301R183U6R3JL2 | 19.1 | 10.9 | 7.57 | 9.45 | 1.02 x 2.15 | 15000 | 301R153U7R5JL2 | 19.6 | 10.9 | 7.47 | 9.41 | 1.02 x 2.15 |
| 22000 | 301223U6R3HS2 | 22.4 | 13.7 | 7.88 | 9.51 | .895 x 3.15 | 18000 | 301183U7R5HS2 | 22.9 | 13.8 | 7.79 | 9.48 | .895 x 3.15 |
| 22000 | 301R223U6R3HS2 | 15.9 | 9.2 | 9.35 | 11.60 | .895 x 3.15 | 18000 | 301R183U7R5HS2 | 16.3 | 9.0 | 9.23 | 11.70 | .895 x 3.15 |
| 22000 | 301223U6R3JP2 | 23.0 | 15.6 | 7.66 | 8.75 | 1.02 x 2.65 | 22000 | 301223U7R5HT2 | 19.8 | 11.9 | 8.95 | 10.90 | .895 x 3.65 |
| 22000 | 301R223U6R3JP2 | 14.7 | 8.4 | 9.59 | 12.00 | 1.02 x 2.65 | 22000 | 301R223U7R5HT2 | 13.9 | 7.7 | 10.70 | 13.60 | .895 x 3.65 |
| 27000 | 301273U6R3HT2 | 19.4 | 11.9 | 9.04 | 10.90 | .895 x 3.65 | 22000 | 301223U7R5JP2 | 23.4 | 15.5 | 7.59 | 8.80 | 1.02 x 2.65 |
| 27000 | 301R273U6R3HT2 | 13.6 | 7.9 | 10.80 | 13.40 | .895 x 3.65 | 22000 | 301R223U7R5JP2 | 15.0 | 8.4 | 9.47 | 11.90 | 1.02 x 2.65 |
| 27000 | 301273U6R3JS2 | 19.2 | 13.0 | 9.11 | 10.40 | 1.02 x 3.15 | 27000 | 301273U7R5JS2 | 19.5 | 12.9 | 9.03 | 10.50 | 1.02 x 3.15 |
| 27000 | 301R273U6R3JS2 | 15.1 | 8.6 | 10.30 | 12.80 | 1.02 x 3.15 | 27000 | 301R273U7R5JS2 | 15.5 | 8.7 | 10.10 | 12.80 | 1.02 x 3.15 |
| 33000 | 301333U6R3JT2 | 16.7 | 11.4 | 10.50 | 12.00 | 1.02 x 3.65 | 33000 | 301333U7R5JT2 | 17.0 | 11.2 | 10.40 | 12.10 | 1.02 x 3.65 |
| 33000 | 301R333U6R3JT2 | 10.4 | 5.9 | 13.30 | 16.60 | 1.02 x 3.65 | 33000 | 301R333U7R5JT2 | 10.6 | 5.9 | 13.10 | 16.60 | 1.02 x 3.65 |

Type 300/301 –55 °C to 105 °C Long-Life, Switching Power Grade Radial High Capacitance and Ultra-Low ESR

| Cap. (µF) | Catalog Part Number | ESR MAX @ 25°C | | Ripple MAX @ 85°C | | Nom Size Insulated | Cap. (µF) | Catalog Part Number | ESR MAX @ 25°C | | Ripple MAX @ 85°C | | Nom Size Insulated |
|------------------------------|---------------------|--------------------|------|--------------------|-------|--------------------|------------------------------|---------------------|--------------------|------|--------------------|-------|--------------------|
| | | 120 Hz 20 kHz (mΩ) | | 120 Hz 20 kHz (mΩ) | | D x L (in) | | | 120 Hz 20 kHz (mΩ) | | 120 Hz 20 kHz (mΩ) | | D x L (in) |
| 10 Vdc (15 Vdc Surge) | | | | | | | 16 Vdc (25 Vdc Surge) | | | | | | |
| 1800 | 301182U010GE2 | 153.0 | 81.2 | 1.65 | 2.14 | .77 x 1.15 | 1500 | 301152U016GE2 | 159.0 | 80.9 | 1.62 | 2.14 | .77 x 1.15 |
| 1800 | 301R182U010GE2 | 133.0 | 70.3 | 1.77 | 2.30 | .77 x 1.15 | 1500 | 301R152U016GE2 | 138.0 | 70.1 | 1.74 | 2.30 | .77 x 1.15 |
| 3300 | 301R332U010HE2 | 106.0 | 61.8 | 2.17 | 2.69 | .895 x 1.15 | 2700 | 301272U016HE2 | 110.0 | 63.7 | 2.14 | 2.65 | .895 x 1.15 |
| 3300 | 301332U010HE2 | 92.3 | 50.8 | 2.33 | 2.97 | .895 x 1.15 | 2700 | 301R272U016HE2 | 95.2 | 52.4 | 2.30 | 2.92 | .895 x 1.15 |
| 3900 | 301392U010GJ2 | 77.6 | 41.1 | 2.56 | 3.31 | .77 x 1.65 | 3300 | 301332U016GJ2 | 80.4 | 41.0 | 2.51 | 3.32 | .77 x 1.65 |
| 3900 | 301R392U010GJ2 | 67.3 | 35.7 | 2.75 | 3.56 | .77 x 1.65 | 3300 | 301R332U016GJ2 | 69.7 | 35.5 | 2.70 | 3.56 | .77 x 1.65 |
| 4700 | 301472U010JE2 | 88.3 | 56.5 | 2.49 | 2.94 | 1.02 x 1.15 | 3300 | 301332U016JE2 | 90.7 | 56.2 | 2.46 | 2.94 | 1.02 x 1.15 |
| 4700 | 301R472U010JE2 | 76.5 | 42.8 | 2.68 | 3.37 | 1.02 x 1.15 | 3300 | 301R332U016JE2 | 78.6 | 41.6 | 2.64 | 3.42 | 1.02 x 1.15 |
| 5600 | 301562U010GL2 | 52.7 | 27.9 | 3.89 | 5.04 | .77 x 2.15 | 4700 | 301472U016GL2 | 54.5 | 27.8 | 3.82 | 5.05 | .77 x 2.15 |
| 5600 | 301R562U010GL2 | 45.6 | 24.2 | 4.18 | 5.41 | .77 x 2.15 | 4700 | 301R472U016GL2 | 47.2 | 24.1 | 4.11 | 5.42 | .77 x 2.15 |
| 6800 | 301682U010HJ2 | 54.3 | 31.5 | 3.60 | 4.46 | .895 x 1.65 | 4700 | 301472U016HJ2 | 56.0 | 32.5 | 3.55 | 4.39 | .895 x 1.65 |
| 6800 | 301R682U010HJ2 | 47.1 | 25.9 | 3.87 | 4.92 | .895 x 1.65 | 4700 | 301R472U016HJ2 | 48.5 | 26.7 | 3.81 | 4.84 | .895 x 1.65 |
| 8200 | 301822U010GP2 | 40.3 | 21.4 | 4.95 | 6.41 | .77 x 2.65 | 5600 | 301562U016GP2 | 41.7 | 21.3 | 4.87 | 6.43 | .77 x 2.65 |
| 8200 | 301R822U010GP2 | 34.9 | 18.5 | 5.32 | 6.89 | .77 x 2.65 | 5600 | 301R562U016GP2 | 36.1 | 18.4 | 5.23 | 6.90 | .77 x 2.65 |
| 8200 | 301822U010JJ2 | 45.2 | 28.9 | 4.28 | 5.05 | 1.02 x 1.65 | 6800 | 301682U016HL2 | 38.2 | 22.2 | 4.97 | 6.15 | .895 x 2.15 |
| 8200 | 301R822U010JJ2 | 39.2 | 21.9 | 4.60 | 5.80 | 1.02 x 1.65 | 6800 | 301R682U016HL2 | 28.3 | 15.6 | 5.78 | 7.35 | .895 x 2.15 |
| 10000 | 301103U010GS2 | 33.0 | 17.5 | 5.97 | 7.73 | .77 x 3.15 | 6800 | 301682U016JJ2 | 46.4 | 28.8 | 4.23 | 5.06 | 1.02 x 1.65 |
| 10000 | 301R103U010GS2 | 28.6 | 15.2 | 6.41 | 8.31 | .77 x 3.15 | 6800 | 301R682U016JJ2 | 40.2 | 21.3 | 4.54 | 5.88 | 1.02 x 1.65 |
| 10000 | 301103U010HL2 | 37.1 | 21.5 | 5.05 | 6.25 | .895 x 2.15 | 8200 | 301822U016GS2 | 34.1 | 17.4 | 5.87 | 7.75 | .77 x 3.15 |
| 10000 | 301R103U010HL2 | 27.3 | 15.0 | 5.88 | 7.48 | .895 x 2.15 | 8200 | 301R822U016GS2 | 29.6 | 15.1 | 6.31 | 8.33 | .77 x 3.15 |
| 12000 | 301123U010GT2 | 28.3 | 15.0 | 6.88 | 8.91 | .77 x 3.65 | 10000 | 301103U016GT2 | 29.2 | 14.9 | 6.77 | 8.94 | .77 x 3.65 |
| 12000 | 301R123U010GT2 | 24.5 | 13.0 | 7.39 | 9.57 | .77 x 3.65 | 10000 | 301R103U016GT2 | 25.3 | 12.9 | 7.27 | 9.60 | .77 x 3.65 |
| 12000 | 301123U010HP2 | 28.7 | 16.6 | 6.39 | 7.91 | .895 x 2.65 | 10000 | 301103U016HP2 | 29.5 | 17.1 | 6.30 | 7.79 | .895 x 2.65 |
| 12000 | 301R123U010HP2 | 20.8 | 11.5 | 7.49 | 9.53 | .895 x 2.65 | 10000 | 301R103U016HP2 | 21.6 | 11.9 | 7.36 | 9.36 | .895 x 2.65 |
| 12000 | 301123U010JL2 | 31.0 | 19.9 | 5.93 | 6.99 | 1.02 x 2.15 | 10000 | 301103U016JL2 | 31.8 | 19.7 | 5.86 | 7.01 | 1.02 x 2.15 |
| 12000 | 301R123U010JL2 | 20.3 | 11.4 | 7.33 | 9.23 | 1.02 x 2.15 | 10000 | 301R103U016JL2 | 21.0 | 11.1 | 7.21 | 9.33 | 1.02 x 2.15 |
| 15000 | 301153U010HS2 | 23.7 | 13.7 | 7.66 | 9.49 | .895 x 3.15 | 12000 | 301123U016HS2 | 24.4 | 14.1 | 7.55 | 9.35 | .895 x 3.15 |
| 15000 | 301R153U010HS2 | 17.0 | 9.3 | 9.05 | 11.50 | .895 x 3.15 | 12000 | 301R123U016HS2 | 17.6 | 9.7 | 8.89 | 11.30 | .895 x 3.15 |
| 18000 | 301183U010HT2 | 20.5 | 11.9 | 8.81 | 10.90 | .895 x 3.65 | 15000 | 301153U016HT2 | 21.1 | 12.2 | 8.69 | 10.80 | .895 x 3.65 |
| 18000 | 301R183U010HT2 | 14.5 | 8.0 | 10.50 | 13.30 | .895 x 3.65 | 15000 | 301R153U016HT2 | 15.0 | 8.2 | 10.30 | 13.10 | .895 x 3.65 |
| 18000 | 301183U010JP2 | 24.1 | 15.4 | 7.48 | 8.81 | 1.02 x 2.65 | 15000 | 301153U016JP2 | 24.7 | 15.3 | 7.39 | 8.85 | 1.02 x 2.65 |
| 18000 | 301R183U010JP2 | 15.6 | 8.7 | 9.29 | 11.70 | 1.02 x 2.65 | 15000 | 301R153U016JP2 | 16.1 | 8.5 | 9.14 | 11.80 | 1.02 x 2.65 |
| 22000 | 301223U010JS2 | 20.1 | 12.8 | 8.90 | 10.50 | 1.02 x 3.15 | 18000 | 301183U016JS2 | 20.5 | 12.7 | 8.80 | 10.50 | 1.02 x 3.15 |
| 22000 | 301R223U010JS2 | 16.1 | 9.0 | 9.94 | 12.50 | 1.02 x 3.15 | 18000 | 301R183U016JS2 | 16.6 | 8.8 | 9.79 | 12.70 | 1.02 x 3.15 |
| 27000 | 301273U010JT2 | 17.5 | 11.2 | 10.30 | 12.10 | 1.02 x 3.65 | 22000 | 301223U016JT2 | 17.9 | 11.1 | 10.10 | 12.10 | 1.02 x 3.65 |
| 27000 | 301R273U010JT2 | 11.0 | 6.2 | 12.90 | 16.30 | 1.02 x 3.65 | 22000 | 301R223U016JT2 | 11.4 | 6.0 | 12.70 | 16.50 | 1.02 x 3.65 |

Type 300/301 –55 °C to 105 °C Long-Life, Switching Power Grade Radial High Capacitance and Ultra-Low ESR

| Cap. (µF) | Catalog Part Number | ESR MAX @ 25°C | | Ripple MAX @ 85°C | | Nom Size Insulated D x L (in) | Cap. (µF) | Catalog Part Number | ESR MAX @ 25°C | | Ripple MAX @ 85°C | | Nom Size Insulated D x L (in) |
|------------------------------|------------------------|-------------------|--------|----------------------|--------|----------------------------------------|------------------------------|------------------------|-------------------|--------|----------------------|--------|----------------------------------------|
| | | 120 Hz | 20 kHz | 120 Hz | 20 kHz | | | | 120 Hz | 20 kHz | 120 Hz | 20 kHz | |
| 20 Vdc (30 Vdc Surge) | | | | | | | 25 Vdc (35 Vdc Surge) | | | | | | |
| 1200 | 301122U020GE2 | 159.0 | 80.9 | 1.62 | 2.14 | .77 x 1.15 | 1000 | 301102U025GE2 | 170.0 | 81.8 | 1.57 | 2.13 | .77 x 1.15 |
| 1200 | 301R122U020GE2 | 138.0 | 70.1 | 1.74 | 2.30 | .77 x 1.15 | 1000 | 301R102U025GE2 | 148.0 | 70.9 | 1.68 | 2.29 | .77 x 1.15 |
| 2200 | 301222U020HE2 | 110.0 | 61.5 | 2.14 | 2.70 | .895 x 1.15 | 1800 | 301182U025HE2 | 117.0 | 62.1 | 2.07 | 2.68 | .895 x 1.15 |
| 2200 | 301R222U020HE2 | 95.2 | 53.3 | 2.30 | 2.90 | .895 x 1.15 | 1800 | 301R182U025HE2 | 102.0 | 47.7 | 2.23 | 3.06 | .895 x 1.15 |
| 2700 | 301272U020GJ2 | 80.4 | 41.0 | 2.51 | 3.32 | .77 x 1.65 | 2200 | 301222U025GJ2 | 86.3 | 41.4 | 2.42 | 3.30 | .77 x 1.65 |
| 2700 | 301R272U020GJ2 | 69.7 | 35.5 | 2.70 | 3.56 | .77 x 1.65 | 2200 | 301R222U025GJ2 | 74.8 | 35.9 | 2.60 | 3.54 | .77 x 1.65 |
| 2700 | 301272U020JE2 | 90.7 | 57.1 | 2.46 | 2.92 | 1.02 x 1.15 | 2700 | 301272U025JE2 | 95.8 | 57.5 | 2.39 | 2.91 | 1.02 x 1.15 |
| 2700 | 301R272U020JE2 | 78.6 | 49.5 | 2.64 | 3.14 | 1.02 x 1.15 | 2700 | 301R272U025JE2 | 83.0 | 41.5 | 2.57 | 3.42 | 1.02 x 1.15 |
| 3900 | 301392U020GL2 | 54.5 | 27.8 | 3.82 | 5.05 | .77 x 2.15 | 3300 | 301332U025GL2 | 58.4 | 28.1 | 3.69 | 5.02 | .77 x 2.15 |
| 3900 | 301R392U020GL2 | 47.2 | 24.1 | 4.11 | 5.42 | .77 x 2.15 | 3300 | 301R332U025GL2 | 50.6 | 24.3 | 3.97 | 5.40 | .77 x 2.15 |
| 3900 | 301392U020HJ2 | 56.0 | 31.4 | 3.55 | 4.47 | .895 x 1.65 | 3300 | 301332U025HJ2 | 59.7 | 31.6 | 3.44 | 4.45 | .895 x 1.65 |
| 3900 | 301R392U020HJ2 | 48.5 | 27.2 | 3.81 | 4.80 | .895 x 1.65 | 3300 | 301R332U025HJ2 | 51.7 | 24.3 | 3.69 | 5.07 | .895 x 1.65 |
| 4700 | 301472U020GP2 | 41.7 | 21.3 | 4.87 | 6.43 | .77 x 2.65 | 4700 | 301472U025GP2 | 44.7 | 21.4 | 4.71 | 6.40 | .77 x 2.65 |
| 4700 | 301R472U020GP2 | 36.1 | 18.4 | 5.23 | 6.90 | .77 x 2.65 | 4700 | 301R472U025GP2 | 38.7 | 18.6 | 5.05 | 6.88 | .77 x 2.65 |
| 5600 | 301562U020JJ2 | 46.4 | 29.2 | 4.23 | 5.02 | 1.02 x 1.65 | 4700 | 301472U025JJ2 | 48.9 | 29.4 | 4.12 | 5.01 | 1.02 x 1.65 |
| 5600 | 301R562U020JJ2 | 40.2 | 21.3 | 4.54 | 5.88 | 1.02 x 1.65 | 4700 | 301R472U025JJ2 | 42.4 | 21.2 | 4.42 | 5.90 | 1.02 x 1.65 |
| 6800 | 301682U020GS2 | 34.1 | 17.4 | 5.87 | 7.75 | .77 x 3.15 | 5600 | 301562U025GS2 | 36.5 | 17.5 | 5.68 | 7.73 | .77 x 3.15 |
| 6800 | 301R682U020GS2 | 29.6 | 15.1 | 6.31 | 8.33 | .77 x 3.15 | 5600 | 301R562U025GS2 | 31.6 | 15.2 | 6.10 | 8.30 | .77 x 3.15 |
| 6800 | 301682U020HL2 | 38.2 | 21.4 | 4.97 | 6.26 | .895 x 2.15 | 5600 | 301562U025HL2 | 42.0 | 22.3 | 4.74 | 6.14 | .895 x 2.15 |
| 6800 | 301R682U020HL2 | 28.3 | 15.8 | 5.78 | 7.28 | .895 x 2.15 | 5600 | 301R562U025HL2 | 30.4 | 14.3 | 5.58 | 7.67 | .895 x 2.15 |
| 8200 | 301822U020GT2 | 29.2 | 14.9 | 6.77 | 8.94 | .77 x 3.65 | 6800 | 301682U025GT2 | 31.2 | 15.0 | 6.55 | 8.91 | .77 x 3.65 |
| 8200 | 301R822U020GT2 | 25.3 | 12.9 | 7.27 | 9.60 | .77 x 3.65 | 6800 | 301R682U025GT2 | 27.0 | 13.0 | 7.04 | 9.58 | .77 x 3.65 |
| 8200 | 301822U020HP2 | 29.5 | 16.5 | 6.30 | 7.93 | .895 x 2.65 | 6800 | 301682U025HP2 | 31.3 | 16.6 | 6.11 | 7.91 | .895 x 2.65 |
| 8200 | 301R822U020HP2 | 21.6 | 12.1 | 7.36 | 9.28 | .895 x 2.65 | 6800 | 301R682U025HP2 | 23.1 | 10.9 | 7.11 | 9.77 | .895 x 2.65 |
| 8200 | 301822U020JL2 | 31.8 | 20.1 | 5.86 | 6.96 | 1.02 x 2.15 | 6800 | 301682U025JL2 | 33.5 | 20.1 | 5.71 | 6.94 | 1.02 x 2.15 |
| 8200 | 301R822U020JL2 | 21.0 | 11.1 | 7.21 | 9.33 | 1.02 x 2.15 | 6800 | 301R682U025JL2 | 22.5 | 11.3 | 6.96 | 9.29 | 1.02 x 2.15 |
| 10000 | 301103U020HS2 | 24.4 | 13.7 | 7.55 | 9.52 | .895 x 3.15 | 8200 | 301822U025HS2 | 25.8 | 13.7 | 7.34 | 9.50 | .895 x 3.15 |
| 10000 | 301R103U020HS2 | 17.6 | 9.8 | 8.89 | 11.20 | .895 x 3.15 | 8200 | 301R822U025HS2 | 18.9 | 8.9 | 8.59 | 11.81 | .895 x 3.15 |
| 12000 | 301123U020HT2 | 21.1 | 11.8 | 8.69 | 10.90 | .895 x 3.65 | 10000 | 301103U025HT2 | 22.3 | 11.8 | 8.45 | 10.94 | .895 x 3.65 |
| 12000 | 301R123U020HT2 | 15.0 | 8.4 | 10.30 | 13.00 | .895 x 3.65 | 10000 | 301R103U025HT2 | 16.0 | 7.5 | 9.96 | 13.69 | .895 x 3.65 |
| 12000 | 301123U020JP2 | 24.7 | 15.6 | 7.39 | 8.77 | 1.02 x 2.65 | 10000 | 301103U025JP2 | 26.0 | 15.6 | 7.20 | 8.77 | 1.02 x 2.65 |
| 12000 | 301R123U020JP2 | 16.1 | 8.5 | 9.14 | 11.80 | 1.02 x 2.65 | 10000 | 301R103U025JP2 | 17.2 | 8.6 | 8.84 | 11.80 | 1.02 x 2.65 |
| 15000 | 301153U020JS2 | 20.5 | 12.9 | 8.80 | 10.50 | 1.02 x 3.15 | 12000 | 301123U025JS2 | 21.6 | 12.9 | 8.59 | 10.50 | 1.02 x 3.15 |
| 15000 | 301R153U020JS2 | 13.2 | 7.0 | 11.00 | 14.20 | 1.02 x 3.15 | 12000 | 301R123U025JS2 | 14.1 | 7.1 | 10.60 | 14.10 | 1.02 x 3.15 |
| 18000 | 301183U020JT2 | 17.9 | 11.2 | 10.10 | 12.00 | 1.02 x 3.65 | 15000 | 301153U025JT2 | 18.7 | 11.2 | 9.90 | 12.10 | 1.02 x 3.65 |
| 18000 | 301R183U020JT2 | 11.4 | 6.0 | 12.70 | 16.50 | 1.02 x 3.65 | 15000 | 301R153U025JT2 | 12.1 | 6.0 | 12.30 | 16.40 | 1.02 x 3.65 |

Type 300/301 –55 °C to 105 °C Long-Life, Switching Power Grade Radial

High Capacitance and Ultra-Low ESR

| Cap. (µF) | Catalog Part Number | ESR MAX @ 25°C | | Ripple MAX @ 85°C | | Nom Size Insulated D x L (in) |
|------------------------------|------------------------|-----------------------|-----------------------|-----------------------|-----------------------|----------------------------------------|
| | | 120 Hz 20 kHz (mΩ) | 120 Hz 20 kHz (mΩ) | 120 Hz 20 kHz (mΩ) | 120 Hz 20 kHz (mΩ) | |
| 40 Vdc (60 Vdc Surge) | | | | | | |
| 1200 | 301122U040HE2 | 137.0 | 65.6 | 1.92 | 2.61 | .895 x 1.15 |
| 1200 | 301R122U040HE2 | 118.0 | 52.1 | 2.06 | 2.93 | .895 x 1.15 |
| 1500 | 301152U040JE2 | 109.0 | 60.2 | 2.24 | 2.84 | 1.02 x 1.15 |
| 1500 | 301R152U040JE2 | 94.8 | 43.6 | 2.40 | 3.34 | 1.02 x 1.15 |
| 2200 | 301222U040HJ2 | 69.4 | 33.3 | 3.18 | 4.33 | .895 x 1.65 |
| 2200 | 301R222U040HJ2 | 60.2 | 26.5 | 3.42 | 4.86 | .895 x 1.65 |
| 3300 | 301332U040HL2 | 47.2 | 22.6 | 4.48 | 6.09 | .895 x 2.15 |
| 3300 | 301R332U040HL2 | 36.0 | 15.8 | 5.12 | 7.28 | .895 x 2.15 |
| 3300 | 301332U040JJ2 | 55.8 | 30.7 | 3.86 | 4.90 | 1.02 x 1.65 |
| 3300 | 301R332U040JJ2 | 48.3 | 22.2 | 4.14 | 5.76 | 1.02 x 1.65 |
| 3900 | 301R392U040GS2 | 37.1 | 16.7 | 5.63 | 7.92 | .77 x 3.15 |
| 4700 | 301472U040GT2 | 36.4 | 16.4 | 6.06 | 8.52 | .77 x 3.65 |
| 4700 | 301R472U040GT2 | 31.6 | 14.2 | 6.51 | 9.15 | .77 x 3.65 |
| 4700 | 301472U040HP2 | 36.2 | 17.4 | 5.68 | 7.73 | .895 x 2.65 |
| 4700 | 301R472U040HP2 | 27.4 | 12.0 | 6.54 | 9.29 | .895 x 2.65 |
| 4700 | 301472U040JL2 | 38.1 | 20.9 | 5.35 | 6.81 | 1.02 x 2.15 |
| 4700 | 301R472U040JL2 | 26.5 | 12.2 | 6.42 | 8.93 | 1.02 x 2.15 |
| 5600 | 301562U040HS2 | 29.7 | 14.3 | 6.84 | 9.31 | .895 x 3.15 |
| 5600 | 301R562U040HS2 | 22.2 | 9.8 | 7.91 | 11.20 | .895 x 3.15 |
| 6800 | 301682U040HT2 | 25.5 | 12.3 | 7.89 | 10.70 | .895 x 3.65 |
| 6800 | 301R682U040HT2 | 18.9 | 8.3 | 9.18 | 13.10 | .895 x 3.65 |
| 6800 | 301682U040JP2 | 29.4 | 16.2 | 6.77 | 8.61 | 1.02 x 2.65 |
| 6800 | 301R682U040JP2 | 20.2 | 9.3 | 8.17 | 11.40 | 1.02 x 2.65 |
| 8200 | 301822U040JS2 | 24.3 | 13.4 | 8.09 | 10.30 | 1.02 x 3.15 |
| 8200 | 301R822U040JS2 | 16.5 | 7.6 | 9.82 | 13.60 | 1.02 x 3.15 |
| 10000 | 301103U040JT2 | 21.0 | 11.5 | 9.35 | 11.90 | 1.02 x 3.65 |
| 10000 | 301R103U040JT2 | 14.1 | 6.5 | 11.40 | 15.90 | 1.02 x 3.65 |
| 50 Vdc (75 Vdc Surge) | | | | | | |
| 560 | 301R561U050GE2 | 216.0 | 88.6 | 1.39 | 2.05 | .77 x 1.15 |
| 560 | 301561U050GE2 | 249.0 | 102.0 | 1.29 | 1.91 | .77 x 1.15 |
| 1200 | 301R122U050GJ2 | 109.0 | 44.7 | 2.16 | 3.18 | .77 x 1.65 |
| 1200 | 301122U050GJ2 | 126.0 | 51.6 | 2.01 | 2.96 | .77 x 1.65 |
| 1200 | 301122U050JE2 | 130.0 | 62.4 | 2.05 | 2.79 | 1.02 x 1.15 |
| 1200 | 301R122U050JE2 | 113.0 | 43.9 | 2.21 | 3.33 | 1.02 x 1.15 |
| 1500 | 301R152U050GL2 | 73.4 | 30.1 | 3.29 | 4.85 | .77 x 2.15 |
| 1500 | 301152U050GL2 | 84.7 | 34.7 | 3.07 | 4.52 | .77 x 2.15 |
| 1800 | 301182U050HJ2 | 84.0 | 34.5 | 2.89 | 4.26 | .895 x 1.65 |
| 1800 | 301R182U050HJ2 | 72.8 | 26.2 | 3.11 | 4.89 | .895 x 1.65 |
| 2200 | 301R222U050GP2 | 55.8 | 22.9 | 4.21 | 6.20 | .77 x 2.65 |
| 2200 | 301222U050GP2 | 64.4 | 26.4 | 3.92 | 5.77 | .77 x 2.65 |
| 2700 | 301R272U050GS2 | 45.3 | 18.6 | 5.10 | 7.51 | .77 x 3.15 |
| 2700 | 301272U050GS2 | 52.3 | 21.4 | 4.75 | 6.99 | .77 x 3.15 |
| 2700 | 301272U050HL2 | 56.9 | 23.3 | 4.07 | 6.00 | .895 x 2.15 |
| 2700 | 301R272U050HL2 | 44.5 | 16.0 | 4.61 | 7.24 | .895 x 2.15 |
| 2700 | 301272U050JJ2 | 66.0 | 31.7 | 3.54 | 4.82 | 1.02 x 1.65 |
| 2700 | 301R272U050JJ2 | 57.2 | 22.3 | 3.81 | 5.75 | 1.02 x 1.65 |
| 3300 | 301R332U050GT2 | 38.4 | 15.7 | 5.90 | 8.69 | .77 x 3.65 |
| 3300 | 301332U050GT2 | 44.3 | 18.2 | 5.49 | 8.09 | .77 x 3.65 |
| 3300 | 301332U050HP2 | 43.5 | 17.8 | 5.18 | 7.63 | .895 x 2.65 |
| 3300 | 301R332U050HP2 | 33.7 | 12.1 | 5.89 | 9.26 | .895 x 2.65 |
| 3900 | 301392U050JL2 | 44.9 | 21.6 | 4.93 | 6.71 | 1.02 x 2.15 |
| 3900 | 301R392U050JL2 | 32.4 | 12.6 | 5.81 | 8.77 | 1.02 x 2.15 |
| 4700 | 301472U050HS2 | 35.6 | 14.6 | 6.25 | 9.21 | .895 x 3.15 |
| 4700 | 301R472U050HS2 | 27.3 | 9.8 | 7.14 | 11.20 | .895 x 3.15 |
| 5600 | 301562U050HT2 | 30.4 | 12.5 | 7.23 | 10.60 | .895 x 3.65 |
| 5600 | 301R562U050HT2 | 23.1 | 8.3 | 8.30 | 13.00 | .895 x 3.65 |
| 5600 | 301562U050JP2 | 34.5 | 16.6 | 6.25 | 8.50 | 1.02 x 2.65 |
| 5600 | 301R562U050JP2 | 24.6 | 9.6 | 7.40 | 11.20 | 1.02 x 2.65 |
| 6800 | 301682U050JS2 | 28.4 | 13.6 | 7.48 | 10.20 | 1.02 x 3.15 |
| 6800 | 301R682U050JS2 | 20.0 | 7.8 | 8.91 | 13.40 | 1.02 x 3.15 |
| 8200 | 301822U050JT2 | 24.4 | 11.7 | 8.67 | 11.80 | 1.02 x 3.65 |
| 8200 | 301R822U050JT2 | 17.0 | 6.6 | 10.40 | 15.70 | 1.02 x 3.65 |
| 63 Vdc (90 Vdc Surge) | | | | | | |
| 390 | 301391U063GE2 | 281.0 | 92.7 | 1.22 | 2.00 | .77 x 1.15 |
| 390 | 301R391U063GE2 | 243.0 | 80.3 | 1.31 | 2.15 | .77 x 1.15 |
| 680 | 301681U063HE2 | 185.0 | 70.5 | 1.65 | 2.52 | .895 x 1.15 |
| 680 | 301R681U063HE2 | 161.0 | 53.0 | 1.77 | 2.90 | .895 x 1.15 |
| 820 | 301821U063GJ2 | 142.0 | 46.7 | 1.89 | 3.11 | .77 x 1.65 |
| 820 | 301R821U063GJ2 | 123.0 | 40.5 | 2.03 | 3.34 | .77 x 1.65 |
| 1000 | 301102U063JE2 | 144.0 | 63.2 | 1.95 | 2.78 | 1.02 x 1.15 |
| 1000 | 301R102U063JE2 | 124.0 | 43.5 | 2.10 | 3.34 | 1.02 x 1.15 |
| 1200 | 301122U063GL2 | 95.2 | 31.4 | 2.89 | 4.75 | .77 x 2.15 |
| 1200 | 301R122U063GL2 | 82.5 | 27.2 | 3.11 | 5.10 | .77 x 2.15 |
| 1200 | 301122U063HJ2 | 93.8 | 35.6 | 2.74 | 4.19 | .895 x 1.65 |
| 1200 | 301R122U063HJ2 | 81.3 | 26.8 | 2.94 | 4.83 | .895 x 1.65 |

Type 300/301 –55 °C to 105 °C Long-Life, Switching Power Grade Radial

High Capacitance and Ultra-Low ESR

| Cap. (µF) | Catalog Part Number | ESR MAX @ 25°C 120 Hz 20 kHz (mΩ) | | Ripple MAX @ 85°C 120 Hz 20 kHz (mΩ) | | Nom Size Insulated D x L (in) |
|--------------------------------|------------------------|--------------------------------------------|-------|-----------------------------------------------|-------|----------------------------------------|
| 63 Vdc (90 Vdc Surge) | | | | | | |
| 1500 | 301152U063GP2 | 72.3 | 23.8 | 3.70 | 6.07 | .77 x 2.65 |
| 1500 | 301R152U063GP2 | 62.6 | 20.7 | 3.97 | 6.52 | .77 x 2.65 |
| 1800 | 301182U063HL2 | 63.4 | 24.1 | 3.86 | 5.90 | .895 x 2.15 |
| 1800 | 301R182U063HL2 | 50.1 | 16.5 | 4.34 | 7.13 | .895 x 2.15 |
| 1800 | 301182U063JJ2 | 72.8 | 32.0 | 3.37 | 4.80 | 1.02 x 1.65 |
| 1800 | 301R182U063JJ2 | 63.1 | 22.1 | 3.62 | 5.78 | 1.02 x 1.65 |
| 2200 | 301222U063GS2 | 58.6 | 19.3 | 4.48 | 7.36 | .77 x 3.15 |
| 2200 | 301R222U063GS2 | 50.8 | 16.8 | 4.82 | 7.90 | .77 x 3.15 |
| 2200 | 301222U063GT2 | 49.6 | 16.4 | 5.19 | 8.53 | .77 x 3.65 |
| 2200 | 301R222U063GT2 | 43.0 | 14.2 | 5.58 | 9.16 | .77 x 3.65 |
| 2700 | 301272U063HP2 | 48.4 | 18.4 | 4.92 | 7.52 | .895 x 2.65 |
| 2700 | 301R272U063HP2 | 37.9 | 12.5 | 5.55 | 9.11 | .895 x 2.65 |
| 2700 | 301272U063JL2 | 49.5 | 21.8 | 4.70 | 6.68 | 1.02 x 2.15 |
| 2700 | 301R272U063JL2 | 36.3 | 12.7 | 5.48 | 8.74 | 1.02 x 2.15 |
| 3300 | 301332U063HS2 | 39.5 | 15.0 | 5.94 | 9.08 | .895 x 3.15 |
| 3300 | 301R332U063HS2 | 30.7 | 10.1 | 6.73 | 11.10 | .895 x 3.15 |
| 3900 | 301392U063HT2 | 33.7 | 12.8 | 6.87 | 10.50 | .895 x 3.65 |
| 3900 | 301R392U063HT2 | 25.9 | 8.5 | 7.84 | 12.90 | .895 x 3.65 |
| 3900 | 301392U063JP2 | 37.9 | 16.7 | 5.96 | 8.47 | 1.02 x 2.65 |
| 3900 | 301R392U063JP2 | 27.6 | 9.7 | 6.99 | 11.10 | 1.02 x 2.65 |
| 4700 | 301472U063JS2 | 31.1 | 13.7 | 7.15 | 10.20 | 1.02 x 3.15 |
| 4700 | 301R472U063JS2 | 22.4 | 7.8 | 8.42 | 13.40 | 1.02 x 3.15 |
| 5600 | 301562U063JT2 | 26.7 | 11.7 | 8.30 | 11.80 | 1.02 x 3.65 |
| 5600 | 301R562U063JT2 | 19.0 | 6.6 | 9.83 | 15.70 | 1.02 x 3.65 |
| 75 Vdc (100 Vdc Surge) | | | | | | |
| 330 | 301331U075GE2 | 360.0 | 155.0 | 1.08 | 1.55 | .77 x 1.15 |
| 330 | 301R331U075GE2 | 312.0 | 134.0 | 1.16 | 1.66 | .77 x 1.15 |
| 470 | 301471U075HE2 | 234.0 | 108.0 | 1.47 | 2.04 | .895 x 1.15 |
| 470 | 301R471U075HE2 | 203.0 | 87.3 | 1.57 | 2.26 | .895 x 1.15 |
| 560 | 301561U075GJ2 | 181.0 | 77.8 | 1.67 | 2.41 | .77 x 1.65 |
| 560 | 301R561U075GJ2 | 157.0 | 67.4 | 1.80 | 2.59 | .77 x 1.65 |
| 680 | 301681U075JE2 | 178.0 | 88.8 | 1.76 | 2.34 | 1.02 x 1.15 |
| 680 | 301R681U075JE2 | 154.0 | 67.7 | 1.89 | 2.68 | 1.02 x 1.15 |
| 1000 | 301102U075GL2 | 122.0 | 52.3 | 2.56 | 3.68 | .77 x 2.15 |
| 1000 | 301R102U075GL2 | 105.0 | 45.3 | 2.75 | 3.95 | .77 x 2.15 |
| 1000 | 301102U075HJ2 | 118.0 | 54.3 | 2.44 | 3.39 | .895 x 1.65 |
| 1000 | 301R102U075HJ2 | 102.0 | 44.0 | 2.62 | 3.77 | .895 x 1.65 |
| 100 Vdc (140 Vdc Surge) | | | | | | |
| 150 | 301151U100GE2 | 581.0 | 221.0 | 0.85 | 1.30 | .77 x 1.15 |
| 150 | 301R151U100GE2 | 503.0 | 191.0 | 0.91 | 1.39 | .77 x 1.15 |
| 220 | 301221U100HE2 | 371.0 | 141.0 | 1.16 | 1.78 | .895 x 1.15 |
| 220 | 301R221U100HE2 | 321.0 | 122.0 | 1.25 | 1.91 | .895 x 1.15 |
| 270 | 301271U100GJ2 | 291.0 | 111.0 | 1.32 | 2.02 | .77 x 1.65 |
| 270 | 301R271U100GJ2 | 252.0 | 95.9 | 1.42 | 2.17 | .77 x 1.65 |
| 330 | 301331U100JE2 | 273.0 | 109.0 | 1.42 | 2.11 | 1.02 x 1.15 |
| 330 | 301R331U100JE2 | 237.0 | 92.3 | 1.52 | 2.30 | 1.02 x 1.15 |
| 470 | 301471U100GL2 | 195.0 | 74.1 | 2.02 | 3.09 | .77 x 2.15 |
| 470 | 301R471U100GL2 | 169.0 | 64.3 | 2.17 | 3.32 | .77 x 2.15 |
| 470 | 301471U100HJ2 | 186.0 | 70.8 | 1.94 | 2.97 | .895 x 1.65 |
| 470 | 301R471U100HJ2 | 162.0 | 61.4 | 2.09 | 3.19 | .895 x 1.65 |
| 560 | 301561U100GP2 | 147.0 | 55.9 | 2.59 | 3.96 | .77 x 2.65 |

Type 300/301 –55 °C to 105 °C Long-Life, Switching Power Grade Radial High Capacitance and Ultra-Low ESR

| Cap. (µF) | Catalog Part Number | ESR MAX @ 25°C | | Ripple MAX @ 85°C | | Nom Size Insulated D x L (in) |
|--------------------------------|---------------------|--------------------|--------------------|--------------------|--------------------|-------------------------------|
| | | 120 Hz 20 kHz (mΩ) | 120 Hz 20 kHz (mΩ) | 120 Hz 20 kHz (mΩ) | 120 Hz 20 kHz (mΩ) | |
| 100 Vdc (140 Vdc Surge) | | | | | | |
| 560 | 301R561U100GP2 | 128.0 | 48.5 | 2.78 | 4.26 | .77 x 2.65 |
| 680 | 301681U100GS2 | 119.0 | 45.0 | 3.15 | 4.82 | .77 x 3.15 |
| 680 | 301R681U100GS2 | 103.0 | 39.0 | 3.39 | 5.18 | .77 x 3.15 |
| 680 | 301681U100HL2 | 125.0 | 47.6 | 2.75 | 4.20 | .895 x 2.15 |
| 680 | 301R681U100HL2 | 104.0 | 39.4 | 3.02 | 4.62 | .895 x 2.15 |
| 680 | 301681U100JJ2 | 138.0 | 55.1 | 2.45 | 3.66 | 1.02 x 1.65 |
| 680 | 301R681U100JJ2 | 119.0 | 46.5 | 2.64 | 3.98 | 1.02 x 1.65 |
| 820 | 301821U100GT2 | 99.5 | 37.8 | 3.67 | 5.61 | .77 x 3.65 |
| 820 | 301R821U100GT2 | 86.2 | 32.8 | 3.94 | 6.02 | .77 x 3.65 |
| 1000 | 301102U100HP2 | 94.7 | 36.0 | 3.51 | 5.38 | .895 x 2.65 |
| 1000 | 301R102U100HP2 | 78.1 | 29.7 | 3.87 | 5.92 | .895 x 2.65 |
| 1000 | 301102U100JL2 | 92.7 | 37.1 | 3.43 | 5.12 | 1.02 x 2.15 |
| 1000 | 301R102U100JL2 | 73.8 | 28.8 | 3.85 | 5.81 | 1.02 x 2.15 |
| 1200 | 301122U100HS2 | 76.5 | 29.1 | 4.26 | 6.52 | .895 x 3.15 |
| 1200 | 301R122U100HS2 | 62.8 | 23.9 | 4.71 | 7.20 | .895 x 3.15 |
| 1200 | 301122U100HT2 | 64.5 | 24.5 | 4.96 | 7.59 | .895 x 3.65 |
| 1200 | 301R122U100HT2 | 52.6 | 20.0 | 5.50 | 8.41 | .895 x 3.65 |
| 1200 | 301122U100JP2 | 70.3 | 28.1 | 4.38 | 6.53 | 1.02 x 2.65 |
| 1200 | 301R122U100JP2 | 55.7 | 21.7 | 4.92 | 7.43 | 1.02 x 2.65 |
| 1500 | 301152U100JS2 | 57.0 | 22.8 | 5.28 | 7.87 | 1.02 x 3.15 |
| 1500 | 301R152U100JS2 | 44.9 | 17.5 | 5.95 | 8.99 | 1.02 x 3.15 |
| 2200 | 301222U100JT2 | 48.3 | 19.3 | 6.17 | 9.19 | 1.02 x 3.65 |
| 2200 | 301R222U100JT2 | 37.7 | 14.7 | 6.97 | 10.50 | 1.02 x 3.65 |
| 160 Vdc (200 Vdc Surge) | | | | | | |
| 56 | 301560T160GE2 | 1817.0 | 690.0 | 0.48 | 0.73 | .77 x 1.15 |
| 82 | 301820T160HE2 | 1169.0 | 444.0 | 0.66 | 1.00 | .895 x 1.15 |
| 100 | 301101T160GJ2 | 1019.0 | 387.0 | 0.71 | 1.08 | .77 x 1.65 |
| 120 | 301121T160JE2 | 904.0 | 362.0 | 0.78 | 1.16 | 1.02 x 1.15 |
| 150 | 301151T160GL2 | 608.0 | 231.0 | 1.15 | 1.75 | .77 x 2.15 |
| 180 | 301181T160HJ2 | 586.0 | 222.0 | 1.10 | 1.68 | .895 x 1.65 |
| 220 | 301221T160GP2 | 457.0 | 174.0 | 1.47 | 2.25 | .77 x 2.65 |
| 270 | 301271T160GS2 | 366.0 | 139.0 | 1.79 | 2.74 | .77 x 3.15 |
| 270 | 301271T160HL2 | 391.0 | 149.0 | 1.55 | 2.38 | .895 x 2.15 |
| 270 | 301271T160JJ2 | 415.0 | 166.0 | 1.41 | 2.11 | 1.02 x 1.65 |
| 330 | 301331T160GT2 | 306.0 | 116.0 | 2.09 | 3.20 | .77 x 3.65 |
| 390 | 301391T160HP2 | 268.0 | 102.0 | 2.09 | 3.19 | .895 x 2.65 |
| 390 | 301391T160JL2 | 278.0 | 111.0 | 1.98 | 2.95 | 1.02 x 2.15 |
| 470 | 301471T160HS2 | 226.0 | 85.7 | 2.48 | 3.80 | .895 x 3.15 |
| 470 | 301471T160JP2 | 228.0 | 91.4 | 2.43 | 3.62 | 1.02 x 2.65 |

| Cap. (µF) | Catalog Part Number | ESR MAX @ 25°C | | Ripple MAX @ 85°C | | Nom Size Insulated D x L (in) |
|--------------------------------|---------------------|--------------------|--------------------|--------------------|--------------------|-------------------------------|
| | | 120 Hz 20 kHz (mΩ) | 120 Hz 20 kHz (mΩ) | 120 Hz 20 kHz (mΩ) | 120 Hz 20 kHz (mΩ) | |
| 560 | 301561T160HT2 | 189.0 | 71.8 | 2.90 | 4.44 | .895 x 3.65 |
| 560 | 301561T160JS2 | 184.0 | 73.5 | 2.94 | 4.39 | 1.02 x 3.15 |
| 680 | 301681T160JT2 | 154.0 | 61.6 | 3.45 | 5.15 | 1.02 x 3.65 |
| 200 Vdc (250 Vdc Surge) | | | | | | |
| 56 | 301560T200GE2 | 2285.0 | 1051.0 | 0.43 | 0.59 | .77 x 1.15 |
| 82 | 301820T200HE2 | 1423.0 | 655.0 | 0.59 | 0.83 | .895 x 1.15 |
| 100 | 301101T200GJ2 | 1144.0 | 526.0 | 0.67 | 0.93 | .77 x 1.65 |
| 120 | 301121T200JE2 | 1012.0 | 465.0 | 0.74 | 1.02 | 1.02 x 1.15 |
| 150 | 301151T200GL2 | 763.0 | 351.0 | 1.02 | 1.42 | .77 x 2.15 |
| 180 | 301181T200HJ2 | 713.0 | 328.0 | 0.99 | 1.38 | .895 x 1.65 |
| 220 | 301221T200GP2 | 574.0 | 264.0 | 1.31 | 1.82 | .77 x 2.65 |
| 220 | 301221T200JJ2 | 507.0 | 233.0 | 1.28 | 1.78 | 1.02 x 1.65 |
| 270 | 301271T200GS2 | 460.0 | 212.0 | 1.60 | 2.22 | .77 x 3.15 |
| 270 | 301271T200HL2 | 476.0 | 219.0 | 1.41 | 1.96 | .895 x 2.15 |
| 330 | 301331T200GT2 | 384.0 | 177.0 | 1.87 | 2.59 | .77 x 3.65 |
| 330 | 301331T200HP2 | 358.0 | 165.0 | 1.81 | 2.51 | .895 x 2.65 |
| 390 | 301391T200HS2 | 288.0 | 132.0 | 2.20 | 3.06 | .895 x 3.15 |
| 390 | 301391T200JL2 | 339.0 | 156.0 | 1.79 | 2.49 | 1.02 x 2.15 |
| 470 | 301471T200HT2 | 240.0 | 111.0 | 2.57 | 3.57 | .895 x 3.65 |
| 470 | 301471T200JP2 | 255.0 | 117.0 | 2.30 | 3.19 | 1.02 x 2.65 |
| 560 | 301561T200JS2 | 205.0 | 94.4 | 2.78 | 3.87 | 1.02 x 3.15 |
| 680 | 301681T200JT2 | 172.0 | 79.1 | 3.27 | 4.54 | 1.02 x 3.65 |
| 250 Vdc (300 Vdc Surge) | | | | | | |
| 39 | 301390T250GE2 | 2708.0 | 1137.0 | 0.39 | 0.57 | .77 x 1.15 |
| 68 | 301680T250HE2 | 1684.0 | 707.0 | 0.55 | 0.79 | .895 x 1.15 |
| 82 | 301820T250GJ2 | 1355.0 | 569.0 | 0.61 | 0.89 | .77 x 1.65 |
| 100 | 301101T250JE2 | 1194.0 | 502.0 | 0.68 | 0.99 | 1.02 x 1.15 |
| 120 | 301121T250GL2 | 905.0 | 380.0 | 0.94 | 1.37 | .77 x 2.15 |
| 120 | 301121T250HJ2 | 843.0 | 354.0 | 0.91 | 1.33 | .895 x 1.65 |
| 150 | 301151T250GP2 | 679.0 | 285.0 | 1.21 | 1.75 | .77 x 2.65 |
| 180 | 301181T250JJ2 | 598.0 | 251.0 | 1.18 | 1.71 | 1.02 x 1.65 |
| 220 | 301221T250GS2 | 544.0 | 229.0 | 1.47 | 2.14 | .77 x 3.15 |
| 220 | 301221T250HL2 | 563.0 | 237.0 | 1.30 | 1.88 | .895 x 2.15 |
| 270 | 301271T250GT2 | 455.0 | 191.0 | 1.72 | 2.50 | .77 x 3.65 |
| 270 | 301271T250HP2 | 423.0 | 178.0 | 1.66 | 2.42 | .895 x 2.65 |
| 270 | 301271T250JL2 | 400.0 | 168.0 | 1.65 | 2.40 | 1.02 x 2.15 |
| 330 | 301331T250HS2 | 340.0 | 143.0 | 2.02 | 2.94 | .895 x 3.15 |
| 390 | 301391T250HT2 | 284.0 | 119.0 | 2.37 | 3.44 | .895 x 3.65 |
| 390 | 301391T250JP2 | 301.0 | 126.0 | 2.12 | 3.08 | 1.02 x 2.65 |
| 470 | 301471T250JS2 | 242.0 | 102.0 | 2.56 | 3.73 | 1.02 x 3.15 |
| 560 | 301561T250JT2 | 202.0 | 85.0 | 3.01 | 4.38 | 1.02 x 3.65 |

Type 300/301 –55 °C to 105 °C Long-Life, Switching Power Grade Radial

High Capacitance and Ultra-Low ESR

| Cap. (µF) | Catalog Part Number | ESR MAX @ 25°C 120 Hz 20 kHz (mΩ) | | Ripple MAX @ 85°C 120 Hz 20 kHz (mΩ) | | Nom Size Insulated D x L (in) | Cap. (µF) | Catalog Part Number | ESR MAX @ 25°C 120 Hz 20 kHz (mΩ) | | Ripple MAX @ 85°C 120 Hz 20 kHz (mΩ) | | Nom Size Insulated D x L (in) |
|------------------------------|---------------------|--------------------------------------|-------|-----------------------------------------|------|-------------------------------|------------------------------|---------------------|--------------------------------------|-------|-----------------------------------------|------|-------------------------------|
| 6.3 Vdc (9 Vdc Surge) | | | | | | | 680 | NR301681U020FF2 | 170.0 | 60.0 | 1.72 | 2.90 | .65 x 1.32 |
| 680 | NR301681U6R3EM2 | 231.0 | 150.0 | 1.16 | 1.44 | .51 x 1.10 | 1000 | NR301R102M020EN2 | 114.0 | 48.0 | 1.10 | 1.69 | .51 x 1.38 |
| 1000 | NR301102U6R3FK2 | 160.0 | 90.0 | 1.54 | 2.05 | .65 x 1.04 | 1500 | NR301R152M020ER2 | 85.0 | 33.0 | 2.23 | 3.58 | .51 x 1.73 |
| 1200 | NR301122U6R3ER2 | 134.0 | 70.0 | 1.78 | 2.46 | .51 x 1.73 | 1500 | NR301152U020LV2 | 90.0 | 50.0 | 2.42 | 3.25 | .73 x 1.63 |
| 1500 | NR301R152M6R3EG2 | 201.0 | 71.0 | 1.09 | 1.84 | .51 x .85 | 2200 | NR301R222M020FQ2 | 77.0 | 32.0 | 2.55 | 3.96 | .65 x 1.48 |
| 1500 | NR301152U6R3FN2 | 105.0 | 50.0 | 2.00 | 2.90 | .65 x 1.32 | 3300 | NR301R332M020LV2 | 62.0 | 26.0 | 3.19 | 4.92 | .73 x 1.63 |
| 2200 | NR301R222M6R3EM2 | 110.0 | 60.0 | 1.20 | 1.63 | .51 x 1.10 | 25 Vdc (35 Vdc Surge) | | | | | | |
| 3300 | NR301R332M6R3EN2 | 93.0 | 57.0 | 1.78 | 2.28 | .51 x 1.38 | 330 | NR301331U025EN2 | 290.0 | 120.0 | 1.13 | 1.75 | .51 x 1.38 |
| 3300 | NR301332U6R3LV2 | 76.0 | 45.0 | 2.61 | 3.39 | .73 x 1.63 | 390 | NR301R391M025EG2 | 267.0 | 92.0 | 0.89 | 1.52 | .51 x .85 |
| 3900 | NR301R392M6R3FK2 | 111.0 | 41.0 | 1.84 | 3.03 | .65 x 1.04 | 470 | NR301471U025ER2 | 220.0 | 80.0 | 1.42 | 2.35 | .51 x 1.73 |
| 4700 | NR301R472M6R3ER2 | 68.0 | 31.0 | 2.52 | 3.73 | .51 x 1.73 | 560 | NR301R561M025EK2 | 193.0 | 75.0 | 1.12 | 1.79 | .51 x 1.04 |
| 5600 | NR301R562M6R3FF2 | 78.0 | 37.0 | 2.43 | 3.53 | .65 x 1.32 | 680 | NR301R681M025EM2 | 160.0 | 67.0 | 1.40 | 2.17 | .51 x 1.10 |
| 5600 | NR301R682M6R3FQ2 | 71.0 | 34.0 | 2.53 | 3.65 | .65 x 1.48 | 680 | NR301681U025FQ2 | 190.0 | 75.0 | 1.53 | 2.44 | .65 x 1.48 |
| 5600 | NR301R822M6R3FV2 | 59.0 | 31.0 | 3.03 | 4.18 | .65 x 1.65 | 1000 | NR301R102M025EN2 | 152.0 | 56.0 | 1.62 | 2.67 | .51 x 1.38 |
| 6800 | NR301R822M6R3LQ2 | 67.0 | 29.0 | 2.97 | 4.51 | .73 x 1.48 | 1200 | NR301R122M025ER2 | 90.0 | 34.0 | 2.20 | 3.58 | .51 x 1.73 |
| 8200 | NR301R103M6R3LV2 | 54.0 | 24.0 | 3.47 | 5.21 | .73 x 1.63 | 1200 | NR301R122M025FK2 | 132.0 | 45.0 | 1.71 | 2.93 | .65 x 1.04 |
| 10 Vdc (15 Vdc Surge) | | | | | | | 1200 | NR301122U025LV2 | 100.0 | 50.0 | 2.26 | 3.20 | .73 x 1.63 |
| 1000 | NR301R102M010EG2 | 216.0 | 77.0 | 1.07 | 1.80 | .51 x .85 | 1500 | NR301R152M025FF2 | 95.0 | 39.0 | 2.20 | 3.44 | .65 x 1.32 |
| 1500 | NR301R152M010EK2 | 200.0 | 64.0 | 1.07 | 1.90 | .51 x 1.04 | 1800 | NR301R182M025FQ2 | 75.0 | 32.0 | 2.59 | 3.97 | .65 x 1.48 |
| 1800 | NR301R182M010EM2 | 122.0 | 62.0 | 1.58 | 2.21 | .51 x 1.10 | 2200 | NR301R222M025FV2 | 73.0 | 31.0 | 2.69 | 4.13 | .65 x 1.65 |
| 2700 | NR301R272M010EN2 | 111.0 | 59.0 | 1.66 | 2.28 | .51 x 1.38 | 2200 | NR301R222M025LQ2 | 70.0 | 30.0 | 2.84 | 4.34 | .73 x 1.48 |
| 2700 | NR301R272M010FK2 | 116.0 | 42.0 | 2.04 | 3.39 | .65 x 1.04 | 2700 | NR301R272M025LV2 | 62.0 | 26.0 | 3.22 | 4.97 | .73 x 1.63 |
| 3300 | NR301R332M010ER2 | 75.0 | 32.0 | 2.41 | 3.69 | .51 x 1.73 | 40 Vdc (60 Vdc Surge) | | | | | | |
| 4700 | NR301R472M010FF2 | 87.0 | 38.0 | 2.29 | 3.47 | .65 x 1.32 | 220 | NR301221U040FK2 | 480.0 | 140.0 | 0.89 | 1.65 | .65 x 1.04 |
| 5600 | NR301R562M010FQ2 | 78.0 | 33.0 | 2.35 | 3.62 | .65 x 1.48 | 330 | NR301R331M040EM2 | 202.0 | 68.0 | 1.19 | 2.05 | .51 x 1.10 |
| 6800 | NR301R682M010LQ2 | 71.0 | 31.0 | 2.92 | 4.42 | .73 x 1.48 | 330 | NR301331U040FN2 | 330.0 | 120.0 | 1.35 | 2.24 | .65 x 1.32 |
| 8200 | NR301R882M010LV2 | 60.0 | 26.0 | 3.30 | 5.01 | .73 x 1.63 | 390 | NR301391U040ER2 | 270.0 | 150.0 | 1.42 | 1.90 | .51 x 1.73 |
| 16 Vdc (25 Vdc Surge) | | | | | | | 470 | NR301R471M040FK2 | 133.0 | 46.0 | 1.66 | 2.82 | .65 x 1.04 |
| 820 | NR301R821M016EG2 | 216.0 | 85.0 | 1.12 | 1.78 | .51 x .85 | 680 | NR301R681M040ER2 | 95.0 | 35.0 | 2.07 | 3.41 | .51 x 1.73 |
| 1200 | NR301R122M016EM2 | 130.0 | 66.0 | 1.60 | 2.24 | .51 x 1.10 | 820 | NR301821U040LV2 | 160.0 | 75.0 | 1.78 | 2.60 | .73 x 1.63 |
| 1800 | NR301R182M016EN2 | 122.0 | 55.0 | 1.85 | 2.76 | .51 x 1.38 | 1000 | NR301R102M040FQ2 | 80.0 | 33.0 | 2.49 | 3.87 | .65 x 1.48 |
| 2200 | NR301R222M016FK2 | 120.0 | 42.0 | 1.79 | 3.02 | .65 x 1.04 | 1500 | NR301R152M040LV2 | 63.0 | 27.0 | 3.16 | 4.82 | .73 x 1.63 |
| 2700 | NR301R272M016ER2 | 82.0 | 32.0 | 1.66 | 2.65 | .51 x 1.73 | 50 Vdc (75 Vdc Surge) | | | | | | |
| 3300 | NR301R332M016FF2 | 78.0 | 32.0 | 2.42 | 3.78 | .65 x 1.32 | 100 | NR301101U050EN2 | 810.0 | 260.0 | 0.65 | 1.14 | .51 x 1.38 |
| 3900 | NR301R392M016FQ2 | 75.0 | 32.0 | 2.59 | 3.97 | .65 x 1.48 | 120 | NR301R121M050EG2 | 391.0 | 139.0 | 0.79 | 1.33 | .51 x .85 |
| 4700 | NR301R472M016LQ2 | 74.0 | 32.0 | 2.85 | 4.34 | .73 x 1.48 | 150 | NR301151U050FK2 | 550.0 | 220.0 | 0.82 | 1.30 | .65 x 1.04 |
| 5600 | NR301R562M016LV2 | 62.0 | 26.0 | 3.22 | 4.98 | .73 x 1.63 | 180 | NR301R181M050EK2 | 261.0 | 90.0 | 0.95 | 1.61 | .51 x 1.04 |
| 20 Vdc (30 Vdc Surge) | | | | | | | 180 | NR301181U050ER2 | 500.0 | 180.0 | 0.93 | 1.55 | .51 x 1.73 |
| 330 | NR301331U020EM2 | 360.0 | 160.0 | 0.89 | 1.34 | .51 x 1.10 | 220 | NR301R221M050EM2 | 240.0 | 69.0 | 1.12 | 2.08 | .51 x 1.04 |
| 470 | NR301R471M020EG2 | 250.0 | 77.0 | 0.55 | 0.99 | .51 x .85 | 220 | NR301221U050FN2 | 420.0 | 150.0 | 1.09 | 1.83 | .65 x 1.32 |
| 470 | NR301471U020FK2 | 240.0 | 90.0 | 1.22 | 2.00 | .65 x 1.04 | 330 | NR301R331M050EN2 | 221.0 | 63.0 | 1.19 | 2.22 | .51 x 1.38 |
| 560 | NR301561U020ER2 | 220.0 | 80.0 | 1.41 | 2.34 | .51 x 1.73 | 390 | NR301R391M050FK2 | 150.0 | 48.0 | 1.60 | 2.82 | .65 x 1.04 |
| 680 | NR301R681M020EM2 | 140.0 | 67.0 | 1.46 | 2.11 | .51 x 1.10 | 470 | NR301R471M050ER2 | 111.0 | 36.0 | 1.97 | 3.46 | .51 x 1.73 |

Type 300/301 –55 °C to 105 °C Long-Life, Switching Power Grade Radial

High Capacitance and Ultra-Low ESR

| Cap. (µF) | Catalog Part Number | ESR MAX @ 25°C 120 Hz 20 kHz (mΩ) | | Ripple MAX @ 85°C 120 Hz 20 kHz (mΩ) | | Nom Size Insulated D x L (in) | Cap. (µF) | Catalog Part Number | ESR MAX @ 25°C 120 Hz 20 kHz (mΩ) | | Ripple MAX @ 85°C 120 Hz 20 kHz (mΩ) | | Nom Size Insulated D x L (in) |
|--------------------------------|---------------------|--------------------------------------|--------|-----------------------------------------|------|-------------------------------|--------------------------------|---------------------|--------------------------------------|--------|-----------------------------------------|------|-------------------------------|
| 470 | NR301471U050LV2 | 250.0 | 90.0 | 1.44 | 2.40 | .73 x 1.63 | 160 Vdc (200 Vdc Surge) | | | | | | |
| 560 | NR301R561M050FF2 | 118.0 | 41.0 | 1.98 | 3.36 | .65 x 1.32 | 39 | NR301390U160EN2 | 6210.0 | 600.0 | 0.23 | 0.74 | .51 x 1.38 |
| 680 | NR301R681M050FQ2 | 102.0 | 40.0 | 2.31 | 3.69 | .65 x 1.48 | 47 | NR301470U160FK2 | 6000.0 | 620.0 | 0.23 | 0.70 | .65 x 1.04 |
| 820 | NR301R821M050FV2 | 95.0 | 38.0 | 2.40 | 3.79 | .65 x 1.63 | 56 | NR301560U160ER2 | 5110.0 | 500.0 | 0.28 | 0.89 | .51 x 1.73 |
| 820 | NR301R821M050LQ2 | 89.0 | 36.0 | 2.59 | 4.07 | .73 x 1.48 | 68 | NR301680U160FF2 | 3500.0 | 350.0 | 0.36 | 1.15 | .65 x 1.32 |
| 1000 | NR301R102M050LV2 | 77.0 | 28.0 | 2.90 | 4.81 | .73 x 1.63 | 82 | NR301820U160FQ2 | 2950.0 | 320.0 | 0.50 | 1.53 | .65 x 1.48 |
| 63 Vdc (90 Vdc Surge) | | | | | | | 100 | NR301101U160LQ2 | 2540.0 | 210.0 | 0.47 | 1.65 | .73 x 1.48 |
| 120 | NR301R121M063EG2 | 451.0 | 93.0 | 0.73 | 1.60 | .51 x .85 | 120 | NR301121U160LV2 | 2010.0 | 190.0 | 0.55 | 1.79 | .73 x 1.63 |
| 180 | NR301R181M063EK2 | 298.0 | 90.0 | 1.01 | 1.83 | .51 x 1.04 | 200 Vdc (250 Vdc Surge) | | | | | | |
| 270 | NR301R271M063EN2 | 160.0 | 55.0 | 1.44 | 2.46 | .51 x 1.38 | 10 | NR301100U200EG2 | 19900.0 | 1780.0 | 0.12 | 0.39 | .51 x .85 |
| 330 | NR301R331M063FK2 | 171.0 | 50.0 | 1.48 | 2.74 | .65 x 1.04 | 15 | NR301150U200EK2 | 15200.0 | 1270.0 | 0.14 | 0.49 | .51 x 1.04 |
| 390 | NR301R391M063ER2 | 130.0 | 38.0 | 1.83 | 3.38 | .51 x 1.73 | 18 | NR301180U200EM2 | 10600.0 | 960.0 | 0.19 | 0.63 | .51 x 1.10 |
| 470 | NR301R471M063FF2 | 142.0 | 43.0 | 1.80 | 3.27 | .65 x 1.32 | 22 | NR301220U200EN2 | 7010.0 | 580.0 | 0.22 | 0.75 | .51 x 1.38 |
| 560 | NR301R561M063FQ2 | 120.0 | 35.0 | 2.05 | 3.80 | .65 x 1.48 | 27 | NR301270U200FK2 | 6500.0 | 650.0 | 0.22 | 0.68 | .65 x 1.04 |
| 680 | NR301R681M063FV2 | 113.0 | 32.0 | 2.06 | 3.87 | .65 x 1.65 | 33 | NR301330U200ER2 | 5990.0 | 550.0 | 0.26 | 0.87 | .51 x 1.73 |
| 680 | NR301R681M063LQ2 | 103.0 | 29.0 | 2.21 | 4.17 | .73 x 1.48 | 39 | NR301390U200FF2 | 3910.0 | 340.0 | 0.34 | 1.15 | .65 x 1.32 |
| 820 | NR301R821M063LV2 | 90.0 | 29.0 | 2.69 | 4.74 | .73 x 1.63 | 47 | NR301470U200FQ2 | 3730.0 | 330.0 | 0.45 | 1.50 | .65 x 1.48 |
| 100 Vdc (140 Vdc Surge) | | | | | | | 56 | NR301560U200FV2 | 3250.0 | 290.0 | 0.47 | 1.58 | .65 x 1.65 |
| 47 | NR301470U100EG2 | 1770.0 | 345.0 | 0.38 | 0.74 | .51 x .85 | 68 | NR301680U200LQ2 | 2840.0 | 260.0 | 0.53 | 1.74 | .73 x 1.48 |
| 68 | NR301680U100EM2 | 1160.0 | 183.0 | 0.42 | 1.10 | .51 x 1.10 | 82 | NR301820U200LV2 | 2310.0 | 180.0 | 0.53 | 1.89 | .73 x 1.63 |
| 100 | NR301101U100EN2 | 756.0 | 149.0 | 0.52 | 1.37 | .51 x 1.38 | 250 Vdc (300 Vdc Surge) | | | | | | |
| 120 | NR301121U100FK2 | 686.0 | 139.0 | 0.55 | 1.48 | .65 x 1.04 | 8.2 | NR30182U250EG2 | 29900.0 | 3050.0 | 0.07 | 0.23 | .51 x .85 |
| 150 | NR301151U100ER2 | 519.0 | 104.0 | 0.61 | 1.83 | .51 x 1.73 | 12 | NR301120U250EK2 | 23300.0 | 2500.0 | 0.09 | 0.27 | .51 x 1.04 |
| 180 | NR301181U100FF2 | 450.0 | 93.0 | 0.64 | 2.00 | .65 x 1.32 | 15 | NR301150U250EM2 | 15000.0 | 1900.0 | 0.14 | 0.38 | .51 x 1.10 |
| 220 | NR301221U100FQ2 | 365.0 | 76.0 | 0.69 | 2.31 | .65 x 1.48 | 18 | NR301180U250EN2 | 12100.0 | 1500.0 | 0.17 | 0.47 | .51 x 1.38 |
| 270 | NR301271U100FV2 | 298.0 | 63.0 | 0.75 | 2.64 | .65 x 1.65 | 27 | NR301270U250FK2 | 10800.0 | 1610.0 | 0.20 | 0.53 | .65 x 1.04 |
| 330 | NR301331U100LQ2 | 249.0 | 55.0 | 0.81 | 2.94 | .73 x 1.48 | 27 | NR301270U250ER2 | 7820.0 | 1390.0 | 0.28 | 0.67 | .51 x 1.73 |
| 390 | NR301391U100LV2 | 210.0 | 47.0 | 0.87 | 3.35 | .73 x 1.63 | 33 | NR301330U250FF2 | 5500.0 | 720.0 | 0.29 | 0.80 | .65 x 1.32 |
| 160 Vdc (200 Vdc Surge) | | | | | | | 39 | NR301390U250FQ2 | 5260.0 | 700.0 | 0.32 | 0.89 | .65 x 1.48 |
| 15 | NR301150U160EG2 | 17500.0 | 1450.0 | 0.12 | 0.40 | .51 x .85 | 47 | NR301470U250FV2 | 4680.0 | 670.0 | 0.38 | 1.00 | .65 x 1.65 |
| 22 | NR301220U160EK2 | 12800.0 | 960.0 | 0.14 | 0.52 | .51 x 1.04 | 56 | NR301560U250LQ2 | 3750.0 | 550.0 | 0.42 | 1.10 | .73 x 1.48 |
| 27 | NR301270U160EM2 | 9700.0 | 720.0 | 0.18 | 0.66 | .51 x 1.10 | 68 | NR301680U250LV2 | 3110.0 | 360.0 | 0.44 | 1.29 | .73 x 1.63 |

Type 300/301 -55 °C to 105 °C Long-Life, Switching Power Grade Radial High Capacitance and Ultra-Low ESR

Typical Performance Curves

Type 301/301R Impedance vs Frequency
18,000 μ F, 6.3V, 1x3 $\frac{5}{8}$ "

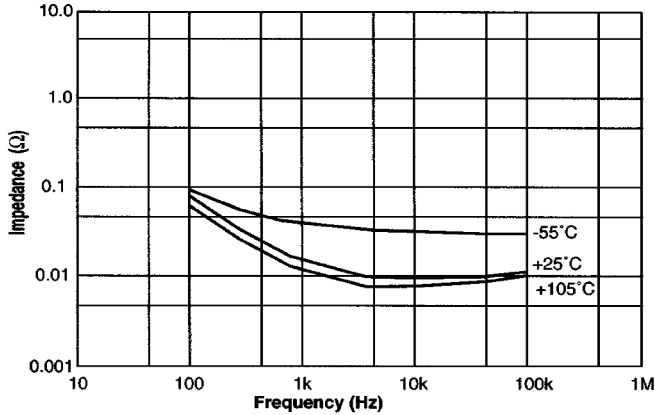

1500 μ F 75V, 1" x 3 $\frac{3}{8}$ "
Impedance-Frequency Characteristics

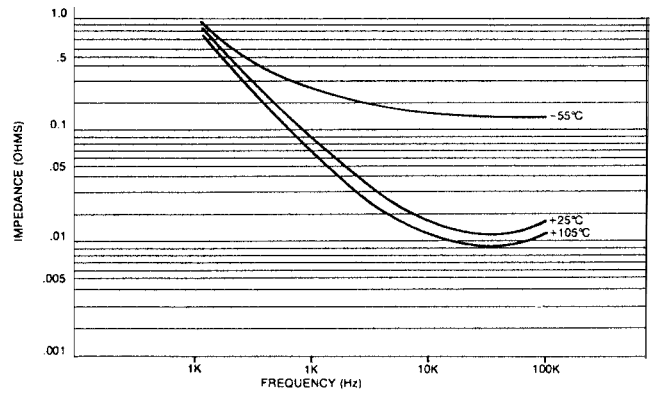

Type 301/301R ESR vs Frequency
ESR vs. Frequency (25°C)

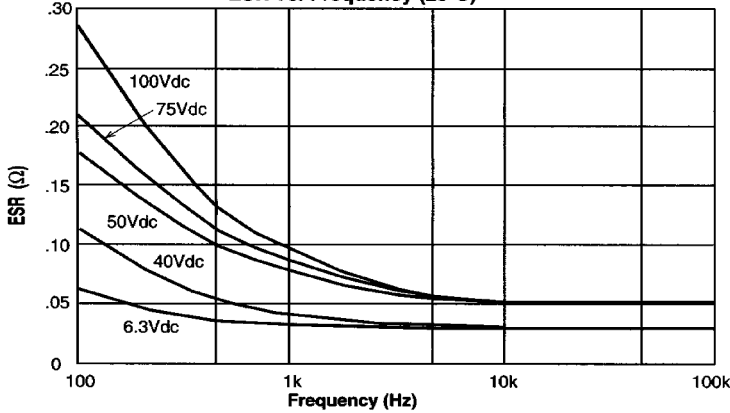

300/301 Operating Life in Kilohours vs Ripple Current

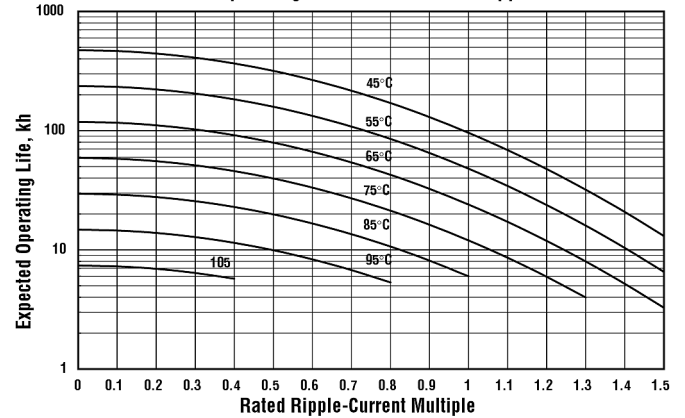

Capacitance vs. Temperature (120Hz)

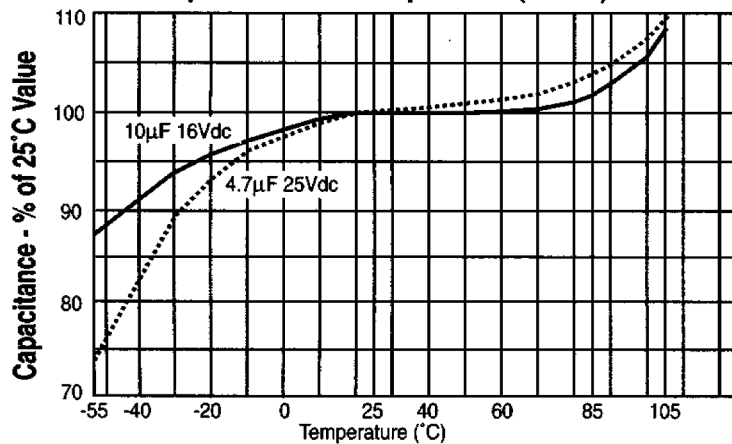

Notice and Disclaimer: All product drawings, descriptions, specifications, statements, information and data (collectively, the "Information") in this datasheet or other publication are subject to change. The customer is responsible for checking, confirming and verifying the extent to which the Information contained in this datasheet or other publication is applicable to an order at the time the order is placed. All Information given herein is believed to be accurate and reliable, but it is presented without any guarantee, warranty, representation or responsibility of any kind, expressed or implied. Statements of suitability for certain applications are based on the knowledge that the Cornell Dubilier company providing such statements ("Cornell Dubilier") has of operating conditions that such Cornell Dubilier company regards as typical for such applications, but are not intended to constitute any guarantee, warranty or representation regarding any such matter – and Cornell Dubilier specifically and expressly disclaims any guarantee, warranty or representation concerning the suitability for a specific customer application, use, storage, transportation, or operating environment. The Information is intended for use only by customers who have the requisite experience and capability to determine the correct products for their application. Any technical advice inferred from this Information or otherwise provided by Cornell Dubilier with reference to the use of any Cornell Dubilier products is given gratis (unless otherwise specified by Cornell Dubilier), and Cornell Dubilier assumes no obligation or liability for the advice given or results obtained. Although Cornell Dubilier strives to apply the most stringent quality and safety standards regarding the design and manufacturing of its products, in light of the current state of the art, isolated component failures may still occur. Accordingly, customer applications which require a high degree of reliability or safety should employ suitable designs or other safeguards (such as installation of protective circuitry or redundancies or other appropriate protective measures) in order to ensure that the failure of an electrical component does not result in a risk of personal injury or property damage. Although all product-related warnings, cautions and notes must be observed, the customer should not assume that all safety measures are indicated in such warnings, cautions and notes, or that other safety measures may not be required.

X-ON Electronics

Largest Supplier of Electrical and Electronic Components

Click to view similar products for [Aluminum Electrolytic Capacitors - Leaded](#) category:

Click to view products by [Cornell Dubilier](#) manufacturer:

Other Similar products are found below :

[LXY50VB4.7M-5X11](#) [MAL203125221E3](#) [MAL204216159E3](#) [ESMG101ETD100MF11S](#) [RBC-25V-10UF-4X7](#) [RE3-35V222MJ6#](#) [RFO-100V471MJ7P#](#) [B41041A2687M8](#) [B41041A7226M8](#) [B41044A7157M6](#) [EKRG250ELL100MD07D](#) [EKXG201EC3101ML20S](#)
[EKXG351ETD6R8MJ16S](#) [EKZM160ETD471MHB5D](#) [EPA-201ELL151MM25S](#) [NCD681K10KVY5PF](#) [NRLF103M25V35X20F](#)
[KM4700/16](#) [KME50VB100M-8X11.5](#) [RXJ222M1EBK-1625](#) [SG220M1CSA-0407](#) [ES5107M016AE1DA](#) [ESX472M16B](#) [MAL211929479E3](#)
[40D506F050DF5A](#) [TE1202E](#) [36DA273F050BB2A](#) [KME25VB100M-6.3X11](#) [511D336M250EK5D](#) [511D337M035CG4D](#)
[515D477M035CG8PE3](#) [052687X](#) [EKMA500ELL4R7ME07D](#) [EKRG100ETC221MF09D](#) [NRE-S560M16V6.3X7TBSTF](#)
[ERZA630VHN182UP54N](#) [MAL214099813E3](#) [MAL211990518E3](#) [MAL204281229E3](#) [NEV680M35EF](#) [686KXM050M](#) [ERS1VM222L30OT](#)
[EGW2GM150W16OT](#) [EGS2GM6R8G12OC](#) [EHS2GM220W20OT](#) [ERF1VM222L30OT](#) [ERF1KM151G20OT](#) [EKZE500ELL101MHB5D](#)
[EKMM251VSN221MP25S](#) [RGA221M1HBK-1016G](#)