

Type 381LX / 383LX 105 °C High Ripple, Snap-In Aluminum

High Ripple, Long Life, 2, 4 and 5 pin styles available



Adding longer-life and more ripple capability to the excellent value of Type 380L/LX capacitors, the 381L/LX readily handles tough switching power supply input and output circuits and motor-drive bus capacitor applications where the high surface area of multiple units in parallel equals the ripple capability of our Type 520C inverter-grade capacitor. Type 381LX delivers more capacitance per can size while Type 381L gives lower ESR for the same capacitance rating. Type 383L/LX has 4 or 5 leads for stable, reverse-proof mounting.

Highlights

- Top performance in power supplies and motor drives
- 4 times the life of Type 380L/LX
- 2, 4 and 5 leads available
- Big selection of 42 case sizes

Specifications

| Temperature Range | -40 °C to + 105 °C ≤ 250 Vdc -25 °C to + 105 °C ≥ 315 Vdc | | | | | | | | | | | | | | | | | | | | | | | | | | | | | | | | | | | | | | | |
|---------------------------------|---|-------|--------|--------|--------|------------|--------|----------------------------|------|------|------|------|------|--------------------------------|------|------|------|------|------|--|-------|-------|--------|--------|-------|------------|-------------------|------|------|------|------|------|------|--------------------|------|------|------|------|------|------|
| Rated Voltage Range | 10 Vdc to 450 Vdc | | | | | | | | | | | | | | | | | | | | | | | | | | | | | | | | | | | | | | | |
| Capacitance Range | 33 µF to 150,000 µF | | | | | | | | | | | | | | | | | | | | | | | | | | | | | | | | | | | | | | | |
| Capacitance Tolerance | ± 20% | | | | | | | | | | | | | | | | | | | | | | | | | | | | | | | | | | | | | | | |
| Leakage Current | ≤ 3 \sqrt{CV} µA, 4 mA max, 5 minutes | | | | | | | | | | | | | | | | | | | | | | | | | | | | | | | | | | | | | | | |
| Ripple Current Multipliers | <p>Ambient Temperature</p> <table border="1"> <thead> <tr> <th></th> <th>45 °C</th> <th>60 °C</th> <th>70 °C</th> <th>85 °C</th> <th>105 °C</th> </tr> </thead> <tbody> <tr> <td>381L 383L</td> <td>2.70</td> <td>2.60</td> <td>2.50</td> <td>2.10</td> <td>1.00</td> </tr> <tr> <td>381LX, 383 LX</td> <td>2.35</td> <td>2.20</td> <td>2.00</td> <td>1.70</td> <td>1.00</td> </tr> </tbody> </table> <p>Frequency</p> <table border="1"> <thead> <tr> <th></th> <th>50 Hz</th> <th>60 Hz</th> <th>120 Hz</th> <th>500 Hz</th> <th>1 kHz</th> <th>5 kHz & up</th> </tr> </thead> <tbody> <tr> <td>10-100 Vdc</td> <td>0.93</td> <td>0.95</td> <td>1.00</td> <td>1.05</td> <td>1.08</td> <td>1.15</td> </tr> <tr> <td>160-450 Vdc</td> <td>0.75</td> <td>0.80</td> <td>1.00</td> <td>1.20</td> <td>1.25</td> <td>1.40</td> </tr> </tbody> </table> | | 45 °C | 60 °C | 70 °C | 85 °C | 105 °C | 381L 383L | 2.70 | 2.60 | 2.50 | 2.10 | 1.00 | 381LX, 383 LX | 2.35 | 2.20 | 2.00 | 1.70 | 1.00 | | 50 Hz | 60 Hz | 120 Hz | 500 Hz | 1 kHz | 5 kHz & up | 10-100 Vdc | 0.93 | 0.95 | 1.00 | 1.05 | 1.08 | 1.15 | 160-450 Vdc | 0.75 | 0.80 | 1.00 | 1.20 | 1.25 | 1.40 |
| | 45 °C | 60 °C | 70 °C | 85 °C | 105 °C | | | | | | | | | | | | | | | | | | | | | | | | | | | | | | | | | | | |
| 381L 383L | 2.70 | 2.60 | 2.50 | 2.10 | 1.00 | | | | | | | | | | | | | | | | | | | | | | | | | | | | | | | | | | | |
| 381LX, 383 LX | 2.35 | 2.20 | 2.00 | 1.70 | 1.00 | | | | | | | | | | | | | | | | | | | | | | | | | | | | | | | | | | | |
| | 50 Hz | 60 Hz | 120 Hz | 500 Hz | 1 kHz | 5 kHz & up | | | | | | | | | | | | | | | | | | | | | | | | | | | | | | | | | | |
| 10-100 Vdc | 0.93 | 0.95 | 1.00 | 1.05 | 1.08 | 1.15 | | | | | | | | | | | | | | | | | | | | | | | | | | | | | | | | | | |
| 160-450 Vdc | 0.75 | 0.80 | 1.00 | 1.20 | 1.25 | 1.40 | | | | | | | | | | | | | | | | | | | | | | | | | | | | | | | | | | |
| Low Temperature Characteristics | Impedance ratio: $Z_{-20^{\circ}\text{C}}/Z_{+25^{\circ}\text{C}}$ ≤ 10 (10 Vdc) ≤ 8 (16–50 Vdc) ≤ 4 (63–100 Vdc) ≤ 3 (150–450 Vdc) | | | | | | | | | | | | | | | | | | | | | | | | | | | | | | | | | | | | | | | |
| Endurance Life Test | 3000 h at full load at 105 °C Δ Capacitance ±20% ESR 200% of limit DCL 100% of limit | | | | | | | | | | | | | | | | | | | | | | | | | | | | | | | | | | | | | | | |
| Shelf Life Test | 1000 h at 105 °C Δ Capacitance ±20% ESR 200% of limit DCL 100% of limit | | | | | | | | | | | | | | | | | | | | | | | | | | | | | | | | | | | | | | | |
| Vibration | 10 to 55 Hz, 0.06" and 10 g max, 2 h each plane | | | | | | | | | | | | | | | | | | | | | | | | | | | | | | | | | | | | | | | |
| RoHS Compliant | | | | | | | | | | | | | | | | | | | | | | | | | | | | | | | | | | | | | | | | |

Type 381LX / 383LX 105 °C High Ripple, Snap-In Aluminum

High Ripple, Long Life, 2,4 and 5 pin styles available

| | | | | | | |
|-------------------------|---------------|------------------|----------------|------------------|--------------------------|---|
| 383LX | 272 | M | 200 | N08 | 2 | V |
| | | | | | | |
| Type | Cap | Tolerance | Voltage | Case Code | Insulation | # of pins |
| 381L / LX (2 pins) | 100 = 10 µF | M = ±20% | 200 = 200 Vdc | | 2 = PVC | Blank = 2 pins / 4 pins snap-in 6.3mm L |
| 383L / LX (4 or 5 pins) | 101 = 100 µF | | | | or PET (PET after 12/19) | A = 2 pins / 4 pins snap-in 4.0mm L |
| | 272 = 2700 µF | | | | | VS = 5 pins snap-in 6.3mm L |
| | | | | | | V = 5 pins standoff |

Outline Drawings

Dimensions shown are in mm

Sleeving is PVC or PET (PET for all date codes after December 2019)

Two Pins

381L/LX (22 through 40 mm diameter)

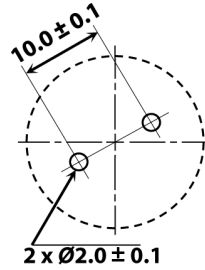
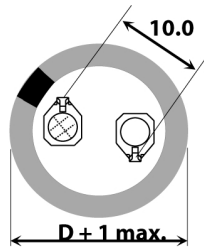
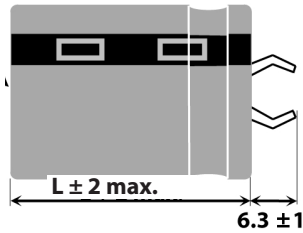

PC Board Mounting Holes

Available in 2, 4 and 5 pins

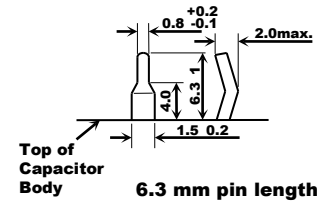

Four Pins

383L/LX (35 and 40 mm diameter)

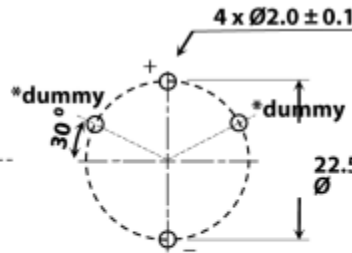
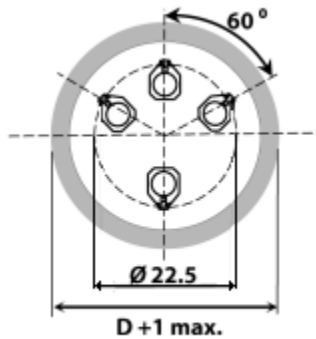
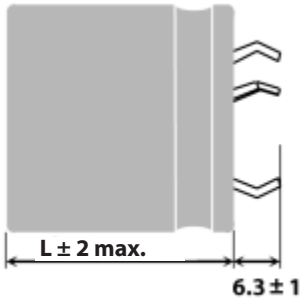

PC Board Mounting Holes

Available in 2 and 4 pins

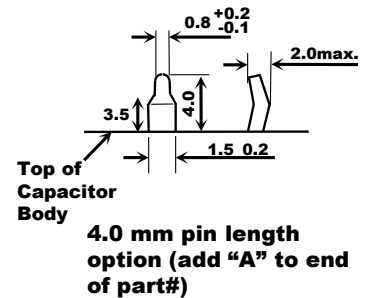

Five Pins

383L/LX (40 and 50 mm diameter)

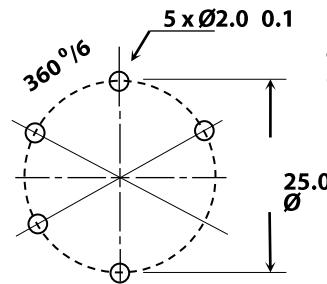
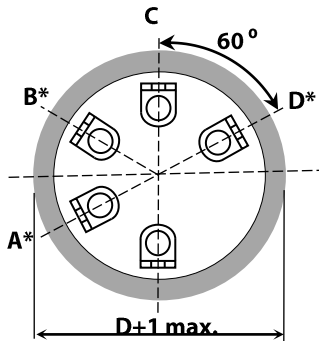
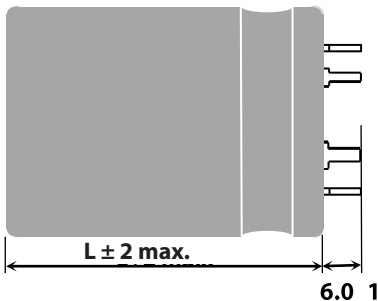

PC Board Mounting Holes

Available in 5 pins

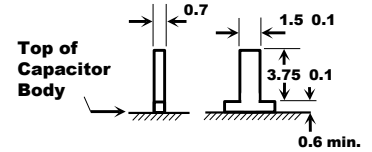

5 pin Standoff pin style (add "V" to end of part#)

| Terminal | Connection | |
|----------|--------------|--------------|
| | 40 mm Dia. | 50 mm Dia. |
| A | dummy | negative (-) |
| B | dummy | dummy |
| C | positive (+) | positive (+) |
| D | dummy | positive (+) |
| - | negative (-) | negative (-) |

Notes:

* Use dummy terminals for mechanical support only. Make no electrical connection because they resistively connect through the electrolyte to the negative terminal.

** Safety Vent may be on the bottom or on the side of the can.

Type 381LX / 383LX 105 °C High Ripple, Snap-In Aluminum

High Ripple, Long Life, 2,4 and 5 pin styles available

Insulated Case Dimensions

| Case Code | DIAMETER "D" | | LENGTH "L" | | Typical Weight (grams) |
|-----------|--------------|--------|------------|--------|------------------------|
| | mm | inches | mm | inches | |
| H20 | 22 | 0.87 | 20 | 0.79 | 14 |
| H01 | 22 | 0.87 | 25 | 0.98 | 16 |
| H02 | 22 | 0.87 | 30 | 1.18 | 19 |
| H03 | 22 | 0.87 | 35 | 1.38 | 22 |
| H04 | 22 | 0.87 | 40 | 1.57 | 24 |
| H45 | 22 | 0.87 | 45 | 1.77 | 28 |
| H05 | 22 | 0.87 | 50 | 1.97 | 31 |
| J20 | 25 | 0.98 | 20 | 0.79 | 16 |
| J01 | 25 | 0.98 | 25 | 0.98 | 20 |
| J02 | 25 | 0.98 | 30 | 1.18 | 24 |
| J03 | 25 | 0.98 | 35 | 1.38 | 27 |
| J04 | 25 | 0.98 | 40 | 1.57 | 31 |
| J45 | 25 | 0.98 | 45 | 1.77 | 35 |
| J05 | 25 | 0.98 | 50 | 1.97 | 38 |
| K20 | 30 | 1.18 | 20 | 0.79 | 25 |
| K01 | 30 | 1.18 | 25 | 0.98 | 30 |
| K02 | 30 | 1.18 | 30 | 1.18 | 35 |
| K03 | 30 | 1.18 | 35 | 1.38 | 40 |
| K04 | 30 | 1.18 | 40 | 1.57 | 44 |
| K45 | 30 | 1.18 | 45 | 1.77 | 48 |
| K05 | 30 | 1.18 | 50 | 1.97 | 53 |
| A20 | 35 | 1.38 | 20 | 0.79 | 35 |
| A01 | 35 | 1.38 | 25 | 0.98 | 42 |
| A02 | 35 | 1.38 | 30 | 1.18 | 48 |
| A03 | 35 | 1.38 | 35 | 1.38 | 54 |

| Case Code | DIAMETER "D" | | LENGTH "L" | | Typical Weight (grams) |
|-----------|--------------|--------|------------|--------|------------------------|
| | mm | inches | mm | inches | |
| A04 | 35 | 1.38 | 40 | 1.57 | 62 |
| A45 | 35 | 1.38 | 45 | 1.77 | 67 |
| A05 | 35 | 1.38 | 50 | 1.97 | 74 |
| A55 | 35 | 1.38 | 55 | 2.17 | 80 |
| A06 | 35 | 1.38 | 63 | 2.48 | 88 |
| A07 | 35 | 1.38 | 70 | 2.76 | 98 |
| A08 | 35 | 1.38 | 80 | 3.15 | 112 |
| A10 | 35 | 1.38 | 105 | 4.13 | 144 |
| N04 | 40 | 1.57 | 40 | 1.57 | 82 |
| N05 | 40 | 1.57 | 50 | 1.97 | 105 |
| N06 | 40 | 1.57 | 63 | 2.48 | 130 |
| N08 | 40 | 1.57 | 80 | 3.15 | 185 |
| N10 | 40 | 1.57 | 105 | 4.13 | 265 |
| E05 | 45 | 1.77 | 50 | 1.97 | 122 |
| E06 | 45 | 1.77 | 63 | 2.48 | 150 |
| E75 | 45 | 1.77 | 75 | 2.65 | 200 |
| E08 | 45 | 1.77 | 80 | 3.15 | 213 |
| E09 | 45 | 1.77 | 92 | 3.62 | 238 |
| E10 | 45 | 1.77 | 105 | 4.13 | 299 |
| B05 | 50 | 1.97 | 50 | 1.97 | 136 |
| B06 | 50 | 1.97 | 63 | 2.48 | 168 |
| B08 | 50 | 1.97 | 80 | 3.15 | 239 |
| B09 | 50 | 1.97 | 92 | 3.62 | 241 |
| B10 | 50 | 1.97 | 105 | 4.13 | 325 |

Typical Performance Curves

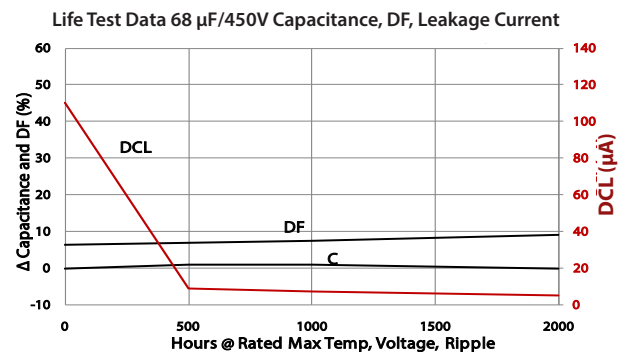
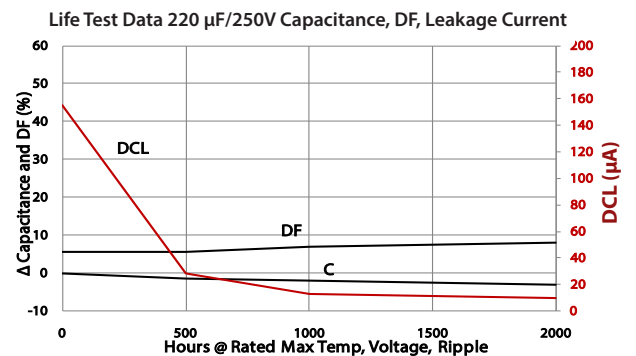
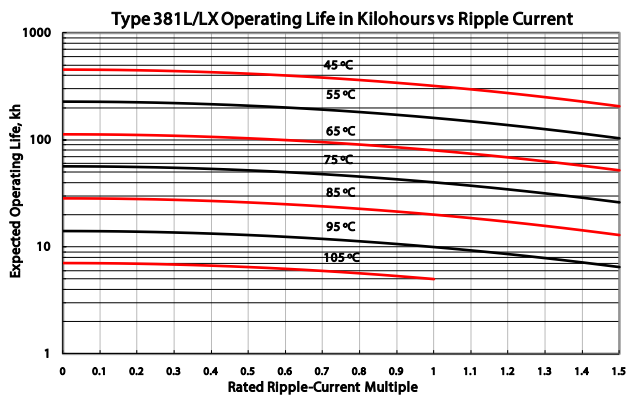

Type 381LX / 383LX 105 °C High Ripple, Snap-In Aluminum

High Ripple, Long Life, 2,4 and 5 pin styles available

Ratings

| Cap. (µF) | Catalog Part Number | Max. ESR @ +25°C | | Ripple Amps @ +105°C | | Nominal Size D x L (mm) | Cap. (µF) | Catalog Part Number | Max. ESR @ +25°C | | Ripple Amps @ +105°C | | Nominal Size D x L (mm) |
|------------------------------|------------------------|---------------------|------------------|-------------------------|---------------|----------------------------------|------------------------------|------------------------|---------------------|------------------|-------------------------|---------------|----------------------------------|
| | | 120 Hz (ohms) | 20 kHz (ohms) | 120 Hz (A) | 20 kHz (A) | | | | 120 Hz (ohms) | 20 kHz (ohms) | 120 Hz (A) | 20 kHz (A) | |
| 10 Vdc (13 Vdc Surge) | | | | | | | 16 Vdc (20 Vdc Surge) | | | | | | |
| 4700 | 381LX472M010H012 | 0.159 | 0.135 | 0.85 | 0.98 | 22 x 25 | 47000 | 383LX473M016N042 | 0.020 | 0.018 | 5.50 | 6.33 | 40 x 40 |
| 6800 | 381LX682M010H012 | 0.111 | 0.093 | 1.30 | 1.50 | 22 x 25 | 56000 | 381LX563M016A452 | 0.020 | 0.018 | 6.00 | 6.90 | 35 x 45 |
| 10000 | 381LX103M010H012 | 0.075 | 0.063 | 1.80 | 2.10 | 22 x 25 | 68000 | 381LX683M016A452 | 0.020 | 0.018 | 6.50 | 7.50 | 35 x 45 |
| 12000 | 381LX123M010H012 | 0.076 | 0.065 | 2.20 | 2.63 | 22 x 25 | 68000 | 383LX683M016N052 | 0.015 | 0.014 | 7.30 | 8.40 | 40 x 50 |
| 15000 | 381LX153M010H012 | 0.076 | 0.065 | 2.20 | 2.53 | 22 x 25 | 82000 | 383LX823M016N062 | 0.017 | 0.013 | 7.70 | 8.80 | 40 x 63 |
| 18000 | 381LX183M010H022 | 0.051 | 0.043 | 2.40 | 2.76 | 22 x 30 | 100000 | 381LX104M016A082 | 0.015 | 0.013 | 8.00 | 9.20 | 35 x 80 |
| 22000 | 381LX223M010H032 | 0.041 | 0.035 | 2.60 | 2.99 | 22 x 35 | 120000 | 381LX124M016A082 | 0.015 | 0.013 | 8.50 | 9.50 | 35 x 80 |
| 27000 | 381LX273M010J032 | 0.034 | 0.029 | 3.10 | 3.57 | 25 x 35 | 120000 | 383LX124M016N082 | 0.014 | 0.012 | 8.80 | 10.10 | 40 x 80 |
| 33000 | 381LX333M010J042 | 0.028 | 0.023 | 3.40 | 3.91 | 25 x 40 | 120000 | 383LX124M016B052V | 0.015 | 0.014 | 9.02 | 10.37 | 50 x 50 |
| 39000 | 381LX393M010K032 | 0.026 | 0.023 | 3.70 | 4.26 | 30 x 35 | 150000 | 383LX154M016N102 | 0.013 | 0.012 | 9.88 | 11.36 | 40 x 105 |
| 39000 | 381LX393M010A022 | 0.025 | 0.020 | 3.70 | 4.30 | 35 x 30 | 150000 | 383LX154M016B062V | 0.014 | 0.013 | 10.15 | 11.67 | 50 x 63 |
| 47000 | 381LX473M010K032 | 0.024 | 0.022 | 4.20 | 4.83 | 30 x 35 | 180000 | 383LX184M016B082V | 0.013 | 0.012 | 11.02 | 12.67 | 50 x 80 |
| 56000 | 381LX563M010K042 | 0.023 | 0.021 | 5.00 | 5.75 | 30 x 40 | 220000 | 383LX224M016B092V | 0.012 | 0.011 | 11.71 | 13.47 | 50 x 92 |
| 68000 | 381LX683M010K452 | 0.022 | 0.019 | 5.40 | 6.21 | 30 x 45 | 250000 | 383LX254M016B102V | 0.011 | 0.010 | 12.31 | 14.16 | 50 x 105 |
| 68000 | 383LX683M010N042 | 0.023 | 0.022 | 5.40 | 6.20 | 40 x 40 | 25 Vdc (32 Vdc Surge) | | | | | | |
| 82000 | 383LX823M010N052 | 0.018 | 0.017 | 7.40 | 8.50 | 40 x 50 | 2200 | 381LX222M025H202 | 0.240 | 0.180 | 1.30 | 1.50 | 22 x 20 |
| 120000 | 383L124M010N062 | 0.012 | 0.008 | 7.10 | 8.60 | 40 x 63 | 3300 | 381LX332M025H012 | 0.160 | 0.120 | 1.60 | 1.80 | 22 x 25 |
| 150000 | 383L154M010N082 | 0.009 | 0.006 | 8.90 | 10.60 | 40 x 80 | 4700 | 381LX472M025H012 | 0.105 | 0.080 | 2.00 | 2.30 | 22 x 25 |
| 16 Vdc (20 Vdc Surge) | | | | | | | 5600 | 381LX562M025H012 | 0.090 | 0.070 | 2.20 | 2.50 | 22 x 25 |
| 3300 | 381LX332M016H012 | 0.213 | 0.170 | 1.30 | 1.50 | 22 x 25 | 6800 | 381LX682M025H022 | 0.085 | 0.064 | 2.40 | 2.76 | 22 x 30 |
| 4700 | 381LX472M016H012 | 0.150 | 0.120 | 1.60 | 1.80 | 22 x 25 | 6800 | 381LX682M025J012 | 0.070 | 0.055 | 2.40 | 2.80 | 25 x 25 |
| 6800 | 381LX682M016H012 | 0.090 | 0.067 | 2.20 | 2.50 | 22 x 25 | 8200 | 381LX822M025H022 | 0.071 | 0.053 | 2.70 | 3.11 | 22 x 30 |
| 6800 | 381LX682M016J202 | 0.110 | 0.092 | 1.80 | 2.10 | 25 x 20 | 10000 | 381LX103M025J022 | 0.058 | 0.044 | 3.00 | 3.45 | 25 x 30 |
| 8200 | 381LX822M016H012 | 0.110 | 0.092 | 1.80 | 2.10 | 22 x 25 | 12000 | 381LX123M025J022 | 0.048 | 0.036 | 3.20 | 3.68 | 25 x 30 |
| 10000 | 381LX103M016H012 | 0.075 | 0.063 | 2.60 | 2.99 | 22 x 25 | 12000 | 381LX123M025A012 | 0.044 | 0.033 | 3.20 | 3.70 | 35 x 25 |
| 10000 | 381LX103M016J012 | 0.120 | 0.086 | 2.60 | 3.00 | 25 x 25 | 15000 | 381LX153M025J032 | 0.039 | 0.029 | 3.60 | 4.14 | 25 x 35 |
| 12000 | 381LX123M016H022 | 0.062 | 0.053 | 2.90 | 3.34 | 22 x 30 | 15000 | 381LX153M025J452 | 0.036 | 0.031 | 3.60 | 4.10 | 25 x 45 |
| 15000 | 381LX153M016J022 | 0.046 | 0.307 | 3.20 | 3.70 | 25 x 30 | 15000 | 381LX153M025A022 | 0.036 | 0.031 | 3.60 | 4.10 | 35 x 30 |
| 15000 | 381LX153M016J032 | 0.080 | 0.064 | 3.20 | 3.70 | 25 x 35 | 18000 | 381LX183M025J042 | 0.032 | 0.024 | 3.90 | 4.49 | 25 x 40 |
| 15000 | 381LX153M016K022 | 0.080 | 0.064 | 3.20 | 3.70 | 30 x 30 | 18000 | 381LX183M025J052 | 0.030 | 0.027 | 3.90 | 4.50 | 25 x 50 |
| 18000 | 381LX183M016H032 | 0.041 | 0.035 | 3.50 | 4.03 | 22 x 35 | 22000 | 381LX223M025J452 | 0.026 | 0.020 | 4.30 | 4.95 | 25 x 45 |
| 22000 | 381LX223M016H042 | 0.034 | 0.029 | 3.80 | 4.37 | 22 x 40 | 22000 | 381LX223M025K452 | 0.025 | 0.022 | 4.30 | 4.90 | 30 x 45 |
| 22000 | 381LX223M016J452 | 0.033 | 0.028 | 3.80 | 4.40 | 25 x 45 | 22000 | 381LX223M025A032 | 0.030 | 0.026 | 4.30 | 4.90 | 35 x 35 |
| 27000 | 381LX273M016H052 | 0.028 | 0.023 | 4.20 | 4.83 | 22 x 50 | 27000 | 381LX273M025K042 | 0.021 | 0.019 | 4.80 | 5.50 | 30 x 40 |
| 27000 | 381LX273M016J052 | 0.030 | 0.025 | 4.20 | 4.80 | 25 x 50 | 27000 | 383L273M025N042 | 0.020 | 0.013 | 4.60 | 5.60 | 40 x 40 |
| 27000 | 381LX273M016K022 | 0.028 | 0.023 | 4.20 | 4.83 | 30 x 30 | 33000 | 381LX333M025K452 | 0.018 | 0.014 | 5.50 | 6.33 | 30 x 45 |
| 33000 | 381LX333M016K032 | 0.023 | 0.020 | 4.70 | 5.41 | 30 x 35 | 33000 | 383LX333M025N042 | 0.018 | 0.016 | 5.50 | 6.33 | 40 x 40 |
| 33000 | 381LX333M016K452 | 0.023 | 0.020 | 4.70 | 5.40 | 30 x 45 | 39000 | 383L393M025N052 | 0.015 | 0.010 | 5.80 | 7.00 | 40 x 50 |
| 39000 | 381LX393M016K042 | 0.022 | 0.020 | 5.10 | 5.87 | 30 x 40 | 47000 | 381LX473M025A052 | 0.017 | 0.015 | 6.50 | 4.25 | 35 x 50 |
| 47000 | 381LX473M016K452 | 0.021 | 0.019 | 5.50 | 6.33 | 30 x 45 | 47000 | 383LX473M025N052 | 0.015 | 0.014 | 6.50 | 7.40 | 40 x 50 |
| 47000 | 381LX473M016A452 | 0.020 | 0.018 | 5.50 | 6.30 | 35 x 45 | 47000 | 383L473M025N062 | 0.012 | 0.008 | 6.90 | 8.30 | 40 x 63 |
| | | | | | | | 56000 | 383LX563M025N062 | 0.015 | 0.012 | 7.20 | 8.25 | 40 x 63 |

Type 381LX / 383LX 105 °C High Ripple, Snap-In Aluminum

High Ripple, Long Life, 2,4 and 5 pin styles available

| Cap. (µF) | Catalog Part Number | Max. ESR @ +25°C | | Ripple Amps @ +105°C | | Nominal Size | Cap. (µF) | Catalog Part Number | Max. ESR @ +25°C | | Ripple Amps @ +105°C | | Nominal Size |
|------------------------------|------------------------|---------------------|------------------|-------------------------|---------------|-----------------|------------------------------|------------------------|---------------------|------------------|-------------------------|---------------|-----------------|
| | | 120 Hz (ohms) | 20 kHz (ohms) | 120 Hz (A) | 20 kHz (A) | | | | D x L (mm) | 120 Hz (ohms) | 20 kHz (ohms) | 120 Hz (A) | |
| 25 Vdc (32 Vdc Surge) | | | | | | | 35 Vdc (44 Vdc Surge) | | | | | | |
| 68000 | 383L683M025N082 | 0.009 | 0.007 | 8.70 | 10.20 | 40 x 80 | 68000 | 383LX683M035B082V | 0.017 | 0.013 | 10.07 | 11.58 | 50 x 80 |
| 82000 | 383LX823M025N082 | 0.014 | 0.011 | 8.70 | 10.00 | 40 x 80 | 82000 | 383LX823M035B092V | 0.015 | 0.011 | 10.89 | 12.52 | 50 x 92 |
| 82000 | 383LX823M025B052V | 0.016 | 0.015 | 9.20 | 10.58 | 50 x 50 | 100000 | 383LX104M035B102V | 0.013 | 0.010 | 11.75 | 13.51 | 50 x 105 |
| 100000 | 383LX104M025N102 | 0.012 | 0.010 | 9.76 | 11.22 | 40 x 105 | 50 Vdc (63 Vdc Surge) | | | | | | |
| 100000 | 383LX104M025B062V | 0.015 | 0.013 | 10.02 | 11.52 | 50 x 63 | 1000 | 381LX102M050H202 | 0.260 | 0.200 | 0.90 | 1.00 | 22 x 20 |
| 120000 | 383LX124M025B082V | 0.013 | 0.012 | 10.93 | 12.57 | 50 x 80 | 1500 | 381LX152M050H012 | 0.155 | 0.120 | 1.25 | 1.45 | 22 x 25 |
| 150000 | 383LX154M025B092V | 0.012 | 0.011 | 11.70 | 13.46 | 50 x 92 | 1800 | 381LX182M050H012 | 0.129 | 0.097 | 1.50 | 1.70 | 22 x 25 |
| 180000 | 383LX184M025B102V | 0.010 | 0.009 | 12.42 | 14.28 | 50 x 105 | 2200 | 381LX222M050H012 | 0.129 | 0.097 | 1.50 | 1.70 | 22 x 25 |
| 35 Vdc (44 Vdc Surge) | | | | | | | 2700 | 381LX272M050H012 | 0.154 | 0.115 | 1.80 | 2.07 | 22 x 25 |
| 1500 | 381LX152M035H012 | 0.287 | 0.216 | 1.10 | 1.30 | 22 x 25 | 2700 | 381LX272M050J012* | 0.086 | 0.064 | 1.80 | 2.10 | 25 x 25 |
| 2200 | 381LX222M035H012 | 0.200 | 0.150 | 1.40 | 1.60 | 22 x 25 | 3300 | 381LX332M050H012 | 0.126 | 0.094 | 2.00 | 2.30 | 22 x 25 |
| 3300 | 381LX332M035H012 | 0.121 | 0.091 | 1.90 | 2.20 | 22 x 25 | 3300 | 381LX332M050J022 | 0.070 | 0.053 | 2.00 | 2.30 | 25 x 30 |
| 3300 | 381LX332M035K202 | 0.130 | 0.100 | 1.70 | 2.00 | 30 x 20 | 3900 | 381LX392M050J012 | 0.106 | 0.080 | 2.20 | 2.53 | 25 x 25 |
| 3900 | 381LX392M035H012 | 0.110 | 0.080 | 2.00 | 2.30 | 22 x 25 | 3900 | 381LX392M050K012 | 0.065 | 0.050 | 2.20 | 2.50 | 30 x 25 |
| 4700 | 381LX472M035H022 | 0.090 | 0.070 | 2.20 | 2.50 | 22 x 30 | 4700 | 381LX472M050J022 | 0.053 | 0.040 | 2.50 | 2.90 | 25 x 30 |
| 4700 | 381LX472M035J012 | 0.090 | 0.070 | 2.20 | 2.50 | 25 x 25 | 4700 | 381LX472M050A012 | 0.053 | 0.040 | 2.50 | 2.90 | 35 x 25 |
| 5600 | 381LX562M035H032 | 0.071 | 0.054 | 2.40 | 2.80 | 22 x 35 | 5600 | 381LX562M050J032 | 0.074 | 0.056 | 2.80 | 3.22 | 25 x 35 |
| 5600 | 381LX562M035J012 | 0.041 | 0.054 | 2.40 | 2.80 | 25 x 25 | 5600 | 381LX562M050A022 | 0.050 | 0.038 | 2.80 | 3.20 | 35 x 30 |
| 6800 | 381LX682M035J022 | 0.073 | 0.055 | 2.60 | 2.99 | 25 x 30 | 6800 | 381LX682M050H452 | 0.061 | 0.046 | 3.30 | 3.80 | 22 x 45 |
| 6800 | 381LX682M035K022 | 0.059 | 0.045 | 2.60 | 3.00 | 30 x 30 | 6800 | 381LX682M050A022 | 0.046 | 0.035 | 3.30 | 3.80 | 35 x 30 |
| 8200 | 381LX822M035J022 | 0.049 | 0.037 | 2.90 | 3.30 | 25 x 30 | 8200 | 381LX822M050K452 | 0.051 | 0.038 | 3.60 | 4.10 | 30 x 45 |
| 8200 | 381LX822M035A012 | 0.049 | 0.037 | 2.90 | 3.30 | 35 x 25 | 8200 | 381LX822M050A032 | 0.040 | 0.030 | 3.60 | 4.10 | 35 x 35 |
| 10000 | 381LX103M035J032 | 0.050 | 0.037 | 3.20 | 3.68 | 25 x 35 | 10000 | 381LX103M050J052 | 0.041 | 0.031 | 4.00 | 4.60 | 25 x 50 |
| 10000 | 381LX103M035J452 | 0.040 | 0.030 | 3.20 | 3.70 | 25 x 45 | 10000 | 381LX103M050K052 | 0.033 | 0.025 | 4.00 | 4.60 | 30 x 50 |
| 10000 | 381LX103M035A022 | 0.040 | 0.030 | 3.20 | 3.70 | 35 x 30 | 10000 | 381LX103M050A042 | 0.033 | 0.025 | 4.00 | 4.60 | 35 x 40 |
| 12000 | 381LX123M035J042 | 0.041 | 0.031 | 3.50 | 4.03 | 25 x 40 | 12000 | 381LX123M050A452 | 0.028 | 0.021 | 4.50 | 5.20 | 35 x 45 |
| 12000 | 381LX123M035J052 | 0.033 | 0.025 | 3.50 | 4.00 | 25 x 50 | 12000 | 383L123M050N042 | 0.029 | 0.018 | 3.80 | 4.80 | 40 x 40 |
| 12000 | 381LX123M035A022 | 0.033 | 0.025 | 3.50 | 4.00 | 35 x 30 | 15000 | 381LX153M050K452 | 0.028 | 0.022 | 4.80 | 5.52 | 30 x 45 |
| 15000 | 381LX153M035K042 | 0.033 | 0.025 | 3.90 | 4.49 | 30 x 40 | 15000 | 383LX153M050N042 | 0.022 | 0.018 | 4.80 | 5.52 | 40 x 40 |
| 15000 | 381LX153M035K452 | 0.030 | 0.020 | 3.90 | 4.50 | 30 x 45 | 15000 | 383L153M050N052 | 0.021 | 0.013 | 4.90 | 6.10 | 40 x 50 |
| 15000 | 381LX153M035A032 | 0.030 | 0.020 | 3.90 | 4.50 | 35 x 35 | 18000 | 381LX183M050A452 | 0.023 | 0.018 | 5.60 | 6.44 | 35 x 45 |
| 18000 | 381LX183M035K452 | 0.028 | 0.021 | 4.30 | 4.95 | 30 x 45 | 18000 | 383L183M050N062 | 0.017 | 0.011 | 5.80 | 7.20 | 40 x 63 |
| 22000 | 381LX223M035A052 | 0.023 | 0.017 | 5.00 | 5.80 | 35 x 50 | 22000 | 383LX223M050N052 | 0.016 | 0.013 | 5.10 | 5.90 | 40 x 50 |
| 22000 | 383LX223M035N042 | 0.023 | 0.017 | 5.00 | 5.75 | 40 x 40 | 27000 | 383LX273M050N062 | 0.015 | 0.012 | 6.05 | 6.96 | 40 x 63 |
| 27000 | 381LX273M035A052 | 0.018 | 0.014 | 5.30 | 6.10 | 35 x 50 | 27000 | 383L273M050N082 | 0.013 | 0.009 | 7.40 | 9.00 | 40 x 80 |
| 27000 | 383LX273M035N052 | 0.020 | 0.015 | 5.45 | 6.25 | 40 x 50 | 33000 | 383LX333M050B052V | 0.018 | 0.014 | 7.75 | 8.91 | 50 x 50 |
| 33000 | 383L333M035N062 | 0.019 | 0.014 | 6.60 | 7.60 | 40 x 63 | 39000 | 383LX393M050N082 | 0.013 | 0.010 | 6.20 | 7.10 | 40 x 80 |
| 39000 | 381LX393M035A052 | 0.017 | 0.014 | 6.50 | 7.50 | 35 x 50 | 39000 | 383LX393M050B062V | 0.016 | 0.013 | 8.40 | 9.66 | 50 x 63 |
| 47000 | 383L473M035N082 | 0.018 | 0.013 | 7.80 | 9.00 | 40 x 80 | 47000 | 383LX473M050N102 | 0.012 | 0.010 | 8.18 | 9.41 | 40 x 105 |
| 47000 | 383LX473M035B052V | 0.021 | 0.016 | 8.25 | 9.49 | 50 x 50 | 47000 | 383LX473M050B082V | 0.014 | 0.011 | 9.19 | 10.57 | 50 x 80 |
| 56000 | 383LX563M035B062V | 0.019 | 0.014 | 9.07 | 10.43 | 50 x 63 | 56000 | 383LX563M050B092V | 0.012 | 0.009 | 9.79 | 11.26 | 50 x 92 |
| 68000 | 383LX683M035N102 | 0.016 | 0.012 | 9.27 | 10.66 | 40 x 105 | 68000 | 383LX683M050B102V | 0.011 | 0.009 | 10.40 | 12.00 | 50 x 105 |

*Denotes Discontinued Part

Type 381LX / 383LX 105 °C High Ripple, Snap-In Aluminum

High Ripple, Long Life, 2,4 and 5 pin styles available

| Cap. (µF) | Catalog Part Number | Max. ESR | | Ripple Amps | | Nominal | Cap. (µF) | Catalog Part Number | Max. ESR | | Ripple Amps | | Nominal |
|------------------------------|------------------------|------------------|------------------|---------------|---------------|---------------|--------------------------------|------------------------|------------------|------------------|---------------|---------------|---------------|
| | | @ +25°C | | @ +105°C | | Size | | | @ +25°C | | @ +105°C | | Size |
| | | 120 Hz (ohms) | 20 kHz (ohms) | 120 Hz (A) | 20 kHz (A) | D x L (mm) | | | 120 Hz (ohms) | 20 kHz (ohms) | 120 Hz (A) | 20 kHz (A) | D x L (mm) |
| 63 Vdc (79 Vdc Surge) | | | | | | | 80 Vdc (100 Vdc Surge) | | | | | | |
| 680 | 381LX681M063H012 | 0.410 | 0.310 | 0.90 | 1.00 | 22 x 25 | 470 | 381LX471M080H012 | 0.390 | 0.270 | 0.80 | 0.90 | 22 x 25 |
| 1000 | 381LX102M063H012 | 0.280 | 0.210 | 1.18 | 1.35 | 22 x 25 | 680 | 381LX681M080H012 | 0.270 | 0.190 | 1.00 | 1.15 | 22 x 25 |
| 1200 | 381LX122M063H012 | 0.235 | 0.180 | 1.40 | 1.60 | 22 x 25 | 820 | 381LX821M080H012 | 0.222 | 0.145 | 1.20 | 1.40 | 22 x 25 |
| 1500 | 381LX152M063H012 | 0.235 | 0.180 | 1.50 | 1.70 | 22 x 25 | 1000 | 381LX102M080H012 | 0.222 | 0.145 | 1.20 | 1.40 | 22 x 25 |
| 1800 | 381LX182M063H022 | 0.157 | 0.117 | 1.70 | 1.96 | 22 x 30 | 1000 | 381LX102M080J012* | 0.182 | 0.120 | 1.30 | 1.50 | 25 x 25 |
| 1800 | 381LX182M063J012 | 0.123 | 0.092 | 2.20 | 2.53 | 25 x 25 | 1200 | 381LX122M080H022 | 0.235 | 0.176 | 1.50 | 1.73 | 22 x 30 |
| 2200 | 381LX222M063H022 | 0.143 | 0.110 | 1.50 | 1.70 | 22 x 30 | 1500 | 381LX152M080H032 | 0.188 | 0.141 | 1.70 | 1.96 | 22 x 35 |
| 2700 | 381LX272M063H042 | 0.123 | 0.092 | 2.20 | 2.53 | 22 x 40 | 1800 | 381LX182M080J032* | 0.147 | 0.080 | 1.80 | 2.10 | 25 x 35 |
| 2700 | 381LX272M063K012 | 0.105 | 0.080 | 2.20 | 2.50 | 30 x 25 | 1800 | 381LX182M080K012 | 0.111 | 0.080 | 1.80 | 2.10 | 30 x 25 |
| 3300 | 381LX332M063J022 | 0.090 | 0.070 | 2.50 | 2.90 | 25 x 30 | 2200 | 381LX222M080H452 | 0.121 | 0.092 | 2.10 | 2.40 | 22 x 45 |
| 3300 | 381LX332M063A012 | 0.090 | 0.070 | 2.50 | 2.90 | 35 x 25 | 2200 | 381LX222M080A012 | 0.090 | 0.063 | 2.10 | 2.40 | 35 x 25 |
| 3900 | 381LX392M063J022 | 0.085 | 0.064 | 2.70 | 3.11 | 25 x 30 | 2700 | 381LX272M080J042 | 0.104 | 0.078 | 2.40 | 2.76 | 25 x 40 |
| 3900 | 381LX392M063J452 | 0.080 | 0.060 | 2.70 | 3.10 | 25 x 45 | 3300 | 381LX332M080J052 | 0.065 | 0.049 | 2.60 | 3.00 | 25 x 50 |
| 4700 | 381LX472M063K042 | 0.063 | 0.048 | 3.00 | 3.50 | 30 x 40 | 3300 | 381LX332M080K042 | 0.100 | 0.075 | 2.60 | 3.00 | 30 x 40 |
| 5600 | 381LX562M063K042 | 0.059 | 0.044 | 3.30 | 3.80 | 30 x 40 | 3300 | 381LX332M080A022 | 0.065 | 0.049 | 2.60 | 3.00 | 35 x 30 |
| 5600 | 381LX562M063K452 | 0.055 | 0.040 | 3.30 | 3.80 | 30 x 45 | 3900 | 381LX392M080K042 | 0.072 | 0.054 | 3.00 | 3.45 | 30 x 40 |
| 5600 | 381LX562M063A032 | 0.055 | 0.040 | 3.30 | 3.80 | 35 x 35 | 4700 | 381LX472M080K042 | 0.060 | 0.045 | 3.30 | 3.80 | 30 x 40 |
| 6800 | 381LX682M063J052 | 0.050 | 0.040 | 3.60 | 4.10 | 25 x 50 | 4700 | 381LX472M080K052 | 0.048 | 0.036 | 3.30 | 3.80 | 30 x 50 |
| 6800 | 381LX682M063K042 | 0.049 | 0.037 | 3.60 | 4.14 | 30 x 40 | 4700 | 381LX472M080A042 | 0.048 | 0.036 | 3.30 | 3.80 | 35 x 40 |
| 6800 | 381LX682M063K052 | 0.050 | 0.040 | 3.60 | 4.10 | 30 x 50 | 5600 | 381LX562M080A052 | 0.072 | 0.054 | 3.00 | 3.45 | 35 x 50 |
| 8200 | 381LX822M063J052 | 0.040 | 0.030 | 3.90 | 4.50 | 25 x 50 | 5600 | 383L562M080N042 | 0.035 | 0.022 | 3.50 | 4.40 | 40 x 40 |
| 8200 | 381LX822M063A452 | 0.040 | 0.030 | 3.90 | 4.50 | 35 x 45 | 6800 | 381LX682M080A052 | 0.041 | 0.031 | 3.90 | 4.50 | 35 x 50 |
| 8200 | 383L822M063N042 | 0.031 | 0.018 | 3.70 | 4.80 | 40 x 40 | 6800 | 383LX682M080N042 | 0.041 | 0.031 | 3.90 | 4.49 | 40 x 40 |
| 10000 | 381LX103M063K452 | 0.033 | 0.028 | 4.40 | 5.10 | 30 x 45 | 8200 | 383L822M080N052 | 0.025 | 0.016 | 4.40 | 5.60 | 40 x 50 |
| 10000 | 381LX103M063K052 | 0.033 | 0.028 | 4.40 | 5.10 | 30 x 50 | 10000 | 383L103M080N062 | 0.021 | 0.013 | 5.30 | 6.70 | 40 x 63 |
| 12000 | 381LX123M063K052 | 0.030 | 0.025 | 4.40 | 5.06 | 30 x 50 | 12000 | 383LX123M080B052V | 0.035 | 0.026 | 6.03 | 6.93 | 50 x 50 |
| 12000 | 383LX123M063N042 | 0.030 | 0.028 | 4.52 | 5.20 | 40 x 40 | 15000 | 383L153M080N082 | 0.015 | 0.010 | 6.80 | 8.40 | 40 x 80 |
| 12000 | 383L123M063N052 | 0.022 | 0.013 | 4.70 | 6.10 | 40 x 50 | 15000 | 383LX153M080B062V | 0.028 | 0.021 | 6.65 | 7.65 | 50 x 63 |
| 15000 | 381LX153M063A052 | 0.024 | 0.023 | 4.90 | 5.70 | 35 x 50 | 18000 | 383LX183M080B082V | 0.026 | 0.019 | 7.29 | 8.38 | 50 x 80 |
| 15000 | 383LX153M063N052 | 0.027 | 0.023 | 4.80 | 5.50 | 40 x 50 | 22000 | 383LX223M080N102 | 0.019 | 0.014 | 6.95 | 7.99 | 40 x 105 |
| 15000 | 383L153M063N062 | 0.018 | 0.011 | 5.70 | 7.20 | 40 x 63 | 22000 | 383LX223M080B092V | 0.022 | 0.016 | 7.83 | 9.00 | 50 x 92 |
| 18000 | 381LX183M063A082 | 0.022 | 0.019 | 5.80 | 6.70 | 35 x 80 | 27000 | 383LX273M080B102V | 0.018 | 0.014 | 8.38 | 9.64 | 50 x 105 |
| 18000 | 383LX183M063N062 | 0.023 | 0.020 | 5.40 | 6.20 | 40 x 63 | 100 Vdc (125 Vdc Surge) | | | | | | |
| 22000 | 383L223M063N082 | 0.013 | 0.009 | 7.20 | 9.00 | 40 x 80 | 330 | 381LX331M100H012 | 0.653 | 0.392 | 0.80 | 1.20 | 22 x 25 |
| 22000 | 383LX223M063B052V | 0.019 | 0.016 | 6.76 | 7.77 | 50 x 50 | 470 | 381LX471M100H012 | 0.390 | 0.230 | 0.92 | 1.40 | 22 x 25 |
| 27000 | 383LX273M063N082 | 0.017 | 0.014 | 6.60 | 7.60 | 40 x 80 | 560 | 381LX561M100H012 | 0.300 | 0.180 | 1.10 | 1.30 | 22 x 25 |
| 27000 | 383LX273M063B062V | 0.017 | 0.014 | 7.34 | 8.44 | 50 x 63 | 680 | 381LX681M100H012 | 0.300 | 0.180 | 1.10 | 1.30 | 22 x 25 |
| 33000 | 383LX333M063B082V | 0.015 | 0.013 | 8.00 | 9.20 | 50 x 80 | 820 | 381LX821M100H012 | 0.303 | 0.197 | 1.40 | 1.60 | 22 x 25 |
| 39000 | 383LX393M063N102 | 0.014 | 0.012 | 7.53 | 8.66 | 40 x 105 | 820 | 381LX821M100J012 | 0.202 | 0.120 | 1.40 | 2.10 | 25 x 25 |
| 39000 | 383LX393M063B092V | 0.014 | 0.012 | 8.48 | 9.75 | 50 x 92 | 1000 | 381LX102M100H022 | 0.182 | 0.110 | 1.70 | 2.55 | 22 x 30 |
| 47000 | 383LX473M063B102V | 0.012 | 0.010 | 8.99 | 10.34 | 50 x 105 | 1200 | 381LX122M100H022 | 0.195 | 0.125 | 1.85 | 2.70 | 22 x 30 |
| | | | | | | | 1200 | 381LX122M100H032* | 0.195 | 0.125 | 1.85 | 2.70 | 22 x 35 |

*Denotes Discontinued Part

Type 381LX / 383LX 105 °C High Ripple, Snap-In Aluminum

High Ripple, Long Life, 2,4 and 5 pin styles available

| Cap. (µF) | Catalog Part Number | Max. ESR | | Ripple Amps | | Nominal |
|--------------------------------|------------------------|------------------|------------------|---------------|---------------|---------------|
| | | @ +25°C | | @ +105°C | | Size |
| | | 120 Hz (ohms) | 20 kHz (ohms) | 120 Hz (A) | 20 kHz (A) | D x L (mm) |
| 100 Vdc (125 Vdc Surge) | | | | | | |
| 1500 | 381LX152M100H042 | 0.155 | 0.100 | 2.30 | 2.80 | 22 x 40 |
| 1500 | 381LX152M100K012 | 0.155 | 0.100 | 2.30 | 2.80 | 30 x 25 |
| 1800 | 381LX182M100J042 | 0.138 | 0.090 | 2.30 | 2.65 | 25 x 40 |
| 2200 | 381LX222M100J042 | 0.121 | 0.080 | 2.60 | 2.99 | 25 x 40 |
| 2200 | 381LX222M100J452 | 0.090 | 0.060 | 2.60 | 3.90 | 25 x 45 |
| 2700 | 381LX272M100A022 | 0.092 | 0.060 | 2.90 | 3.34 | 35 x 30 |
| 3300 | 381LX332M100K052 | 0.075 | 0.053 | 3.20 | 4.80 | 30 x 50 |
| 3300 | 381LX332M100A042 | 0.075 | 0.053 | 3.20 | 4.80 | 35 x 40 |
| 3900 | 381LX392M100K052 | 0.064 | 0.043 | 3.60 | 4.14 | 30 x 50 |
| 4700 | 381LX472M100A052 | 0.053 | 0.040 | 3.80 | 5.70 | 35 x 50 |
| 4700 | 383LX472M100N042 | 0.053 | 0.040 | 3.80 | 5.70 | 40 x 40 |
| 5600 | 381LX562M100A052 | 0.044 | 0.033 | 4.10 | 4.70 | 35 x 50 |
| 5600 | 383L562M100N062 | 0.027 | 0.012 | 4.60 | 6.50 | 40 x 63 |
| 6800 | 383LX682M100N052 | 0.037 | 0.027 | 4.60 | 5.30 | 40 x 50 |
| 8200 | 383LX822M100N062 | 0.030 | 0.023 | 5.00 | 5.77 | 40 x 63 |
| 8200 | 383L822M100N082 | 0.020 | 0.009 | 6.00 | 8.20 | 40 x 80 |
| 8200 | 383LX822M100B052V | 0.030 | 0.023 | 6.14 | 7.06 | 50 x 50 |
| 10000 | 381LX103M100A082 | 0.033 | 0.025 | 6.38 | 7.34 | 35 x 80 |
| 12000 | 383LX123M100N082 | 0.021 | 0.016 | 6.44 | 7.40 | 40 x 80 |
| 12000 | 383LX123M100B062V | 0.022 | 0.017 | 7.17 | 8.25 | 50 x 63 |
| 15000 | 383LX153M100N102 | 0.017 | 0.012 | 7.37 | 8.48 | 40 x 105 |
| 15000 | 383LX153M100B082V | 0.019 | 0.014 | 8.01 | 9.21 | 50 x 80 |
| 18000 | 383LX183M100B092V | 0.017 | 0.012 | 8.64 | 9.94 | 50 x 92 |
| 22000 | 383LX223M100B102V | 0.015 | 0.011 | 9.32 | 10.72 | 50 x 105 |
| 160 Vdc (200 Vdc Surge) | | | | | | |
| 470 | 381LX471M160H022 | 0.423 | 0.190 | 1.40 | 2.00 | 22 x 30 |
| 560 | 381LX561M160H032 | 0.355 | 0.160 | 1.50 | 2.10 | 22 x 35 |
| 680 | 381LX681M160H042 | 0.293 | 0.132 | 1.70 | 2.40 | 22 x 40 |
| 820 | 381LX821M160J042 | 0.243 | 0.109 | 2.00 | 2.80 | 25 x 40 |
| 1000 | 381LX102M160J042 | 0.216 | 0.108 | 2.20 | 3.08 | 25 x 40 |
| 1200 | 381LX122M160K032 | 0.180 | 0.090 | 2.30 | 3.20 | 30 x 35 |
| 1500 | 381LX152M160K452 | 0.155 | 0.077 | 2.50 | 3.50 | 30 x 45 |
| 1800 | 381LX182M160K452 | 0.111 | 0.055 | 2.70 | 3.78 | 30 x 45 |
| 2200 | 381LX222M160K052 | 0.098 | 0.049 | 2.90 | 4.06 | 30 x 50 |
| 2200 | 383LX222M160N042 | 0.100 | 0.060 | 2.90 | 4.10 | 40 x 40 |
| 2700 | 383L272M160N062 | 0.045 | 0.027 | 3.80 | 5.00 | 40 x 63 |
| 3300 | 383LX332M160N052 | 0.070 | 0.040 | 3.40 | 4.70 | 40 x 40 |
| 180 Vdc (225 Vdc Surge) | | | | | | |
| 270 | 381LX271M180H012 | 0.737 | 0.376 | 1.10 | 1.50 | 22 x 25 |
| 330 | 381LX331M180H022 | 0.603 | 0.308 | 1.20 | 1.70 | 22 x 30 |
| 390 | 381LX391M180J012 | 0.510 | 0.260 | 1.30 | 1.80 | 25 x 25 |
| 470 | 381LX471M180H032 | 0.423 | 0.216 | 1.40 | 2.00 | 22 x 35 |

| Cap. (µF) | Catalog Part Number | Max. ESR | | Ripple Amps | | Nominal |
|--------------------------------|------------------------|------------------|------------------|---------------|---------------|---------------|
| | | @ +25°C | | @ +105°C | | Size |
| | | 120 Hz (ohms) | 20 kHz (ohms) | 120 Hz (A) | 20 kHz (A) | D x L (mm) |
| 180 Vdc (225 Vdc Surge) | | | | | | |
| 560 | 381LX561M180H042 | 0.355 | 0.181 | 1.50 | 2.10 | 22 x 40 |
| 680 | 381LX681M180J032 | 0.293 | 0.149 | 1.70 | 2.38 | 25 x 35 |
| 820 | 381LX821M180K022 | 0.243 | 0.124 | 2.00 | 2.80 | 30 x 30 |
| 1000 | 381LX102M180J052 | 0.216 | 0.097 | 2.20 | 3.08 | 25 x 50 |
| 1200 | 381LX122M180K452 | 0.166 | 0.085 | 2.30 | 3.20 | 30 x 45 |
| 1500 | 381LX152M180K052 | 0.133 | 0.068 | 2.50 | 3.50 | 30 x 50 |
| 1800 | 381LX182M180A452 | 0.111 | 0.050 | 2.70 | 3.80 | 35 x 45 |
| 1800 | 383L182M180N052 | 0.059 | 0.033 | 3.10 | 4.20 | 40 x 50 |
| 2200 | 381LX222M180A052 | 0.090 | 0.046 | 2.90 | 4.10 | 35 x 50 |
| 2200 | 383L222M180N062 | 0.048 | 0.027 | 3.70 | 4.90 | 40 x 63 |
| 3300 | 383L332M180N082 | 0.035 | 0.020 | 4.80 | 6.30 | 40 x 80 |
| 200 Vdc (250 Vdc Surge) | | | | | | |
| 100 | 381LX101M200H012 | 1.660 | 0.750 | 0.50 | 0.70 | 22 x 25 |
| 150 | 381LX151M200H012 | 1.100 | 0.500 | 0.70 | 0.95 | 22 x 25 |
| 220 | 381LX221M200H012 | 0.754 | 0.339 | 1.00 | 1.40 | 22 x 25 |
| 270 | 381LX271M200H012 | 0.730 | 0.300 | 1.10 | 1.50 | 22 x 25 |
| 270 | 381LX271M200J012 | 0.614 | 0.276 | 1.10 | 1.50 | 25 x 25 |
| 330 | 381LX331M200H022 | 0.603 | 0.308 | 1.25 | 1.79 | 22 x 30 |
| 330 | 381LX331M200J012 | 0.603 | 0.308 | 1.20 | 1.70 | 25 x 25 |
| 390 | 381LX391M200H022 | 0.510 | 0.230 | 1.30 | 1.80 | 22 x 30 |
| 470 | 381LX471M200J022 | 0.423 | 0.190 | 1.40 | 2.00 | 25 x 30 |
| 470 | 381LX471M200K012 | 0.353 | 0.159 | 1.40 | 2.00 | 30 x 25 |
| 560 | 381LX561M200H042 | 0.355 | 0.160 | 1.50 | 2.10 | 22 x 40 |
| 560 | 381LX561M200J022 | 0.355 | 0.160 | 1.50 | 2.10 | 25 x 30 |
| 680 | 381LX681M200J042 | 0.293 | 0.132 | 1.70 | 2.40 | 25 x 40 |
| 680 | 381LX681M200K022 | 0.244 | 0.110 | 1.70 | 2.40 | 30 x 30 |
| 820 | 381LX821M200H452 | 0.263 | 0.118 | 2.00 | 2.80 | 22 x 45 |
| 820 | 381LX821M200J042 | 0.243 | 0.109 | 2.04 | 2.92 | 25 x 40 |
| 820 | 381LX821M200K022 | 0.263 | 0.118 | 2.00 | 2.80 | 30 x 30 |
| 1000 | 381LX102M200J052 | 0.216 | 0.108 | 2.20 | 3.10 | 25 x 50 |
| 1000 | 381LX102M200K032 | 0.216 | 0.108 | 2.20 | 3.10 | 30 x 35 |
| 1000 | 381LX102M200K452 | 0.216 | 0.108 | 2.20 | 3.10 | 30 x 45 |
| 1000 | 381LX102M200A022 | 0.216 | 0.108 | 2.20 | 3.10 | 35 x 30 |
| 1200 | 381LX122M200K042 | 0.193 | 0.097 | 2.30 | 3.20 | 30 x 40 |
| 1200 | 381LX122M200K052 | 0.193 | 0.097 | 2.30 | 3.20 | 30 x 50 |
| 1200 | 381LX122M200A032 | 0.193 | 0.097 | 2.30 | 3.20 | 35 x 35 |
| 1500 | 381LX152M200K052 | 0.155 | 0.077 | 2.50 | 3.50 | 30 x 50 |
| 1500 | 381LX152M200A042 | 0.155 | 0.077 | 2.50 | 3.50 | 35 x 40 |
| 1800 | 381LX182M200A452 | 0.129 | 0.077 | 2.70 | 3.80 | 35 x 45 |
| 1800 | 383LX182M200N042 | 0.129 | 0.077 | 2.70 | 3.78 | 40 x 40 |
| 1800 | 383L182M200N052 | 0.063 | 0.033 | 3.00 | 4.10 | 40 x 50 |
| 2200 | 381LX222M200A052 | 0.105 | 0.063 | 2.90 | 4.00 | 35 x 50 |

Type 381LX / 383LX 105 °C High Ripple, Snap-In Aluminum

High Ripple, Long Life, 2,4 and 5 pin styles available

| Cap. (µF) | Catalog Part Number | Max. ESR | | Ripple Amps | | Nominal | Cap. (µF) | Catalog Part Number | Max. ESR | | Ripple Amps | | Nominal |
|--------------------------------|------------------------|------------------|------------------|---------------|---------------|---------------|--------------------------------|------------------------|------------------|------------------|---------------|---------------|---------------|
| | | @ +25°C | | @ +105°C | | Size | | | @ +25°C | | @ +105°C | | Size |
| | | 120 Hz (ohms) | 20 kHz (ohms) | 120 Hz (A) | 20 kHz (A) | D x L (mm) | | | 120 Hz (ohms) | 20 kHz (ohms) | 120 Hz (A) | 20 kHz (A) | D x L (mm) |
| 200 Vdc (250 Vdc Surge) | | | | | | | 250 Vdc (300 Vdc Surge) | | | | | | |
| 2200 | 383L222M200N062 | 0.051 | 0.027 | 3.60 | 4.90 | 40 x 63 | 1800 | 383L182M250N062 | 0.066 | 0.025 | 3.10 | 5.10 | 40 x 63 |
| 2700 | 383LX272M200N052 | 0.086 | 0.052 | 3.55 | 4.97 | 40 x 50 | 2200 | 381LX222M250A082 | 0.096 | 0.064 | 3.75 | 5.25 | 35 x 80 |
| 2700 | 383L272M200N082 | 0.032 | 0.018 | 4.60 | 6.20 | 40 x 80 | 2200 | 383LX222M250N062 | 0.098 | 0.064 | 3.70 | 5.15 | 40 x 63 |
| 3300 | 381LX332M200A082 | 0.065 | 0.039 | 4.50 | 6.33 | 35 x 80 | 2200 | 383L222M250N082 | 0.043 | 0.017 | 4.00 | 6.40 | 40 x 80 |
| 3300 | 383LX332M200N062 | 0.700 | 0.040 | 4.40 | 6.20 | 40 x 63 | 2200 | 383LX222M250B052V | 0.098 | 0.064 | 4.35 | 6.09 | 50 x 50 |
| 3300 | 383LX332M200B052V | 0.075 | 0.045 | 5.20 | 7.28 | 50 x 50 | 2700 | 383LX272M250N082 | 0.092 | 0.047 | 3.10 | 4.30 | 40 x 80 |
| 3900 | 383LX392M200B062V | 0.064 | 0.038 | 5.90 | 8.26 | 50 x 63 | 2700 | 383LX272M250B062V | 0.080 | 0.052 | 4.98 | 6.97 | 50 x 63 |
| 4700 | 383LX472M200N082 | 0.050 | 0.030 | 5.75 | 8.10 | 40 x 80 | 3300 | 383LX332M250N082 | 0.065 | 0.042 | 4.86 | 6.80 | 40 x 80 |
| 4700 | 383LX472M200B082V | 0.053 | 0.032 | 6.82 | 9.55 | 50 x 80 | 3900 | 383LX392M250N102 | 0.055 | 0.036 | 5.61 | 7.85 | 40 x 105 |
| 5600 | 383LX562M200N102 | 0.041 | 0.025 | 6.76 | 9.46 | 40 x 105 | 3900 | 383LX392M250B082V | 0.055 | 0.036 | 6.10 | 8.54 | 50 x 80 |
| 5600 | 383LX562M200B092V | 0.044 | 0.027 | 7.68 | 10.75 | 50 x 92 | 4300 | 383LX432M250B092V | 0.050 | 0.033 | 6.67 | 9.34 | 50 x 92 |
| 6800 | 383LX682M200B102V | 0.034 | 0.020 | 8.71 | 12.19 | 50 x 105 | 4700 | 383LX472M250B102V | 0.046 | 0.030 | 7.03 | 9.84 | 50 x 105 |
| 250 Vdc (300 Vdc Surge) | | | | | | | 315 Vdc (365 Vdc Surge) | | | | | | |
| 68 | 381LX680M250H202 | 2.926 | 1.493 | 0.40 | 0.60 | 22 x 20 | 82 | 381LX820M315H012 | 2.430 | 1.240 | 0.60 | 0.90 | 22 x 25 |
| 68 | 381LX680M250H012 | 2.440 | 1.220 | 0.40 | 0.60 | 22 x 25 | 100 | 381LX101M315H012 | 1.990 | 1.020 | 0.70 | 1.00 | 22 x 25 |
| 100 | 381LX101M250H012 | 1.660 | 0.830 | 0.55 | 0.78 | 22 x 25 | 120 | 381LX121M315H012 | 1.660 | 0.850 | 0.80 | 1.10 | 22 x 25 |
| 150 | 381LX151M250H012 | 1.327 | 0.465 | 0.79 | 0.11 | 22 x 25 | 150 | 381LX151M315H022 | 1.330 | 0.600 | 0.82 | 1.15 | 22 x 30 |
| 180 | 381LX181M250H012 | 1.106 | 0.553 | 0.88 | 1.23 | 22 x 25 | 180 | 381LX181M315H022 | 1.110 | 0.550 | 0.90 | 1.25 | 22 x 30 |
| 220 | 381LX221M250H012 | 0.905 | 0.452 | 1.00 | 1.40 | 22 x 25 | 220 | 381LX221M315H032 | 0.900 | 0.410 | 0.98 | 1.37 | 22 x 35 |
| 270 | 381LX271M250H022 | 0.737 | 0.332 | 1.18 | 1.69 | 22 x 30 | 220 | 381LX221M315K022 | 0.904 | 0.461 | 1.00 | 1.40 | 30 x 30 |
| 330 | 381LX331M250H022 | 0.502 | 0.251 | 1.20 | 1.70 | 22 x 30 | 270 | 381LX271M315J032 | 0.740 | 0.330 | 1.10 | 1.54 | 25 x 35 |
| 330 | 381LX331M250J022 | 0.502 | 0.251 | 1.20 | 1.70 | 25 x 30 | 270 | 381LX271M315K022 | 0.737 | 0.376 | 1.10 | 1.50 | 30 x 30 |
| 390 | 381LX391M250J032 | 0.510 | 0.229 | 1.49 | 2.12 | 25 x 35 | 270 | 381LX271M315A022 | 0.737 | 0.376 | 1.10 | 1.50 | 35 x 30 |
| 470 | 381LX471M250J032 | 0.423 | 0.191 | 1.40 | 1.96 | 25 x 35 | 330 | 381LX331M315J042 | 0.600 | 0.270 | 1.20 | 1.68 | 25 x 40 |
| 470 | 381LX471M250K022 | 0.353 | 0.176 | 1.40 | 2.00 | 30 x 30 | 330 | 381LX331M315K032 | 0.603 | 0.308 | 1.20 | 1.70 | 30 x 35 |
| 560 | 381LX561M250J032 | 0.355 | 0.160 | 1.80 | 2.57 | 25 x 35 | 330 | 381LX331M315K042 | 0.603 | 0.308 | 1.20 | 1.70 | 30 x 40 |
| 560 | 381LX561M250K032 | 0.296 | 0.148 | 1.50 | 2.10 | 30 x 35 | 330 | 381LX331M315A022 | 0.603 | 0.308 | 1.20 | 1.70 | 35 x 30 |
| 560 | 381LX561M250A012 | 0.296 | 0.148 | 1.50 | 2.10 | 35 x 25 | 390 | 381LX391M315K452 | 0.510 | 0.260 | 1.30 | 1.80 | 30 x 45 |
| 680 | 381LX681M250J052 | 0.244 | 0.134 | 1.70 | 2.38 | 25 x 50 | 390 | 381LX391M315A032 | 0.510 | 0.260 | 1.30 | 1.80 | 35 x 35 |
| 680 | 381LX681M250K042 | 0.244 | 0.134 | 1.70 | 2.38 | 30 x 40 | 470 | 381LX471M315K452 | 0.423 | 0.216 | 1.40 | 2.00 | 30 x 45 |
| 680 | 381LX681M250A022 | 0.244 | 0.134 | 1.70 | 2.38 | 35 x 30 | 470 | 381LX471M315K052 | 0.423 | 0.216 | 1.40 | 2.00 | 30 x 50 |
| 820 | 381LX821M250K452 | 0.202 | 0.111 | 2.00 | 2.80 | 30 x 45 | 470 | 381LX471M315A032 | 0.423 | 0.216 | 1.40 | 2.00 | 35 x 35 |
| 820 | 381LX821M250A032 | 0.202 | 0.111 | 2.00 | 2.80 | 35 x 35 | 470 | 381LX471M315A042 | 0.423 | 0.216 | 1.40 | 2.00 | 35 x 40 |
| 1000 | 381LX102M250K052 | 0.199 | 0.109 | 2.20 | 3.10 | 30 x 50 | 560 | 381LX561M315K052 | 0.355 | 0.181 | 1.50 | 2.10 | 30 x 50 |
| 1000 | 381LX102M250A042 | 0.199 | 0.109 | 2.20 | 3.10 | 35 x 40 | 560 | 381LX561M315A042 | 0.355 | 0.181 | 1.50 | 2.10 | 35 x 40 |
| 1000 | 381LX102M250A452 | 0.166 | 0.099 | 2.30 | 3.20 | 35 x 45 | 560 | 381LX561M315A452 | 0.355 | 0.181 | 1.50 | 2.10 | 35 x 45 |
| 1200 | 381LX122M250A452 | 0.166 | 0.099 | 2.30 | 3.20 | 35 x 45 | 680 | 381LX681M315A452 | 0.293 | 0.149 | 1.70 | 2.40 | 35 x 45 |
| 1200 | 383LX122M250N042 | 0.180 | 0.117 | 2.66 | 3.72 | 40 x 40 | 680 | 381LX681M315A052 | 0.293 | 0.149 | 1.70 | 2.40 | 35 x 50 |
| 1200 | 383L122M250N052 | 0.081 | 0.031 | 2.60 | 4.30 | 40 x 50 | 820 | 381LX821M315A052 | 0.242 | 0.030 | 2.00 | 2.80 | 35 x 50 |
| 1500 | 381LX152M250A052 | 0.144 | 0.093 | 2.50 | 3.50 | 35 x 50 | 820 | 383L821M315N052 | 0.190 | 0.130 | 1.70 | 2.10 | 40 x 50 |
| 1800 | 383LX182M250N052 | 0.120 | 0.078 | 3.25 | 4.55 | 40 x 50 | 1200 | 383L122M315N062 | 0.150 | 0.110 | 2.10 | 2.50 | 40 x 63 |
| | | | | | | | 1500 | 383L152M315N082 | 0.110 | 0.055 | 2.70 | 3.20 | 40 x 80 |

Type 381LX / 383LX 105 °C High Ripple, Snap-In Aluminum

High Ripple, Long Life, 2,4 and 5 pin styles available

| Cap. (µF) | Catalog Part Number | Max. ESR | | Ripple Amps | | Nominal | Cap. (µF) | Catalog Part Number | Max. ESR | | Ripple Amps | | Nominal |
|--------------------------------|------------------------|----------|--------|-------------|--------|----------|--------------------------------|------------------------|----------|--------|-------------|--------|----------|
| | | @ +25°C | | @ +105°C | | Size | | | @ +25°C | | @ +105°C | | Size |
| | | 120 Hz | 20 kHz | 120 Hz | 20 kHz | D x L | | | 120 Hz | 20 kHz | 120 Hz | 20 kHz | D x L |
| | | (ohms) | (ohms) | (A) | (A) | (mm) | | | (ohms) | (ohms) | (A) | (A) | (mm) |
| 350 Vdc (400 Vdc Surge) | | | | | | | 400 Vdc (450 Vdc Surge) | | | | | | |
| 82 | 381LX820M350H012 | 2.430 | 1.240 | 0.60 | 0.90 | 22 x 25 | 150 | 381LX151M400H022 | 0.921 | 0.322 | 0.90 | 1.30 | 22 x 30 |
| 100 | 381LX101M350H022 | 1.990 | 1.020 | 0.70 | 1.00 | 22 x 30 | 150 | 381LX151M400H032 | 1.330 | 0.460 | 0.80 | 1.10 | 22 x 35 |
| 120 | 381LX121M350H022 | 1.660 | 0.750 | 0.75 | 1.05 | 22 x 30 | 150 | 381LX151M400J012 | 1.110 | 0.870 | 0.80 | 1.10 | 25 x 25 |
| 150 | 381LX151M350H022 | 1.330 | 0.600 | 0.77 | 1.08 | 22 x 30 | 180 | 381LX181M400J022 | 0.921 | 0.322 | 0.90 | 1.30 | 25 x 30 |
| 180 | 381LX181M350H032 | 1.110 | 0.500 | 0.87 | 1.22 | 22 x 35 | 180 | 381LX181M400J032 | 1.110 | 0.500 | 0.95 | 1.33 | 25 x 35 |
| 220 | 381LX221M350H042 | 0.900 | 0.410 | 1.00 | 1.40 | 22 x 40 | 180 | 381LX181M400K022 | 0.921 | 0.322 | 0.90 | 1.30 | 30 x 30 |
| 270 | 381LX271M350H452 | 0.740 | 0.380 | 1.10 | 1.50 | 22 x 45 | 220 | 381LX221M400H452 | 0.614 | 0.215 | 1.20 | 1.70 | 22 x 45 |
| 270 | 381LX271M350K022 | 0.737 | 0.376 | 1.10 | 1.50 | 30 x 30 | 220 | 381LX221M400K022 | 0.754 | 0.264 | 1.10 | 1.50 | 30 x 30 |
| 330 | 381LX331M350K042 | 0.603 | 0.308 | 1.20 | 1.70 | 30 x 40 | 220 | 381LX221M400A012 | 0.754 | 0.264 | 1.10 | 1.50 | 35 x 25 |
| 330 | 381LX331M350A022 | 0.603 | 0.308 | 1.20 | 1.70 | 35 x 30 | 270 | 381LX271M400J052 | 0.614 | 0.215 | 1.20 | 1.70 | 25 x 50 |
| 390 | 381LX391M350K452 | 0.510 | 0.260 | 1.30 | 1.80 | 30 x 45 | 270 | 381LX271M400K032 | 0.614 | 0.215 | 1.20 | 1.70 | 30 x 35 |
| 390 | 381LX391M350A022 | 0.510 | 0.260 | 1.30 | 1.80 | 35 x 30 | 270 | 381LX271M400A022 | 0.614 | 0.215 | 1.20 | 1.70 | 35 x 30 |
| 470 | 381LX471M350K052 | 0.423 | 0.216 | 1.40 | 2.00 | 30 x 50 | 330 | 381LX331M400K452 | 0.502 | 0.201 | 1.40 | 1.90 | 30 x 45 |
| 470 | 381LX471M350A042 | 0.423 | 0.216 | 1.40 | 2.00 | 35 x 40 | 330 | 381LX331M400A032 | 0.502 | 0.201 | 1.40 | 1.90 | 35 x 35 |
| 560 | 381LX561M350A452 | 0.355 | 0.181 | 1.50 | 2.10 | 35 x 45 | 390 | 381LX391M400J452 | 0.425 | 0.170 | 1.55 | 2.20 | 25 x 45 |
| 560 | 383L561M350N042 | 0.299 | 0.205 | 1.30 | 1.50 | 40 x 40 | 390 | 381LX391M400K052 | 0.425 | 0.170 | 1.55 | 2.20 | 30 x 50 |
| 680 | 381LX681M350A052 | 0.293 | 0.149 | 1.70 | 2.40 | 35 x 50 | 390 | 381LX391M400A042 | 0.425 | 0.170 | 1.55 | 2.20 | 35 x 40 |
| 680 | 383LX681M350N042 | 0.317 | 0.127 | 2.30 | 3.22 | 40 x 40 | 470 | 381LX471M400A452 | 0.353 | 0.141 | 1.80 | 2.50 | 35 x 45 |
| 820 | 381LX821M350A062 | 0.303 | 0.155 | 2.70 | 3.70 | 35 x 63 | 470 | 383LX471M400N042 | 0.353 | 0.141 | 1.80 | 2.50 | 40 x 40 |
| 820 | 383LX821M350N052 | 0.303 | 0.155 | 2.70 | 3.70 | 40 x 50 | 560 | 381LX561M400A052 | 0.296 | 0.118 | 1.80 | 2.50 | 35 x 50 |
| 1000 | 383L102M350N062 | 0.170 | 0.117 | 2.00 | 2.40 | 40 x 63 | 680 | 383LX681M400N052 | 0.244 | 0.098 | 2.20 | 3.00 | 40 x 50 |
| 1000 | 383LX102M350B052V | 0.216 | 0.066 | 3.56 | 4.96 | 50 x 50 | 820 | 381LX821M400A062 | 0.202 | 0.081 | 2.44 | 3.42 | 35 x 63 |
| 1200 | 381LX122M350A082 | 0.207 | 0.106 | 3.20 | 4.50 | 35 x 80 | 820 | 383LX821M400B052V | 0.202 | 0.081 | 3.20 | 4.40 | 50 x 50 |
| 1200 | 383LX122M350N062 | 0.207 | 0.106 | 3.20 | 4.50 | 40 x 63 | 1000 | 381LX102M400A082 | 0.202 | 0.081 | 3.00 | 4.20 | 35 x 80 |
| 1500 | 381LX152M350A102 | 0.144 | 0.057 | 4.78 | 6.69 | 35 x 105 | 1000 | 383LX102M400N062 | 0.202 | 0.081 | 3.00 | 4.20 | 40 x 63 |
| 1500 | 383LX152M350N082 | 0.166 | 0.085 | 3.80 | 5.25 | 40 x 80 | 1200 | 381LX122M400A102 | 0.138 | 0.055 | 3.80 | 5.30 | 35 x 105 |
| 1500 | 383LX152M350B062V | 0.144 | 0.057 | 4.16 | 5.82 | 50 x 63 | 1200 | 383LX122M400N082 | 0.138 | 0.055 | 3.80 | 5.30 | 40 x 80 |
| 1800 | 383LX182M350N102 | 0.120 | 0.048 | 5.23 | 7.32 | 40 x 105 | 1200 | 383LX122M400B062V | 0.152 | 0.061 | 4.20 | 5.90 | 50 x 63 |
| 1800 | 383LX182M350B082V | 0.120 | 0.048 | 5.69 | 7.97 | 50 x 80 | 1500 | 383LX152M400N102 | 0.111 | 0.044 | 4.80 | 6.70 | 40 x 105 |
| 2000 | 383LX202M350B092V | 0.108 | 0.043 | 6.34 | 8.88 | 50 x 92 | 1500 | 383LX152M400B082V | 0.122 | 0.049 | 5.20 | 7.30 | 50 x 80 |
| 2200 | 383LX222M350B102V | 0.098 | 0.039 | 6.60 | 9.30 | 50 x 105 | 1600 | 383LX162M400B092V | 0.114 | 0.046 | 5.60 | 8.00 | 50 x 92 |
| 400 Vdc (450 Vdc Surge) | | | | | | | 420 Vdc (470 Vdc Surge) | | | | | | |
| 33 | 381LX330M400H202 | 5.020 | 1.760 | 0.20 | 0.30 | 22 x 20 | 100 | 381LX101M420H022 | 1.820 | 0.820 | 0.65 | 0.90 | 22 x 30 |
| 47 | 381LX470M400H012 | 4.500 | 1.600 | 0.30 | 0.42 | 22 x 25 | 120 | 381LX121M420H022 | 1.660 | 0.750 | 0.70 | 1.00 | 22 x 30 |
| 56 | 381LX560M400H012 | 3.530 | 1.240 | 0.47 | 0.66 | 22 x 25 | 150 | 381LX151M420H042 | 1.330 | 0.600 | 0.79 | 1.11 | 22 x 40 |
| 68 | 381LX680M400H012 | 2.927 | 1.020 | 0.45 | 0.60 | 22 x 25 | 180 | 381LX181M420H042 | 1.110 | 0.500 | 0.87 | 1.22 | 22 x 40 |
| 68 | 381LX680M400J012 | 1.950 | 0.683 | 0.60 | 0.80 | 25 x 25 | 180 | 381LX181M420K022 | 1.000 | 0.450 | 0.88 | 1.20 | 30 x 30 |
| 82 | 381LX820M400H012* | 2.440 | 0.850 | 0.55 | 0.80 | 22 x 25 | 220 | 381LX221M420H452 | 0.900 | 0.410 | 1.05 | 1.50 | 22 x 45 |
| 100 | 381LX101M400H022 | 1.658 | 0.580 | 0.50 | 0.70 | 22 x 30 | 220 | 381LX221M420K022 | 0.750 | 0.260 | 1.10 | 1.50 | 30 x 30 |
| 100 | 381LX101M400J012 | 1.658 | 0.580 | 0.70 | 1.00 | 25 x 25 | 270 | 381LX271M420J452 | 0.740 | 0.330 | 1.19 | 1.67 | 25 x 45 |
| 120 | 381LX121M400J012 | 1.100 | 0.387 | 0.80 | 1.10 | 25 x 25 | 270 | 381LX271M420K032 | 0.610 | 0.210 | 1.20 | 1.70 | 30 x 35 |
| 120 | 381LX121M400J022* | 1.100 | 0.387 | 0.80 | 1.10 | 25 x 30 | | | | | | | |

*Denotes Discontinued Part

Type 381LX / 383LX 105 °C High Ripple, Snap-In Aluminum

High Ripple, Long Life, 2,4 and 5 pin styles available

| Cap. (µF) | Catalog Part Number | Max. ESR | | Ripple Amps | | Nominal |
|--------------------------------|------------------------|------------------|------------------|---------------|---------------|---------------|
| | | @ +25°C | | @ +105°C | | Size |
| | | 120 Hz (ohms) | 20 kHz (ohms) | 120 Hz (A) | 20 kHz (A) | D x L (mm) |
| 420 Vdc (470 Vdc Surge) | | | | | | |
| 270 | 381LX271M420A022 | 0.610 | 0.210 | 1.20 | 1.70 | 35 x 30 |
| 330 | 381LX331M420K452 | 0.500 | 0.200 | 1.35 | 1.90 | 30 x 45 |
| 330 | 381LX331M420A032 | 0.502 | 0.200 | 1.35 | 1.90 | 35 x 35 |
| 390 | 381LX391M420K052 | 0.420 | 0.170 | 1.55 | 2.18 | 30 x 50 |
| 390 | 381LX391M420A042 | 0.420 | 0.170 | 1.55 | 2.18 | 35 x 40 |
| 470 | 381LX471M420A452 | 0.350 | 0.141 | 1.75 | 2.45 | 35 x 45 |
| 470 | 383LX471M420N042 | 0.350 | 0.141 | 1.78 | 2.45 | 40 x 40 |
| 560 | 381LX561M420A052 | 0.300 | 0.120 | 1.80 | 2.50 | 35 x 50 |
| 680 | 383LX681M420N052 | 0.250 | 0.100 | 2.10 | 2.95 | 40 x 50 |
| 450 Vdc (500 Vdc Surge) | | | | | | |
| 56 | 381LX560M450H012 | 3.530 | 1.240 | 0.47 | 0.66 | 22 x 25 |
| 68 | 381LX680M450H012 | 2.930 | 1.020 | 0.53 | 0.73 | 22 x 25 |
| 82 | 381LX820M450H022 | 2.430 | 1.090 | 0.64 | 0.91 | 22 x 30 |
| 100 | 381LX101M450H022 | 1.990 | 0.710 | 0.65 | 0.90 | 22 x 30 |
| 100 | 381LX101M450J022* | 1.660 | 0.580 | 0.65 | 0.90 | 25 x 30 |
| 120 | 381LX121M450H032 | 1.660 | 0.750 | 0.70 | 1.00 | 22 x 35 |
| 150 | 381LX151M450H032 | 1.330 | 0.590 | 0.80 | 1.10 | 22 x 35 |
| 150 | 381LX151M450K022 | 1.100 | 0.390 | 0.80 | 1.10 | 30 x 30 |
| 180 | 381LX181M450J032 | 1.110 | 0.380 | 0.90 | 1.20 | 25 x 35 |
| 180 | 381LX181M450K032 | 0.920 | 0.320 | 0.90 | 1.20 | 30 x 35 |
| 220 | 381LX221M450J052 | 0.750 | 0.260 | 1.00 | 1.40 | 25 x 50 |
| 220 | 381LX221M450K042 | 0.750 | 0.260 | 1.00 | 1.40 | 30 x 40 |
| 220 | 381LX221M450A022 | 0.750 | 0.260 | 1.00 | 1.40 | 35 x 30 |
| 220 | 381LX221M450A042 | 0.500 | 0.176 | 1.40 | 1.90 | 35 x 40 |
| 270 | 381LX271M450K452 | 0.614 | 0.246 | 1.20 | 1.70 | 30 x 45 |
| 270 | 381LX271M450A032 | 0.614 | 0.246 | 1.20 | 1.70 | 35 x 35 |
| 330 | 381LX331M450K052 | 0.502 | 0.201 | 1.40 | 1.90 | 30 x 50 |
| 330 | 381LX331M450A042 | 0.502 | 0.176 | 1.40 | 1.90 | 35 x 40 |
| 390 | 381LX391M450A452 | 0.425 | 0.150 | 1.60 | 2.20 | 35 x 45 |
| 390 | 383LX391M450N042 | 0.425 | 0.170 | 1.68 | 2.35 | 40 x 40 |
| 470 | 381LX471M450A052 | 0.353 | 0.123 | 1.70 | 2.40 | 35 x 50 |
| 470 | 383LX471M450N042 | 0.350 | 0.140 | 1.75 | 2.45 | 40 x 40 |
| 560 | 381LX561M450A062 | 0.296 | 0.104 | 2.20 | 3.00 | 35 x 63 |
| 680 | 383L681M450A082 | 0.188 | 0.124 | 2.00 | 2.50 | 35 x 80 |
| 680 | 383LX681M450N062 | 0.244 | 0.085 | 2.50 | 3.50 | 40 x 63 |
| 680 | 383LX681M450B052V | 0.244 | 0.085 | 2.90 | 4.06 | 50 x 50 |
| 820 | 383LX821M450A082 | 0.202 | 0.071 | 2.70 | 3.80 | 35 x 80 |
| 820 | 383LX821M450B062V | 0.222 | 0.078 | 3.42 | 4.79 | 50 x 63 |
| 1000 | 383LX102M450N082 | 0.166 | 0.058 | 3.50 | 4.90 | 40 x 80 |
| 1200 | 383LX122M450N102 | 0.138 | 0.048 | 4.33 | 6.06 | 40 x 105 |
| 1200 | 383LX122M450B082V | 0.152 | 0.053 | 4.70 | 6.58 | 50 x 80 |
| 1300 | 383LX132M450B092V | 0.140 | 0.049 | 5.16 | 7.25 | 50 x 92 |
| 1500 | 383LX152M450B102V | 0.122 | 0.043 | 6.03 | 8.44 | 50 x 105 |

*Denotes Discontinued Part

Notice and Disclaimer: All product drawings, descriptions, specifications, statements, information and data (collectively, the "Information") in this datasheet or other publication are subject to change. The customer is responsible for checking, confirming and verifying the extent to which the Information contained in this datasheet or other publication is applicable to an order at the time the order is placed. All Information given herein is believed to be accurate and reliable, but it is presented without any guarantee, warranty, representation or responsibility of any kind, expressed or implied. Statements of suitability for certain applications are based on the knowledge that the Cornell Dubilier company providing such statements ("Cornell Dubilier") has of operating conditions that such Cornell Dubilier company regards as typical for such applications, but are not intended to constitute any guarantee, warranty or representation regarding any such matter – and Cornell Dubilier specifically and expressly disclaims any guarantee, warranty or representation concerning the suitability for a specific customer application, use, storage, transportation, or operating environment. The Information is intended for use only by customers who have the requisite experience and capability to determine the correct products for their application. Any technical advice inferred from this Information or otherwise provided by Cornell Dubilier with reference to the use of any Cornell Dubilier products is given gratis (unless otherwise specified by Cornell Dubilier), and Cornell Dubilier assumes no obligation or liability for the advice given or results obtained. Although Cornell Dubilier strives to apply the most stringent quality and safety standards regarding the design and manufacturing of its products, in light of the current state of the art, isolated component failures may still occur. Accordingly, customer applications which require a high degree of reliability or safety should employ suitable designs or other safeguards (such as installation of protective circuitry or redundancies or other appropriate protective measures) in order to ensure that the failure of an electrical component does not result in a risk of personal injury or property damage. Although all product-related warnings, cautions and notes must be observed, the customer should not assume that all safety measures are indicated in such warnings, cautions and notes, or that other safety measures may not be required.

X-ON Electronics

Largest Supplier of Electrical and Electronic Components

Click to view similar products for Aluminium Electrolytic Capacitors - Snap In category:

Click to view products by Cornell Dubilier manufacturer:

Other Similar products are found below :

[NRLF103M25V35X20F](#) [EET-XB2W221LA](#) [419-2066-400](#) [B41231C4229M](#) [B43508C5337M062](#) [MAL215969181E3](#) [ALC40F1012DH](#)
[ALC40E1004EL](#) [383LX332M250N082V](#) [LGZ2W101MELB30](#) [LGZ2W151MELB40](#) [LGZ2W271MELC45](#) [LGZ2W221MELC40](#)
[LGZ2W331MELC50](#) [LGZ2W121MELC25](#) [HFE102M35070FVA](#) [KN821M40035x50A](#) [EHP337M2DO25SW](#) [EKMM451VSN471MA45S](#)
[EKMW451VSN331MR30S](#) [ELXS601VSN121MA30S](#) [ESMH101VNN682MA50U](#) [KN471M20022*36A](#) [ELH2GM221P30KT](#)
[ELT2WM221Q35KT](#) [CK221MOH40B](#) [CL221KPI30B](#) [CL271MPI40B](#) [CL471MVJ50B](#) [EKMR451VSN471MA35S](#)
[EKMR451VSN151MP35S](#) [ELXS421VSN221MP45S](#) [KN331M40030*35A](#) [ELG229M016AS3AA](#) [B43541A6397M000](#) [B43544C6227M000](#)
[B43630B5477M067](#) [B43640E9477M000](#) [B43644J6477M000](#) [MAL215757331E3](#) [MAL229956561E3](#) [MAL229966182E3](#) [MAL229967471E3](#)
[MAL229967821E3](#) [ALC70A821EF400](#) [ALC70A102EH400](#) [MAL205658102E3](#) [MAL205855103E3](#) [MAL209436471E3](#) [MAL215848103E3](#)