

# Type 550 105 °C High Ripple, Long-life, Inverter Grade, Aluminum

## High Ripple, Long Life, Computer Grade



### High Value, High Ripple Current

Type 550 is the original Inverter Grade capacitor for continuous operation at up to 105 °C and it now is available in low voltages too. For best value its load life test is 2000 hours instead of the 5000 hours of the Type 550C. While less than half the life capability of the Type 550C, it is lower cost and easily lasts more than 10 years in typical industrial applications.

### Highlights

- 2,000 hour load life
- Ripple current to >50 amps
- ESRs to 2.5 mΩ

### RoHS Compliant

### Specifications

|                                    |  |
|------------------------------------|--|
| <b>Operating Temperature:</b>      | -40 °C to +105 °C                            |
| <b>Rated Voltage:</b>              | 6.3 to 450 Vdc                               |
| <b>Capacitance:</b>                | 90 µF to 1.5 F                               |
| <b>Capacitance Tolerance:</b>      | Vdc ≤ 150 V: -10 +75%, Vdc > 150 V: -10 +50% |
| <b>DCLeakage Current:</b>          | ≤3√CV µA (4 mA max.)                         |
| <b>Ripple Current Multipliers:</b> | <b>Ambient Temperature</b>                   |

| 45 °C | 55 °C | 65 °C | 75 °C | 85 °C | 95 °C | 105 °C |
|-------|-------|-------|-------|-------|-------|--------|
| 1.73  | 1.58  | 1.41  | 1.22  | 1.00  | 0.71  | 0.57   |

### Frequency

|                                  | 50 Hz | 60 Hz | 120 Hz | 360 Hz | 1 kHz | 5 kHz | 10 kHz @ up |
|----------------------------------|-------|-------|--------|--------|-------|-------|-------------|
| <b>1 3/8 and 2 inch diameter</b> |       |       |        |        |       |       |             |
| ≤ 50 V                           | 0.77  | 0.85  | 1.00   | 1.05   | 1.08  | 1.08  | 1.08        |
| 51–299 V                         | 0.75  | 0.83  | 1.00   | 1.15   | 1.20  | 1.20  | 1.20        |
| ≥300 V                           | 0.72  | 0.80  | 1.00   | 1.30   | 1.40  | 1.40  | 1.40        |
| <b>2 1/2 and 3 inch diameter</b> |       |       |        |        |       |       |             |
| ≤ 50 V                           | 0.81  | 0.90  | 1.00   | 1.02   | 1.02  | 1.02  | 1.02        |
| 51–299 V                         | 0.81  | 0.90  | 1.00   | 1.07   | 1.07  | 1.07  | 1.07        |
| ≥300 V                           | 0.72  | 0.80  | 1.00   | 1.25   | 1.35  | 1.35  | 1.35        |

**Load Life:** 2,000 h at full load @ 105 °C

**Shelf Life:** 500 h @ 105 °C, Capacitance, ESR and DCL, initial requirements.

**Vibration:** 0 to 55 Hz, 0.06" and 10 g max, 1.5 h each of 2 axis

# Type 550 105 °C High Ripple, Long-life, Inverter Grade, Aluminum Outline Drawing

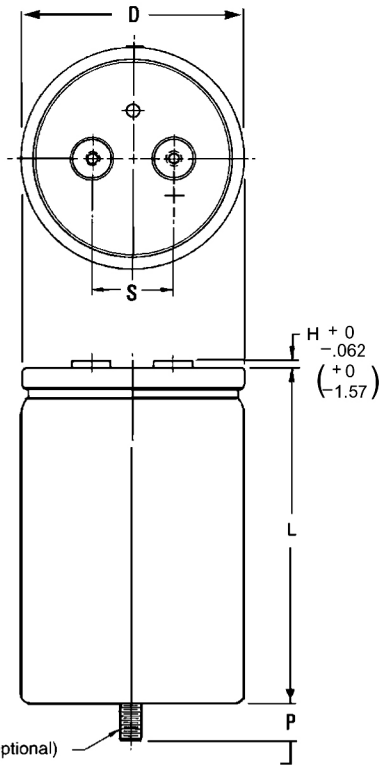

NOTE: With the stud-mount feature, a thermally-conductive disk can be inserted in the bottom flush with the outer insulating sleeve. This reduces the thermal resistance through the can bottom by 0.3 °C/W. Can Style P.

## Stud Dimensions

| Case Diam. | Stud Thread | P ± 0.039" (±1.0 mm) |
|------------|-------------|----------------------|
| 1.38       | M8          | 0.470" (12.0)        |
| 1.75       | M8          | 0.470" (12.0)        |
| 2.00       | M12         | 0.630" (16.0)        |
| 2.50       | M12         | 0.630" (16.0)        |
| 3.00       | M12         | 0.630" (16.0)        |

## Insulated Case Dimensions

For bare can subtract 0.024" (0.61 mm) from D and 0.03" (0.76 mm) from L

| Case Code | Diameter (D) |            | Length (L)  |            | Terminals (S) |            | Typical Weight |      |
|-----------|--------------|------------|-------------|------------|---------------|------------|----------------|------|
|           | ±0.031 (in)  | ±0.78 (mm) | ±0.062 (in) | ±1.57 (mm) | ±0.015 (in)   | ±0.38 (mm) | (oz)           | (g)  |
| AK        | 1.399        | 35.53      | 1.655       | 42.04      | 0.500         | 12.70      | 1.90           | 54   |
| AA        | 1.399        | 35.53      | 2.155       | 54.74      | 0.500         | 12.70      | 2.00           | 57   |
| AH        | 1.399        | 35.53      | 2.655       | 67.44      | 0.500         | 12.70      | 2.70           | 77   |
| AB        | 1.399        | 35.53      | 3.155       | 80.14      | 0.500         | 12.70      | 3.30           | 94   |
| AJ        | 1.399        | 35.53      | 3.655       | 92.84      | 0.500         | 12.70      | 3.80           | 108  |
| AC        | 1.399        | 35.53      | 4.155       | 105.54     | 0.500         | 12.70      | 4.40           | 125  |
| AD        | 1.399        | 35.53      | 4.655       | 118.24     | 0.500         | 12.70      | 5.10           | 145  |
| AE        | 1.399        | 35.53      | 5.155       | 130.94     | 0.500         | 12.70      | 6.80           | 193  |
| AF        | 1.399        | 35.53      | 5.655       | 143.64     | 0.500         | 12.70      | 8.10           | 230  |
| BA        | 2.024        | 51.41      | 2.155       | 54.74      | 0.875         | 22.23      | 5.40           | 153  |
| BH        | 2.024        | 51.41      | 2.655       | 67.44      | 0.875         | 22.23      | 6.10           | 173  |
| BB        | 2.024        | 51.41      | 3.155       | 80.14      | 0.875         | 22.23      | 6.80           | 193  |
| BJ        | 2.024        | 51.41      | 3.655       | 92.84      | 0.875         | 22.23      | 8.20           | 232  |
| BC        | 2.024        | 51.41      | 1.155       | 29.34      | 0.875         | 22.23      | 9.50           | 269  |
| BD        | 2.024        | 51.41      | 4.655       | 118.24     | 0.875         | 22.23      | 10.30          | 292  |
| BE        | 2.024        | 51.41      | 5.155       | 130.94     | 0.875         | 22.23      | 10.70          | 303  |
| BF        | 2.024        | 51.41      | 5.655       | 143.64     | 0.875         | 22.23      | 13.00          | 369  |
| CB        | 2.524        | 64.11      | 3.155       | 80.14      | 1.125         | 28.58      | 10.40          | 295  |
| CJ        | 2.524        | 64.11      | 3.655       | 92.84      | 1.125         | 28.58      | 12.73          | 361  |
| CC        | 2.524        | 64.11      | 4.155       | 105.54     | 1.125         | 28.58      | 15.00          | 425  |
| CD        | 2.524        | 64.11      | 4.655       | 118.24     | 1.125         | 28.58      | 17.20          | 488  |
| CE        | 2.524        | 64.11      | 5.155       | 130.94     | 1.125         | 28.58      | 19.30          | 547  |
| CF        | 2.524        | 64.11      | 5.655       | 143.64     | 1.125         | 28.58      | 21.40          | 607  |
| DJ        | 3.024        | 76.81      | 3.655       | 92.84      | 1.250         | 31.75      | 20.00          | 567  |
| DC        | 3.024        | 76.81      | 4.155       | 105.54     | 1.250         | 31.75      | 22.20          | 629  |
| DD        | 3.024        | 76.81      | 4.655       | 118.24     | 1.250         | 31.75      | 25.50          | 723  |
| DE        | 3.024        | 76.81      | 5.155       | 130.94     | 1.250         | 31.75      | 30.00          | 850  |
| DF        | 3.024        | 76.81      | 5.655       | 143.64     | 1.250         | 31.75      | 31.90          | 904  |
| DP        | 3.024        | 76.81      | 5.905       | 149.99     | 1.250         | 31.75      | 32.85          | 931  |
| DG        | 3.024        | 76.81      | 8.655       | 219.84     | 1.250         | 31.75      | 43.30          | 1227 |

| Terminal Style     | Code | Post Diameter |      | H Maximum |      | Thread | min Full Thread |      | For Case Diameters |
|--------------------|------|---------------|------|-----------|------|--------|-----------------|------|--------------------|
|                    |      | (in)          | (mm) | (in)      | (mm) |        | (in)            | (mm) |                    |
| Low Post           | A    | 0.314         | 8.0  | 0.094     | 2.4  | 10-32  | 0.218           | 5.5  | 1 3/8 to 3         |
| High Post          | B    | 0.314         | 8.0  | 0.281     | 7.1  | 10-32  | 0.375           | 9.5  | 1 3/8 to 3         |
| High Current, Low  | D    | 0.684         | 17.4 | 0.125     | 3.2  | 1/4-28 | 0.344           | 8.7  | 2 1/2 & 3          |
| High Current, High | E    | 0.684         | 17.4 | 0.281     | 7.1  | 1/4-28 | 0.469           | 11.9 | 2 1/2 & 3          |
| Small M5 Post      | M    | 0.314         | 8.0  | 0.281     | 7.1  | M5     | 0.375           | 9.5  | 1 3/8 & 2          |
| M5 Post            | F    | 0.512         | 13.0 | 0.23      | 5.8  | M5     | 0.344           | 8.7  | 2 1/2 & 3          |
| M6 Low Post        | G    | 0.684         | 17.4 | 0.125     | 3.2  | M6     | 0.344           | 8.7  | 2 1/2 & 3          |
| M6 High Post       | H    | 0.684         | 17.4 | 0.281     | 7.1  | M6     | 0.469           | 11.9 | 2 1/2 & 3          |

[Click here to see Hardware & Mounting Options](#)

# Type 550 105 °C High Ripple, Long-life, Inverter Grade, Aluminum

## Part Numbering System

|             |                    |   |  |                                   |   |   |                  |
|-------------|--------------------|---|--|-----------------------------------|---|---|------------------|
| 550         | 542                | T   | 450  | DG                                | 2   | D   | S                |
| <b>Type</b> | <b>Capacitance</b> | <b>Tolerance</b>                          | <b>Voltage</b>                                 | <b>Case Code</b>                  | <b>Insulation</b>   | <b>Terminal</b>   | <b>Can Style</b> |
|             | 542 = 5400 $\mu$ F | M= $\pm$ 20%<br>U= 10%+75%<br>T= -10%+50% | 450 = 450 Vdc<br>016 = 16 Vdc<br>6R3 = 6.3 Vdc | 0= None<br>1= Polyester<br>2= PVC | A= Low Post<br>B= High Post<br>D= High Current,<br>Low Post<br>E= High Current,<br>High Post<br>F= M5 Post<br>M= M5 Post,<br>small<br>G= M6 Low Post<br>H= M6 High Post | Blank=<br>Standard<br>Can<br>S= Stud<br>Bottom<br>P= Stud<br>with<br>Thermal<br>Pad |                  |

Standard insulation is 0.008-in PVC sleeve with 0.01-in polypropylene end disk.

## Typical Performance Curves

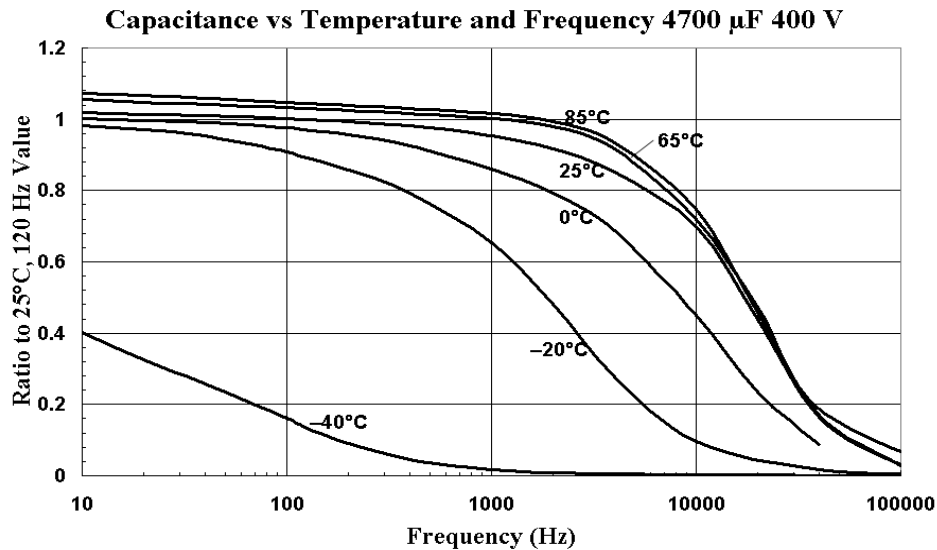
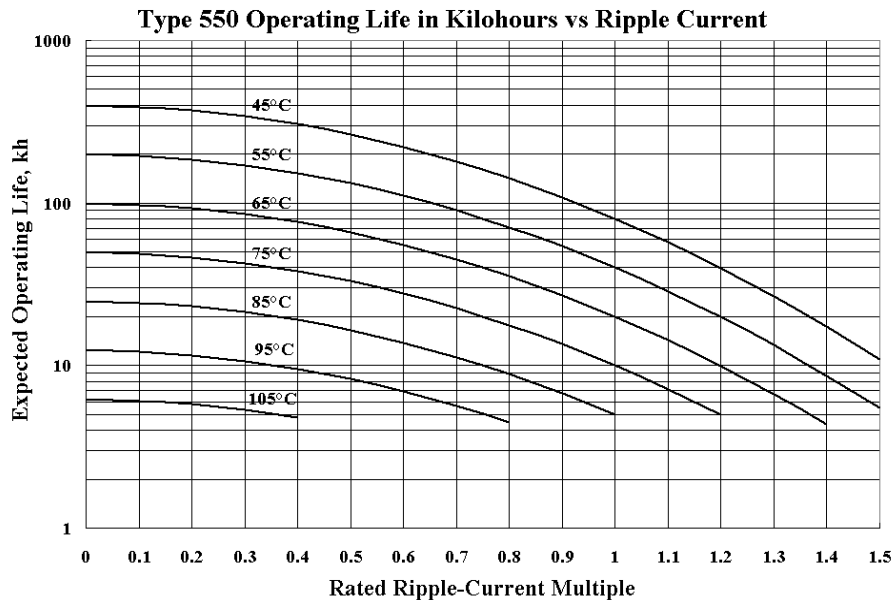

# Type 550 105 °C High Ripple, Long-life, Inverter Grade, Aluminum

## Typical Performance Curves

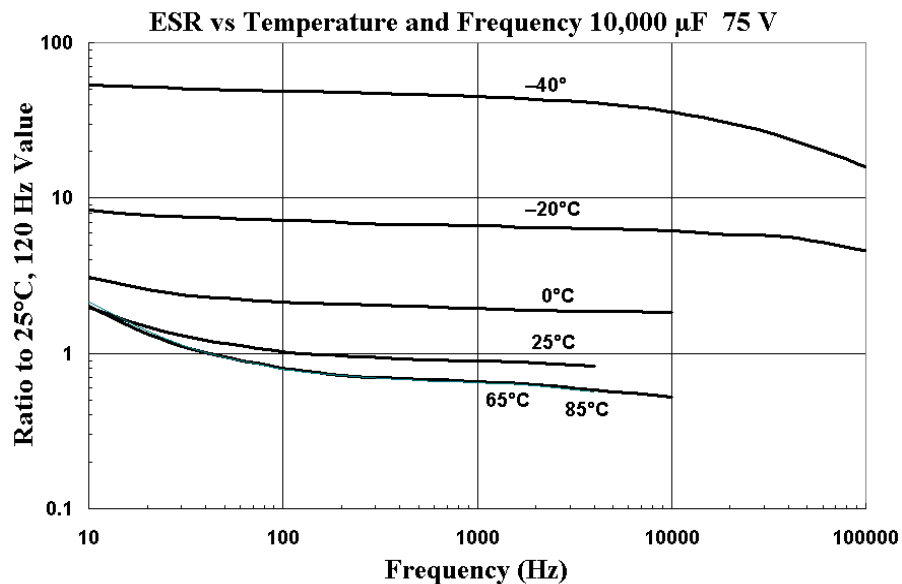
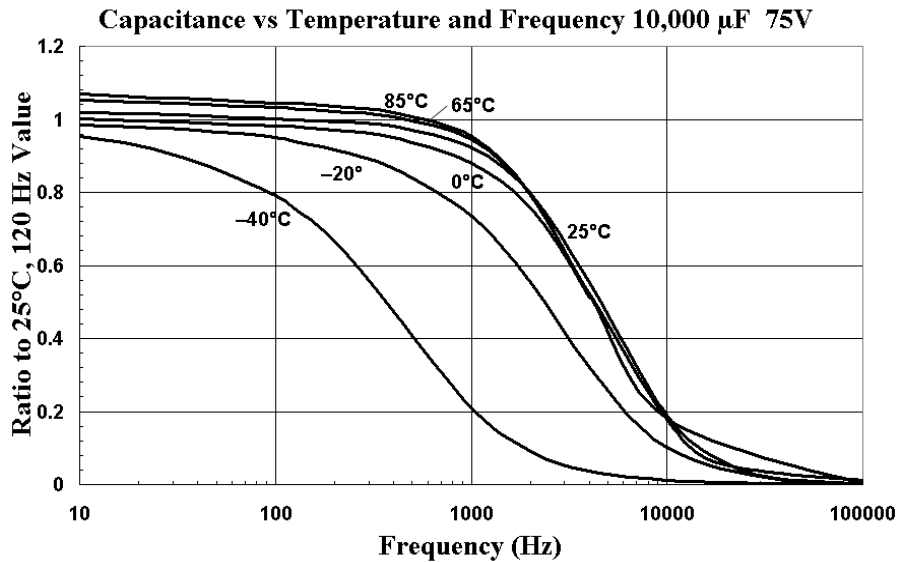
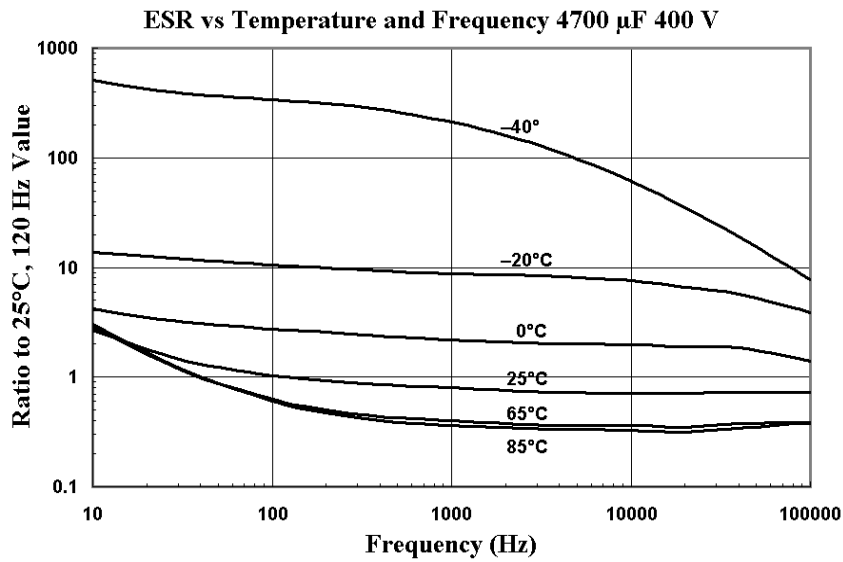

# Type 550 105 °C High Ripple, Long-life, Inverter Grade, Aluminum

## Typical Performance Curves

Impedance vs Temperature and Frequency 10,000 µF 75V

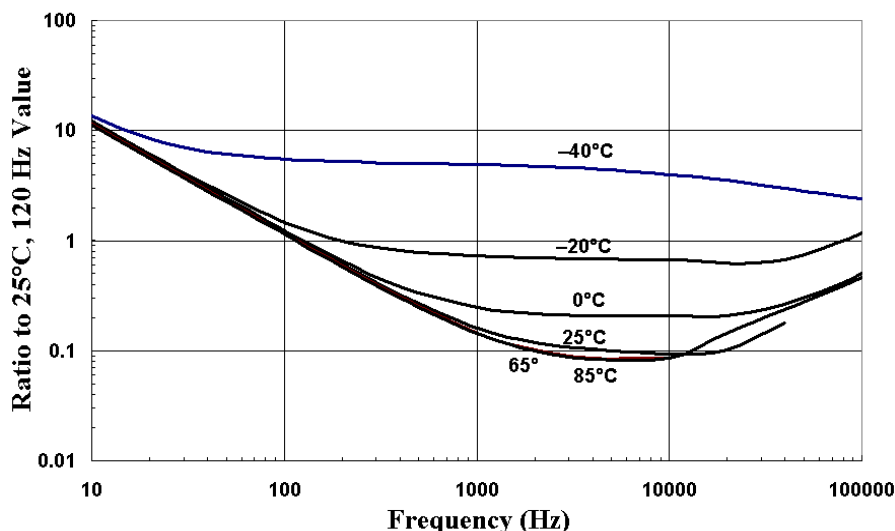

## Ratings

| Cap.<br>(µF)                 | Catalog<br>Part Number | ESR Max<br>@ 25°C |               | Ripple Current<br>Max @ 85°C |              | Nominal<br>Size<br>D x L<br>(in.) |
|------------------------------|------------------------|-------------------|---------------|------------------------------|--------------|-----------------------------------|
|                              |                        | 120Hz<br>(mΩ)     | 20kHz<br>(mΩ) | 120Hz<br>(A)                 | 20kHz<br>(A) |                                   |
| <b>6.3 Vdc (8 Vdc Surge)</b> |                        |                   |               |                              |              |                                   |
| 28,000                       | 550283U6R3AK2B         | 49.5              | 33.5          | 5.0                          | 6.0          | 1 3/8 X 1 1/8                     |
| 47,000                       | 550473U6R3AA2B         | 30.1              | 20.6          | 7.0                          | 8.5          | 1 3/8 X 2 1/8                     |
| 66,000                       | 550663U6R3AH2B         | 21.9              | 15.1          | 8.9                          | 10.7         | 1 3/8 X 2 3/8                     |
| 85,000                       | 550853U6R3AB2B         | 17.4              | 12.1          | 10.7                         | 12.9         | 1 3/8 X 3 1/8                     |
| 120,000                      | 550124U6R3AC2B         | 12.7              | 9.0           | 14.1                         | 16.7         | 1 3/8 X 4 1/8                     |
| 170,000                      | 550174U6R3BB2B         | 9.8               | 7.2           | 17.8                         | 20.8         | 2 X 3 1/8                         |
| 180,000                      | 550184U6R3AF2B         | 9.6               | 7.1           | 18.5                         | 21.6         | 1 3/8 X 5 1/8                     |
| 260,000                      | 550264U6R3BC2B         | 6.9               | 5.2           | 23.6                         | 27.3         | 2 X 4 1/8                         |
| 390,000                      | 550394U6R3BF2D         | 5.1               | 3.9           | 30.8                         | 35.1         | 2 X 5 1/8                         |
| 430,000                      | 550434U6R3CC2D         | 4.6               | 3.5           | 33.2                         | 37.8         | 2 1/2 X 4 1/8                     |
| 610,000                      | 550614U6R3DC2D         | 4.3               | 3.6           | 38.8                         | 42.4         | 3 X 4 1/8                         |
| 640,000                      | 550644U6R3CF2D         | 3.3               | 2.6           | 44.4                         | 50.1         | 2 1/2 X 5 1/8                     |
| 810,000                      | 550814U6R3DE2D         | 3.4               | 2.9           | 46.8                         | 50.0         | 3 X 5 1/8                         |
| 910,000                      | 550914U6R3DF2D         | 3.1               | 2.6           | 50.0                         | 50.0         | 3 X 5 3/8                         |
| 960,000                      | 550964U6R3DP2D         | 3.0               | 2.5           | 50.0                         | 50.0         | 3 X 5 3/8                         |
| 1,500,000                    | 550155U6R3DG2D         | 2.9               | 2.5           | 50.0                         | 50.0         | 3 X 8 3/8                         |
| <b>16 Vdc (20 Vdc Surge)</b> |                        |                   |               |                              |              |                                   |
| 17,000                       | 550173U016AK2B         | 56.6              | 33.5          | 4.6                          | 6.0          | 1 3/8 X 1 1/8                     |
| 29,000                       | 550293U016AA2B         | 34.4              | 20.6          | 6.5                          | 8.5          | 1 3/8 X 2 1/8                     |
| 41,000                       | 550413U016AH2B         | 25.0              | 15.1          | 8.3                          | 10.7         | 1 3/8 X 2 3/8                     |
| 52,000                       | 550523U016AB2B         | 19.8              | 12.1          | 10.0                         | 12.9         | 1 3/8 X 3 1/8                     |
| 75,000                       | 550753U016AC2B         | 14.4              | 9.0           | 13.3                         | 16.7         | 1 3/8 X 4 1/8                     |
| 110,000                      | 550114U016AF2B         | 10.7              | 7.1           | 17.5                         | 21.6         | 1 3/8 X 5 1/8                     |
| 110,000                      | 550114U016BB2B         | 11.0              | 7.2           | 16.8                         | 20.8         | 2 X 3 1/8                         |
| 160,000                      | 550164U016BC2B         | 7.7               | 5.2           | 22.3                         | 27.3         | 2 X 4 1/8                         |
| 240,000                      | 550244U016BF2B         | 5.6               | 3.9           | 29.3                         | 35.1         | 2 X 5 1/8                         |
| 260,000                      | 550264U016CC2D         | 5.1               | 3.5           | 31.6                         | 37.8         | 2 1/2 X 4 1/8                     |
| <b>25 Vdc (30 Vdc Surge)</b> |                        |                   |               |                              |              |                                   |
| 380,000                      | 550384U016DC2D         | 4.6               | 3.6           | 37.4                         | 42.4         | 3 X 4 1/8                         |
| 390,000                      | 550394U016CF2D         | 3.6               | 2.6           | 42.4                         | 50.1         | 2 1/2 X 5 3/8                     |
| 510,000                      | 550514U016DE2D         | 3.6               | 2.9           | 45.2                         | 50.0         | 3 X 5 1/8                         |
| 570,000                      | 550574U016DF2D         | 3.3               | 2.6           | 49.0                         | 50.0         | 3 X 5 3/8                         |
| 600,000                      | 550604U016DP2D         | 3.2               | 2.5           | 50.0                         | 50.0         | 3 X 5 3/8                         |
| 920,000                      | 550924U016DG2D         | 3.1               | 2.5           | 50.0                         | 50.0         | 3 X 8 3/8                         |
| <b>25 Vdc (30 Vdc Surge)</b> |                        |                   |               |                              |              |                                   |
| 9,900                        | 550992U025AK2B         | 63.8              | 34.0          | 4.4                          | 6.0          | 1 3/8 X 1 1/8                     |
| 16,000                       | 550163U025AA2B         | 38.7              | 20.8          | 6.2                          | 8.4          | 1 3/8 X 2 1/8                     |
| 23,000                       | 550233U025AH2B         | 28.1              | 15.3          | 7.8                          | 10.6         | 1 3/8 X 2 3/8                     |
| 30,000                       | 550303U025AB2B         | 22.2              | 12.3          | 9.5                          | 12.8         | 1 3/8 X 3 1/8                     |
| 43,000                       | 550433U025AC2B         | 16.0              | 9.1           | 12.6                         | 16.6         | 1 3/8 X 4 1/8                     |
| 60,000                       | 550603U025BB2B         | 12.2              | 7.3           | 16.0                         | 20.7         | 2 X 3 1/8                         |
| 62,000                       | 550623U025AF2B         | 11.8              | 7.1           | 16.7                         | 21.5         | 1 3/8 X 5 3/8                     |
| 90,000                       | 550903U025BC2B         | 8.5               | 5.2           | 21.3                         | 27.1         | 2 X 4 1/8                         |
| 140,000                      | 550144U025BF2B         | 6.1               | 3.9           | 28.0                         | 34.9         | 2 X 5 3/8                         |
| 150,000                      | 550154U025CC2D         | 5.5               | 3.6           | 30.2                         | 37.7         | 2 1/2 X 4 1/8                     |
| 220,000                      | 550224U025CF2D         | 3.9               | 2.6           | 40.7                         | 49.9         | 2 1/2 X 5 3/8                     |
| 220,000                      | 550224U025DC2D         | 5.0               | 3.6           | 36.2                         | 42.3         | 3 X 4 1/8                         |
| 290,000                      | 550294U025DE2D         | 3.9               | 2.9           | 43.8                         | 50.0         | 3 X 5 1/8                         |
| 320,000                      | 550324U025DF2D         | 3.5               | 2.7           | 47.5                         | 50.0         | 3 X 5 3/8                         |
| 340,000                      | 550344U025DP2D         | 3.4               | 2.6           | 50.0                         | 50.0         | 3 X 5 3/8                         |
| 520,000                      | 550524U025DG2D         | 3.3               | 2.5           | 50.0                         | 50.0         | 3 X 8 3/8                         |
| <b>50 Vdc (65 Vdc Surge)</b> |                        |                   |               |                              |              |                                   |
| 4,000                        | 550402U050AK2B         | 85.2              | 34.6          | 3.8                          | 5.9          | 1 3/8 X 1 1/8                     |
| 6,700                        | 550672U050AA2B         | 51.6              | 21.2          | 5.3                          | 8.3          | 1 3/8 X 2 1/8                     |
| 9,400                        | 550942U050AH2B         | 37.2              | 15.5          | 6.8                          | 10.5         | 1 3/8 X 2 3/8                     |
| 12,000                       | 550123U050AB2B         | 29.3              | 12.5          | 8.3                          | 12.7         | 1 3/8 X 3 1/8                     |

# Type 550 105 °C High Ripple, Long-life, Inverter Grade, Aluminum

| Cap.<br>(µF)                             | Catalog<br>Part Number | ESR Max<br>@ 25°C |               | Ripple Current<br>Max @ 85°C |              | Nominal<br>Size<br>D x L<br>(in.) | Cap.<br>(µF)                   | Catalog<br>Part Number | ESR Max<br>@ 25°C |               | Ripple Current<br>Max @ 85°C |              | Nominal<br>Size<br>D x L<br>(in.) |
|--|------------------------|-------------------|---------------|------------------------------|--------------|-----------------------------------|--------------------------------|------------------------|-------------------|---------------|------------------------------|--------------|-----------------------------------|
|  |                        | 120Hz<br>(mΩ)     | 20kHz<br>(mΩ) | 120Hz<br>(A)                 | 20kHz<br>(A) |                                   |                                |                        | 120Hz<br>(mΩ)     | 20kHz<br>(mΩ) | 120Hz<br>(A)                 | 20kHz<br>(A) |                                   |
| <b>50 Vdc (65 Vdc Surge) (continued)</b> |                        |                   |               |                              |              |                                   |                                |                        |                   |               |                              |              |                                   |
| 17,000                                   | 550173U050AC2B         | 21.0              | 9.3           | 11.0                         | 16.5         | 1 3/8 X 4 1/8                     | 31,000                         | 550313U100CF2B         | 8.8               | 6.5           | 27.1                         | 31.6         | 2 1/2 X 5 5/8                     |
| 25,000                                   | 550253U050AF2B         | 15.2              | 7.2           | 14.7                         | 21.3         | 1 3/8 X 5 5/8                     | 31,000                         | 550313U100DC2B         | 11.7              | 9.3           | 23.6                         | 28.3         | 3 X 4 1/8                         |
| 25,000                                   | 550253U050BB2B         | 15.7              | 7.4           | 14.1                         | 20.5         | 2 X 3 1/8                         | 42,000                         | 550423U100DE2B         | 9.0               | 7.2           | 28.8                         | 33.7         | 3 X 5 1/8                         |
| 37,000                                   | 550373U050BC2B         | 10.8              | 5.3           | 18.8                         | 27.0         | 2 X 4 1/8                         | 47,000                         | 550473U100DF2D         | 8.1               | 6.5           | 31.4                         | 35.0         | 3 X 5 5/8                         |
| 55,000                                   | 550553U050BF2B         | 7.7               | 4.0           | 25.0                         | 34.7         | 2 X 5 5/8                         | 49,000                         | 550493U100DP2D         | 7.7               | 6.2           | 32.8                         | 36.5         | 3 X 5 5/8                         |
| 61,000                                   | 550613U050CC2B         | 7.0               | 3.6           | 26.9                         | 37.5         | 2 1/2 X 4 1/8                     | 68,000                         | 550683U100DG2D         | 10.1              | 6.1           | 33.8                         | 43.6         | 3 X 8 5/8                         |
| 91,000                                   | 550913U050CF2D         | 4.9               | 2.6           | 36.5                         | 49.7         | 2 1/2 X 5 5/8                     | <b>200 Vdc - 250 Vdc Surge</b> |                        |                   |               |                              |              |                                   |
| 91,000                                   | 550913U050DC2D         | 5.9               | 3.7           | 33.2                         | 42.1         | 3 X 4 1/8                         | 320                            | 550321T200AK2B         | 295.0             | 189.0         | 2.8                          | 4.2          | 1 3/8 X 1 5/8                     |
| 120,000                                  | 550124U050DE2D         | 4.6               | 2.9           | 40.3                         | 50.6         | 3 X 5 1/8                         | 520                            | 550521T200AA2B         | 181.0             | 116.0         | 3.8                          | 5.7          | 1 3/8 X 2 1/8                     |
| 140,000                                  | 550144U050DF2D         | 4.2               | 2.7           | 43.8                         | 54.7         | 3 X 5 5/8                         | 750                            | 550751T200AH2B         | 125.0             | 80.8          | 4.9                          | 7.3          | 1 3/8 X 2 5/8                     |
| 140,000                                  | 550144U050DP2D         | 4.0               | 2.6           | 45.7                         | 50.0         | 3 X 5 5/8                         | 980                            | 550981T200AB2B         | 96.2              | 60.0          | 5.7                          | 8.5          | 1 3/8 X 3 1/8                     |
| 220,000                                  | 550224U050DG2D         | 3.8               | 2.5           | 50.0                         | 50.0         | 3 X 8 5/8                         | 1,200                          | 550122T200AC2B         | 78.3              | 48.9          | 7.1                          | 10.4         | 1 3/8 X 4 1/8                     |
| <b>75 Vdc (100 Vdc Surge)</b>            |                        |                   |               |                              |              |                                   |                                |                        |                   |               |                              |              |                                   |
| 2,300                                    | 550232U075AK2B         | 114.0             | 74.0          | 3.3                          | 4.6          | 1 3/8 X 1 5/8                     | 1,400                          | 550142T200AF2B         | 66.1              | 40.2          | 8.5                          | 12.2         | 1 3/8 X 5 5/8                     |
| 3,800                                    | 550382U075AA2B         | 69.1              | 44.8          | 4.6                          | 6.4          | 1 3/8 X 2 1/8                     | 2,000                          | 550202T200BB2B         | 51.2              | 32.6          | 9.9                          | 14.0         | 2 X 3 1/8                         |
| 5,300                                    | 550532U075AH2B         | 49.8              | 32.4          | 5.9                          | 8.1          | 1 3/8 X 2 5/8                     | 3,000                          | 550302T200BC2B         | 33.7              | 21.6          | 12.6                         | 17.6         | 2 X 4 1/8                         |
| 6,900                                    | 550692U075AB2B         | 39.1              | 25.6          | 7.2                          | 9.6          | 1 3/8 X 3 1/8                     | 4,600                          | 550462T200BF2B         | 22.6              | 14.6          | 15.4                         | 21.1         | 2 X 5 5/8                         |
| 9,900                                    | 550992U075AC2B         | 27.7              | 18.4          | 9.5                          | 12.0         | 1 3/8 X 4 1/8                     | 5,000                          | 550502T200CC2B         | 21.2              | 13.8          | 18.3                         | 24.6         | 2 1/2 X 4 1/8                     |
| 14,000                                   | 550143U075BB2B         | 26.2              | 19.6          | 10.9                         | 14.4         | 2 X 3 1/8                         | 7,500                          | 550752T200DC2B         | 17.5              | 12.6          | 21.8                         | 27.0         | 3 X 4 1/8                         |
| 15,000                                   | 550153U075AF2B         | 19.8              | 13.4          | 12.9                         | 15.6         | 1 3/8 X 5 5/8                     | 7,600                          | 550762T200CF2B         | 14.2              | 9.2           | 22.5                         | 29.8         | 2 1/2 X 5 5/8                     |
| 21,000                                   | 550213U075BC2B         | 18.0              | 13.6          | 14.6                         | 18.8         | 2 X 4 1/8                         | 10,000                         | 550103T200DE2B         | 13.3              | 9.2           | 25.5                         | 31.3         | 3 X 5 1/8                         |
| 31,000                                   | 550313U075BF2B         | 12.7              | 9.8           | 19.5                         | 22.2         | 2 X 5 5/8                         | 11,000                         | 550113T200DF2B         | 11.8              | 8.3           | 27.0                         | 33.0         | 3 X 5 5/8                         |
| 35,000                                   | 550353U075CC2B         | 12.2              | 8.8           | 20.3                         | 25.3         | 2 1/2 X 4 1/8                     | 12,000                         | 550123T200DP2B         | 11.2              | 8.1           | 27.4                         | 33.4         | 3 X 5 5/8                         |
| 52,000                                   | 550523U075CF2B         | 8.5               | 6.1           | 27.7                         | 32.5         | 2 1/2 X 5 5/8                     | 19,000                         | 550193T200DG2B         | 13.0              | 11.0          | 25.1                         | 27.0         | 3 X 8 5/8                         |
| 52,000                                   | 550523U075DC2B         | 11.2              | 9.4           | 24.1                         | 28.3         | 3 X 4 1/8                         | <b>250 Vdc - 300 Vdc Surge</b> |                        |                   |               |                              |              |                                   |
| 69,000                                   | 550693U075DE2B         | 8.6               | 7.2           | 29.5                         | 33.7         | 3 X 5 1/8                         | 260                            | 550261T250AK2B         | 341.0             | 196.0         | 2.8                          | 4.2          | 1 3/8 X 1 5/8                     |
| 77,000                                   | 550773U075DF2D         | 7.7               | 6.5           | 32.1                         | 36.7         | 3 X 5 5/8                         | 420                            | 550421T250AA2B         | 209.0             | 120.0         | 3.6                          | 5.6          | 1 3/8 X 2 1/8                     |
| 82,000                                   | 550823U075DP2D         | 7.4               | 6.3           | 33.6                         | 38.3         | 3 X 5 5/8                         | 610                            | 550611T250AH2B         | 145.0             | 81.8          | 4.6                          | 7.2          | 1 3/8 X 2 5/8                     |
| 110,000                                  | 550114U075DG2D         | 9.8               | 6.1           | 34.4                         | 45.6         | 3 X 8 5/8                         | 800                            | 550801T250AB2B         | 104.0             | 60.7          | 5.5                          | 8.4          | 1 3/8 X 3 1/8                     |
| <b>100 Vdc (125 Vdc Surge)</b>           |                        |                   |               |                              |              |                                   |                                |                        |                   |               |                              |              |                                   |
| 1,400                                    | 550142U100AK2B         | 140.0             | 87.3          | 2.9                          | 4.3          | 1 3/8 X 1 5/8                     | 990                            | 550991T250AJ2B         | 84.7              | 52.6          | 6.3                          | 9.7          | 1 3/8 X 3 5/8                     |
| 2,300                                    | 550232U100AA2B         | 84.4              | 52.8          | 4.2                          | 6.0          | 1 3/8 X 2 1/8                     | 1,200                          | 550122T250AC2B         | 71.5              | 42.0          | 6.8                          | 10.4         | 1 3/8 X 4 1/8                     |
| 3,200                                    | 550322U100AH2B         | 60.7              | 38.1          | 5.3                          | 7.5          | 1 3/8 X 2 5/8                     | 1,600                          | 550162T250AE2B         | 54.8              | 32.5          | 8.2                          | 15.3         | 1 3/8 X 5 1/8                     |
| 4,200                                    | 550422U100AB2B         | 47.6              | 30.0          | 6.5                          | 8.9          | 1 3/8 X 3 1/8                     | 1,700                          | 550172T250AF2B         | 49.2              | 29.3          | 8.2                          | 12.1         | 1 3/8 X 5 5/8                     |
| 6,000                                    | 550602U100AC2B         | 33.6              | 21.4          | 8.7                          | 10.8         | 1 3/8 X 4 1/8                     | 1,600                          | 550162T250BB2B         | 56.8              | 33.0          | 9.3                          | 13.8         | 2 X 3 1/8                         |
| 8,500                                    | 550852U100BB2B         | 29.7              | 21.0          | 10.3                         | 14.2         | 2 X 3 1/8                         | 2,500                          | 550252T250BC2B         | 36.1              | 21.8          | 11.9                         | 17.4         | 2 X 4 1/8                         |
| 8,800                                    | 550882U100AF2B         | 26.2              | 15.5          | 11.2                         | 14.5         | 1 3/8 X 5 5/8                     | 3,800                          | 550382T250BF2B         | 24.1              | 14.8          | 14.5                         | 21.0         | 2 X 5 5/8                         |
| 13,000                                   | 550133U100BC2B         | 20.3              | 14.5          | 13.8                         | 18.2         | 2 X 4 1/8                         | 4,100                          | 550412T250CC2B         | 24.2              | 14.0          | 14.5                         | 20.9         | 2 1/2 X 4 1/8                     |
| 19,000                                   | 550193U100BF2B         | 14.2              | 10.4          | 18.4                         | 22.6         | 2 X 5 5/8                         | 6,200                          | 550622T250CF2B         | 15.2              | 9.3           | 21.4                         | 29.5         | 2 1/2 X 5 5/8                     |
| 21,000                                   | 550213U100CC2B         | 12.8              | 9.3           | 19.9                         | 25.6         | 2 1/2 X 4 1/8                     | 6,100                          | 550612T250DC2B         | 19.8              | 12.7          | 21.0                         | 26.9         | 3 X 4 1/8                         |
|  |                        |                   |               |                              |              |                                   | 8,200                          | 550822T250DE2B         | 14.0              | 9.3           | 24.5                         | 31.1         | 3 X 5 1/8                         |
|  |                        |                   |               |                              |              |                                   | 9,300                          | 550932T250DF2B         | 12.0              | 8.4           | 25.9                         | 32.8         | 3 X 5 5/8                         |

# Type 550 105 °C High Ripple, Long-life, Inverter Grade, Aluminum

| Cap.<br>( $\mu$ F)             | Catalog<br>Part Number | ESR Max<br>@ 25°C |               | Ripple Current<br>Max @ 85°C |       | Nominal<br>Size<br>D x L<br>(in.) |
|--------------------------------|------------------------|-------------------|---------------|------------------------------|-------|-----------------------------------|
|                                |                        | 120Hz             | 20kHz         | 120Hz                        | 20kHz |                                   |
|                                |                        | (m $\Omega$ )     | (m $\Omega$ ) | (A)                          | (A)   |                                   |
| <b>300 Vdc (350 Vdc Surge)</b> |                        |                   |               |                              |       |                                   |
| 190                            | 550191T300AK2B         | 625.0             | 414.0         | 2.1                          | 3.3   | 1 3/8 X 1 5/8                     |
| 310                            | 550311T300AA2B         | 382.0             | 253.0         | 2.9                          | 4.5   | 1 3/8 X 2 1/8                     |
| 440                            | 550441T300AH2B         | 260.0             | 176.0         | 3.7                          | 5.7   | 1 3/8 X 2 5/8                     |
| 580                            | 550581T300AB2B         | 190.0             | 135.0         | 4.4                          | 6.7   | 1 3/8 X 3 1/8                     |
| 720                            | 550721T300AC2B         | 154.0             | 103.0         | 5.0                          | 7.8   | 1 3/8 X 4 1/8                     |
| 850                            | 550851T300AF2B         | 130.0             | 87.0          | 5.5                          | 8.5   | 1 3/8 X 5 5/8                     |
| 1,200                          | 550122T300BB2B         | 101.0             | 69.8          | 7.7                          | 11.6  | 2 X 3 1/8                         |
| 1,800                          | 550182T300BC2B         | 66.0              | 43.0          | 9.9                          | 14.9  | 2 X 4 1/8                         |
| 2,700                          | 550272T300BF2B         | 43.8              | 28.7          | 11.9                         | 17.8  | 2 X 5 5/8                         |
| 3,000                          | 550302T300CC2B         | 45.7              | 31.7          | 14.5                         | 20.7  | 2 1/2 X 4 1/8                     |
| 4,500                          | 550452T300CF2B         | 30.1              | 20.2          | 18.0                         | 25.4  | 2 1/2 X 5 5/8                     |
| 4,400                          | 550442T300DC2B         | 30.6              | 21.2          | 18.2                         | 24.8  | 3 X 4 1/8                         |
| 5,900                          | 550592T300DE2B         | 22.9              | 15.9          | 22.1                         | 29.0  | 3 X 5 1/8                         |
| 6,700                          | 550672T300DF2B         | 20.4              | 14.2          | 22.6                         | 30.9  | 3 X 5 5/8                         |
| 7,100                          | 550712T300DP2B         | 19.3              | 14.0          | 23.2                         | 31.2  | 3 X 5 5/8                         |
| 11,000                         | 550113T300DG2B         | 17.1              | 14.8          | 26.0                         | 27.9  | 3 X 8 5/8                         |
| <b>350 Vdc (400 Vdc Surge)</b> |                        |                   |               |                              |       |                                   |
| 160                            | 550161T350AK2B         | 678.0             | 425.0         | 1.9                          | 3.1   | 1 3/8 X 1 5/8                     |
| 270                            | 550271T350AA2B         | 414.0             | 260.0         | 2.7                          | 4.3   | 1 3/8 X 2 1/8                     |
| 390                            | 550391T350AH2B         | 288.0             | 181.0         | 3.6                          | 5.4   | 1 3/8 X 2 5/8                     |
| 510                            | 550511T350AB2B         | 206.0             | 139.0         | 4.2                          | 6.4   | 1 3/8 X 3 1/8                     |
| 630                            | 550631T350AC2B         | 167.0             | 106.0         | 4.8                          | 7.7   | 1 3/8 X 4 1/8                     |
| 750                            | 550751T350AF2B         | 141.0             | 89.4          | 5.3                          | 8.4   | 1 3/8 X 5 5/8                     |
| 1,000                          | 550102T350BB2B         | 109.0             | 71.5          | 7.2                          | 11.1  | 2 X 3 1/8                         |
| 1,600                          | 550162T350BC2B         | 71.2              | 44.0          | 9.0                          | 13.9  | 2 X 4 1/8                         |
| 2,400                          | 550242T350BF2B         | 47.2              | 29.4          | 11.3                         | 17.6  | 2 X 5 5/8                         |
| 2,600                          | 550262T350CC2B         | 48.9              | 32.4          | 13.6                         | 20.7  | 2 1/2 X 4 1/8                     |
| 4,000                          | 550402T350CF2B         | 31.8              | 20.4          | 16.9                         | 24.9  | 2 1/2 X 5 5/8                     |
| 3,900                          | 550392T350DC2B         | 32.7              | 21.6          | 17.3                         | 24.5  | 3 X 4 1/8                         |
| 5,300                          | 550532T350DE2B         | 24.2              | 16.1          | 21.5                         | 28.8  | 3 X 5 1/8                         |
| 6,000                          | 550602T350DF2B         | 21.6              | 14.4          | 22.0                         | 30.7  | 3 X 5 5/8                         |
| 6,300                          | 550632T350DP2B         | 20.5              | 14.2          | 22.5                         | 31.0  | 3 X 5 5/8                         |
| 10,000                         | 550103T350DG2B         | 17.7              | 14.8          | 25.6                         | 27.9  | 3 X 8 5/8                         |

| Cap.<br>( $\mu$ F)             | Catalog<br>Part Number | ESR Max<br>@ 25°C |               | Ripple Current<br>Max @ 85°C |       | Nominal<br>Size<br>D x L<br>(in.) |
|--------------------------------|------------------------|-------------------|---------------|------------------------------|-------|-----------------------------------|
|                                |                        | 120Hz             | 20kHz         | 120Hz                        | 20kHz |                                   |
|                                |                        | (m $\Omega$ )     | (m $\Omega$ ) | (A)                          | (A)   |                                   |
| <b>400 Vdc (450 Vdc Surge)</b> |                        |                   |               |                              |       |                                   |
| 130                            | 550131T400AK2B         | 731.0             | 437.0         | 1.9                          | 3.1   | 1 3/8 X 1 5/8                     |
| 210                            | 550211T400AA2B         | 447.0             | 267.0         | 2.6                          | 4.2   | 1 3/8 X 2 1/8                     |
| 310                            | 550311T400AH2B         | 310.0             | 185.0         | 3.4                          | 5.3   | 1 3/8 X 2 5/8                     |
| 400                            | 550401T400AB2B         | 223.0             | 142.0         | 4.0                          | 6.3   | 1 3/8 X 3 1/8                     |
| 500                            | 550501T400AC2B         | 181.0             | 109.0         | 4.6                          | 7.6   | 1 3/8 X 4 1/8                     |
| 590                            | 550591T400AF2B         | 152.0             | 91.7          | 5.1                          | 8.3   | 1 3/8 X 5 5/8                     |
| 810                            | 550811T400BB2B         | 117.0             | 73.2          | 6.9                          | 10.9  | 2 X 3 1/8                         |
| 1,200                          | 550122T400BC2B         | 76.4              | 45.1          | 8.7                          | 13.7  | 2 X 4 1/8                         |
| 1,900                          | 550192T400BF2B         | 50.7              | 30.1          | 10.9                         | 17.4  | 2 X 5 5/8                         |
| 2,100                          | 550212T400CC2B         | 52.1              | 33.0          | 12.8                         | 19.6  | 2 1/2 X 4 1/8                     |
| 3,100                          | 550312T400CF2B         | 34.2              | 21.0          | 16.0                         | 24.3  | 2 1/2 X 5 5/8                     |
| 3,100                          | 550312T400DC2B         | 34.8              | 22.0          | 16.7                         | 24.3  | 3 X 4 1/8                         |
| 4,100                          | 550412T400DE2B         | 26.0              | 16.6          | 20.7                         | 28.5  | 3 X 5 1/8                         |
| 4,700                          | 550472T400DF2B         | 23.2              | 14.8          | 21.2                         | 30.3  | 3 X 5 5/8                         |
| 4,900                          | 550492T400DP2B         | 22.0              | 14.5          | 21.8                         | 30.6  | 3 X 5 5/8                         |
| 7,700                          | 550772T400DG2B         | 18.9              | 15.2          | 24.7                         | 27.6  | 3 X 8 5/8                         |
| <b>450 Vdc (500 Vdc Surge)</b> |                        |                   |               |                              |       |                                   |
| 90                             | 550900T450AK2B         | 941.0             | 553.0         | 1.1                          | 1.6   | 1 3/8 X 1 5/8                     |
| 150                            | 550151T450AA2B         | 570.0             | 338.0         | 1.6                          | 2.3   | 1 3/8 X 2 1/8                     |
| 210                            | 550211T450AH2B         | 399.0             | 234.0         | 2.1                          | 3.0   | 1 3/8 X 2 5/8                     |
| 280                            | 550281T450AB2B         | 305.0             | 180.0         | 2.6                          | 3.7   | 1 3/8 X 3 1/8                     |
| 350                            | 550351T450AC2B         | 247.0             | 146.0         | 3.2                          | 4.6   | 1 3/8 X 4 1/8                     |
| 410                            | 550411T450AF2B         | 208.0             | 123.0         | 4.0                          | 5.7   | 1 3/8 X 5 5/8                     |
| 560                            | 550561T450BB2B         | 157.0             | 95.1          | 4.5                          | 6.0   | 2 X 3 1/8                         |
| 870                            | 550871T450BC2B         | 103.0             | 62.3          | 6.1                          | 8.3   | 2 X 4 1/8                         |
| 1,300                          | 550132T450BF2B         | 68.0              | 41.4          | 8.4                          | 11.4  | 2 X 5 5/8                         |
| 1,400                          | 550142T450CC2B         | 67.8              | 43.1          | 8.6                          | 11.4  | 2 1/2 X 4 1/8                     |
| 2,200                          | 550222T450CF2B         | 45.0              | 28.8          | 12.0                         | 15.8  | 2 1/2 X 5 5/8                     |
| 2,100                          | 550212T450DC2B         | 52.1              | 35.6          | 11.2                         | 14.2  | 3 X 4 1/8                         |
| 2,900                          | 550292T450DE2B         | 39.0              | 26.8          | 13.8                         | 17.6  | 3 X 5 1/8                         |
| 3,200                          | 550322T450DF2B         | 34.7              | 23.9          | 15.2                         | 19.3  | 3 X 5 5/8                         |
| 3,400                          | 550342T450DP2B         | 32.9              | 22.7          | 15.6                         | 19.8  | 3 X 5 5/8                         |
| 5,400                          | 550542T450DG2B         | 21.7              | 15.2          | 23.1                         | 29.1  | 3 X 8 5/8                         |

## **Type 550 105 °C High Ripple, Long-life, Inverter Grade, Aluminum**

---

**Notice and Disclaimer:** All product drawings, descriptions, specifications, statements, information and data (collectively, the "Information") in this datasheet or other publication are subject to change. The customer is responsible for checking, confirming and verifying the extent to which the Information contained in this datasheet or other publication is applicable to an order at the time the order is placed. All Information given herein is believed to be accurate and reliable, but it is presented without any guarantee, warranty, representation or responsibility of any kind, expressed or implied. Statements of suitability for certain applications are based on the knowledge that the Cornell Dubilier company providing such statements ("Cornell Dubilier") has of operating conditions that such Cornell Dubilier company regards as typical for such applications, but are not intended to constitute any guarantee, warranty or representation regarding any such matter – and Cornell Dubilier specifically and expressly disclaims any guarantee, warranty or representation concerning the suitability for a specific customer application, use, storage, transportation, or operating environment. The Information is intended for use only by customers who have the requisite experience and capability to determine the correct products for their application. Any technical advice inferred from this Information or otherwise provided by Cornell Dubilier with reference to the use of any Cornell Dubilier products is given gratis (unless otherwise specified by Cornell Dubilier), and Cornell Dubilier assumes no obligation or liability for the advice given or results obtained. Although Cornell Dubilier strives to apply the most stringent quality and safety standards regarding the design and manufacturing of its products, in light of the current state of the art, isolated component failures may still occur. Accordingly, customer applications which require a high degree of reliability or safety should employ suitable designs or other safeguards (such as installation of protective circuitry or redundancies or other appropriate protective measures) in order to ensure that the failure of an electrical component does not result in a risk of personal injury or property damage. Although all product-related warnings, cautions and notes must be observed, the customer should not assume that all safety measures are indicated in such warnings, cautions and notes, or that other safety measures may not be required.



## X-ON Electronics

Largest Supplier of Electrical and Electronic Components

*Click to view similar products for Aluminium Electrolytic Capacitors - Screw Terminal category:*

*Click to view products by Cornell Dubilier manufacturer:*

Other Similar products are found below :

[A331FH221M500A](#) [A331FB472M063A](#) [A331FD153M040A](#) [A331FD682M063A](#) [A331LH223M063A](#) [A331PM682M200A](#)  
[36DA332F350CD2A](#) [ETOR401CTH902QEG8N](#) [C1808N680J302T](#) [A331PM472M250A](#) [500X822U450DG1B](#) [A331LH683M025A](#)  
[A331LM333M063A](#) [A331TW682M500A](#) [500332U050BB2B](#) [ALS31B1003NX](#) [E32D600LPN133TDA5M](#) [550152M200BC2B](#)  
[36DX253G075DC2A](#) [101C282U063AK2A](#) [DB301V-3.5-3P-GN](#) [DB301V-3.5-2P-GN](#) [WR479M1JT1LO5](#) [OBJ35](#) [OBJ35A](#)  
[WL338M2WU1AD6](#) [WL 10000U/100V](#) [WL 4700U/200V](#) [B43310A5109M000](#) [B43310C9228M000](#) [B43310A9828M000](#)  
[GT1H109M35060SB](#) [GT1H229M35100SB](#) [GT1J229M35120SB](#) [GT2A229M51100SB](#) [GT2W227M35060SB](#) [GT2W228M64120SB](#)  
[WR229M1JS80O5](#) [WR188M2WS1MO5](#) [WL158M2WS1AO5](#) [WR478M2WU1PD6](#) [2738](#) [ALS30A151DB500](#) [ALS30A152KF350](#)  
[ALS30A682DF100](#) [ALS31A103DE063](#) [ALS40A223DB025](#) [ALS40A223KF063](#) [ALS40A472DF100](#) [ALS40A473DF025](#)