

# Din rail Attachment Plate

## APPLICABLE TO MODEL

Din rail width : 35mm

Plate model	FD-A	FD-B
Model	P30, P50 R50A, PAA50 RMB30A, RMC30A	P15, MMC8A R10A, R15A, R25A RMB15A, RMC15A

## EXTERNAL VIEW

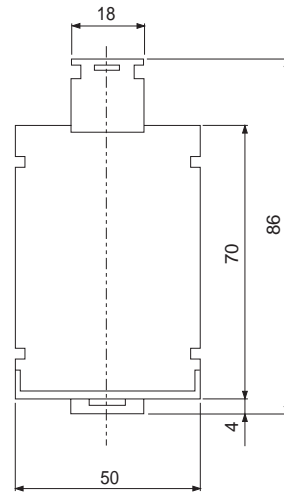
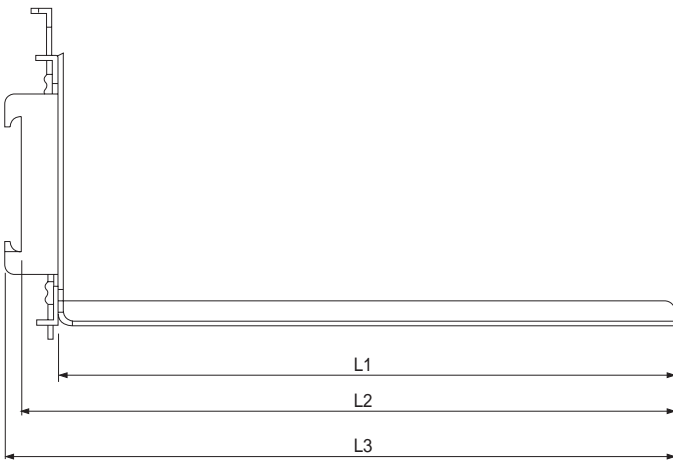

(Unit : mm)

Model	L1	L2	L3
FD-A	165	174.5	178.6
FD-B	115	124.5	128.6

★ Material : SPCC  
★ Thickness : 1.6  
★ Tolerance : ±1

## DIN RAIL ATTACHMENT MODEL : FD-SP

## MOUNTING EXAMPLE

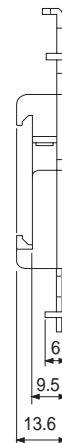
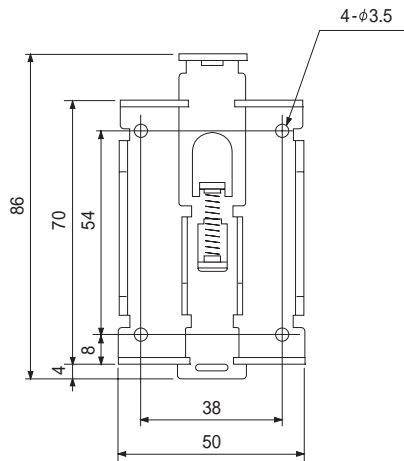
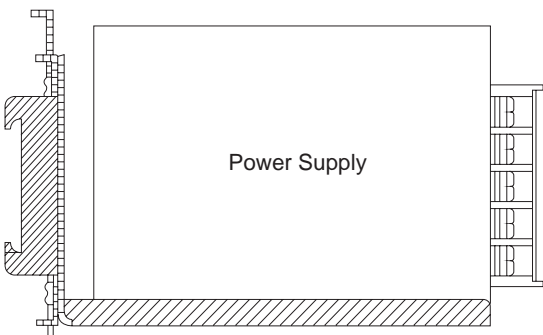

★ Material : SPCC  
★ Thickness : 1.6  
★ Tolerance : ±1

## ■ Din rail Attachment Plate(PB Series)

### APPLICABLE TO MODEL

Din rail width : 35mm

Plate model	Model
FD-PBA10	PBA10F
FD-PBA15	PBA15F, PBW15F
FD-PBA30	PBA30F, PBW30F
FD-PBA50	PBA50F, PBW50F, PBA75F
FD-PBA100	PBA100F, PBA150F
FD-PBA300	PBA300F

### FD-PBA10, FD-PBA15, FD-PBA30 EXTERNAL VIEW

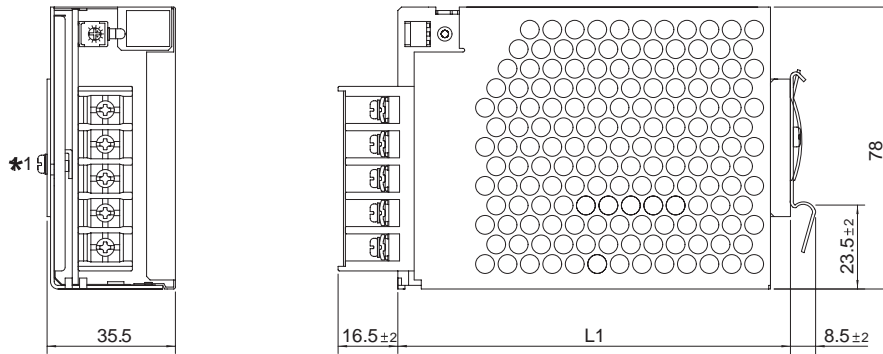

Plate model	Model	L1
FD-PBA10	PBA10F	73.5±2
FD-PBA15	PBA15F, PBW15F	90.5±2
FD-PBA30	PBA30F, PBW30F	108.5±2

- \* Material : SECC
- \* Thickness : 1.0
- \* Tolerance : ±1
- \*1 Two screws of M3 are necessary for installation

FD-PBA50, FD-PBA100  
EXTERNAL VIEW

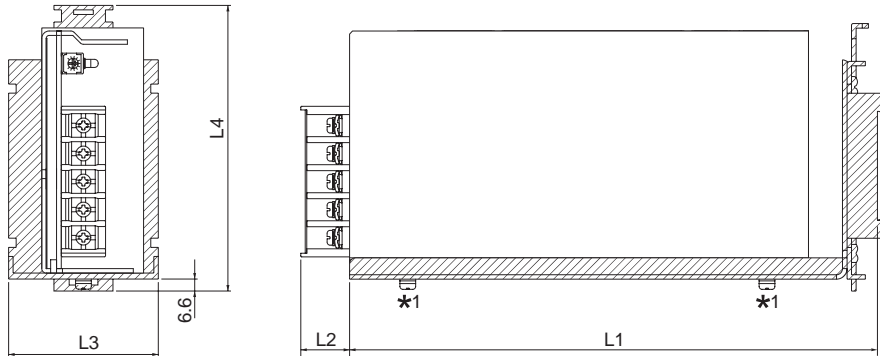

Plate model	Model	L1	L2	L3	L4
FD-PBA50	PBA50F	135	16.5±2	41	102.5
	PBA75F	150			
FD-PBA100	PBA100F	162	13.5±2	42.5	112
	PBA150F	183			

\* Material : SECC  
 \* Thickness : 1.6  
 \* Tolerance : ±1  
 \*1 Two screws of M3 are necessary for installation

FD-PBA300  
EXTERNAL VIEW

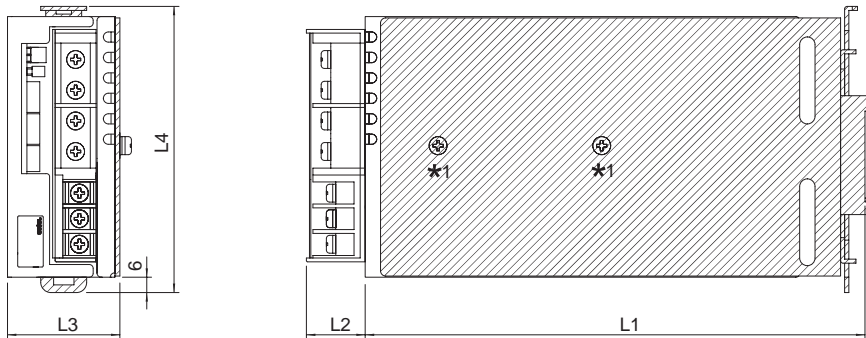

Plate model	Model	L1	L2	L3	L4
FD-PBA300	PBA300F	195.5	25max	44	112

\* Material : SPHC  
 \* Thickness : 2.0  
 \* Tolerance : ±1  
 \*1 Two screws of M4 are necessary for installation

## X-ON Electronics

Largest Supplier of Electrical and Electronic Components

*Click to view similar products for [Mounting Fixings](#) category:*

*Click to view products by [Cosel](#) manufacturer:*

Other Similar products are found below :

[5912235-2](#) [007541](#) [627](#) [M3783-7001](#) [71-074914-006](#) [75-69211-3P](#) [75-69214-6P](#) [75-69220-27S](#) [75-69224-5S](#) [7717-8DAP](#) [85047GULPT](#)  
[85048GBESR](#) [FPK-02-R10](#) [PMS27488-001-01](#) [1-18023-0](#) [H-118-2](#) [DB1](#) [1302030464](#) [DC37-22-21PX](#) [1302010957](#) [1302263564](#)  
[1302340393](#) [1404-0016-78](#) [14540](#) [1561-60](#) [1566](#) [1566](#) [BR16A](#) [NT20SATT01](#) [22594-8](#) [KBB-141](#) [89078GBEPR](#) [915060](#) [SF4011-60101](#)  
[97-CS-50](#) [1671](#) [1855-54](#) [T-2085-SP](#) [20800240002](#) [21899-4](#) [2193](#) [2518](#) [25745-1](#) [H-118-1](#) [354467](#) [37184](#) [4658](#) [4665](#) [4731](#) [BRACKET-RA-](#)  
[30](#)