

Cooper Crouse-Hinds®

LIQUIDTIGHT FITTINGS

- *LiQuik™ Series – no disassembly required!*
- *Liquidator™ Series*
- *Low Profile Series*
- *Zinc Die Cast Series*
- *Non-Metallic Liquidtight Series*



LIQUIDTIGHT FITTINGS

LiQuik™ Series • Liquidator™ Series • Low Profile Series • Zinc Die Cast Series • Non-Metallic Series • Class I, Division 2 • Class II, Divisions 1 & 2 • Class III, Divisions 1 & 2



Cooper Crouse-Hinds® liquidtight product line offers high-quality, high-performance fittings. Designed to the toughest standards and integrating the latest technology, not only do you get a reliable and durable product, you also get one that reduces installation time and cost. Our versatile lines of liquidtight fittings are designed for a wide range of applications. Choose from our Liquidator, LiQuik, Zinc Die Cast, Non-Metallic or Low Profile liquidtight fittings. Whatever your needs are, you can be assured that our liquidtight fittings will stand up to the most demanding, wet or corrosive environments.



Liquidtight fittings come in a wide range of sizes in straight, 45° and 90° styles. They are available in steel, aluminum, zinc die cast or non-metallic with or without insulated throats and aluminum or copper grounding lugs.

Applications

Typical applications for liquidtight conduit and liquidtight fittings include the wiring of machine tools, motors, transformers, food processing equipment, robotics, air conditioning units, illuminated store front signs and billboards, etc. The flexible metallic conduit and fittings protect conductors from mechanical damage due to vibration and movement, and seal out cutting oils, coolants, water, dust, etc. Applications such as these can be found in, but are not limited to, industries such as:

- machine tool manufacturers
- electric power generating plants
- waste treatment facilities
- paint manufacturing facilities
- automobile manufacturing facilities
- aerospace industries
- breweries
- food processing plants
- dairies
- pulp and paper mills
- petroleum refineries
- chemical and petrochemical plants

Certifications & Compliances

- UL Listed liquidtight flexible metal conduit fittings are suitable for use in the following hazardous locations under NEC, Class I, Division 2; Class II, Division 1 and 2; and Class III, Division 1 and 2, and are suitable for grounding in sizes 3/8" through 1-1/4" under NEC.
- UL Standards: 514B, 467
- cUL Standard: C22.2 No. 18F

Features & Benefits

| Product Features | User Benefits |
|---|--|
| <ul style="list-style-type: none"> • UL Listed, cUL Certified. | <ul style="list-style-type: none"> • Assurance of safe and reliable performance. End user peace of mind. |
| <ul style="list-style-type: none"> • Provides protection in wet locations. | <ul style="list-style-type: none"> • Meets NEC and UL requirements for use in wet locations. Reduces downtime and replacement costs. |
| <ul style="list-style-type: none"> • Available in various configurations in various trade sizes and materials. | <ul style="list-style-type: none"> • Complete selection of styles and sizes. Easy selection from one source, saves time and money. |
| <ul style="list-style-type: none"> • Hex surfaces on gland nut and body. | <ul style="list-style-type: none"> • Easy wrenching. Fast, easy installation results in labor savings. |
| <ul style="list-style-type: none"> • Thermoplastic elastomer sealing gasket effectively seals out water, oil, dust and dirt. | <ul style="list-style-type: none"> • Eliminates leakage, potential downtime and replacement costs. |
| <ul style="list-style-type: none"> • Lock nut bites into box. | <ul style="list-style-type: none"> • Provides a reliable ground and safety of personnel and equipment. Won't vibrate loose. |
| <ul style="list-style-type: none"> • Cupped long grounding ferrule is distortion-free. | <ul style="list-style-type: none"> • Provides excellent pullout strength, prevents conduit popout and provides grounding for safety of personnel and equipment. |

Liquidtight Fittings Selection Chart

| Family | Material | Size/Range | Configurations | Typical Applications | For More Details |
|---------------------------|----------------------|------------|--------------------|--|------------------|
| Liquidator | Malleable Iron | 3/8"–6" | Straight, 45°, 90° | Tough, industrial, corrosive for STANDARD APPLICATIONS | See page 4 & 5 |
| Liquidator Aluminum LT-SA | Copper-free Aluminum | 3/8"–4" | Straight & 90°* | Tough, industrial, corrosive applications where ALUMINUM MATERIAL PREFERRED | See page 4 & 5 |
| LTK Low Profile | Steel/Malleable Iron | 3/8"–2" | Straight, 45°, 90° | Tough, industrial, corrosive applications with SPACE RESTRICTIONS | See page 8 |
| LTQ LiQuik | Malleable Iron | 3/8"–2" | Straight | Tough, industrial, corrosive applications needing NO DISASSEMBLY INSTALLATIONS | See page 3 |
| LTDC Zinc Die Cast | Zinc Die Cast | 3/8"–4" | Straight & 90° | Tough, industrial, corrosive applications where ZINC DIE CAST MATERIAL PREFERRED | See page 6 |
| LTNM Non-Metallic | Nylon | 1/2"–1" | Straight & 90° | Tough, industrial, corrosive for use with NON-METALLIC TYPE B LIQUIDTIGHT CONDUIT | See page 7 |

* 90° LT-SA available in 3/8"–2" only

LIQUIK™ LIQUIDTIGHT FITTINGS

No disassembly required! The Cooper Crouse-Hinds LiQuik liquidtight fittings are quick and easy to install in just 2 steps, offering huge labor saving potential. Available in trade sizes 3/8" – 2" straight insulated or non-insulated.

Traditional Assembly Installation

1. Slide nut over conduit.



2. Slide compression ring over conduit.



3. Thread ferrule inside the conduit.



4. Slide the conduit assembly inside body.



5. Slide compression nut and ring toward the connector.



6. Tighten the nut.



New LiQuik Assembly Installation In Just 2 Steps:

1. Slide conduit inside the fully assembled connector.



2. Turn the connector assembly or the conduit until the ferrule threads engage the spirals in the conduit. The pins in the ferrule are locked inside the holes in the connector body, preventing the ferrule from turning. Tighten the nut against the connector.



Done!

Ordering & Dimensional Information

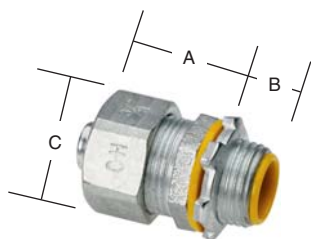
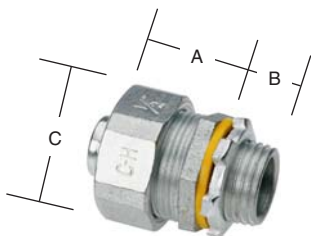

LiQuik Liquidtight Fittings — malleable iron, straight, non-insulated

| Catalog Number | Trade Size | KO Size | A | Dimensions B | C |
|----------------|------------|---------|---------|--------------|----------|
| LTQ38 | 3/8" | 1/2" | 1 1/8" | 1/2" | 1 1/8" |
| LTQ50 | 1/2" | 1/2" | 1 1/4" | 1/2" | 1 1/4" |
| LTQ75 | 3/4" | 3/4" | 1 1/4" | 1/2" | 1 9/16" |
| LTQ100 | 1" | 1" | 1 7/16" | 5/8" | 1 13/16" |
| LTQ125 | 1 1/4" | 1 1/4" | 1 1/2" | 11/16" | 2 1/4" |
| LTQ150 | 1 1/2" | 1 1/2" | 1 5/8" | 3/4" | 2 7/16" |
| LTQ200 | 2" | 2" | 1 3/4" | 3/4" | 3" |

LiQuik Liquidtight Fittings — malleable iron, straight, insulated

| Catalog Number | Trade Size | KO Size | A | Dimensions B | C |
|----------------|------------|---------|---------|--------------|----------|
| LTQB38 | 3/8" | 1/2" | 1 1/8" | 9/16" | 1 1/8" |
| LTQB50 | 1/2" | 1/2" | 1 1/4" | 9/16" | 1 1/4" |
| LTQB75 | 3/4" | 3/4" | 1 1/4" | 9/16" | 1 9/16" |
| LTQB100 | 1" | 1" | 1 7/16" | 11/16" | 1 13/16" |
| LTQB125 | 1 1/4" | 1 1/4" | 1 1/2" | 3/4" | 2 1/4" |
| LTQB150 | 1 1/2" | 1 1/2" | 1 5/8" | 13/16" | 2 7/16" |
| LTQB200 | 2" | 2" | 1 3/4" | 13/16" | 3" |



LIQUIDATOR™ LIQUIDTIGHT FITTINGS

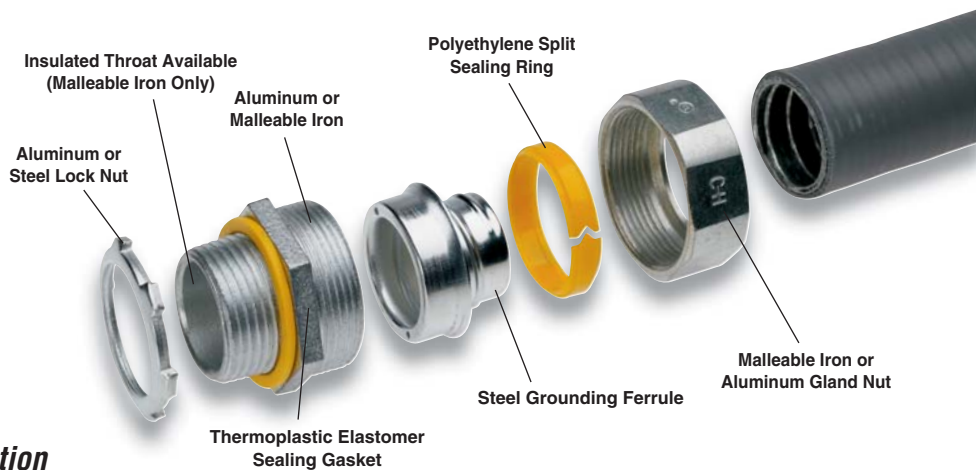

Ordering Information

Straight Connectors



| Malleable Iron | | | | | | | Aluminum | |
|----------------|------------------------|--------------------|--|--|--|-----------|---------------------------------|--|
| Conduit Size | Non-Insulated Cat. No. | Insulated Cat. No. | Non-Insulated with Aluminum Grounding Lug Cat. No. | Insulated with Aluminum Grounding Lug Cat. No. | Insulated with Copper Grounding Lug Cat. No. | Lug Size | Non-Insulated Aluminum Cat. No. | Non-Insulated with Aluminum Grounding Lug Cat. No. |
| 3/8" | LT38 | LTB38 | LT38G | LTB38G | LTB38GC | #4-#14 | LT38-SA | LT38G-SA |
| 1/2" | LT50 | LTB50 | LT50G | LTB50G | LTB50GC | #4-#14 | LT50-SA | LT50G-SA |
| 3/4" | LT75 | LTB75 | LT75G | LTB75G | LTB75GC | #4-#14 | LT75-SA | LT75G-SA |
| 1" | LT100 | LTB100 | LT100G | LTB100G | LTB100GC | #4-#14 | LT100-SA | LT100G-SA |
| 1 1/4" | LT125 | LTB125 | LT125G | LTB125G | LTB125GC | #4-#14 | LT125-SA | LT125G-SA |
| 1 1/2" | LT150 | LTB150 | LT150G | LTB150G | LTB150GC | #4-#14 | LT150-SA | LT150G-SA |
| 2" | LT200 | LTB200 | LT200G | LTB200G | LTB200GC | #4-#14 | LT200-SA | LT200G-SA |
| 2 1/2" | LT250 | LTB250 | LT250G | LTB250G | LTB250GC | #1/0-#8 | LT250-SA | LT250G-SA |
| 3" | LT300 | LTB300 | LT300G | LTB300G | LTB300GC | #1/0-#8 | LT300-SA | LT300G-SA |
| 3 1/2" | LT350 | LTB350 | LT350G | LTB350G | LTB350GC | #3/0-#6 | LT350-SA | LT350G-SA |
| 4" | LT400 | LTB400 | LT400G | LTB400G | LTB400GC | #3/0-#6 | LT400-SA | LT400G-SA |
| 5" | LT500 | LTB500 | LT500G | LTB500G | — | 250MCM-#6 | — | — |
| 6" | LT600 | LTB600 | LT600G | LTB600G | — | 250MCM-#6 | — | — |

45° Angle Connectors



| Malleable Iron | | | | | | | Aluminum | |
|----------------|------------------------|--------------------|--|--|--|----------|---------------------------------|--|
| Conduit Size | Non-Insulated Cat. No. | Insulated Cat. No. | Non-Insulated with Aluminum Grounding Lug Cat. No. | Insulated with Aluminum Grounding Lug Cat. No. | Insulated with Copper Grounding Lug Cat. No. | Lug Size | Non-Insulated Aluminum Cat. No. | |
| 3/8" | LT3845 | LTB3845 | LT3845G | LTB3845G | LTB3845GC | #4-#14 | — | |
| 1/2" | LT5045 | LTB5045 | LT5045G | LTB5045G | LTB5045GC | #4-#14 | — | |
| 3/4" | LT7545 | LTB7545 | LT7545G | LTB7545G | LTB7545GC | #4-#14 | — | |
| 1" | LT10045 | LTB10045 | LT10045G | LTB10045G | LTB10045GC | #4-#14 | — | |
| 1 1/4" | LT12545 | LTB12545 | LT12545G | LTB12545G | LTB12545GC | #4-#14 | — | |
| 1 1/2" | LT15045 | LTB15045 | LT15045G | LTB15045G | LTB15045GC | #4-#14 | — | |
| 2" | LT20045 | LTB20045 | LT20045G | LTB20045G | LTB20045GC | #4-#14 | — | |
| 2 1/2" | LT25045 | LTB25045 | LT25045G | LTB25045G | LTB25045GC | #1/0-#8 | — | |
| 3" | LT30045 | LTB30045 | LT30045G | LTB30045G | LTB30045GC | #1/0-#8 | — | |
| 3 1/2" | LT35045 | LTB35045 | LT35045G | LTB35045G | LTB35045GC | #3/0-#6 | — | |
| 4" | LT40045 | LTB40045 | LT40045G | LTB40045G | LTB40045GC | #3/0-#6 | — | |

90° Angle Connectors



| Malleable Iron | | | | | | | Aluminum | |
|----------------|------------------------|--------------------|--|--|--|----------|---------------------------------|--|
| Conduit Size | Non-Insulated Cat. No. | Insulated Cat. No. | Non-Insulated with Aluminum Grounding Lug Cat. No. | Insulated with Aluminum Grounding Lug Cat. No. | Insulated with Copper Grounding Lug Cat. No. | Lug Size | Non-Insulated Aluminum Cat. No. | Non-Insulated with Aluminum Grounding Lug Cat. No. |
| 3/8" | LT3890 | LTB3890 | LT3890G | LTB3890G | LTB3890GC | #4-#14 | LT3890-SA | LT3890G-SA |
| 1/2" | LT5090 | LTB5090 | LT5090G | LTB5090G | LTB5090GC | #4-#14 | LT5090-SA | LT5090G-SA |
| 3/4" | LT7590 | LTB7590 | LT7590G | LTB7590G | LTB7590GC | #4-#14 | LT7590-SA | LT7590G-SA |
| 1" | LT10090 | LTB10090 | LT10090G | LTB10090G | LTB10090GC | #4-#14 | LT10090-SA | LT10090G-SA |
| 1 1/4" | LT12590 | LTB12590 | LT12590G | LTB12590G | LTB12590GC | #4-#14 | LT12590-SA | LT12590G-SA |
| 1 1/2" | LT15090 | LTB15090 | LT15090G | LTB15090G | LTB15090GC | #4-#14 | LT15090-SA | LT15090G-SA |
| 2" | LT20090 | LTB20090 | LT20090G | LTB20090G | LTB20090GC | #4-#14 | LT20090-SA | LT20090G-SA |
| 2 1/2" | LT25090 | LTB25090 | LT25090G | LTB25090G | LTB25090GC | #1/0-#8 | — | — |
| 3" | LT30090 | LTB30090 | LT30090G | LTB30090G | LTB30090GC | #1/0-#8 | — | — |
| 3 1/2" | LT35090 | LTB35090 | LT35090G | LTB35090G | LTB35090GC | #3/0-#6 | — | — |
| 4" | LT40090 | LTB40090 | LT40090G | LTB40090G | LTB40090GC | #3/0-#6 | — | — |

LIQUIDATOR™ LIQUIDTIGHT FITTINGS

Dimensions (in inches)

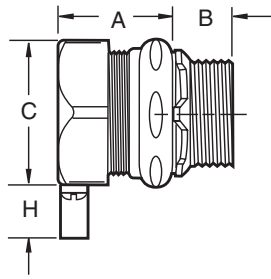

Straight

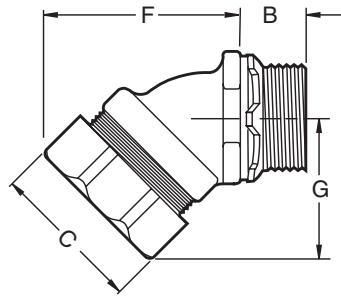

45°

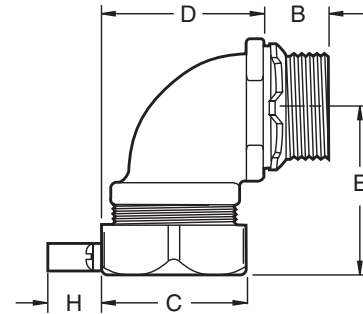

90°



Non-Insulated Malleable Iron

| Conduit/NPT Size | Dimensions | | | | | | | |
|------------------|------------|---------|----------|----------|----------|----------|----------|----------|
| | A | B | C | D | E | F | G | H |
| 3/8" | 1 1/8" | 1/2" | 1 1/8" | 1 5/16" | 1 5/8" | 1 15/16" | 1 1/2" | 3/4" |
| 1/2" | 1 1/4" | 1/2" | 1 1/4" | 1 7/16" | 1 5/8" | 2" | 1 1/2" | 3/4" |
| 3/4" | 1 1/4" | 1/2" | 1 9/16" | 1 5/8" | 1 3/4" | 2 3/16" | 1 9/16" | 3/4" |
| 1" | 1 7/16" | 5/8" | 1 13/16" | 2 5/16" | 2 1/8" | 2 1/2" | 1 13/16" | 3/4" |
| 1 1/4" | 1 1/2" | 11/16" | 2 1/4" | 2 3/8" | 2 1/4" | 2 13/16" | 2 3/16" | 3/4" |
| 1 1/2" | 1 5/8" | 3/4" | 2 7/16" | 3 11/16" | 2 3/8" | 3" | 2 7/16" | 3/4" |
| 2" | 1 3/4" | 3/4" | 3" | 3 3/16" | 2 3/4" | 3 11/16" | 2 13/16" | 3/4" |
| 2 1/2" | 2 3/16" | 1" | 4" | 8 5/16" | 8 3/16" | 7 5/16" | 4 7/16" | 1 1/8" |
| 3" | 2 1/2" | 1 1/8" | 4 3/16" | 9 13/16" | 9 3/8" | 7 5/8" | 5 1/2" | 1 1/8" |
| 3 1/2" | 2 5/8" | 1 3/16" | 5 1/4" | 11 3/16" | 11 1/4" | 9 5/8" | 5 15/16" | 1 1/2" |
| 4" | 2 3/4" | 1 1/4" | 5 3/4" | 13" | 12 9/16" | 11 1/16" | 8 5/16" | 1 1/2" |
| 5" | 3 1/8" | 1 7/16" | 6 1/16" | | | | | 1 11/16" |
| 6" | 3 3/8" | 1 1/2" | 7 3/4" | | | | | 1 11/16" |

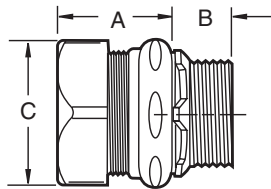

Straight

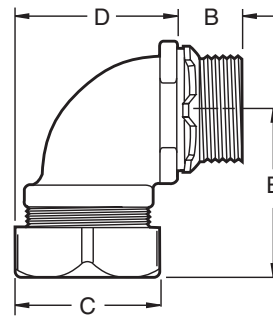

90°

Non-Insulated Aluminum

| Conduit/NPT Size | Dimensions | | | | |
|------------------|------------|---------|--------|----------|----------|
| | A | B | C | D | E |
| 3/8" | 1 3/16" | 19/32" | 1 1/4" | 1 7/16" | 1 3/8" |
| 1/2" | 15/16" | 19/32" | 1 1/4" | 1 1/2" | 1 3/8" |
| 3/4" | 1 5/16" | 19/32" | 1 1/2" | 1 11/16" | 1 1/2" |
| 1" | 1 7/16" | 13/16" | 1 3/4" | 2" | 1 13/16" |
| 1 1/4" | 1 9/16" | 13/16" | 2 1/4" | 2 7/16" | 2 5/32" |
| 1 1/2" | 1 13/16" | 13/16" | 2 1/2" | 2 13/16" | 2 7/16" |
| 2" | 1 3/4" | 7/8" | 3" | 3 3/16" | 2 7/8" |
| 2 1/2" | 2 1/4" | 1 1/16" | 3 3/4" | | |
| 3" | 2 7/16" | 1 1/8" | 4 1/2" | | |
| 3 1/2" | 2 7/8" | 1 3/16" | 5 1/8" | | |
| 4" | 2 15/16" | 1 1/4" | 5 5/8" | | |

ZINC DIE CAST LIQUIDTIGHT CONDUIT FITTINGS

Cooper Crouse-Hinds Zinc Die Cast liquidtight conduit fittings are used for the wiring of machine tools, motors, transformers, food processing equipment, robotics, air conditioning units, illuminated store front signs and billboards, etc. The flexible metallic conduit and fittings protect conductors from mechanical damage due to vibration and movement, and seals out cutting oils, coolants, water, dust, etc.

Certifications & Compliances

- UL Listed
- UL File No. E-19189



Applications & Features

| Applications | Features |
|--|---|
| To terminate and seal liquidtight flexible metal conduit to oiltight, liquidtight, or raintight box or enclosure. Connectors can be used with tapered thread female entry or unthreaded knockout using the provided sealing washer and lock nut. | <ul style="list-style-type: none"> • Furnished with lock nut and sealing ring. • Liquidtight, raintight, oiltight. • Suitable for wet locations. |

Ordering & Dimensional Information

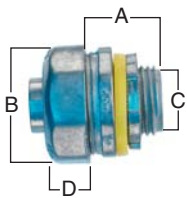

Straight Connector Non-Insulated — Zinc Die Cast

| Cat. # | Size | A | B | C | D | Unit Qty. | Standard Pkg. |
|---------|--------|------|------|------|------|-----------|---------------|
| LT38DC | 3/8" | 1.07 | .96 | .62 | .47 | 25 | 250 |
| LT50DC | 1/2" | 1.07 | 1.08 | .62 | .47 | 25 | 250 |
| LT75DC | 3/4" | 1.07 | 1.33 | .82 | .47 | 15 | 150 |
| LT100DC | 1" | 1.34 | 1.56 | 1.02 | .57 | 8 | 80 |
| LT125DC | 1 1/4" | 1.51 | 1.94 | 1.36 | .71 | 5 | 50 |
| LT150DC | 1 1/2" | 1.52 | 2.19 | 1.60 | .71 | 4 | 40 |
| LT200DC | 2" | 1.54 | 2.66 | 2.07 | .71 | 2 | 20 |
| LT250DC | 2 1/2" | 2.20 | 3.28 | 2.51 | 1.06 | 1 | 10 |
| LT300DC | 3" | 2.22 | 3.80 | 3.13 | 1.06 | 1 | 10 |
| LT350DC | 3 1/2" | 2.36 | 4.28 | 3.58 | 1.06 | 1 | 6 |
| LT400DC | 4" | 2.44 | 4.78 | 4.05 | 1.06 | 1 | 6 |



Straight Connector Insulated — Zinc Die Cast

| Cat. # | Size | A | B | C | D | Unit Qty. | Standard Pkg. |
|----------|--------|------|------|------|------|-----------|---------------|
| LTB38DC | 3/8" | 1.44 | .96 | .62 | .47 | 25 | 250 |
| LTB50DC | 1/2" | 1.44 | 1.08 | .62 | .47 | 25 | 250 |
| LTB75DC | 3/4" | 1.56 | 1.33 | .82 | .47 | 15 | 150 |
| LTB100DC | 1" | 2.01 | 1.56 | 1.02 | .57 | 8 | 80 |
| LTB125DC | 1 1/4" | 2.18 | 1.94 | 1.36 | .71 | 5 | 50 |
| LTB150DC | 1 1/2" | 2.19 | 2.19 | 1.60 | .71 | 4 | 40 |
| LTB200DC | 2" | 2.21 | 2.66 | 2.07 | .71 | 2 | 20 |
| LTB250DC | 2 1/2" | 2.89 | 3.28 | 2.51 | 1.06 | 1 | 10 |
| LTB300DC | 3" | 2.93 | 3.80 | 3.13 | 1.06 | 1 | 10 |
| LTB350DC | 3 1/2" | 3.07 | 4.28 | 3.58 | 1.06 | 1 | 6 |
| LTB400DC | 4" | 3.15 | 4.78 | 4.05 | 1.06 | 1 | 6 |

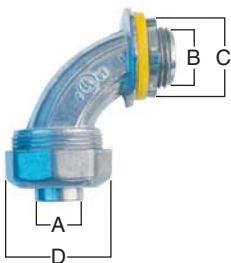

90° Angle Connectors Non-Insulated — Zinc Die Cast

| Cat. # | Size | A | B | C | D | Unit Qty. | Standard Pkg. |
|-----------|--------|------|------|------|------|-----------|---------------|
| LT3890DC | 3/8" | .62 | .81 | .92 | 1.22 | 25 | 250 |
| LT5090DC | 1/2" | .62 | .91 | 1.02 | 1.22 | 25 | 250 |
| LT7590DC | 3/4" | .80 | 1.15 | 1.27 | 1.36 | 15 | 150 |
| LT10090DC | 1" | 1.02 | 1.38 | 1.48 | 1.73 | 8 | 80 |
| LT12590DC | 1 1/4" | 1.36 | 1.77 | 1.93 | 2.11 | 5 | 50 |
| LT15090DC | 1 1/2" | 1.61 | 2.01 | 2.17 | 2.43 | 4 | 40 |
| LT20090DC | 2" | 2.08 | 2.58 | 2.68 | 2.93 | 2 | 20 |
| LT25090DC | 2 1/2" | 2.51 | 3.15 | 3.21 | 3.62 | 1 | 10 |
| LT30090DC | 3" | 3.13 | 3.67 | 3.74 | 4.28 | 1 | 10 |
| LT35090DC | 3 1/2" | 3.58 | 4.17 | 4.23 | 4.84 | 1 | 6 |
| LT40090DC | 4" | 4.06 | 4.74 | 4.75 | 5.37 | 1 | 6 |

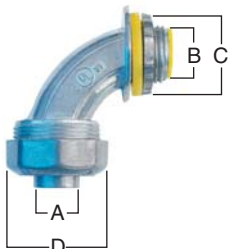

90° Angle Connectors Insulated — Zinc Die Cast

| Cat. # | Size | A | B | C | D | Unit Qty. | Standard Pkg. |
|------------|--------|------|------|------|------|-----------|---------------|
| LTB3890DC | 3/8" | .62 | .81 | .92 | 1.22 | 25 | 250 |
| LTB5090DC | 1/2" | .62 | .91 | 1.02 | 1.22 | 25 | 250 |
| LTB7590DC | 3/4" | .80 | 1.15 | 1.27 | 1.36 | 15 | 150 |
| LTB10090DC | 1" | 1.02 | 1.38 | 1.48 | 1.73 | 8 | 80 |
| LTB12590DC | 1 1/4" | 1.36 | 1.77 | 1.93 | 2.11 | 5 | 50 |
| LTB15090DC | 1 1/2" | 1.61 | 2.01 | 2.17 | 2.43 | 4 | 40 |
| LTB20090DC | 2" | 2.08 | 2.58 | 2.68 | 2.93 | 2 | 20 |
| LTB25090DC | 2 1/2" | 2.51 | 3.15 | 3.21 | 3.62 | 1 | 10 |
| LTB30090DC | 3" | 3.13 | 3.67 | 3.74 | 4.28 | 1 | 10 |
| LTB35090DC | 3 1/2" | 3.58 | 4.17 | 4.23 | 4.84 | 1 | 6 |
| LTB40090DC | 4" | 4.06 | 4.74 | 4.75 | 5.37 | 1 | 6 |

NON-METALLIC LIQUIDTIGHT CONDUIT FITTINGS

Cooper Crouse-Hinds Non-Metallic liquidtight conduit fittings are for use with non-metallic Type B liquidtight conduit and flexible non-metallic tubing to terminate and seal conduit to a liquidtight, oiltight, or raintight box or enclosure. They are used in applications such as wiring motors, transformers, processing equipment, pumps, etc. The non-metallic liquidtight connectors are made of nylon construction that is corrosion resistant and UV Rated for long outdoor life. They are furnished with a zinc die cast lock nut and sealing ring that seals out water and other corrosive liquids. They feature a no-spin ferrule that allows for easy installation (no disassembly required). The fittings are available in two styles, straight and 90° in trade sizes 1/2" – 1".

Features & Benefits

- Liquidtight, raintight, oiltight.
- Furnished with lock nut and sealing ring.
- Corrosion resistant.
- Suitable for wet locations.
- No-spin ferrule.
- No disassembly required for installation.
- 90° has smooth, gradual radius bend to prevent abrasion of conductors.

Materials

- Body and sealing ring: Nylon.
- Lock nut: Zinc die cast.



Certifications & Compliances

- UL Listed
- cUL Listed



Ordering & Dimensional Information

Straight Connector — Nylon

| Catalog No. | Trade Size | Unit Qty. | Std Pkg. | Weight Lbs. Per 100 | Dimensions | | |
|-------------|------------|-----------|----------|------------------------|------------|------|-----|
| | | | | | A | B | C |
| LT50NM | 1/2" | 25 | 250 | 6 | .55 | .85 | .56 |
| LT75NM | 3/4" | 10 | 150 | 8 | .72 | 1.08 | .72 |
| LT100NM | 1" | 5 | 80 | 10 | .94 | 1.30 | .94 |

90° Angle Connector — Nylon

| Catalog No. | Trade Size | Unit Qty. | Std Pkg. | Weight Lbs. Per 100 | Dimensions | | |
|-------------|------------|-----------|----------|------------------------|------------|------|-----|
| | | | | | A | B | C |
| LT5090NM | 1/2" | 25 | 150 | 7 | .55 | .85 | .56 |
| LT7590NM | 3/4" | 10 | 100 | 9 | .72 | 1.08 | .72 |
| LT10090NM | 1" | 5 | 50 | 13 | .94 | 1.30 | .94 |

Cross Reference Information

| Trade Size | T&B Catalog Number | Arlington Catalog Number | Bridgeport Catalog Number | Regal Catalog Number | EGS Catalog Number | CCH Catalog Number |
|------------|-----------------------|-----------------------------|------------------------------|-------------------------|-----------------------|-----------------------|
| 1/2" | LT-501 | NMLT50 | 430-NMLT | 3801 | 4Q-50P | LT50NM |
| 3/4" | LT-502 | NMLT75 | 431-NMLT | 3802 | 4Q-75P | LT75NM |
| 1" | LT-503 | NMLT100 | 432-NMLT | 3803 | 4Q-100P | LT100NM |
| 1/2" | LT-591 | NMLT9050 | 470-NMLT | 3841 | 4Q-950P | LT5090NM |
| 3/4" | LT-592 | NMLT9075 | 471-NMLT | 3842 | 4Q-975P | LT7590NM |
| 1" | LT-593 | NMLT90100 | 473-NMLT | 3843 | 4Q-9100P | LT10090NM |

LOW PROFILE LIQUIDTIGHT FITTINGS

The Low Profile liquidtight fittings are designed specifically for applications that require close side-by-side mounting of multiple liquidtight fittings in tight spaces.

Standard Materials

- Body – steel (straight fittings), malleable iron (angle fittings)
- Gland nut – steel
- Ferrule – steel
- Gland nut sealing ring – nylon
- Sealing gasket – polypropylene

Standard Finishes

- Steel – zinc electroplate
- Malleable iron – zinc electroplate
- Nylon – natural
- Polypropylene – natural

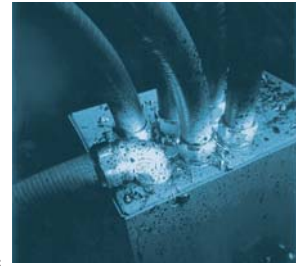

Ordering & Dimensional Information

Straight Connectors — Steel

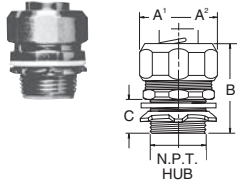

| Conduit Size | Non-Insulated Cat. No. | Insulated Cat. No. | Over Round Corner A ¹ | Hex A ² | B | C | N.P.T. Thread Length |
|--------------|------------------------|--------------------|----------------------------------|--------------------|----------|---|----------------------|
| 3/8" | LTK38 | LTBK38 | 1 3/32" | 1 1/32" | 1 3/16" | | 19/32" |
| 1/2" | LTK50 | LTBK50 | 1 3/16" | 1 1/8" | 1 11/32" | | 19/32" |
| 3/4" | LTK75 | LTBK75 | 1 7/16" | 1 3/8" | 1 7/16" | | 19/32" |
| 1" | LTK100 | LTBK100 | 1 3/4" | 1 11/16" | 1 5/8" | | 21/32" |
| 1 1/4" | LTK125 | LTBK125 | 2 5/32" | 2 1/16" | 1 27/32" | | 43/64" |
| 1 1/2" | LTBK150 | LTBK150 | 2 3/8" | 2 9/32" | 2" | | 23/32" |
| 2" | LTBK200 | LTBK200 | 2 7/8" | 2 25/32" | 2 1/8" | | 23/32" |

45° Angle Connectors — Malleable Iron

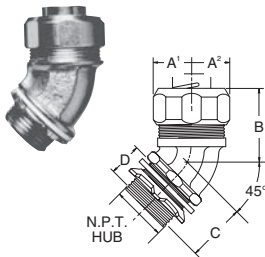

| Conduit Size | Non-Insulated Cat. No. | Insulated Cat. No. | Over Round Corner A ¹ | Hex A ² | B | C | D | N.P.T. Thread Length |
|--------------|------------------------|--------------------|----------------------------------|--------------------|----------|----------|---|----------------------|
| 3/8" | LTK3845 | LTBK3845 | 1 3/32" | 1 1/32" | 1 7/32" | 1 1/32" | | 19/32" |
| 1/2" | LTK5045 | LTBK5045 | 1 3/16" | 1 1/32" | 1 5/16" | 1 1/32" | | 19/32" |
| 3/4" | LTK7545 | LTBK7545 | 1 7/16" | 1 3/8" | 1 3/8" | 1 1/8" | | 13/32" |
| 1" | LTK10045 | LTBK10045 | 1 3/4" | 1 11/16" | 1 21/32" | 1 1/4" | | 21/32" |
| 1 1/4" | LTK12545 | LTBK12545 | 2 5/32" | 2 1/16" | 1 23/32" | 1 11/32" | | 11/16" |
| 1 1/2" | LTBK15045 | LTBK15045 | 2 3/8" | 2 9/32" | 2" | 1 15/32" | | 23/32" |
| 2" | LTBK20045 | LTBK20045 | 2 7/8" | 2 25/32" | 2 9/32" | 1 5/8" | | 23/32" |

90° Angle Connectors — Malleable Iron

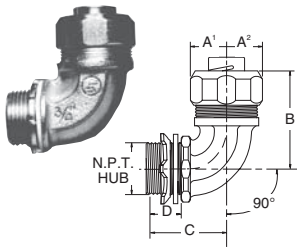

| Conduit Size | Non-Insulated Cat. No. | Insulated Cat. No. | Over Round Corner A ¹ | Hex A ² | B | C | D | N.P.T. Thread Length |
|--------------|------------------------|--------------------|----------------------------------|--------------------|----------|----------|---|----------------------|
| 3/8" | LTK3890 | LTBK3890 | 1 3/32" | 1 1/32" | 1 19/32" | 1 1/4" | | 9/16" |
| 1/2" | LTK5090 | LTBK5090 | 1 3/16" | 1 1/8" | 1 21/32" | 1 1/4" | | 9/16" |
| 3/4" | LTK7590 | LTBK7590 | 1 7/16" | 1 3/8" | 1 25/32" | 1 17/32" | | 9/16" |
| 1" | LTK10090 | LTBK10090 | 1 3/4" | 1 11/16" | 2 3/16" | 1 27/32" | | 21/32" |
| 1 1/4" | LTK12590 | LTBK12590 | 2 5/32" | 2 1/16" | 2 3/8" | 1 15/16" | | 11/16" |
| 1 1/2" | LTBK15090 | LTBK15090 | 2 3/8" | 2 9/32" | 2 5/8" | 2 3/32" | | 23/32" |
| 2" | LTBK20090 | LTBK20090 | 2 7/8" | 2 25/32" | 3 1/16" | 2 13/32" | | 23/32" |

For more information:

Contact an authorized Cooper Crouse-Hinds Distributor, Sales Office or Customer Service Department:

Distributed by:

In the U.S.:

Cooper Crouse-Hinds
P.O. Box 4999
Syracuse, NY 13221
Toll Free: 866-764-5454
(315) 477-5531
FAX: (315) 477-5179
crouse.customerctr@crouse-hinds.com

In Canada:

Cooper Crouse-Hinds Canada
Toll Free: 800-265-0502
(905) 507-4187
FAX: (905) 568-7048

For office locations outside of North America or for additional product information, visit our website at: www.crouse-hinds.com

Mexico • Latin America/Caribbean • Germany • Australia • Asia • Dubai • India



Solutions. Worldwide.™

Crouse-Hinds is a registered trademark of Cooper Industries, Inc.
© 2006 Cooper Industries, Inc.



X-ON Electronics

Largest Supplier of Electrical and Electronic Components

Click to view similar products for [crouse-hinds](#) manufacturer:

Other Similar products are found below :

[RE21](#) [14W48](#) [E1016-1612S](#) [EMP:0205057-J10](#) [NOR-000-002-220-232](#) [RPE417-116](#) [A100601-24](#) [LT20090](#) [AP100-CON-KIT](#) [GLL1](#)
[CGB5913](#) [CGB6920](#) [CGD196](#) [CGD197](#) [CGD292](#) [CGD297](#) [LT7590](#) [TMCX6206](#) [RPE421-121](#) [51F2F-D0](#) [EFS2192](#) [CGE395](#) [CGD293](#)
[CGB6917](#) [CGB5915](#) [CGB4911](#) [CG10090](#) [1050](#) [W2H840](#) [E1016-1600S](#) [NJBW050905TC](#) [PVM25L2B/UNV1](#) [PVM11LR3B2/UNV1](#)
[E1016-1687S](#) [E1016SC-36](#) [CGD4911](#) [AP20458](#) [GH420P5W](#) [DEV12-S769](#) [UNY805](#) [EBM:0206695](#) [CH360RA6W](#) [ZD13701](#) [EDS11273](#)
[STBS1151509](#) [EMP049](#) [ATP375](#) [EDSC215](#) [EFSC2190](#) [DSD918-S769-EM-SP](#) [GHG-410-1965-R0002](#)