

Reversible synchronous geared motors with capacitor

- Constant speed, dependent on supply frequency
- Direction of rotation controlled by dephasing capacitor
- Permanent magnet rotor
- UL, CSA, VDE approved, comply with IEC standards.

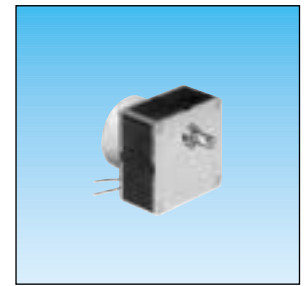
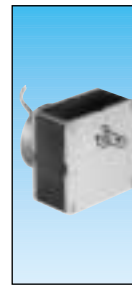

Applications

- Valve actuation
- Blind, louvre and vane actuation
- Office equipment
- Boiler systems
- Amusement machines
- Vending machines
- Medical equipment
- Laboratory equipment
- Peristaltic pumps

Types

Voltagess / Frequencies

	80 517 3	80 527 0	80 527 4
230-240 V			
50 Hz			
Base speed of motor (rpm)	250	250	375

Output speeds (rpm)

Motors	250 rpm	375 rpm	Ratios (i)
	20	30	12.5
	10	15	25
	8	12	31.25
	6	9	41.66
	4	10	62.5
	3	4.5	83.33
	2	3	125
	1	1.5	250
	0.5	0.75	500
	0.33	0.5	750
	0.1	0.15	2500

Part numbers	80 517 3	80 527 0	80 527 4
80 527 010	•	•	•
80 527 001	•	•	•
80 527 002	•	•	•
80 527 003	•	•	•
80 527 005	•	•	•
80 527 006	•	•	•
80 527 008	•	•	•

Standard gearbox shaft: see dimensions

General characteristics

		82 510 3	82 520 0	82 520 4
Motor		82 510 3	82 520 0	82 520 4
Gearbox		81 037 0	81 037 0	81 037 0
Maximum permitted continuous rated gearbox output torque for 1 million revolutions of gearbox output shaft	N.m	5	5	5
Axial load (static)	daN	2	2	2
Radial load (static)	daN	3	3	3
Absorbed power	W	2.7	3.5	3.5
Usable motor power	W	0.31	0.98	1.12
Maximum temperature rise	°C	50	50	50
Ambient temperature	°C	-10+70	-10+70	-10+70
Weight	g	410	530	530
Lead length (approx.)	mm	250	250	250
Protection		IP40	IP40	IP40

Options : for made to order products non stocked

Voltagess / Frequencies	24-115 V 60 Hz	24 V 50 Hz			
Round shaft 79 306 478 (see page 2/29)			•	•	•

Torque / Speed curves

80 517 0

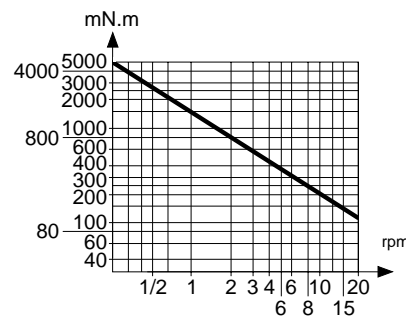

80 527 0 - 80 527 4

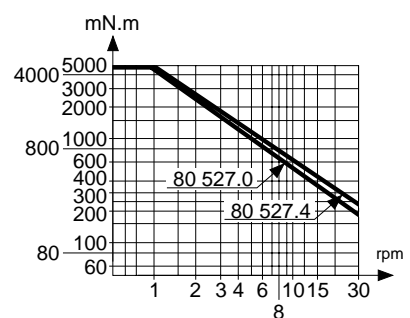

Capacitors (supplied only on request)

Voltagess / Frequencies	μF	V	Part number	Voltagess / Frequencies	μF	V	Part number
Motor 82 510 0				Motor 82 520 0			
230-240 V 50 Hz	0.33 ± 10%	400	26 231 801	230-240 V 50 Hz	0.10 ± 10%	700	26 231 941
115 V 50/60 Hz	0.27 ± 10%	250	26 231 851	115 V 60 Hz	0.33 ± 10%	400	26 231 801
24 V 50 Hz	8.2 ± 10%	63	26 231 711	24 V 50 Hz	8.2 ± 10%	63	26 231 711
24 V 60 Hz	6.8 ± 10%	63	26 231 148				

Motor 82 520 4

230-240 V 50 Hz	0.12 ± 10%	630	26 231 903
115 V 60 Hz	0.39 ± 10%	630	26 231 924
24 V 50 Hz	15 ± 10%	63	26 231 729
24 V 60 Hz	12 ± 10%	63	26 231 727

Other information

For basic principles, see page 2/6

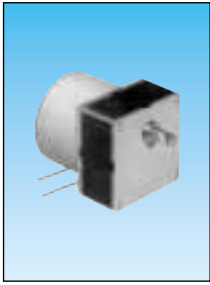

80 547 0

230-240 V
50 Hz
250

80 547 024
80 547 015

80 547 016
80 547 017
80 547 018
80 547 019
80 547 020
80 547 021

82 540 0
81 037 0

5

2
3
7.2
2.65
55
-10+70
860
250

80 547 0

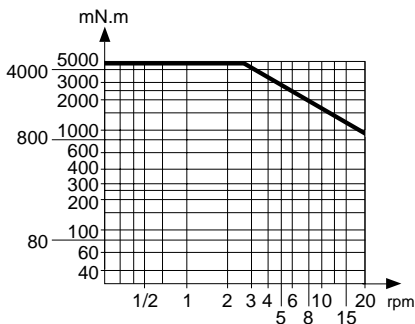

Voltages / Frequencies	μF	V	Part number
Motor 82 540 0			
230-240 V 50 Hz	0.22 ± 10%	630	26 231 908
115 V 60 Hz	0.56 ± 5%	400	26 231 922
24 V 50 Hz	15 ± 10%	63	26 231 729
24 V 60 Hz	15 ± 10%	63	26 231 729

1

2

3

4

Dimensions

80 517 0 - 80 527 0 - 80 527 4 - 80 547 0

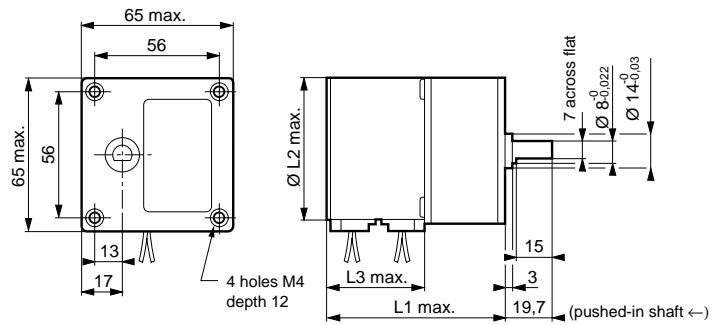

Type	L1 (mm)	Ø L2 (mm)	L3 (mm)
80 517 0	55.3	35.8	21.7
80 527 0	59.2	51.3	25.6
80 527 4	59.2	51.3	25.6
80 547 0	76.6	65.3	43

Shaft 79 206 478

(pushed-in shaft ←)

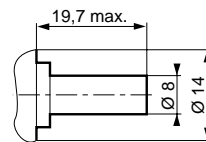

Connections

In parallel

Motors 82 510 0 - 82 520 0 - 82 520 4
82 540 0

In series

Motor 82 510 0 only
230V - 240V 50 Hz version

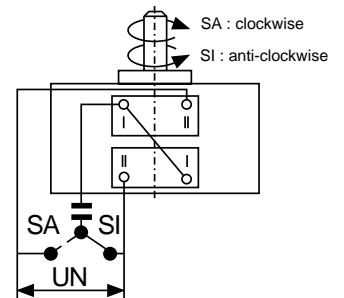
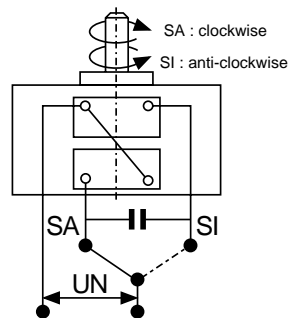

To order, specify :

Standard products

3 Part number

Example : Synchronous geared motor 80 527 010

Standard products,
non stocked

1 Type

2 Voltage /
Frequency

3 Output
speed

4 Option

Example : Reversible synchronous geared motor 80 517 0 - 230 V 50 Hz - 20 rpm

X-ON Electronics

Largest Supplier of Electrical and Electronic Components

Click to view similar products for [Motor Start Capacitors & Motor Run Capacitors](#) category:

Click to view products by [Crouzet](#) manufacturer:

Other Similar products are found below :

[950CQW5H-F](#) [SFS37S30-5K400E-F](#) [SFT44S45-5K491E-F](#) [26231720](#) [26231711](#) [26231703](#) [870CG35800AA2J](#) [878AF24600AA1J](#)
[SFA66T2K219A-F](#) [100MS26ACMA1STD](#) [080MS22ABMA1STD](#) [080MS26ACMA1STD](#) [050MS22AAMA1STD](#) [100MS22ACMA1STD](#)
[070MS22ABMA1STD](#) [180MS22ACMA1STD](#) [040MS26ABMA1STD](#) [100MS26ACMK1STD](#) [120MS26ACMK1STD](#) [200MS26ACMK1STD](#)
[150MS22ACMA1STD](#) [060MS22AAMA1STD](#) [MKSP-6P 4UF 450V B](#) [MKSP-6P 5UF 450V B](#) [MKSP-6P 8UF 450V B](#) [I150V468K-G1](#)
[I150V530K-C1](#) [I150V620K-G1](#) [I150V640K-G1](#) [I15KV580K-D](#) [I15KV610K-B](#) [I15KV612K-D](#) [I15KV640K-B](#) [C274AC34200AA0J](#)
[C274ACF4600WA0J](#) [C274ACF5150WA0J](#) [C878AF24200AA4J](#) [C878AF24600AA1J](#) [C878AF35300AA0J](#) [C878BF34400SA0J](#)
[C878BF34800SA0J](#) [C878BF35300SA0J](#) [CBB60A-12/450](#) [CBB60A-16/450](#) [CBB60A-20/450](#) [CBB60A-6/450](#) [CBB60E-40/450](#) [CBB60E-](#)
[50/450](#) [CBB60E-6/450](#) [CBB60E-80/450](#)