

P – PANEL MOUNTING ADAPTER

This panel adapter is a rugged, black, auto extinguishable polycarbonate material. It is mounted with two 6/32 screws. A timer is mounted by clipping to the adapter or panel. Order part number P ADAPT.

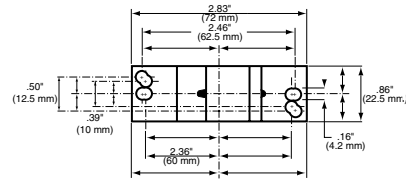

DR – DIN-RAIL

The DR-DIN-Rail material is an extruded aluminum material of the standard configuration, 35mm. Timers and Controls conveniently snap onto the track. Order part number “DR” which is available in 1 meter (39”) lengths. Shown with S08, S11 and K11 sockets.

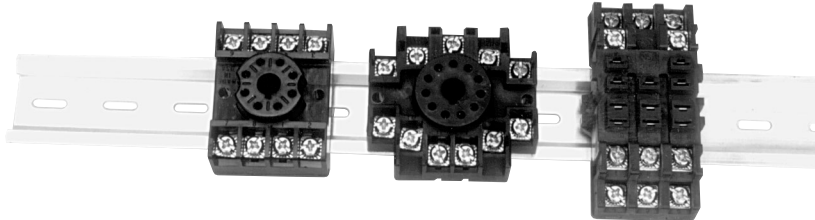

S08, S11 & SCREW TERMINAL SOCKETS

The S08, and S11 are 8 and 11 pin sockets fabricated from a rugged, durable polycarbonate.* The color is grey to match the majority of accessories available. Mounting is with two 6/32 screws .250 or on .30 DIN-Rail, DR. Order part “S08” or “S11.”

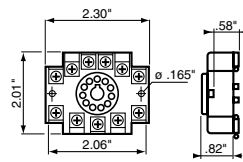

S11

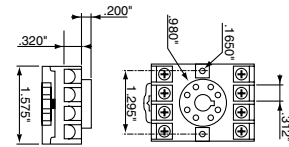

S08

S08-600: 600V, 10A rated 8 pin socket-UL and CSA

S12 & S15 SOLDER TERMINAL SOCKETS

The S12 and S15 are 11 and 8 pin solder terminal sockets fabricated from a rugged, durable polycarbonate. They are black and connections are made by soldering to the tabs or by 3/16” (4.8mm) push-on connectors. Order Part Number “S12” (11 pin) and “S15” (8 pin)

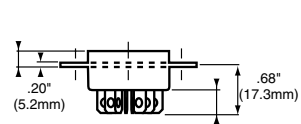
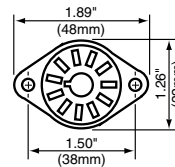

SA8 & SA11 - Back connecting Socket

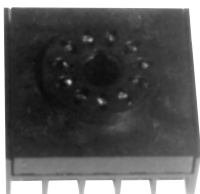

SA11NN

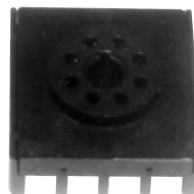
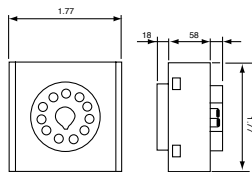

SA8NN

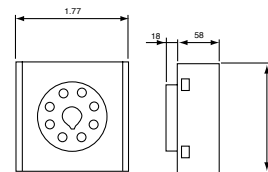

Products and specifications subject to change without notice.

Order/Technical Support – Tel: (800) 677-5311 / FAX: (800) 677-3865 / www.crouzet-usa.com

ACCESSORIES FOR RTM TIMER

SOCKETS PC Board Sockets (mm)

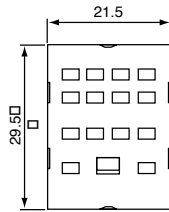
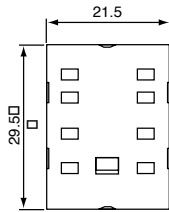

2 Poles
Ref: 26532709

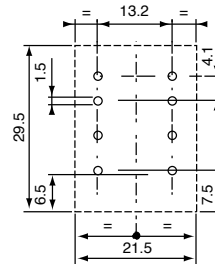
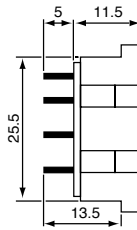

4 Poles
Ref: 26532708

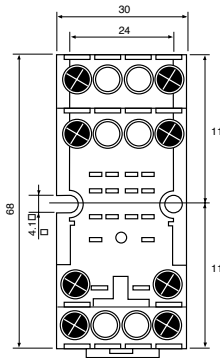
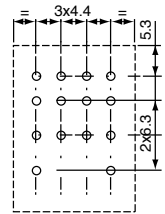

2 Poles
Ref: 26532707

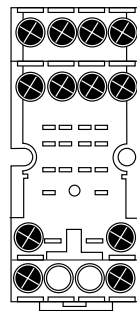

4 Poles
Ref: 26532706

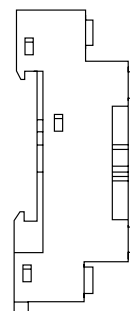

Mounting Clip for DIN-Rail Sockets

Ref: 26532702

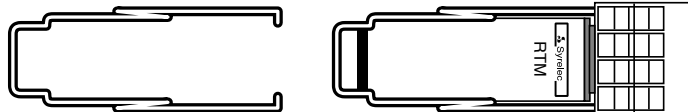

79 238 250 (Part Number)
PANEL MOUNT REMOTE POTENTIOMETER
 470K Ohm ±10% / 0.2 W / linearity ±10%

DIMENSIONS: inches (mm)

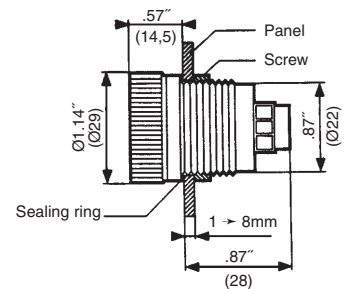

Products and specifications subject to change without notice.

Order/Technical Support – Tel: (800) 677-5311 / FAX: (800) 677-3865 / www.crouzet-usa.com



X-ON Electronics

Largest Supplier of Electrical and Electronic Components

Click to view similar products for [Relay Sockets & Fixings](#) category:

Click to view products by [Crouzet](#) manufacturer:

Other Similar products are found below :

[00008258500](#) [00111976502](#) [0000-825-81-00](#) [60SY4S05](#) [M41G](#) [670-0125](#) [670-0127](#) [6700152](#) [670-0153](#) [6700156](#) [D258-2TS00](#) [70-309](#) [7-1393143-3](#) [7-1616360-5](#) [8000-DG2-5](#) [911361](#) [9-1616339-5](#) [PJF11N](#) [GDA12HA](#) [GDA12HD](#) [GDA12SA](#) [GDA12SD](#) [GDA16HD](#) [GDA22HA](#) [GDA95A](#) [GDA95D](#) [GFX20](#) [PT08QN](#) [PT 1/8 D = 3.2](#) [GUA1](#) [GUA2-11](#) [GUA4-31](#) [GUM5R](#) [GUR-120](#) [GUR-24](#) [GUR-240](#) [GUR-277](#) [GURX-277](#) [GUW12](#) [GUW95](#) [GUZ63L](#) [R99-11 FOR MY\(NAMEPLATE\)](#) [D52PR2T](#) [RES100K](#) [1310H-HDC](#) [1390H-1ST](#) [1393824-3](#) [1390H-2PC](#) [1410-2SM](#) [1410-3SM](#)