

› MWG

› Monitoring Relays

› 3-Phase Monitoring Relays

› Din Rail Mount 17.5 mm Multifunction

- › Control of 3-phase networks : phase sequence, phase failure, imbalance (asymmetry), over and undervoltage (MWU)
- › Range includes mono-function product and multi-function product
- › Multi-voltage from 3 x 208 to 3 x 480 V
- › Controls its own supply voltage
- › True RMS measurement
- › LED status indication



| Specifications | | | |
|----------------------------|-------------------------|--------------------------------|----------|
| Functions | Nominal voltage (V) | Output | Code |
| Phase sequence and failure | 3 x 208 → 3 x 480 V AC* | 1 single pole changeover relay | 84873022 |

| Power supply | |
|--|--------------------------|
| Supply voltage Un | 3 x 208 → 3 x 480 V AC * |
| Voltage supply tolerance | -12% / +10% |
| Operating range | 183 → 528 V AC |
| AC supply voltage frequency | 50 / 60 Hz ±10% |
| Galvanic isolation of power supply/measurement | No |
| Power consumption at Un | 22 VA in 400 VAC, 50 Hz |
| Immunity from micro power cuts | 10 ms |

| Inputs and measuring circuit | |
|--|--|
| Measurement ranges | 183 → 528 V AC |
| Selection of phase-phase nominal voltage Un | 208 - 220 - 380 - 400 - 415 - 440 - 480 V |
| Frequency of measured signal | 50 → 60 Hz ± 10% |
| Max. measuring cycle time | 150 ms/True RMS measurement |
| Voltage threshold adjustment | 2 → 20% of selected Un (-2 to -12% across the 3 x 208 V AC range / -2 to -17% across the 3 x 220 V AC range / 2 to 10% across the 3 x 480 V AC range) |
| Voltage threshold hysteresis | 2% of fixed Un |
| Asymmetry threshold hysteresis | 2% of fixed Un |
| Asymmetry threshold adjustment | 5 to 15% of selected Un |
| Display precision | ± 3% of the displayed value |
| Repetition accuracy with constant parameters | ± 0,5% |
| Measuring error with voltage drift | < 1% across the whole range |
| Measuring error with temperature drift | < 0,05% / °C |
| Maximum regeneration (phase failure) | 70% |

| Time delays | |
|--|--------------------|
| Delay on threshold crossing | 0.1 to 10 s 0 +10% |
| Repetition accuracy with constant parameters | ± 3% |

| Time delays | |
|---|---|
| Reset time | 1500 ms |
| Delay on pick-up | ≤ 650 ms |
| Alarm on delay time max. | < 200 ms |
| Outputs | |
| Type of output | 1 single pole changeover relay |
| Type of contacts | No cadmium |
| Maximum breaking voltage | 250 V AC/DC |
| Max. breaking current | 5 A AC/DC |
| Min. breaking current | 10 mA / 5 V DC |
| Electrical life (number of operations) | 1 x 10 ⁵ |
| Breaking capacity (resistive) | 1250 VA AC |
| Maximum rate | 360 operations/hour at full load |
| Operating categories acc. to IEC/EN 60947-5-1 | AC 12, AC 13, AC 14, AC 15, DC 12, DC 13, DC 14 |
| Mechanical life (operations) | 30 x 10 ⁶ |
| Insulation | |
| Nominal insulation voltage IEC/EN 60664-1 | 400 V |
| Insulation coordination (IEC/EN 60664-1) | Overvoltage category III : degree of pollution 3 |
| Rated impulse withstand voltage (IEC/EN 60664-1) | 4 kV (1,2 / 50 μs) |
| Dielectric strength (IEC/EN 60664-1) | 2 kV AC 50 Hz 1 min |
| Insulation resistance (IEC/EN 60664-1) | > 500 MOhm(s) / 500 V DC |
| General characteristics | |
| Display power supply | Green LED |
| Display relay | Yellow LED - This LED flashes during the threshold delay |
| Casing | 17,5 mm |
| Mounting | On 35 mm symmetrical DIN rail, IEC/EN 60715 |
| Mounting position | All positions |
| Material : enclosure plastic type VO to UL94 standard | Incandescent wire test according to IEC 60695-2-11 & NF EN 60695-2-11 |
| Protection (IEC/EN 60529) | Terminal block : IP20 Casing : IP30 |
| Weight | 80 g |
| Connecting capacity IEC/EN 60947-1 | Rigid : 1 x 4 ² - 2 x 2.5 ² mm ² 1 x 11 AWG - 2 x 14 AWG Flexible with ferrules : 1 x 2.5 ² - 2 x 1.5 ² mm ² 1 x 14 AWG - 2 x 16 AWG |
| Max. tightening torques IEC/EN 60947-1 | 0,6 Nm → 1 / 5,3 → 8,8 Lbf.In |
| Operating temperature IEC/EN 60068-2 | -20 → +50 °C |
| Storage temperature IEC/EN 60068-2 | -40 → +70 °C |
| Humidity IEC/EN 60068-2-30 | 2 x 24 hr cycle 95% RH max. without condensation 55 °C |
| Vibrations according to IEC/EN60068-2-6 | 10 → 150 Hz, A = 0.035 mm |
| Shocks IEC/EN 60068-2-6 | 5 g |
| Standards | |
| Product standard | IEC/EN 50178 |
| Electromagnetic compatibility (EMC) | IEC/EN 61000-6-1, IEC/EN 61000-6-2, IEC/EN 61000-6-3, IEC/EN 61000-6-4 |
| Certifications | CE, UL, CSA, GL |
| Conformity with environmental directives | RoHS |
| Comments | |
| | * 3-phase mains with earth |

Dimensions

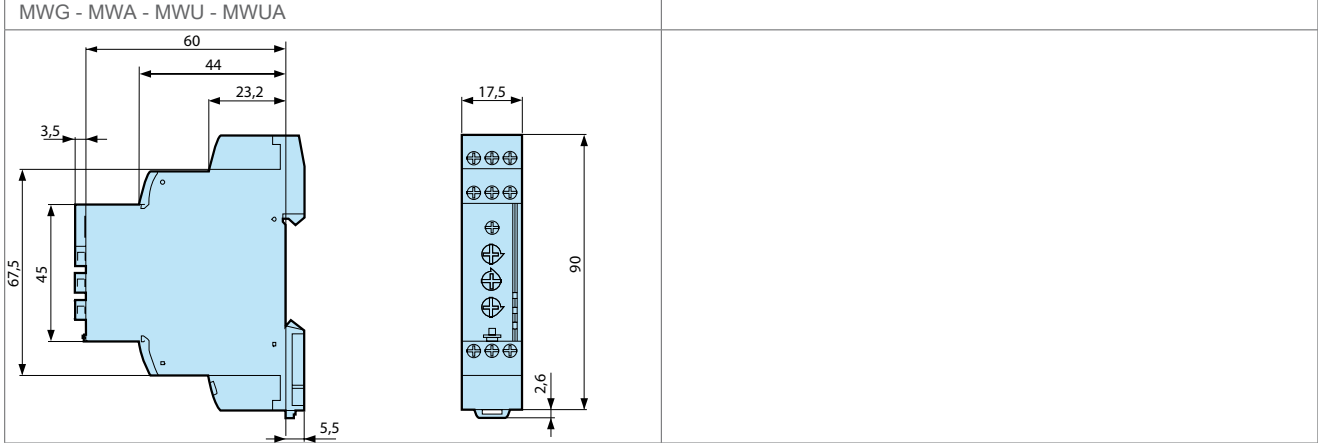

Curves

Connections

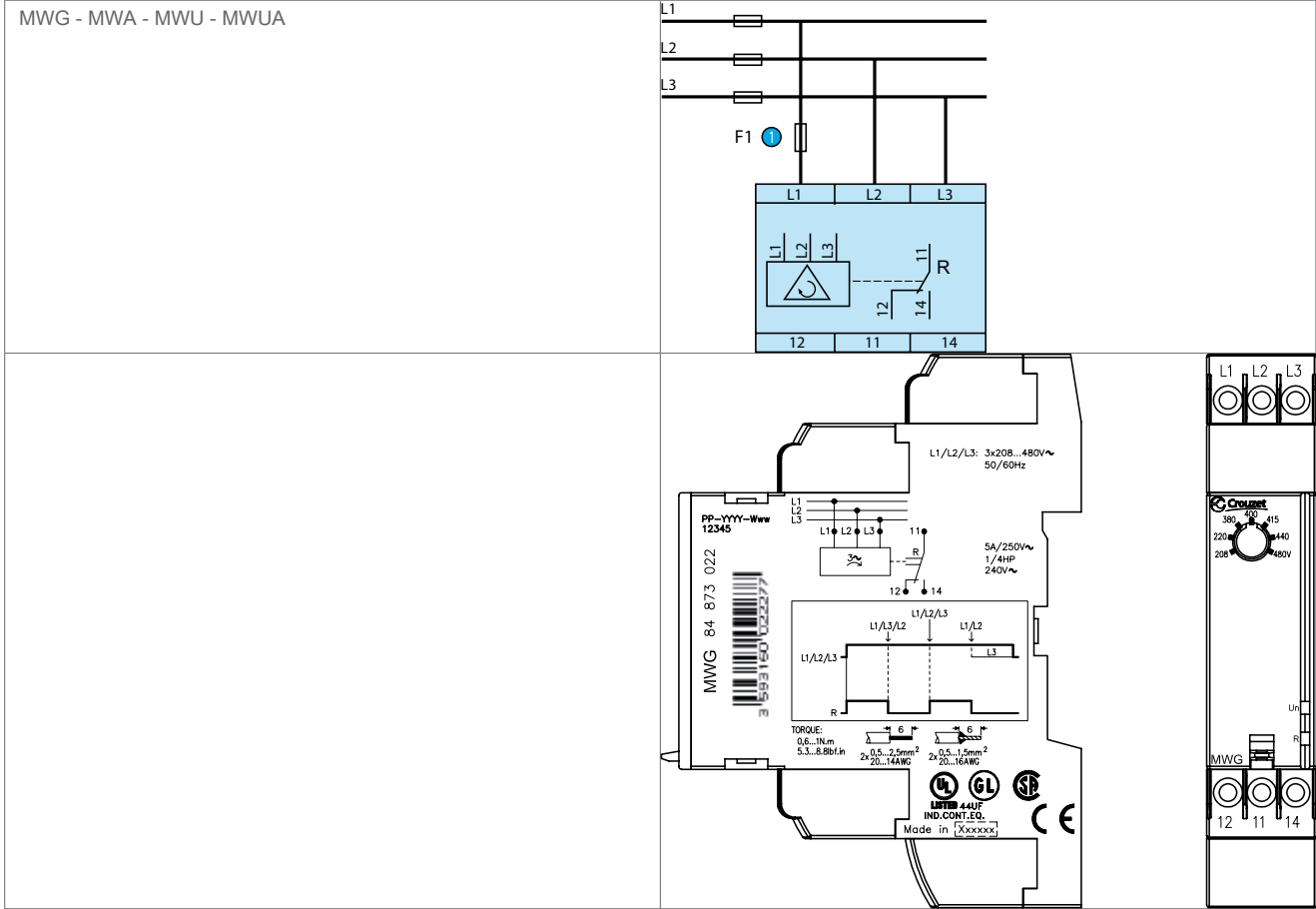

X-ON Electronics

Largest Supplier of Electrical and Electronic Components

Click to view similar products for [Controllers](#) category:

Click to view products by [Crouzet](#) manufacturer:

Other Similar products are found below :

[61FGPN8DAC120](#) [CV500SLK21](#) [70177-1011](#) [F03-03 HAS C](#) [F03-31](#) [81550401](#) [FT1A-C12RA-W](#) [88981106](#) [H2CAC24A](#) [H2CRSAC110B](#)
[R88A-CRGB003CR-E](#) [R88ARR080100S](#) [R88A-TK01K](#) [DCN1-1](#) [AFP0RT32CT](#) [DRT2ID08C](#) [DTB4896VRE](#) [DTB9696CVE](#)
[DTB9696LVE](#) [E53-AZ01](#) [E53E01](#) [E53E8C](#) [E5C4Q40J999FAC120](#) [E5CWLQ1TCAC100240](#) [E5GNQ03PFLKACDC24](#) [B300LKL21](#)
[NSCXDC1V3](#) [NSH5-232CW-3M](#) [NT20SST122BV1](#) [NV-CN001](#) [OAS-160-N](#) [C40PEDRA](#) [K31S6](#) [K33-L1B](#) [K3MA-F](#) [100-240VAC](#)
[K3TX-AD31A](#) [89750101](#) [L595020](#) [SRM1-C02](#) [SRS2-1](#) [G32X-V2K](#) [26546803](#) [26546805](#) [PWRA440A](#) [CPM1AETL03CH](#) [CV500SLK11](#)
[3G2A5BI081](#) [3G2A5IA122](#) [3G2A5LK010E](#) [3G2A5OA223](#)