



# CTT0223, CTT1223, CTT2223, CTT3223

## 600V Random Phase High Power Photo TRIAC

### Features

- High isolation 5000 VRMS
- Supports 0.3 A, 0.6 A, 0.9 A and 1.2 A
- RoHS compliant
- REACH compliance
- External creepage > 7.5mm
- Internal creepage > 6.0mm
- Insulation distance > 0.4mm
- Regulatory Approvals
  - UL - UL1577 (pending approval)
  - VDE - EN60747-5-5(VDE0884-5)
  - CQC – GB4943.1, GB8898
  - IEC60065, IEC60950

### Description

The random phase power Triac consists of a Triac and a photo-Triac, which is optically coupled to a gallium arsenide Infrared emitting diode, and housed in a 7-lead DIP package. It also comes with different lead forming options.

### Applications

- Home appliances
- Industrial equipment

### Package Outline

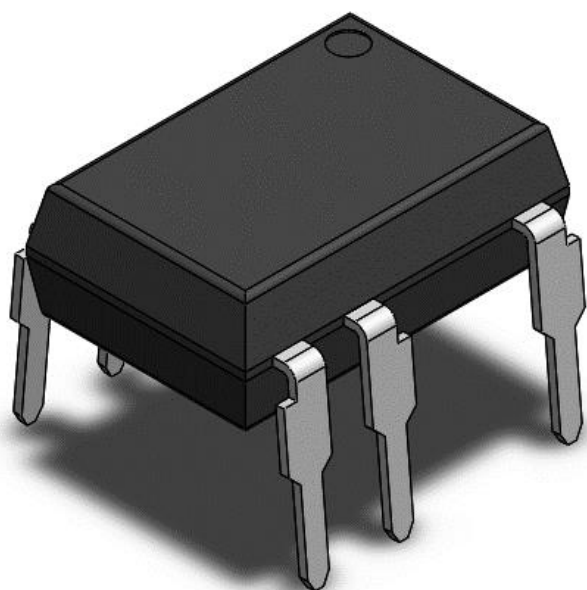

### Schematic

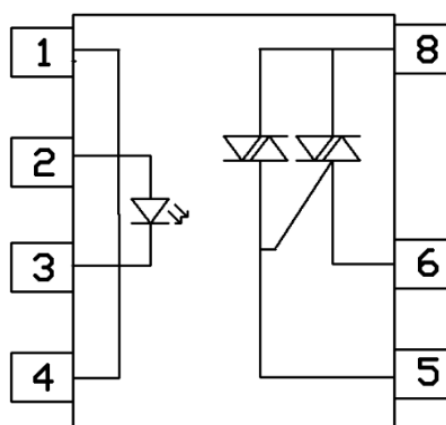

Note: Different bending options available. See package dimension.



# CTT0223, CTT1223, CTT2223, CTT3223

## 600V Random Phase High Power Photo TRIAC

### Absolute Maximum Rating at 25°C

| <b>Symbol</b>       | <b>Parameters</b>                 | <b>Ratings</b> | <b>Units</b> | <b>Notes</b> |
|---------------------|-----------------------------------|----------------|--------------|--------------|
| V <sub>iso</sub>    | Isolation voltage                 | 5000           | Vrms         |              |
| T <sub>OPR</sub>    | Operating temperature             | -40 ~+85       | °C           |              |
| T <sub>STG</sub>    | Storage temperature               | -40 ~+125      | °C           |              |
| T <sub>SOL</sub>    | Soldering temperature             | 260            | °C           |              |
|                     | Wave soldering temperature        | 260            | °C           |              |
| <b>Emitter</b>      |                                   |                |              |              |
| I <sub>F</sub>      | LED forward current               | 50             | mA           |              |
| V <sub>R</sub>      | LED reverse voltage               | 6              | V            |              |
| I <sub>FP</sub>     | Peak forward current              | 1              | A            |              |
| P <sub>in</sub>     | Power dissipation                 | 75             | mW           |              |
| <b>Detector</b>     |                                   |                |              |              |
| V <sub>DRM</sub>    | Repetitive peak OFF-state voltage | 600            | V            |              |
| I <sub>T(RMS)</sub> | Continuous Current Load           | CTT0223        | 0.3          | A            |
|                     |                                   | CTT1223        | 0.6          |              |
|                     |                                   | CTT2223        | 0.9          |              |
|                     |                                   | CTT3223        | 1.2          |              |
| I <sub>TSM</sub>    | Peak Current Load                 | CTT0223        | 3            | A            |
|                     |                                   | CTT1223        | 6            |              |
|                     |                                   | CTT2223        | 9            |              |
|                     |                                   | CTT3223        | 12           |              |
| P <sub>out</sub>    | Power dissipation                 | 800            | mW           |              |
| P <sub>T</sub>      | Total power dissipation           | 850            | mW           |              |



# CTT0223, CTT1223, CTT2223, CTT3223

## 600V Random Phase High Power Photo TRIAC

### Electrical Characteristics $T_A = 25^\circ\text{C}$ (unless otherwise specified)

#### Emitter Characteristics

| Symbol   | Parameters        | Test Conditions     | Min | Typ | Max | Units         | Notes |
|----------|-------------------|---------------------|-----|-----|-----|---------------|-------|
| $V_F$    | Forward voltage   | $I_F = 10\text{mA}$ | -   | -   | 1.3 | V             |       |
| $I_R$    | Reverse Current   | $V_R = 6\text{V}$   | -   | -   | 5   | $\mu\text{A}$ |       |
| $C_{IN}$ | Input Capacitance | $f = 1\text{MHz}$   | -   | 45  | -   | pF            |       |

#### Detector Characteristics

| Symbol    | Parameters                              | Test Conditions                                        | Min | Typ | Max | Units                  | Notes |
|-----------|-----------------------------------------|--------------------------------------------------------|-----|-----|-----|------------------------|-------|
| $I_{DRM}$ | Peak Blocking Current                   | $I_F = 0\text{mA}$ , $V_{DRM} = \text{Rated } V_{DRM}$ | -   | -   | 100 | $\mu\text{A}$          |       |
| $V_{INH}$ | Inhibit Voltage                         | $I_F = \text{Rated } I_{FT}$                           | -   | -   | 50  | V                      |       |
| $V_{TM}$  | Peak On-State Voltage                   | $I_F = \text{Rated } I_{FT}$ , $I_{TM} = 100\text{mA}$ | -   | -   | 2.5 | V                      |       |
| $dv/dt$   | Critical Rate of Rise off-State Voltage | $V_{PEAK} = \text{Rated } V_{DRM}$                     | 200 | -   | -   | $\text{V}/\mu\text{s}$ |       |

#### Transfer Characteristics

| Symbol   | Parameters            | Test Conditions             | Min                | Typ  | Max | Units    | Notes |
|----------|-----------------------|-----------------------------|--------------------|------|-----|----------|-------|
| $I_{FT}$ | Input Trigger Current | Terminal Voltage = 3V       | -                  | -    | 10  | mA       |       |
| $I_H$    | Holding Current       |                             | -                  | -    | 25  | mA       |       |
| $R_{IO}$ | Isolation Resistance  | $V_{IO} = 500\text{V}_{DC}$ | $1 \times 10^{11}$ | -    | -   | $\Omega$ |       |
| $C_{IO}$ | Isolation Capacitance | $f = 1\text{MHz}$           | -                  | 0.25 | -   | pF       |       |



# CTT0223, CTT1223, CTT2223, CTT3223

## 600V Random Phase High Power Photo TRIAC

### Typical Characteristic Curves

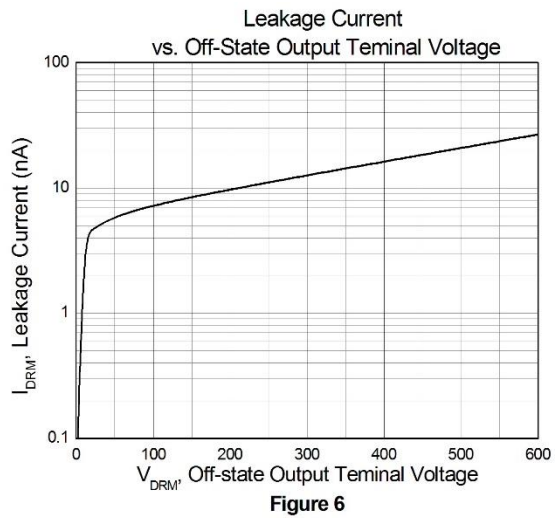
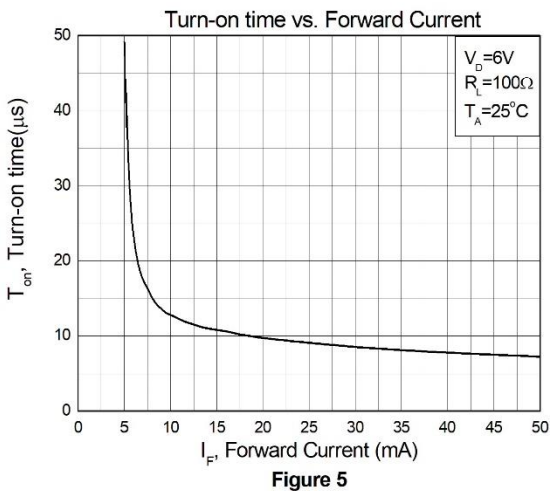
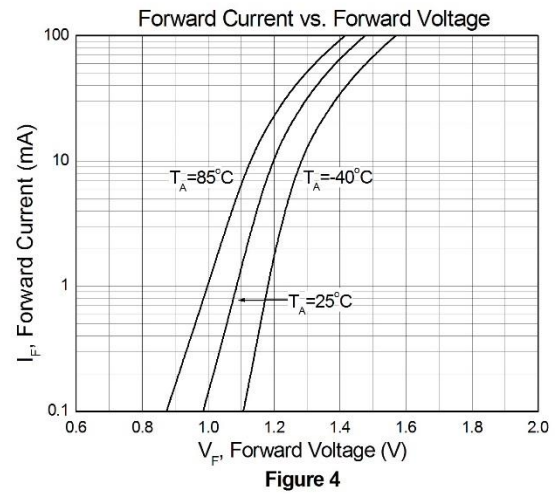
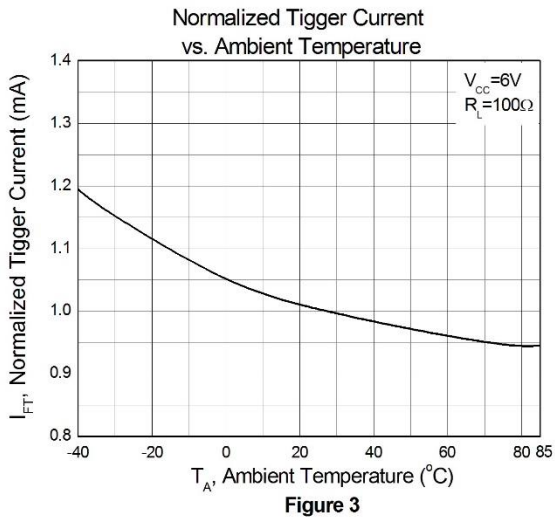
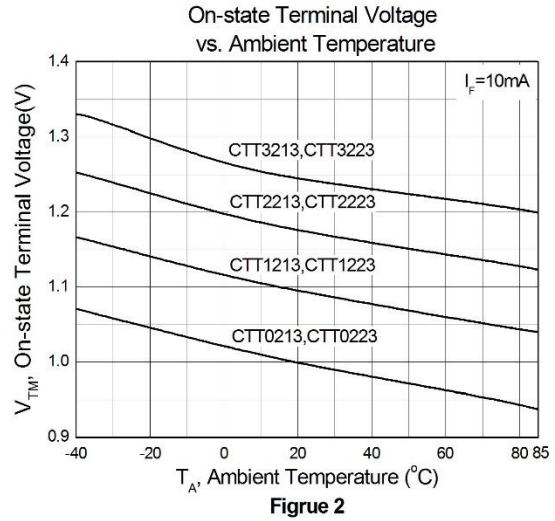
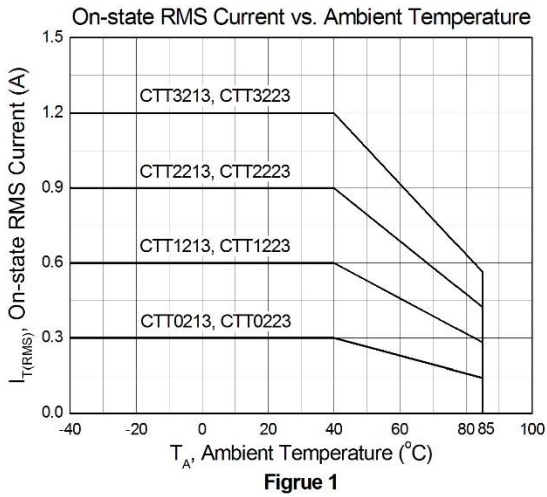



# CTT0223, CTT1223, CTT2223, CTT3223

## 600V Random Phase High Power Photo TRIAC

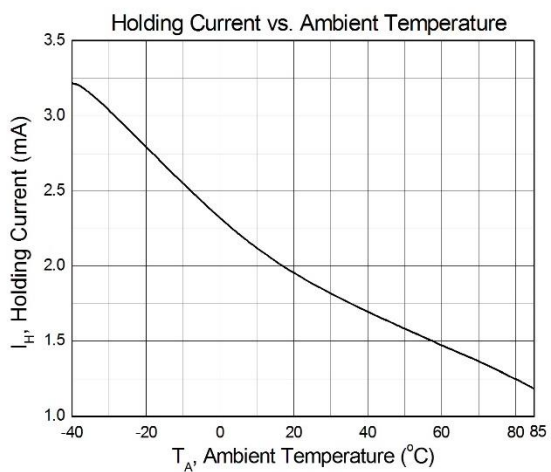

Figure 7

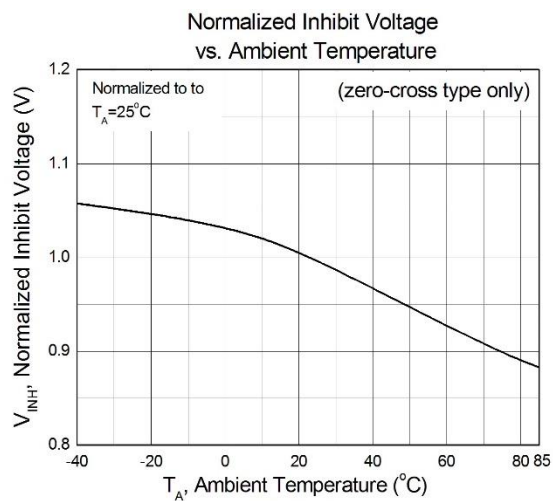

Figure 8



# CTT0223, CTT1223, CTT2223, CTT3223

## 600V Random Phase High Power Photo TRIAC

### Package Dimension *Dimensions in mm unless otherwise stated*

#### Standard DIP – Through Hole

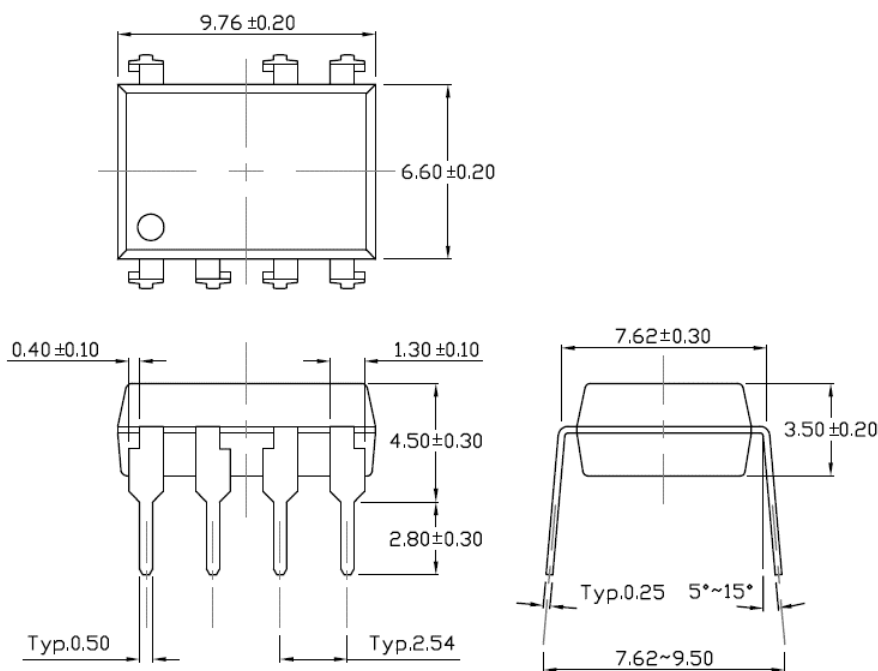

#### Gullwing (400mil) Lead Forming – Through Hole (M Type)

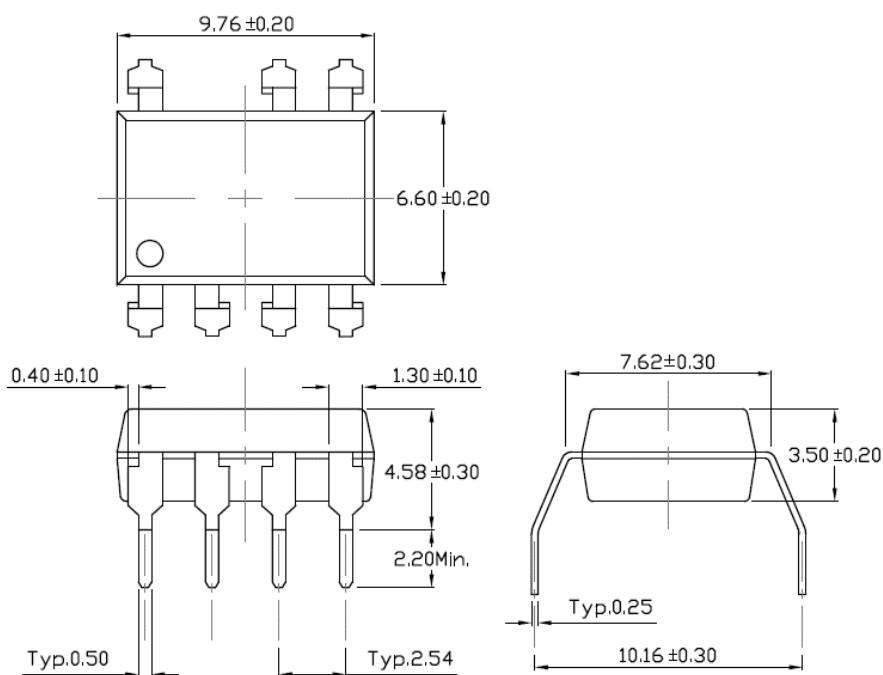



# CTT0223, CTT1223, CTT2223, CTT3223

## 600V Random Phase High Power Photo TRIAC

### Surface Mount Lead Forming (S Type)

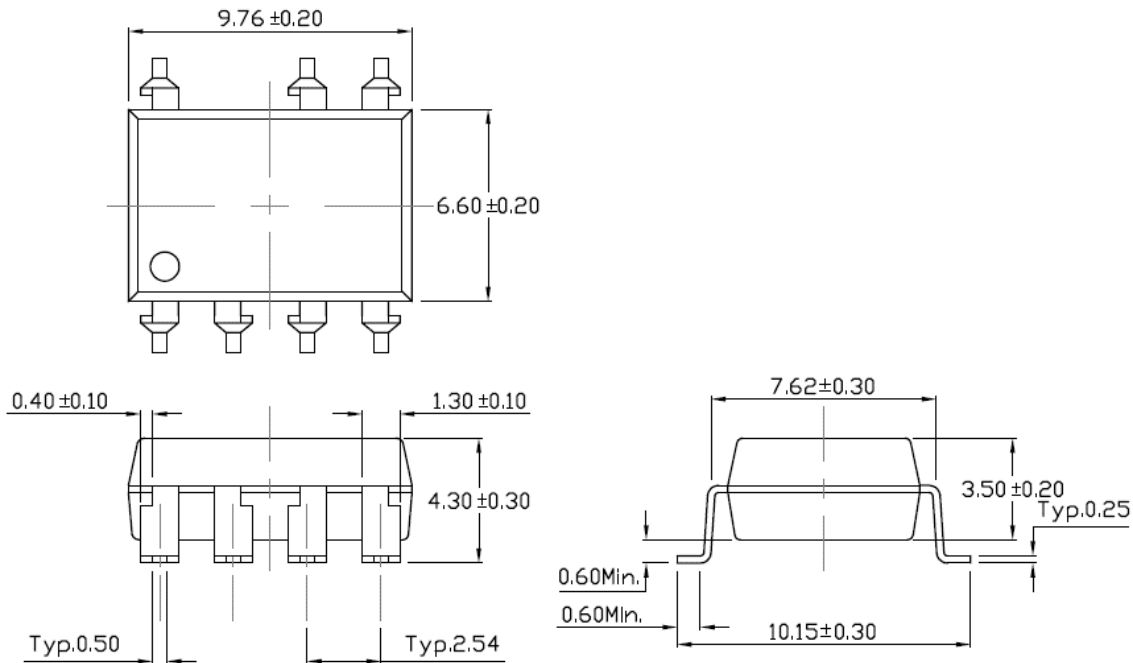

### Surface Mount (Low Profile) Lead Forming (SL Type)

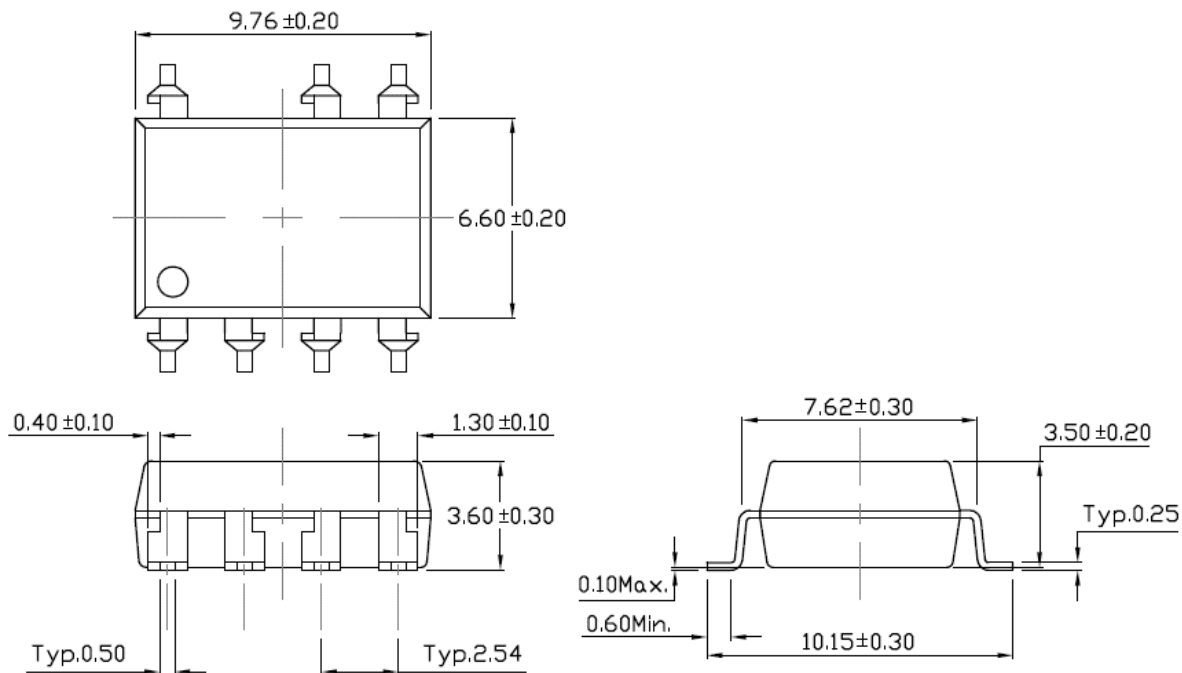



# CTT0223, CTT1223, CTT2223, CTT3223

## 600V Random Phase High Power Photo TRIAC

### Device Marking

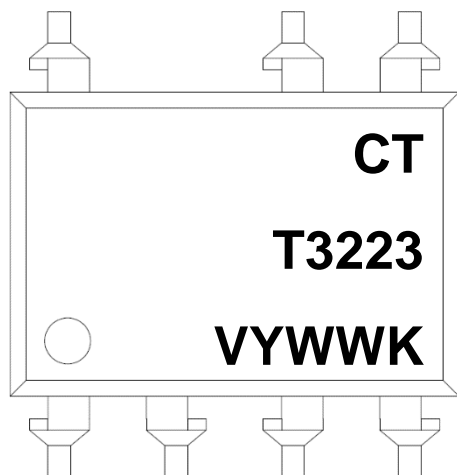

**Note:**

- CT : Denotes “CT Micro”
- T3223 : Product Number
- V : VDE Safety Mark (option)
- Y : Fiscal Year
- WW : Work Week
- K : Production Code

### Ordering Information

#### CTTX223(V)(Y)(Z)

- CT = Denotes “CT Micro”
- TX223 = Product Number (Current Rating Option X=0, 1, 2, or 3)
- V = VDE safety mark option (V, or none)
- Y = Lead form option (S, SL, M or none)
- Z = Tape and reel option (T1, T2 or none)

| <b>Option</b> | <b>Description</b>                                             | <b>Quantity</b> |
|---------------|----------------------------------------------------------------|-----------------|
| None          | Standard 8 Pin Dip                                             | 40 Units/Tube   |
| M             | Gullwing (400mil) Lead Forming                                 | 40 Units/Tube   |
| S(T1)         | Surface Mount Lead Forming – With Option 1 Taping              | 1000 Units/Reel |
| S(T2)         | Surface Mount Lead Forming – With Option 2 Taping              | 1000 Units/Reel |
| SL(T1)        | Surface Mount (Low Profile) Lead Forming– With Option 1 Taping | 1000 Units/Reel |
| SL(T2)        | Surface Mount (Low Profile) Lead Forming– With Option 2 Taping | 1000 Units/Reel |





# CTT0223, CTT1223, CTT2223, CTT3223

## 600V Random Phase High Power Photo TRIAC

### Carrier Tape Specifications *Dimensions in mm unless otherwise stated*

#### Option S(T1) & SL(T1)

Input Direction →

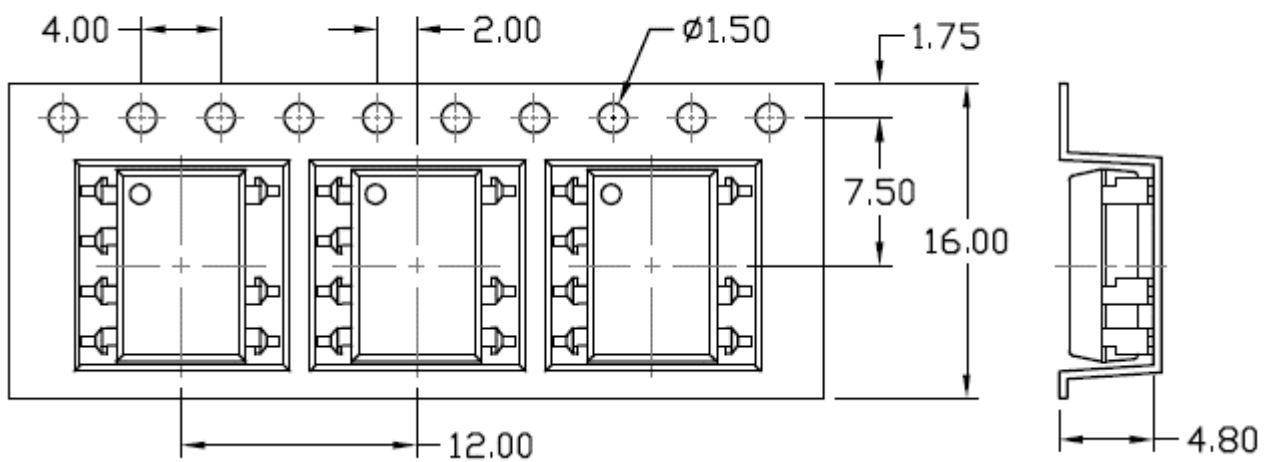

#### Option S(T2) & SL(T2)

Input Direction →

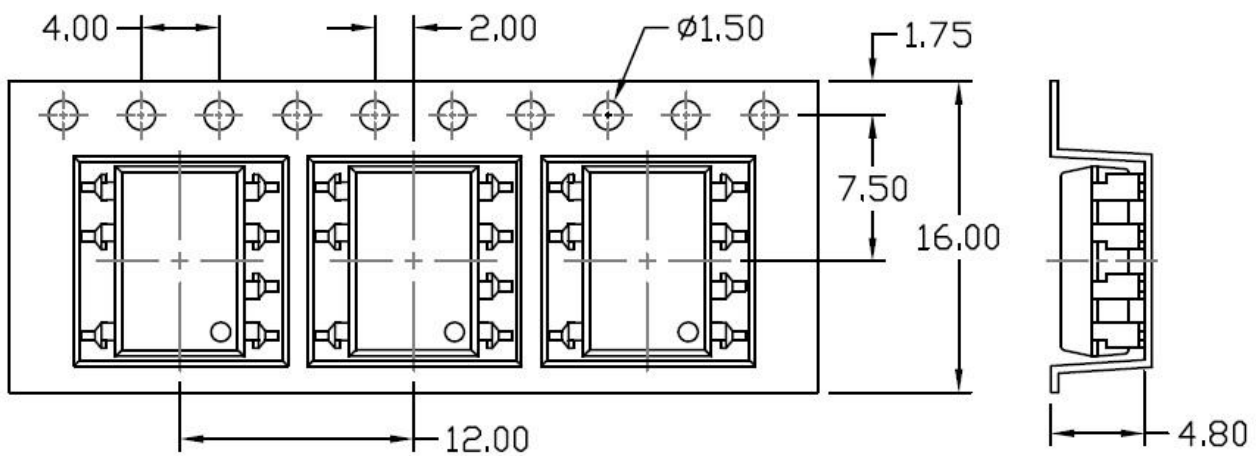



## CTT0223, CTT1223, CTT2223, CTT3223 600V Random Phase High Power Photo TRIAC

### Wave soldering (JEDEC22A111 compliant)

One time soldering is recommended within the condition of temperature.

Temperature:  $260 \pm 5^\circ\text{C}$ .

Time: 10 sec.

Preheat temperature: 25 to  $140^\circ\text{C}$ .

Preheat time: 30 to 80 sec.

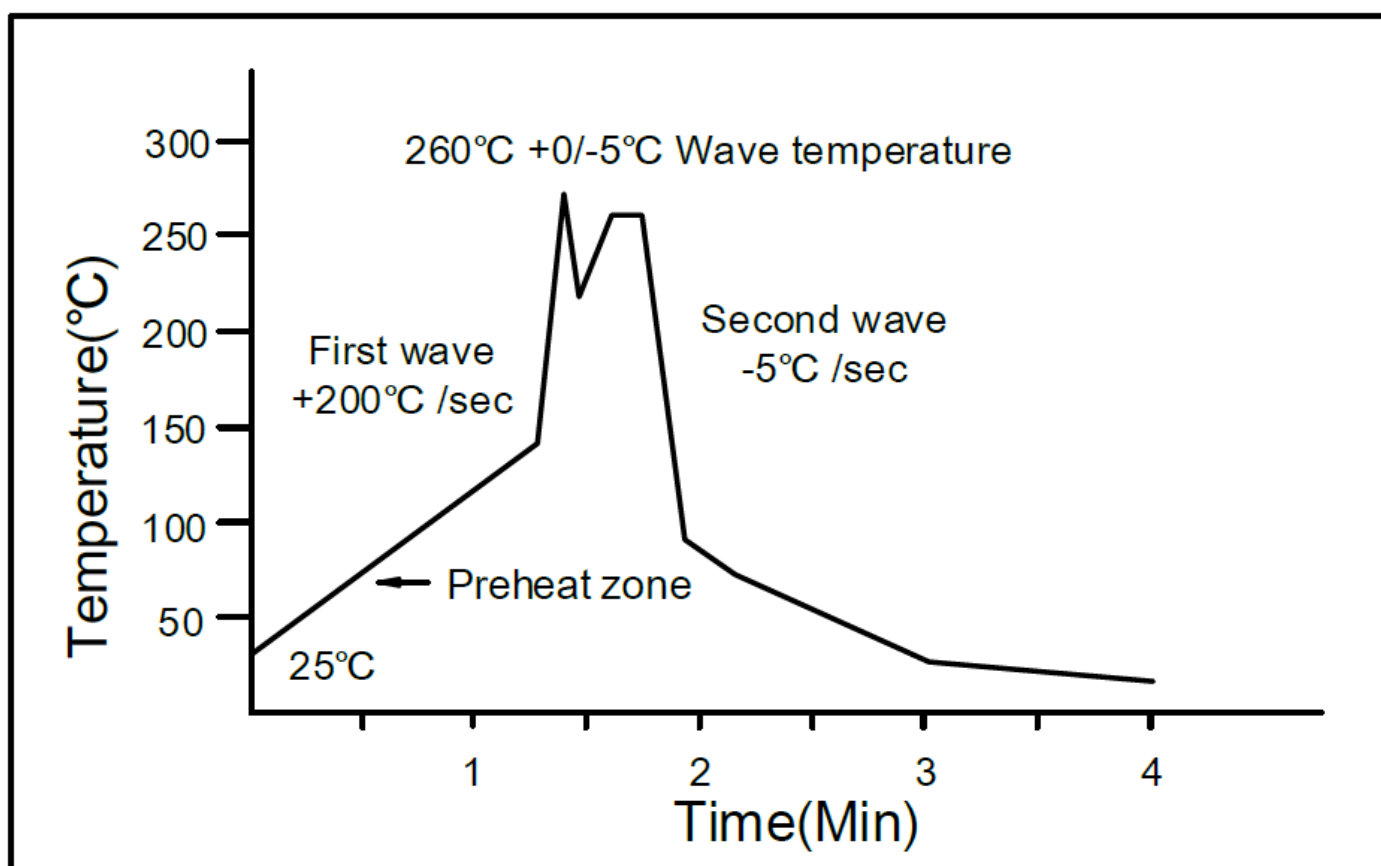

### Hand soldering by soldering iron

Allow single lead soldering in every single process.

One time soldering is recommended. Temperature:  $350 \pm 5^\circ\text{C}$

Time: 3 sec max.



# CTT0223, CTT1223, CTT2223, CTT3223

## 600V Random Phase High Power Photo TRIAC

### Reflow Profile

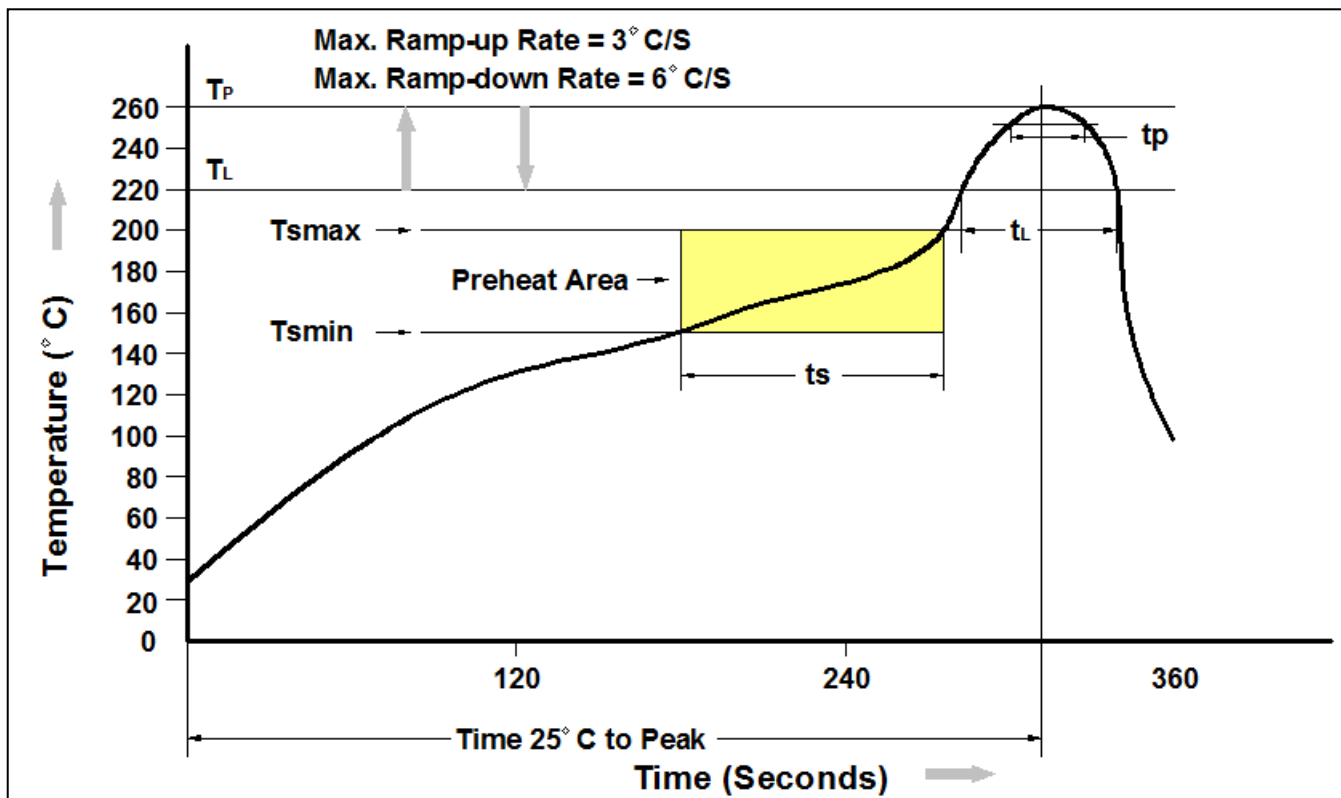

| Profile Feature                 | Pb-Free Assembly Profile |
|---------------------------------|--------------------------|
| Temperature Min. (Tsmin)        | 150°C                    |
| Temperature Max. (Tsmax)        | 200°C                    |
| Time (ts) from (Tsmin to Tsmax) | 60-120 seconds           |
| Ramp-up Rate (tL to tp)         | 3°C/second max.          |
| Liquidous Temperature (TL)      | 217°C                    |
| Time (tL) Maintained Above (TL) | 60 – 150 seconds         |
| Peak Body Package Temperature   | 260°C +0°C / -5°C        |
| Time (tp) within 5°C of 260°C   | 30 seconds               |
| Ramp-down Rate (TP to TL)       | 6°C/second max           |
| Time 25°C to Peak Temperature   | 8 minutes max.           |



# CTT0223, CTT1223, CTT2223, CTT3223 600V Random Phase High Power Photo TRIAC

---

## DISCLAIMER

CT MICRO RESERVES THE RIGHT TO MAKE CHANGES WITHOUT FURTHER NOTICE TO ANY PRODUCTS HEREIN TO IMPROVE RELIABILITY, FUNCTION OR DESIGN. CT MICRO DOES NOT ASSUME ANY LIABILITY ARISING OUT OF THE APPLICATION OR USE OF ANY PRODUCT OR CIRCUIT DESCRIBED HEREIN; NEITHER DOES IT CONVEY ANY LICENSE UNDER ITS PATENT RIGHTS, NOR THE RIGHTS OF OTHERS.

---

CT MICRO ARE NOT AUTHORIZED FOR USE AS CRITICAL COMPONENTS IN LIFE SUPPORT DEVICES OR SYSTEMS WITHOUT EXPRESS WRITTEN APPROVAL OF CT MICRO INTERNATIONAL CORPORATION.

- 1. Life support devices or systems are devices or systems which, (a) are intended for surgical implant into the body, or (b) support or sustain life, or (c) whose failure to perform when properly used in accordance with instruction for use provided in the labelling, can be reasonably expected to result in significant injury to the user.*
- 2. A critical component is any component of a life support device or system whose failure to perform can be reasonably expected to cause the failure of the life support device or system, or to affect its safety or effectiveness.*

## X-ON Electronics

Largest Supplier of Electrical and Electronic Components

*Click to view similar products for [Triac & SCR Output Optocouplers](#) category:*

*Click to view products by [CT Micro International](#) manufacturer:*

Other Similar products are found below :

[MOC3063S-TA](#) [ILD207-X001T](#) [ILD615-1X007T](#) [VO2223-X001](#) [VO4254H](#) [WPPCT-N1066A](#) [WPPCT-N1566A](#) [WPPCT-Z546D](#) [523170E](#)  
[VO2223A-X007T](#) [WPPCT-Z546A](#) [WPPCT-Z1046D](#) [WPPCT-Z1046A](#) [WPPCT-N566D](#) [WPPCT-N566A](#) [WPPCT-N1566D](#)  
[FODM3053V\\_NF098](#) [TLP3042SCF](#) [VO4258D](#) [VO4256D](#) [VO4156D-X007T](#) [VO4158H-X017T](#) [MOC3071SM](#) [MOC3063STA1-V](#) [IL4116-](#)  
[X007](#) [MOC3072SM](#) [VO0601-X001T](#) [OR-M3052](#) [MOC3020XSM](#) [MOC3021X](#) [MOC3021XSM](#) [MOC3022X](#) [MOC3023SR2M](#)  
[MOC3041SM](#) [MOC3042XSM](#) [MOC3043SR2M](#) [MOC3043X](#) [MOC3043XSM](#) [MOC3052SM](#) [MOC3063X](#) [MOC3081X](#) [MOC3081XSM](#)  
[IS620XSM](#) [IS623X](#) [VO3062-X007T](#) [VO3063-X006](#) [PC3SG21YIZ](#) [MOC3020](#) [MOC3020X](#) [MOC3022](#)