

This drawing is the property of Tusonix, Inc., and may not be used, reproduced, published or disclosed to others without expressed authorization by Tusonix Inc.

MARKETING SALES DRAWING
DIMENSIONS IN INCHES - DO NOT SCALE THIS DRAWING
DIMENSIONS IN METRIC - []

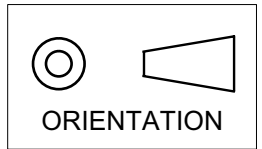

Electrical Testing
per Tusonix standard
test plans and Mil-Std-202
Test Methods.

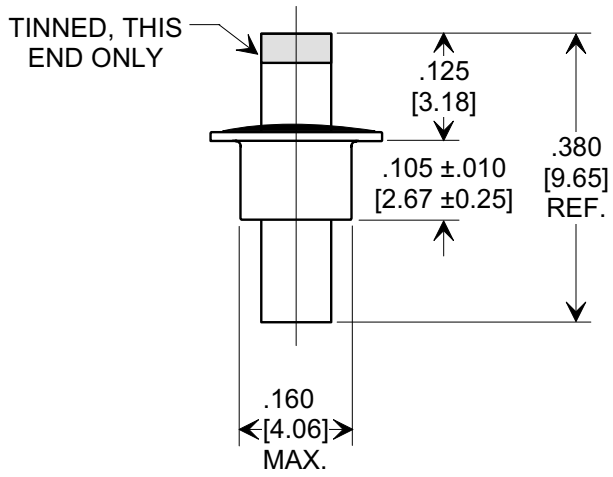
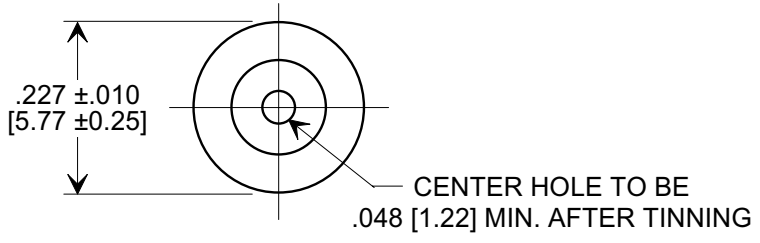
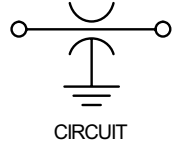

SPECIFICATIONS

Capacitance:	100 pF
Tolerance:	±10%
Temp. Coef.:	X5U
Operating Temp.:	-55°C TO 85°C
Voltage Rating:	500 VDC @ + 85°C
DWV:	875 VDC
IR MIN. @ 100 VDC:	10 GΩ

REVISION RECORD	Original Release	20060119-2-02
	C.O.	
	WAS SK 8188-645.S.M. 01-23-06	
	0	

--TOLERANCES--
 Unless Otherwise Specified

DECIMAL ± .015 [0.38]

ANGLES ±

TUSONIX
 TUCSON, ARIZONA

Title
FEED - THRU CAPACITOR

Drawn **S.M. 10-21-05** Scale **4 X**

Approved **T.C. 10-21-05**

A **2404-699-X5U0-101K**

X-ON Electronics

Largest Supplier of Electrical and Electronic Components

Click to view similar products for [EMI Feedthrough Filters](#) category:

Click to view products by [CTS](#) manufacturer:

Other Similar products are found below :

[FN7511-32-M4](#) [FN7660-100-M8](#) [FN7660-200-M10](#) [2443-007-X5S0-102MLF](#) [2463-001-X5S0-471MLF](#) [SCI-9925-303](#) [1609992-3](#) [1609993-1](#) [FN7510-100-M8](#) [FN7511-200-M10](#) [FN7562-100-M8](#) [FN7562-200-M10](#) [FN7563-100-M8](#) [FN7611-10-M3](#) [2450-000-X5U0-102PLF](#) [2499-003-X5S0-152MLF](#) [4202-025](#) [4251-001LF](#) [4253-002LF](#) [4300-523LF](#) [4305-001LF](#) [4306-019LF](#) [4403-010LF](#) [4600-072LF](#) [4403-060](#) [4600-067](#) [100AFC6-G](#) [10AFC6-B](#) [1-1609990-7](#) [1-1609990-1](#) [FN7510-16-M4](#) [FN7514-32-M4](#) [2461-010-X7V0-102AA](#) [FN7611-32-M4](#) [FN7660-10-M3](#) [SXD1A3-251](#) [2499-003-X5S0-102M](#) [4206-502](#) [M15733/62-0002](#) [4305-006LF](#) [4306-011LF](#) [4300-314-2](#) [4251-002LF](#) [4305-005LF](#) [2461-002-X7V0-102MLF](#) [4403-005](#) [CK70AW152M](#) [4311-001LF](#) [4101-500](#) [32DFC6-N](#)