

For 4 Through 18 Circuits

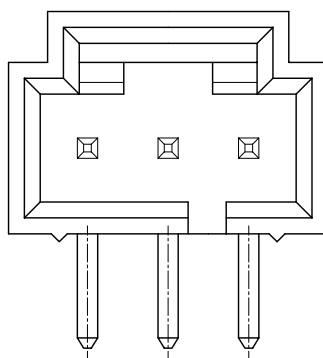

For 3 Circuits

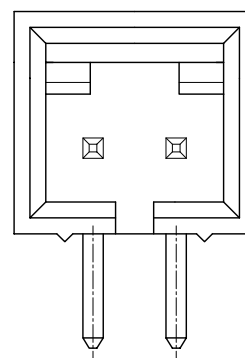

For 2 Circuits

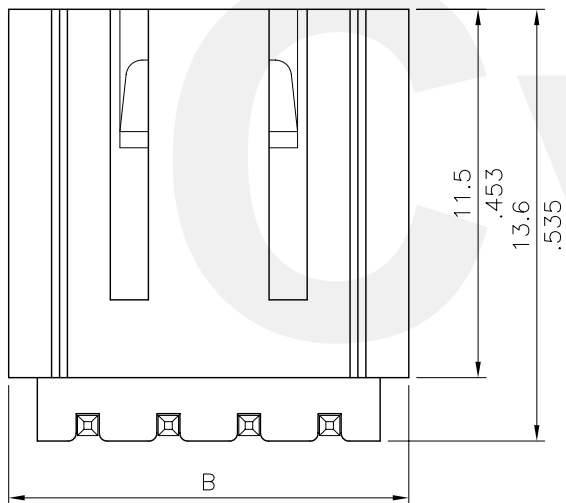

A = 2.54 x No. of Spaces

B = A + 5.1

C = A + 2.98

\* Available in 2 through 18 circuits

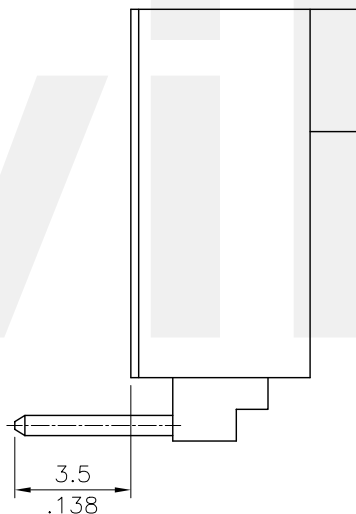

Material:

\* Insulation: Glass filled polyester UL 94V-0

\* Contact: Brass

Ordering Code:

CI33 \*\* P 1 H 1 0  
 ① ② ③ ④ ⑤ ⑥ ⑦

- ① Series No.
- ② No. of Circuits
- ③ Contact type: P= Pin header
- ④ Plating option:
  - 1= 3.05 $\mu$ m(120 $\mu$ "") Min. Tin over 0.76 $\mu$ m(30 $\mu$ "") Nickel
  - 2= Gold flash plated over 1.27 $\mu$ m(50 $\mu$ "") Nickel
  - 3= 0.38 $\mu$ m(15 $\mu$ "") Gold plated over 1.27 $\mu$ m(50 $\mu$ "") Nickel
  - 4= 0.76 $\mu$ m(30 $\mu$ "") Gold plated over 1.27 $\mu$ m(50 $\mu$ "") Nickel
- ⑤ Tail Style: H= Right angle
- ⑥ Color: 1= Black
- ⑦ Option:

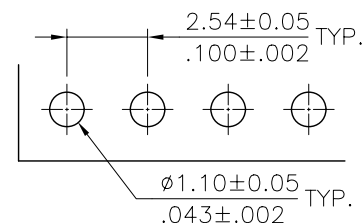

Recommended P.C. Board Layout

RoHS Compliant

④					DATE	UNIT: mm / inch	TITLE: 2.54MM(.100") RIGHT ANGLE HEADER	瀚荃股份有限公司 CviLux Corporation	
③				DRAWN BY: Eisley	05/20-02'	TOLERANCE UNLESS OTHERWISE SPECIFIED	MATERIAL:		
②				ENGINEER: David	05/20-02'	.X ± 0.30/.012 X' ± 1'			
①				CHECKED BY: David	05/20-02'	.XX ± 0.20/.008 X' ±	FINISH:		
SYM	NAME	DATE	REVISIONS	APPROVED BY: Alex	05/20-02'	.XXX ± 0.10/.004 .XX' ±	DRAWING NO. CI3302SD	PART NO. CI33**P*H10	
								SCALE 4 / 1	SHEET 1 OF 1

## X-ON Electronics

Largest Supplier of Electrical and Electronic Components

*Click to view similar products for [Headers & Wire Housings](#) category:*

*Click to view products by [Cvilux](#) manufacturer:*

Other Similar products are found below :

[0015917161](#) [0022155065](#) [57102-F02-18ULF](#) [58102-G61-06LF](#) [582553-1](#) [01.001.5753.1](#) [0050291907](#) [02.125.8002.8](#) [609-3404](#) [61062-3](#)  
[CSU011177004](#) [622-0430](#) [622-3653LF](#) [63453-116](#) [636-1030](#) [636-1427](#) [636-3427](#) [636-4007](#) [641938-9](#) [65495-038](#) [65692-001LF](#) [65781-018](#)  
[65781-047](#) [65817-010LF](#) [65817-015LF](#) [67095-007LF](#) [67601157](#) [68631-112](#) [68645-018](#) [699319-000](#) [70.362.1628.0](#) [70-4210](#) [70-4226B](#) [70-](#)  
[4853B](#) [71.350.2428.0](#) [733-134](#) [733-162](#) [760-3052](#) [MHR-64-VUAL](#) [80.063.4001.1](#) [800-90-001-10-001000](#) [801-43-002-10-013000](#)  
[801-43-006-10-002000](#) [803-43-024-10-001000](#) [803-93-012-10-001000](#) [8-1437020-4](#) [819-22-004-30-001101](#) [820-22-006-30-001101](#)  
[820-22-008-30-001101](#) [821-22-002-10-001101](#)