

Material & Finish :

* Insulation: Nylon 66, Color Nature

* Contact: Brass

Circuit Pattern Schedule:

See Drawing No: CP0111S*

Ordering Code:

CP-01 4 ** * * *
 ① ② ③ ④ ⑤ ⑥

- ① Series No.
- ② Type of Connector:
4= Right angle PCB mount header
- ③ No of Circuits:
- ④ Plating Code:
1= Tin over Nickel
2= Gold flash plated over Nickel
3= 0.38 μ m(15 μ) Gold plated over 1.27 μ m(50 μ) Nickel
4= 0.76 μ m(30 μ) Gold plated over 1.27 μ m(50 μ) Nickel
- ⑤ Variation:
4= UL 94V-2, With mounting pegs
5= UL 94V-0, With mounting pegs
- ⑥ Option: 0= Standard
1= Color Black
3= Color Red
7= Color Blue

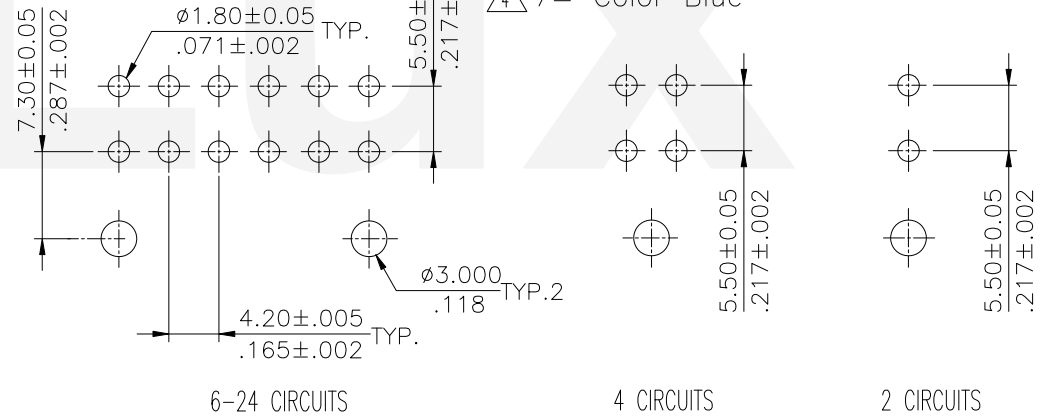
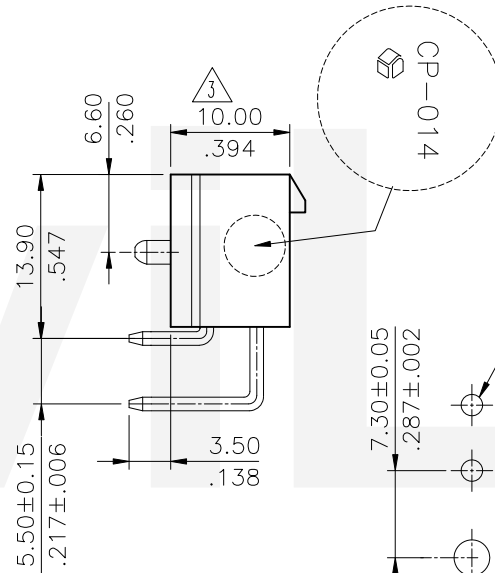
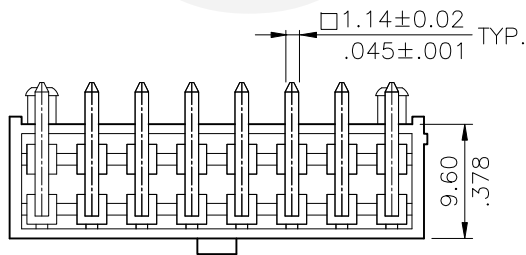
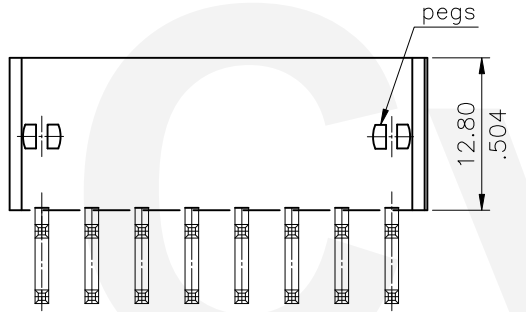
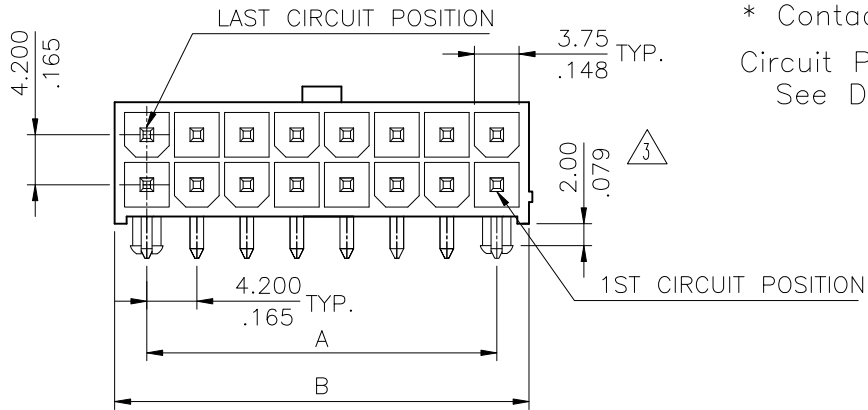

Recommended P.C. Board layout

Tin-Lead Process

RoHS compliant

SYM	NAME	DATE	REVISIONS	APPROVED BY:	DATE	UNIT: mm / inch	TITLE: RIGHT ANGLE HEADER CP-01 POWER CONNECTOR	MATERIAL:	FINISH:	DRAWING NO. CP0108SJ	PART NO. CP-014***4* CP-014***5*	SCALE 2 / 1	SHEET 1 OF 1
4	Karen	3/03-20	ECNT120051										
3	Eager	8/26-06	ECN06285	DRAWN BY: Karen	3/04-17'								
2	Sun	4/30/04'	ECN04150	ENGINEER: Sun	3/09-17'								
1	Jessie	9/26/03'	ECN03323	CHECKED BY: Eisley	3/12-17'								
				APPROVED BY: Eisley	3/12-17'								



瀚荃股份有限公司
CviLux Corporation

X-ON Electronics

Largest Supplier of Electrical and Electronic Components

Click to view similar products for [Headers & Wire Housings](#) category:

Click to view products by [Cvilux](#) manufacturer:

Other Similar products are found below :

[57102-F02-18ULF](#) [58102-G61-06LF](#) [0009485154](#) [009176003701906](#) [0050291907](#) [02.125.8002.8](#) [609-3404](#) [61062-3](#) [622-0430](#) [622-3653LF](#)
[63453-116](#) [636-1030](#) [636-1427](#) [636-3427](#) [636-4007](#) [641938-9](#) [644827-2](#) [65495-038](#) [65692-001LF](#) [65781-018](#) [65781-047](#) [65817-010LF](#)
[65817-015LF](#) [66207-023LF](#) [67016-026LF](#) [67095-007LF](#) [68631-112](#) [68645-018](#) [68648-049](#) [699319-000](#) [70.362.1628.0](#) [70-4210](#) [70-4226B](#)
[70-4853B](#) [707-5020](#) [707-5028](#) [71.350.2428.0](#) [71961-016LF](#) [733-134](#) [754199-000](#) [760-3052](#) [787-8014-00](#) [FCN-367T-T012/H](#) [80.063.4001.1](#)
[800-90-010-10-002000](#) [801-43-002-10-013000](#) [801-43-006-10-002000](#) [803-41-018-10-001000](#) [803-43-014-20-001000](#) [803-43-024-10-001000](#)