

## SWITCH FUNCTION

NO. POLES	UL/CSA MODEL NO.	MODEL NO.	SWITCH FUNCTION			CONNECTED TERMINALS / SCHEMATIC			
			POS.1	POS.2	POS.3	POS.1	POS.2	POS.3	
SP	Q11A11	1AS1	ON	NONE	ON		N/A		
	Q11A12	1AS2	ON	NONE	MOM	2-3		2-1	
	Q11A13	1AS3	ON	OFF	ON		OPEN		
	Q11A14	1AS4	MOM	OFF	MOM				
	Q11A15	1AS5	ON	OFF	MOM				
DP	Q11A21	1AD1	ON	NONE	ON		N/A		
	Q11A22	1AD2	ON	NONE	MOM	2-3,5-6		2-1,5-4	
	Q11A23	1AD3	ON	OFF	ON		OPEN		
	Q11A24	1AD4	MOM	OFF	MOM				
	Q11A25	1AD5	ON	OFF	MOM				
	▲	Q11A27	1AD7	MOM	ON	MOM	2-3,5-6	2-3,5-4	2-1,5-4
	▲	Q11A28	1AD8	ON	ON	MOM			
	3P	Q11A31	1A31	ON	NONE	ON		N/A	
Q11A32		1A32	ON	NONE	MOM	2-3,5-6,8-9		2-1,5-4,8-7	
Q11A33		1A33	ON	OFF	ON		OPEN		
Q11A34		1A34	MOM	OFF	MOM				
Q11A35		1A35	ON	OFF	MOM				

MOM=MOMENTARY

▲ Please check the availability in advance before order

## POLE OPTIONS

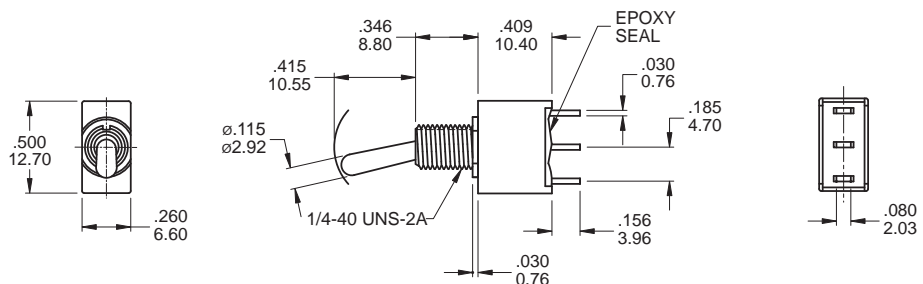

SPDT

Part No. Shown : 1AS1T1B1M1QES



1A  
Toggle Switches

# 1A Series

Sealed Miniature Toggle Switches



1A  
Toggle Switches

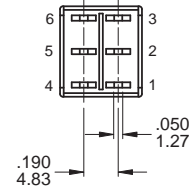
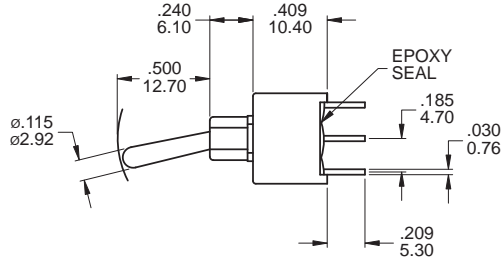
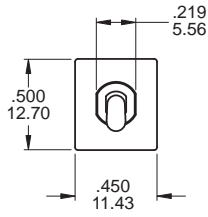

DPDT

Part No. Shown : 1AD1T1B4M2QES

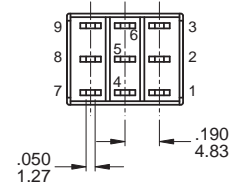
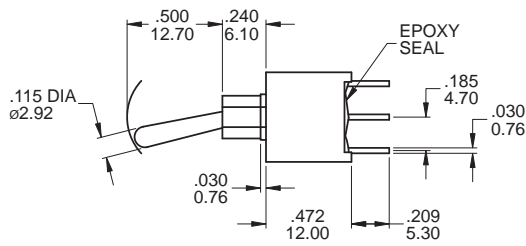
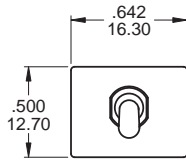

3PDT

Part No. Shown : 1A31T1B4M2QES

## ACTUATOR OPTIONS

Actuator shown with standard B4 Bushing,  
Subtract .085 (2.15) for B1 bushing.

T1

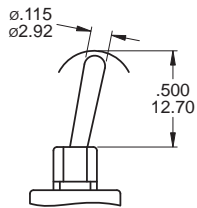

T2

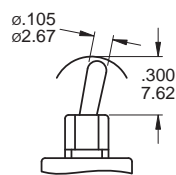

TA

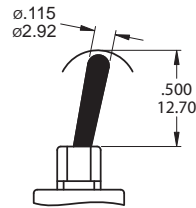

TB

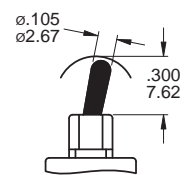

PLASTIC ACTUATOR  
(TC, Silver)

## BUSHING OPTIONS

B1

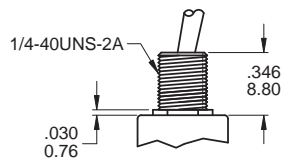

Std for M1

B4

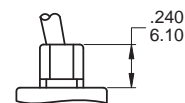

Std for M2, M6, M7, VS termination

### TERMINATION OPTIONS

#### M1 Solder lug

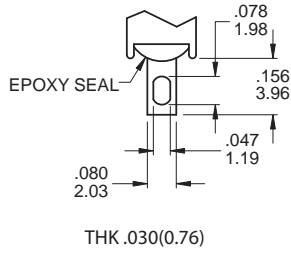

#### M2 PC Thru-hole

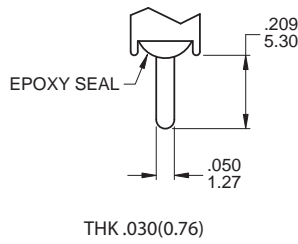

#### M3 Quick connect

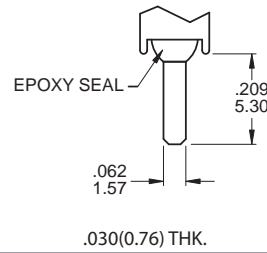

#### M5 Wire Wrap

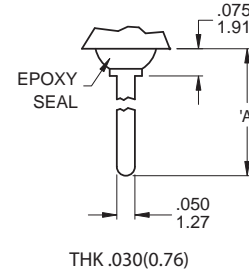

### OTHER TERMINATION OPTIONS

**M6** Right angle P.C. Mount

**M7** Vertical right angle P.C. Mount

**VS2** Vertical bracket P.C. Mount

**VS3** Vertical bracket P.C. Mount

**M6N** Right angle P.C. Mount with snap-in bracket

**V2N** Vertical bracket P.C. Mount with snap-in bracket

OPTION CODE	DIM. 'A'
M51	.736 ( 18.70 )
M52	.953 ( 24.20 )
M53	.415 ( 10.55 )
M54	1.062 ( 26.97 )



1A  
Toggle Switches

#### M6

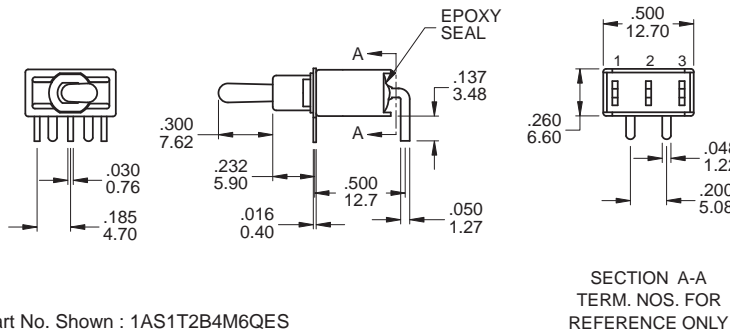

#### P.C. MOUNTING

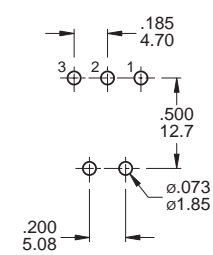

#### SPDT

Part No. Shown : 1AS1T2B4M6QES

#### M6

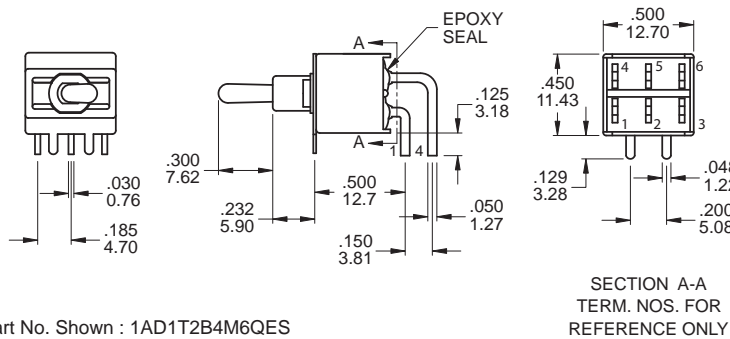

#### P.C. MOUNTING

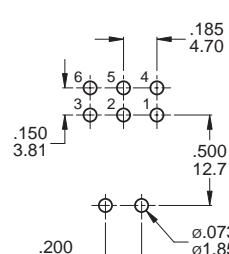

#### DPDT

Part No. Shown : 1AD1T2B4M6QES

#### M7

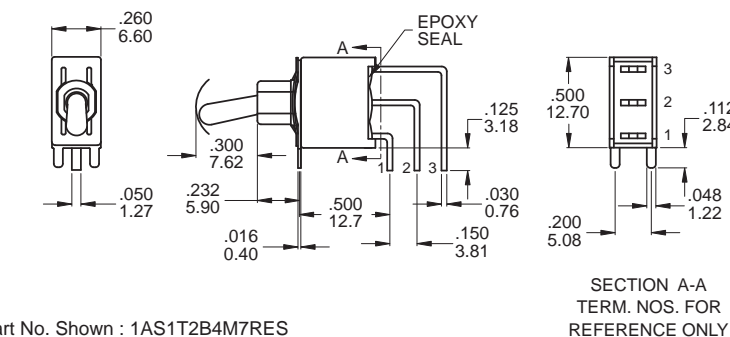

#### P.C. MOUNTING

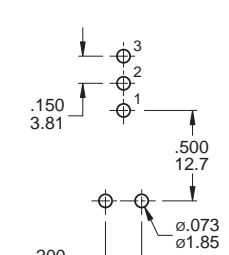

#### SPDT

Part No. Shown : 1AS1T2B4M7RES

# 1A Series

Sealed Miniature Toggle Switches



1A  
Toggle Switches

M7

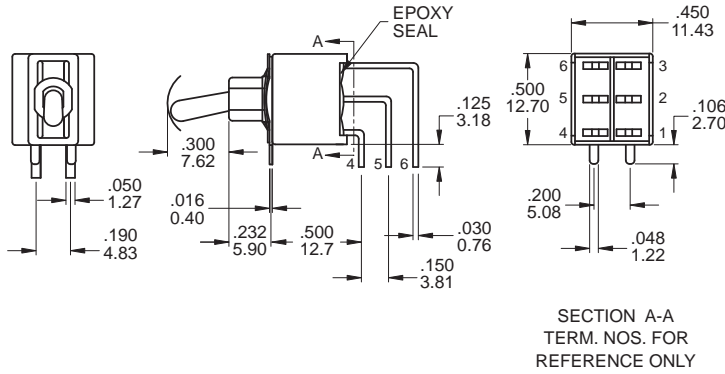
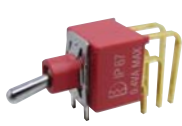

P.C. MOUNTING

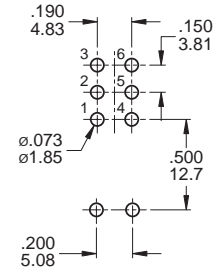

DPDT

Part No. Shown : 1AD1T2B4M7RES

M7

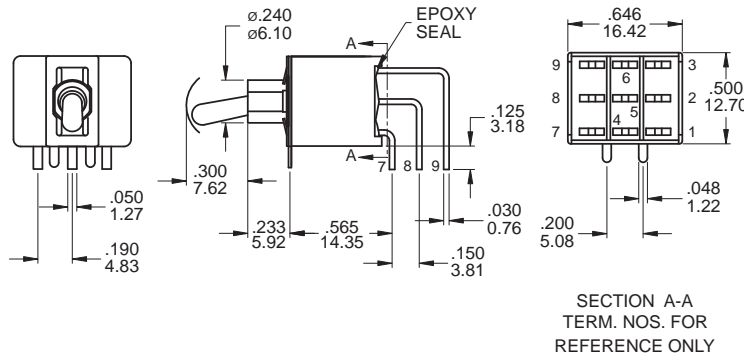

P.C. MOUNTING

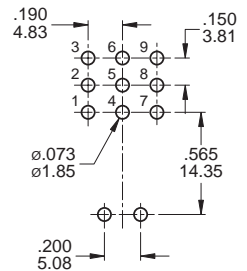

3PDT

Part No. Shown : 1A31T2B4M7QES

VS2 - VS3

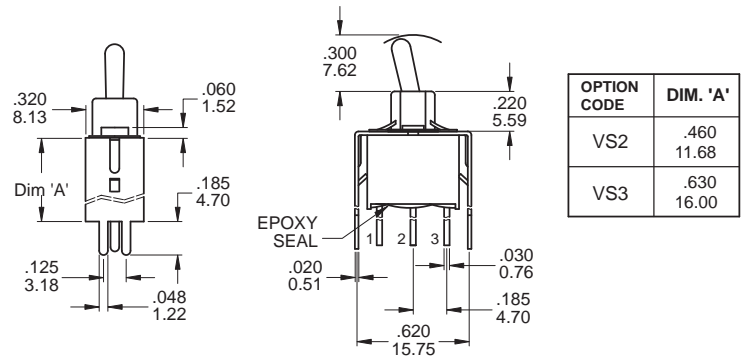

P.C. MOUNTING

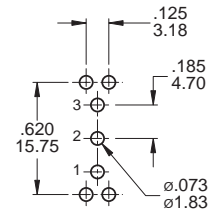

SPDT

Part No. Shown : 1AS1T2B4VS2QES

VS2 - VS3

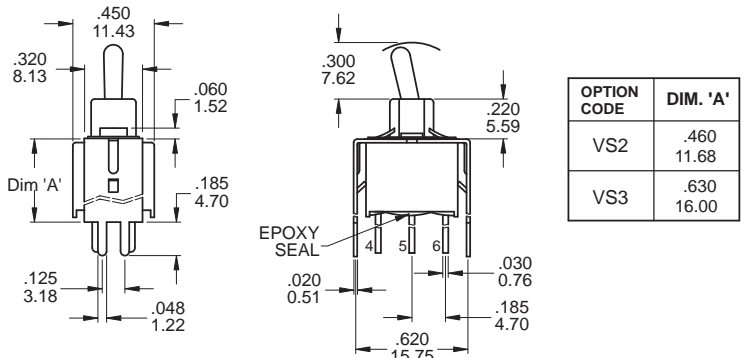

P.C. MOUNTING

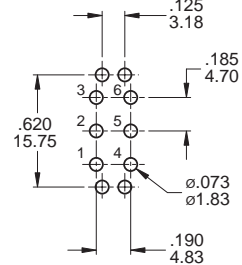

DPDT

Part No. Shown : 1AD1T2B4VS2QES

## VS2 - VS3

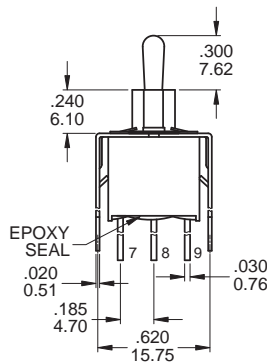
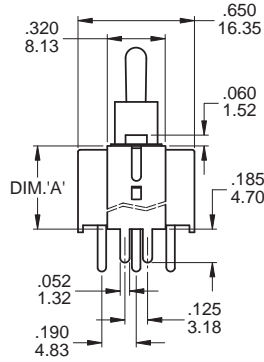

OPTION CODE	DIM. 'A'
VS2	.460 11.68
VS3	.630 16.00

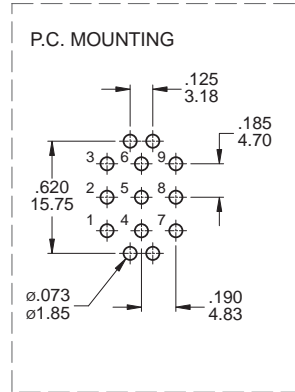

## 3PDT

Part No. Shown : 1A31T2B4VS2QEES



1A  
Toggle Switches

## SNAP-IN TERMINATION OPTIONS

### M6N

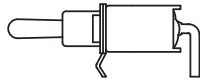

### V2N

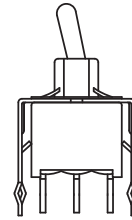

## HARDWARE

### 1/4 NUT

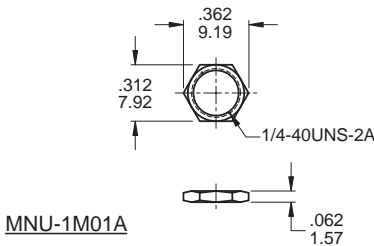

### LOCKING RING

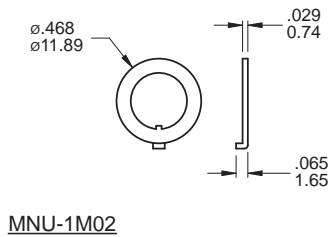

### LOCKWASHER

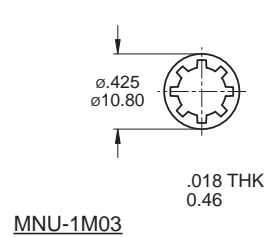

## CONTACT MATERIAL OPTIONS

	CONTACT PLATING	TERMINAL PLATING	RATINGS
<b>Q</b>	Silver	Q = Gold flash over silver	5 Amps with resistant load @ 120VAC or 28VDC 2 Amps with resistant load @ 250VAC
<b>C</b>	Gold over Silver	C = Gold over silver	
<b>R</b>	Gold	R = Gold	0.4 Volt - Amps ( VA ) max. @ 20V max. ( AC or DC )

## SOLDERING PROCESSES

**MANUAL SOLDERING:** Use soldering iron of 30 watts, controlled at 350°C approximately 5 seconds while applying solder.

**WAVE SOLDERING:** Recommended Soldering Temperature: 270 ± 5°C

Duration of Solder Immersion: Max 5 sec. (PCB is 1.6mm in thickness)

# 1A Series

Sealed Toggle Switches

## SPECIFICATIONS

**CONTACT RATING:** 0.4Volt-Amps(VA) max. @20V max(AC or DC)

**MECHANICAL LIFE:** 100,000 make-and-break cycles.

**ELECTRICAL LIFE:** 50,000 cycles.

**CONTACT RESISTANCE:** 10 mΩ max. initial @ 2-4VDC  
100mA for both silver and gold plated contacts.

**INSULATION RESISTANCE:** 1,000 MΩ min.

**DIELECTRIC STRENGTH:** 1,000 V RMS@sea level.

**OPERATING TEMPERATURE:** -30°C to 85°C.

## GENERAL SPECIFICATIONS

**TORQUE:** 0.8Nm max. applied to unt.

**PANEL THICKNESS:** 6mm max. ,2mm min.

## MATERIALS

**CASE & BUSHING:** Glass filled nylon 6/6, flame retardant, heat stabilized (UL94v-0).

**ACTUATOR:** Brass, chrome plated with internal, O-ring seal standard.

**SWITCH SUPPORT:** Brass or steel, tin plated.

**CONTACT / TERMINALS:** Copper alloy, gold plated.

**SEALIND:** IP67.

IP 67  
ACCORDING TO  
EN 60529 1991+A1:2001  
IEC 60529:2001



## SWITCH FUNCTION

NO. POLES	MODEL NO.	SWITCH FUNCTION			CONNECTED TERMINALS / SCHEMATIC		
		POS.1	POS.2	POS.3	POS.1	POS.2	POS.3
SP	1AS1	ON	NONE	ON	2-3	N/A	2-1
	1AS2	ON	NONE	MOM			
	1AS3	ON	OFF	ON			
	1AS4	MOM	OFF	MOM			OPEN
	1AS5	ON	OFF	MOM			
	1AS9	ON	NONE	OFF	2-3	N/A	OPEN
	1ASD	MOM	NONE	OFF			

MOM=MOMENTARY

## M1

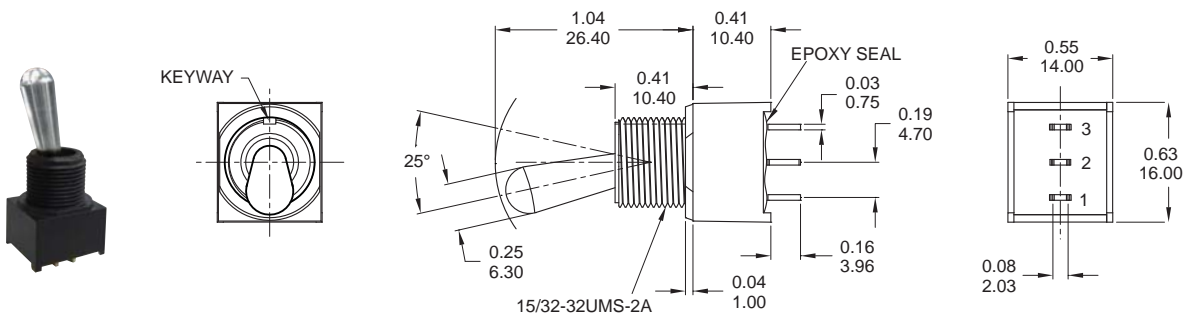

Part No. Shown : 1AS1T8B22M1RPES

## PANEL MOUNTING / HARDWARE

### PANEL MOUNTING

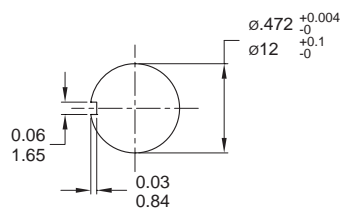

### NUT

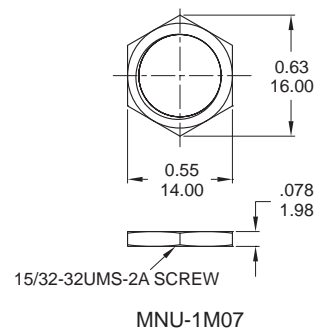

### SEALING BOOTS

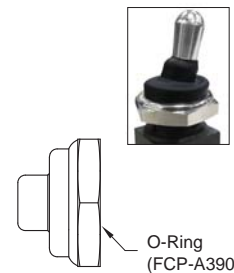
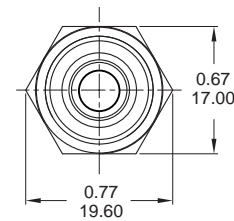

## X-ON Electronics

Largest Supplier of Electrical and Electronic Components

*Click to view similar products for [Toggle Switches](#) category:*

*Click to view products by [Dailywell](#) manufacturer:*

Other Similar products are found below :

[8928K478](#) [8951K2998](#) [8951K3310](#) [8956K1283](#) [8956K1286](#) [8956K1287](#) [8961K155](#) [8A1-C-222](#) [020017-13](#) [0090-0001](#) [0121-0015](#) [CS115W](#)  
[CS120W](#) [CS215I](#) [CS8275](#) [637H/25](#) [6663](#) [7101SPDV30BE](#) [7103SDV30BE](#) [7105D](#) [7108P3YAV2BE](#) [71YY50282](#) [7209SY9AQE](#)  
[7209SYCBE](#) [7300K36](#) [7301K38](#) [7301SS24484](#) [7303KZQE](#) [7306K36](#) [7310K36](#) [7503K21](#) [7506K4](#) [7565K6](#) [7595K6](#) [7660K12](#) [7691K14](#)  
[7700K1](#) [7704K3](#) [8391K108](#) [8396K108](#) [8811K17](#) [8812K14](#) [8825K5](#) [8828K13](#) [8835K3](#) [8858K44](#) [8E4011](#) [1202W](#) [A201SCWZB04](#)  
[A207SYCB04](#)