

MPB19 Series

19mm Metal Pushbutton Switches



SPECIFICATIONS

- RATING** : Ith 5A/250VAC resistive load 3A/250VAC
- CONTACT RESISTANCE** : 50 mΩ max. @ 1A 12VDC (initial value)
- INSULATION RESISTANCE** : 1,000 MΩ min. at 500VDC
- DIELECTRIC STRENGTH** : 2,000V RMS @ sea level
- OPERATION TEMPERATURE** : -20°C to 55°C
- MECHANICAL LIFE** : Momentary 1,000,000 cycles
Self-lock 500,000 cycles
- ELECTRICAL LIFE** : 50,000 make-and-break cycles at full load
- TORQUE** : 5~14Nm
- PANEL THICKNESS** : 10mm (Ø19.20mm)
- OPERATION PRESSURE** : 1Pole 2.5±1N / 2Poles 3.5±1N
- TRAVEL** : About 3.2mm
- INGRESS PROTECTION** : IP67, IK10(Stainless)

MATERIALS

- BUSHING** : Stainless Steel / Nickel plated brass / Aluminum alloy
- BASE** : PBT(UL 94-V0) , PC(UL 94-V2)
- ACTUATOR** : PC(UL 94-V2) ; Stainless Steel / Nickel plated brass / Aluminum alloy
- INNER ASSEMBLY** : POM / PA66.
- SPRING** : Spring steel.
- SEALING** : Silicone.
- O-Ring** : Silicone.
- TERMINAL** : Brass, with silver or gold plated.
- CONTACT** : Brass, coin silver, with silver or gold plated.
- HEX NUT** : Nickel plated brass.



MPB19 Pushbutton Switches

HOW TO ORDER



MODEL NO. BODY TYPE BUTTON TYPE CONTACT CONFIGURATION OPERATING TYPE LIGHT TYPE LED COLOR LED VOLTAGE TERMINAL SHAPE TERMINAL PLATING

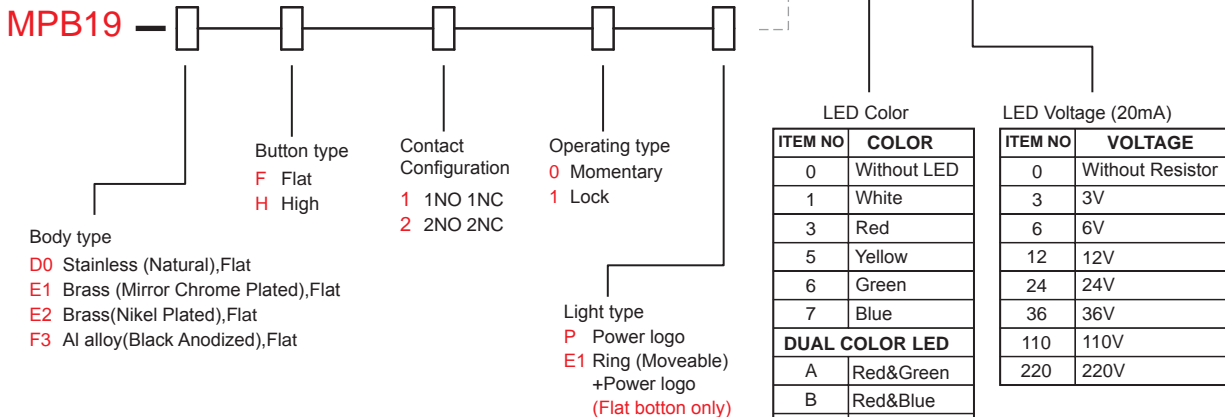
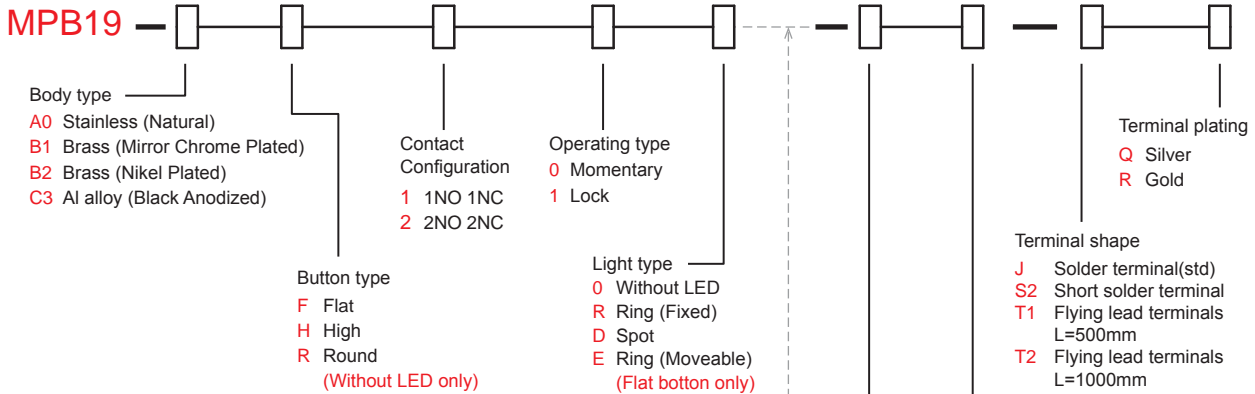

ITEM NO	COLOR
0	Without LED
1	White
3	Red
5	Yellow
6	Green
7	Blue
DUAL COLOR LED	
A	Red&Green
B	Red&Blue
D	Blue&Yellow
G	Red&Yellow
H	Green&Yellow
J	Orange&Green

ITEM NO	VOLTAGE
0	Without Resistor
3	3V
6	6V
12	12V
24	24V
36	36V
110	110V
220	220V

EXAMPLE:
 MPB19-A0F100-JQ (Without LED)
 MPB19-A0F10R-□-JQ
 LED color — LED voltage

CIRCUIT

POSITION 1



Without LED (1 Pole)

POSITION 2



POSITION 1

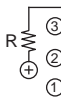

Single Color Led (1 Pole)

POSITION 2

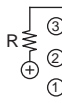

POSITION 1



Dual Color Led (1 Pole)

POSITION 2

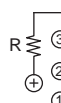

POSITION 1

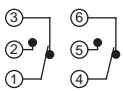

Without LED (2 Poles)

POSITION 2

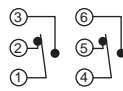

POSITION 1



Single Color Led (2 Poles)

POSITION 2



POSITION 1



Dual Color Led (2 Poles)

POSITION 2



BODY TYPE

A0/B1/B2/C3 Body

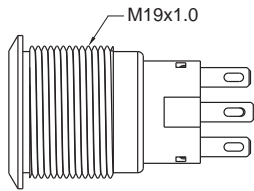

D0/E1/E2/F3 Body (Flat)

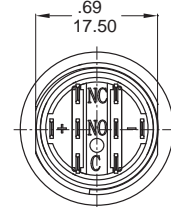
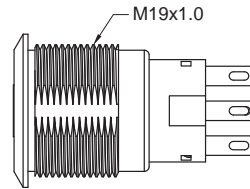
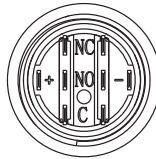

BUTTON TYPE

F Flat Button

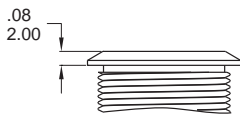

H High Button

* Ring (Moveable) light type is inapplicable

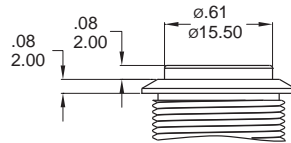

R Round Button

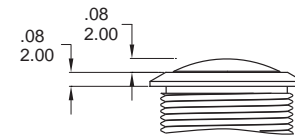

LIGHT TYPE

O Without LED

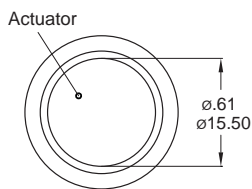

R Ring (Fixed)

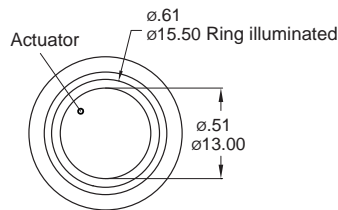

D Spot

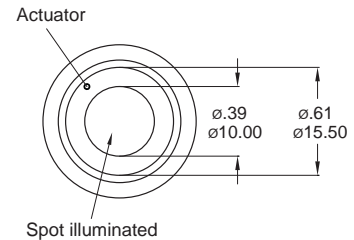

E Ring (Moveable)

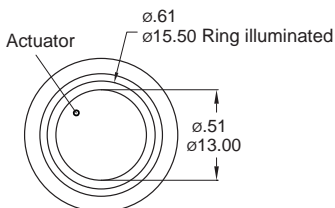

P Power logo

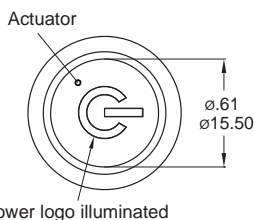

Power logo illuminated

E1 Ring (Moveable)+Power logo

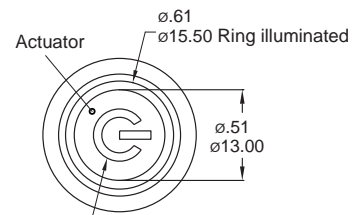

Power logo illuminated

* Only for A0,B1,B2,C3 body.

* Only for D0,E1,E2,F3 body.

* E1 light type only for D0,E1,E2,F3 body.



MPB19
Pushbutton Switches

MPB19 Series

19mm Metal Pushbutton Switches

FLAT BUTTON TYPE

0 Without LED

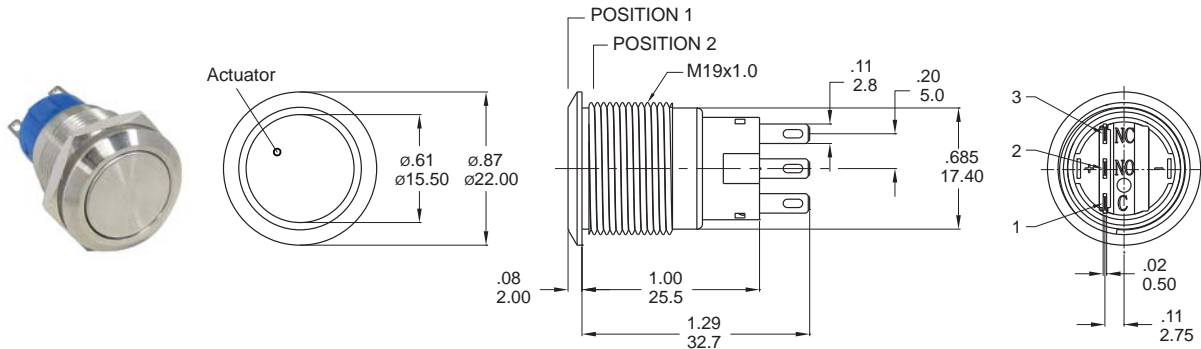

Part No. Shown : MPB19-A0F1□□0-JQ

R Ring (Fixed)

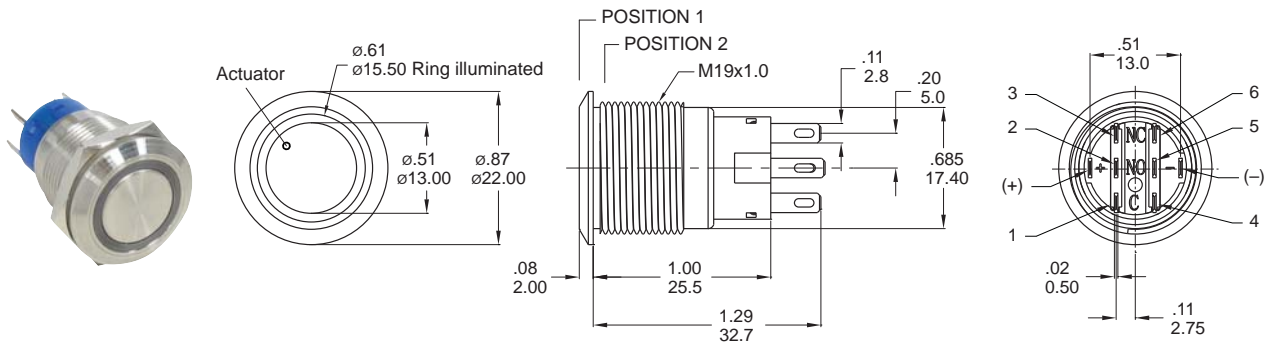

Part No. Shown : MPB19-A0F2□□R-□□-JQ

D Spot

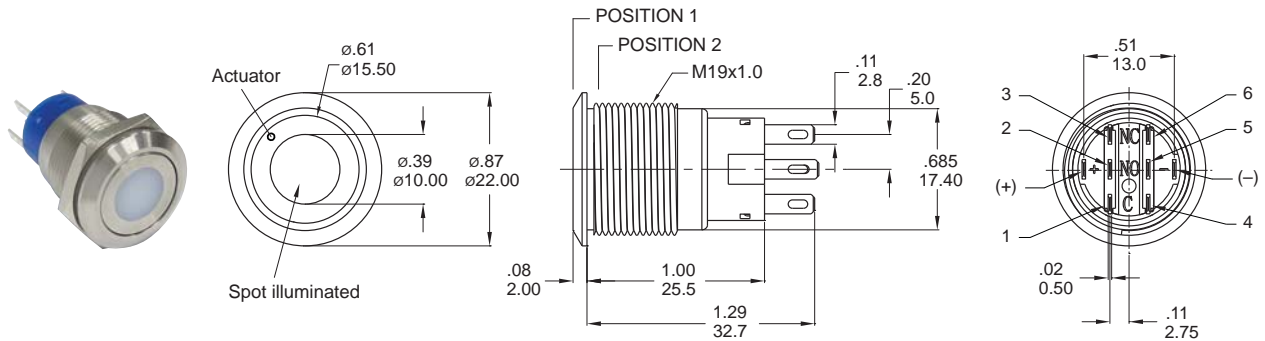

Part No. Shown : MPB19-A0F2□□D-□□-JQ

E1 Ring (Moveable)+Power logo
(Flat Button only)

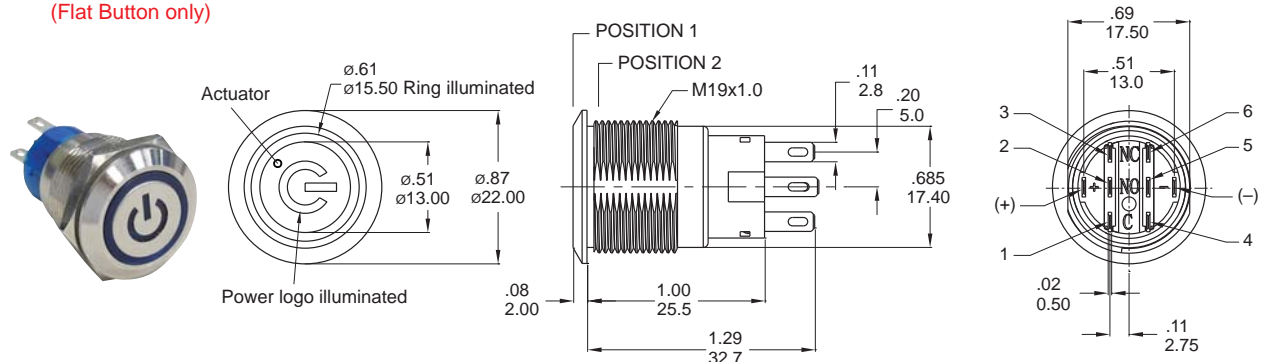

Part No. Shown : MPB19-D0F2□□E1-□□-JQ



MPB19
Pushbutton Switches

HIGH BUTTON TYPE

0 Without LED

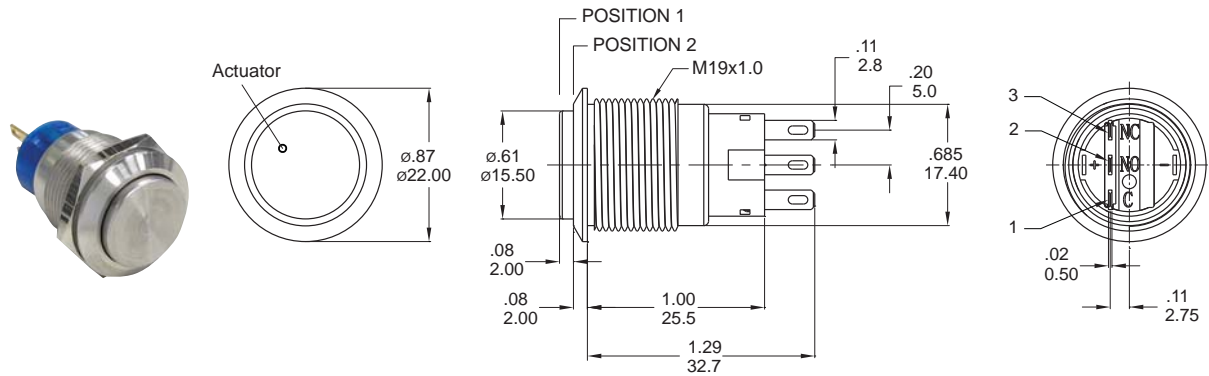

Part No. Shown : MPB19-A0H1□0-JQ

R Ring (Fixed)

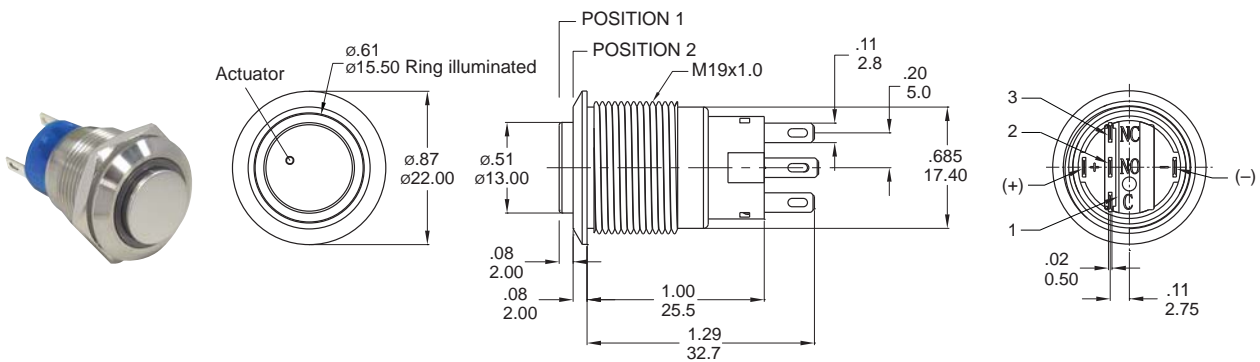

Part No. Shown : MPB19-A0H1□R-□□-JQ

P Power logo

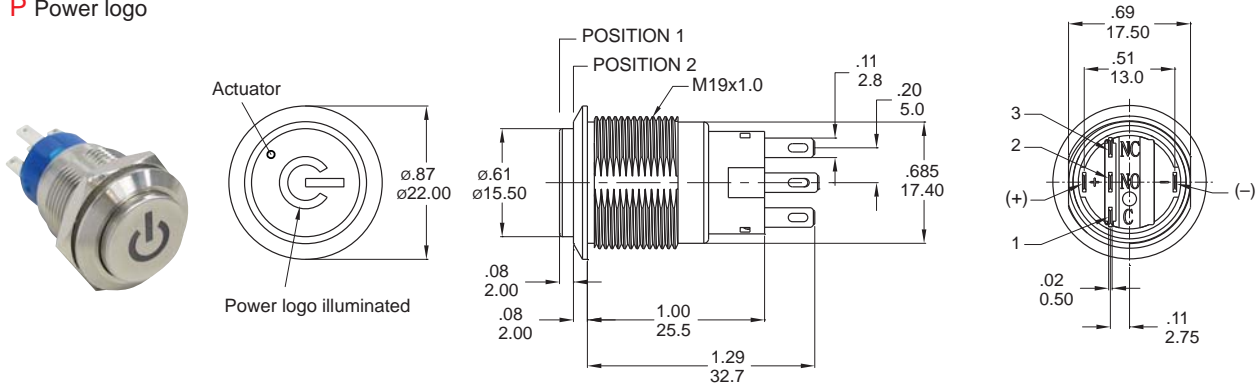

Part No. Shown : MPB19-D0H1□P-□□-JQ

ROUND BUTTON TYPE

0 Without LED only

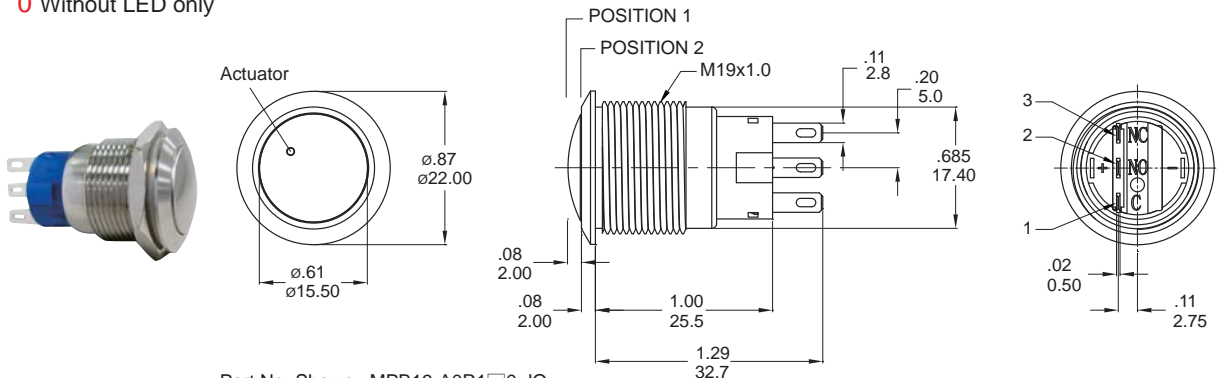

Part No. Shown : MPB19-A0R1□0-JQ



MPB19
Pushbutton Switches

MPB19 Series

19mm Metal Pushbutton Switches

TERMINAL TYPE

J Solder terminal (std)

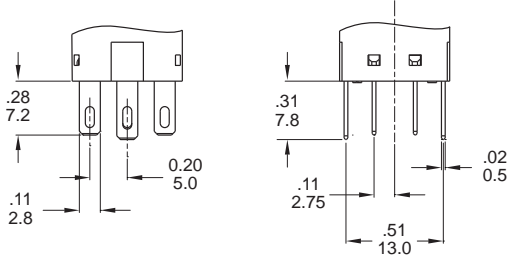

S2 Short solder terminal

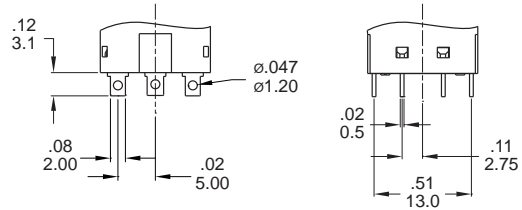

Wire (Flying lead Terminals)

* Wire=UL 3385,18AWG,300V(Black/Yellow/Green/Red/Purple)

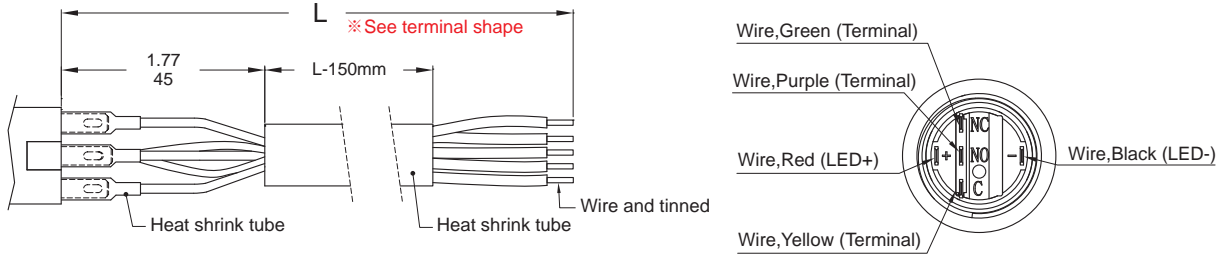

O/R/D/E Light Type

P Light Type

PANEL MOUNTING

Max. Panel thickness: 10.0mm[.39]

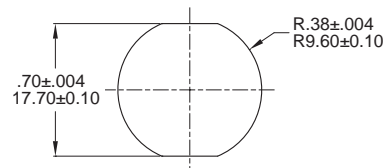
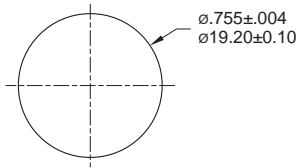

ASSEMBLED VIEW

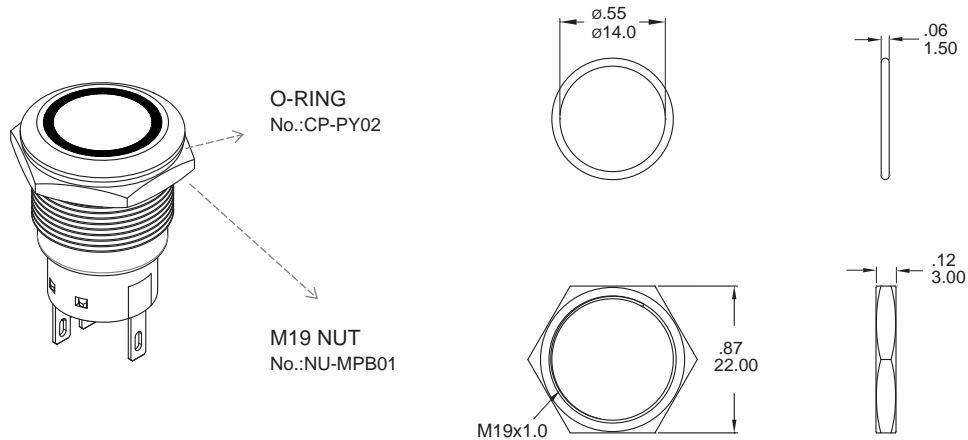

O-RING INSTALLATION

Proposal	In front of the panel	Behind the panel
Installation Diagram		

X-ON Electronics

Largest Supplier of Electrical and Electronic Components

Click to view similar products for [Pushbutton Switches](#) category:

Click to view products by [Dailywell](#) manufacturer:

Other Similar products are found below :

[8940K2012](#) [LW1L-M1C10V-A](#) [LW1L-M1C70-A](#) [LW2L-A1C20M-GD](#) [LW2L-M1C20M-A](#) [60324L](#) [M22-D-R-GB0/K11](#) [M7E-HRN2](#)
[67021K512](#) [67081K512X](#) [701PB580](#) [7199K101](#) [810K12910](#) [810KSV30B](#) [MML21EA2ADK](#) [MML21KA3ABK](#) [MML23KA3AC05K-001](#)
[MML23KW3AA01W](#) [8418K2](#) [8442K3](#) [8450K1](#) [860K11911T01A](#) [861901](#) [861K11911T01A07](#) [861K13810T00A14](#) [861K13911](#)
[8646AB6X718UL](#) [8646ABUL](#) [9001KXRK](#) [907AYY100](#) [PMHD155A1](#) [9533CD4+U574+U4922](#) [95-414.000](#) [99-450.837](#) [99-453.837](#)
[PV3H2B0NN-341](#) [1203MRA](#) [A22NZBGANGA](#) [A22NZBNANGA](#) [A22NZMPATRA](#) [A2PMA1X03EC56](#) [A3A-5123-02](#) [A3A-7140](#) [A3A-7310](#) [A3A-7340](#) [A3U-TMW-A2C-5M](#) [A595](#) [12037A2ULCSA](#) [ABD122N-B](#) [1211390004](#)