

REV	LOOKS	DESCRIPTION	DRAWN	DATE
A0	NEW	PERLIMINARY	Long	2018.08.27
A1		UPDATED	LUU	2019.06.17
A2	Δ	UPDATED	LUU	2019.08.28

SPECIFICATIONS

Current Rating: 9A AC,DC
Voltage Rating: 800V AC,DC
Temperature Range: -25°C ~ +85°C
Contact Resistance: 10mΩ Max.
Insulation Resistance: 1000MΩ Min.
Withstanding Voltage: 1500V AC/minute
Pin Material: Brass/Tin-plated
Material: Nylon 66, UL94V-0
Color: Natural(Translucent)

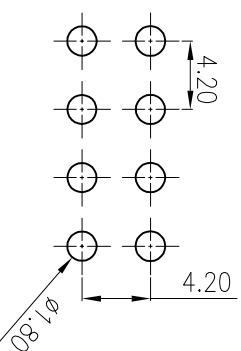

RECOMMENDED PCB LAYOUT
TOLERANCE: ±0.05

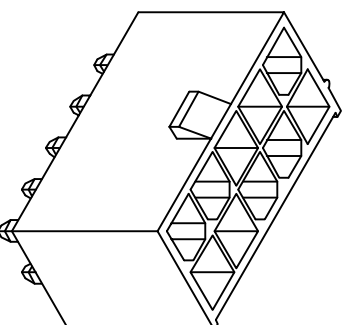
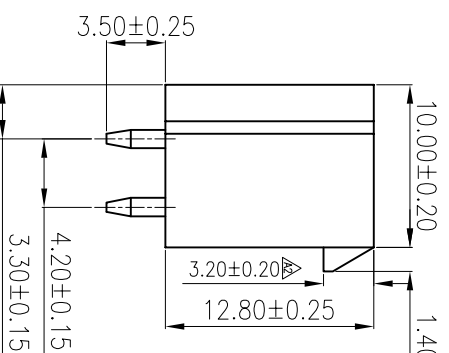
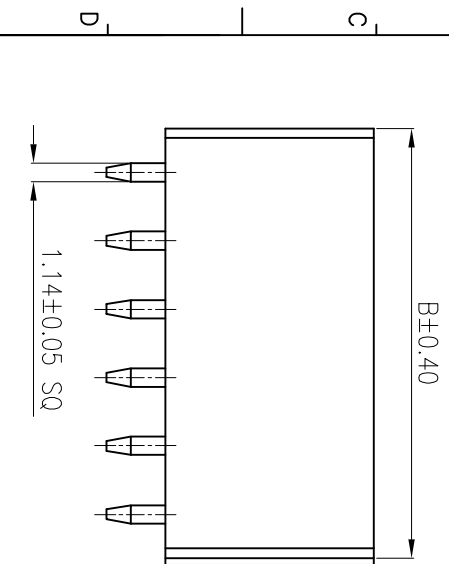
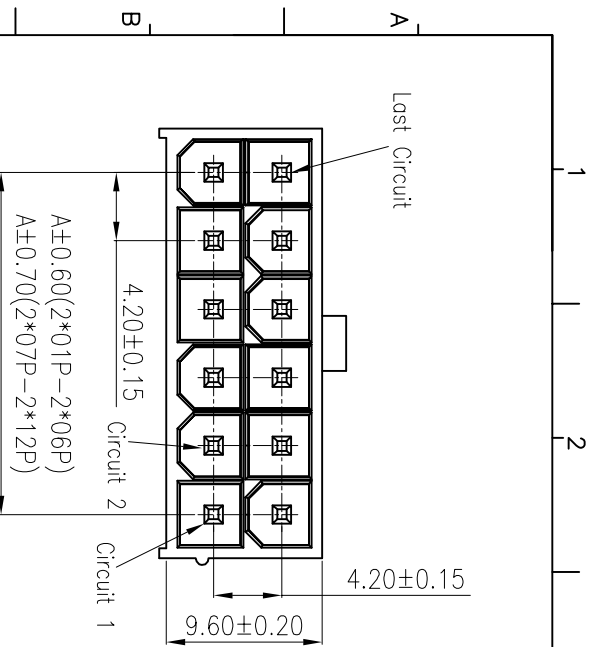

24	22	20	18	16	14	12	10	8	6	4	2
PA2412420130-127DMD	PA2212420130-127DMD	PA2012420130-127DMD	PA1812420130-127DMD	PA1612420130-127DMD	PA1412420130-127DMD	PA1212420130-127DMD	PA1012420130-127DMD	PA0812420130-127DMD	PA0612420130-127DMD	PA0412420130-127DMD	PA0212420130-127DMD
46.20	42.00	37.80	33.60	29.40	25.20	21.00	16.80	12.60	8.40	4.20	/
52.20	47.80	43.50	39.40	35.20	31.00	26.75	22.45	18.20	14.00	9.80	5.60
Circuits		Part No.		A		B		Dimension(mm)			

Ordering Information

P A XX 12 420 130-127 D M D
P: Pin Header Series
A: Finished Product
No. of PINS:
Plating Number:
420 Pitch 4.20mm
130: Height 13.0mm

S: SMT TYPE
D: DIP TYPE
M: Male(排针)
F: Female(排母)
S: Single(单排)
D: Double(双排)
Running number



Dongguan D-CHAIN Precision Components Co., Ltd

MEASURE POINT:	QUADRANT POINT	TANGENCY POINT	INTERSECTION POINT
X	Xx	Xxx	ANSULAR
±0.25	±0.20	±0.15	±5

UNLESS OTHERWISE SPECIFIED, TOLERANCE:	DRAWN	DATE	TITLE:
X	LU	2019.06.17	PITCH: 4.20mm H: 13.0mm DIP TYPE
Xx			
Xxx			
ANSULAR			

APPROVED	DATE	REV	SCALE	UNIT
		A2	1:1	mm
		A4	1/1	

X-ON Electronics

Largest Supplier of Electrical and Electronic Components

Click to view similar products for [Headers & Wire Housings](#) category:

Click to view products by [D-CHAIN](#) manufacturer:

Other Similar products are found below :

[0015917161](#) [0022155065](#) [57102-F02-18ULF](#) [58102-G61-06LF](#) [582553-1](#) [01.001.5753.1](#) [0050291907](#) [02.125.8002.8](#) [609-3404](#) [61062-3](#)
[CSU011177004](#) [622-0430](#) [622-3653LF](#) [63453-116](#) [636-1030](#) [636-1427](#) [636-3427](#) [636-4007](#) [641938-9](#) [65495-038](#) [65692-001LF](#) [65781-018](#)
[65781-047](#) [65817-010LF](#) [65817-015LF](#) [67095-007LF](#) [67601157](#) [68631-112](#) [699319-000](#) [70.362.1628.0](#) [70-4210](#) [70-4226B](#) [70-4853B](#) [707-](#)
[5028](#) [71.350.2428.0](#) [733-134](#) [733-162](#) [760-3052](#) [MHR-64-VUAL](#) [80.063.4001.1](#) [800-90-001-10-001000](#) [801-43-002-10-013000](#)
[801-43-006-10-002000](#) [803-43-024-10-001000](#) [803-93-012-10-001000](#) [8-1437020-4](#) [819-22-004-30-001101](#) [820-22-006-30-001101](#)
[820-22-008-30-001101](#) [821-22-002-10-001101](#)