





惠州市德立电子有限公司

HUI ZHOU DE LI ELECTRONICS CO., LTD

CUSTOMER:		REV NO:	A1.0
DESCRIPTION:	COMMON MODE CHOKE	PAGE NO:	PAGE 1 OF 6
PART NO:	WBA1812D系列	SN.	
CUSTOMER NO:		DATE:	2021年8月10日

# CATALOG

Resume	.....	P2
Shape & Dimension	.....	P3
Characteristic	.....	P3
Part numbering ststem	.....	P3
General specification	.....	P3
Electrical Characteristics List	.....	P4
Soldering Conditions	.....	P5
Package Information	.....	P6





惠州市德立电子有限公司

HUI ZHOU DE LI ELECTRONICS CO., LTD

CUSTOMER:		REV NO:	A1.0
DESCRIPTION:	COMMON MODE CHOKE	PAGE NO:	PAGE 3 OF 6
PART NO:	WBA1812D系列	SN.	
CUSTOMER NO:		DATE:	2021年8月10日

### 1. SHAPE & DIMENSION

UNIT:mm

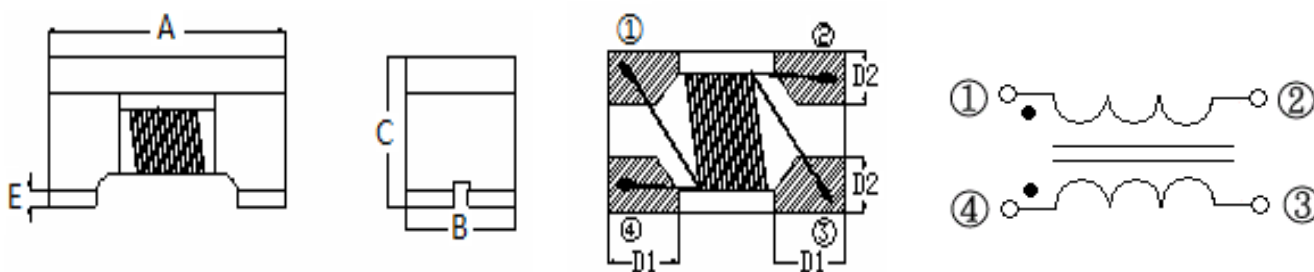

CODE	A	B	C	D1	D2	E
DIMENSION	4.50±0.20	3.20±0.20	2.80±0.2	1.00 Typ.	1.20Typ.	0.50Typ.

### 2. PART NUMBERING SYSTEM

WBA □□□□ □ □□□ □ □ — □□  
 1 2 3 4 5 6 7

- 1 PRODUCT SYMBOL (产品代号)
- 2 DIMENSIONS (规格尺寸)
- 3 MATERIAL CODE (材料代号)
- 4 IMPEDANCE (阻抗)
- 5 TOLERANCE (公差) : P±25%; N±30%
- 6 PACKAGING (包装方式) : T-编带盘装; B -散装
- 7 E.P. (环保) : LF—Lead Free HF—Halogen Free FP—Red Phosphor Free

### 3. GENERAL SPECIFICATION

a. Storage temp.: -10°C~+40°C, R.H.: 30% ~ 70%, Operating temp.: -40°C ~ +125°C.

APPROVED BY	CHECKED BY	DRAFT
陈启善	黄志伟	胡俊平



惠州市德立电子有限公司

HUI ZHOU DE LI ELECTRONICS CO., LTD

CUSTOMER:		REV NO:	A1.0
DESCRIPTION:	COMMON MODE CHOKE	PAGE NO:	PAGE 4 OF 6
PART NO:	WBA1812D系列	SN.	
CUSTOMER NO:		DATE:	2021年8月10日

**4. Electrical Characteristics List**

NO.	Part Number	Z	Freq	Rdc	Idc	Rated Voltge	Insulation Resistance
		(Ω)	(MHz)	(Ω)Max	(mA)Max	Volts	(MΩ) Min
1	WBA1812D800PT-G-HF	80	100	0.05	3000	50	10
2	WBA1812D900PT-J-HF	90	100	0.085	3000	50	10
3	WBA1812D121PT-J-HF	120	100	0.1	3000	50	10
4	WBA1812D161PT-G-HF	160	100	0.085	1500	50	10
5	WBA1812D201PT-G-HF	200	100	0.1	1500	50	10
6	WBA1812D221PT-J-HF	220	100	0.1	1300	50	10
7	WBA1812D331PT-G-HF	330	100	0.11	1100	50	10
8	WBA1812D501PT-G-HF	500	100	0.12	1000	50	10
9	WBA1812D601PT-J-HF	600	100	0.12	1000	50	10
10	WBA1812D701PT-G-HF	700	100	0.12	1000	50	10
11	WBA1812D801PT-G-HF	800	100	0.16	900	50	10
12	WBA1812D102PT-G-HF	1000	100	0.18	800	50	10
13	WBA1812D142PT-G-HF	1400	100	0.2	700	50	10
14							
15							
16							
17							
18							
19							
20							
21							
22							

APPROVED BY	CHECKED BY	DRAFT
陈启善	黄志伟	胡俊平



CUSTOMER:		REV NO:	A1.0
DESCRIPTION:	COMMON MODE CHOKE	PAGE NO:	PAGE 5 OF 6
PART NO:	WBA1812D系列	SN.	
CUSTOMER NO:		DATE:	2021年8月10日

**5. SOLDERING CONDITIONS**

**Figure 1. Re-flow Soldering (Lead Free)**

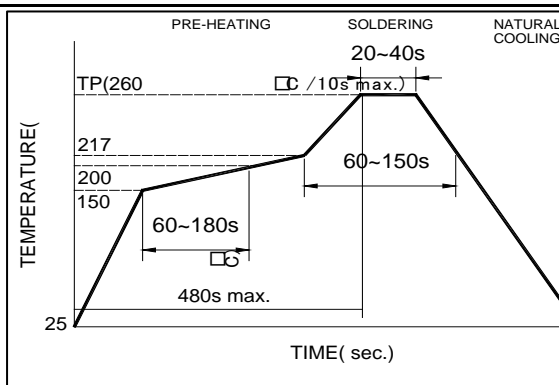

Note:

- Preheat circuit and products to 150°C
- 260°C tip temperature (max)
- Reflow times: no more than 2 times
- Solder paste thickness: the best 0.08mm is ,but max is 0.1mm

**Figure 2. Wave Soldering**

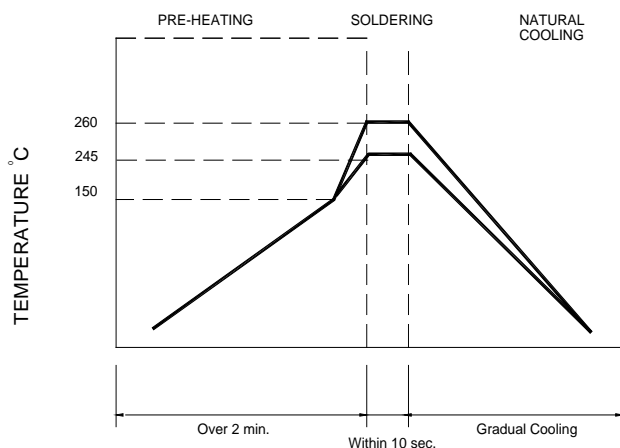

Note :

- Never contact the ceramic with the iron tip
- 1.0mm tip diameter (max)

**Figure 3. Hand Soldering**

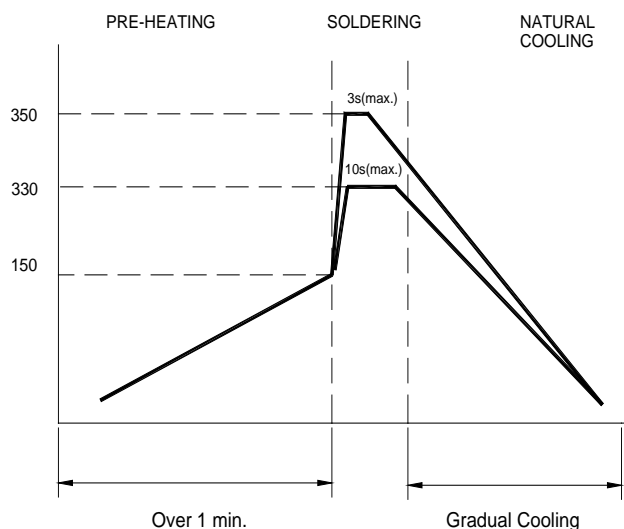

Note:

- Use a 20 watt soldering iron with tip diameter of 1.0mm
- Limit soldering time to 3 sec.

APPROVED BY	CHECKED BY	DRAWN BY
陈启善	黄志伟	胡俊平



惠州市德立电子有限公司

HUI ZHOU DE LI ELECTRONICS CO., LTD

CUSTOMER:		REV NO:	A1.0
DESCRIPTION:	COMMON MODE CHOKE	PAGE NO:	PAGE 6 OF 6
PART NO:	WBA1812D系列	SN.	
CUSTOMER NO:		DATE:	2021年8月10日

**6. PACKAGING(unit: mm)**

Type	1812
Quantity	500

**TAPING DRAWINGS**

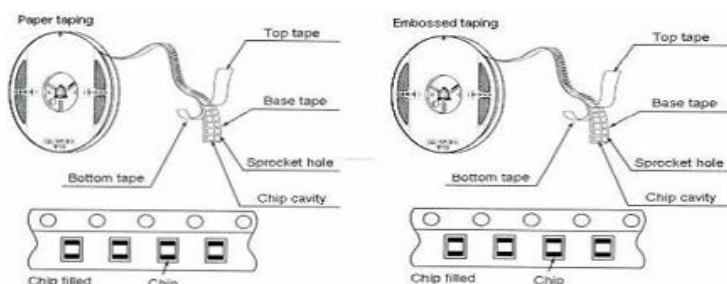

**REEL DIMENSIONS(UNIT:mm)**

	A	B	C	N	G
CF-12	178±2.0	22±2.0	12.5±1.5	98±2.0	12

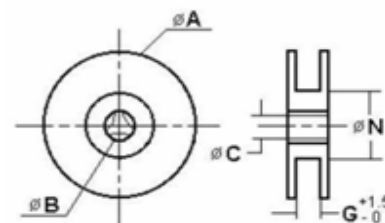

**LEADER AND BLANK PORTION**

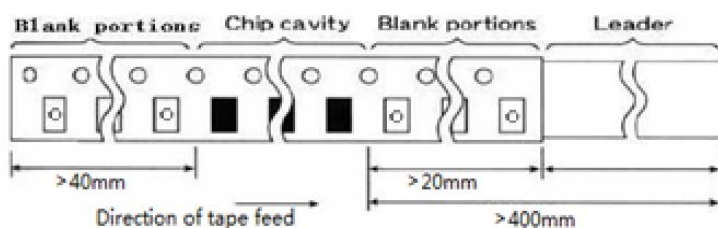

**PEELLING OFF FORCE:0.05 to 0.7N in the direction show below.**

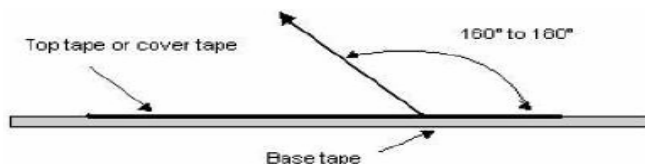

注意:

此物料不涉及汽车或相关产品方面的应用，否则，由此引起的一切品质和责任问题，我司将概不承担。

APPROVED BY	CHECKED BY	DRAFT
陈启善	黄志伟	胡俊平

## X-ON Electronics

Largest Supplier of Electrical and Electronic Components

*Click to view similar products for [Common Mode Chokes / Filters](#) category:*

*Click to view products by [DDY](#) manufacturer:*

Other Similar products are found below :

[PE-64683](#) [RD5122-6-9M6](#) [RD6137-6-7M5](#) [RD8147-16-3M0](#) [ST6118T-R](#) [FE3X025-10-7NL](#) [RD7147-25-0M7](#) [TCM0806G-350-2P-T](#)  
[TCM0806G-650-2P-T](#) [IND-0110](#) [UAL21VR0802000](#) [UALSC023000000](#) [UALSC1020JH000](#) [UALSU10VD20010](#) [UALSU9VD070100](#) [36-00037](#) [UALW21HS072450](#) [UALSU9H0208000](#) [UAL24VK06450CH](#) [PLT10HH501100PNB](#) [PLT10HH401100PNB](#) [PLT10HH1026R0PNB](#)  
[36-00029-01](#) [PE-67531](#) [TLH10UB](#) [113 0R5](#) [2752045447](#) [7351V](#) [CMF16-153131](#) [RD7147-6-6M0](#) [T8116NLT](#) [FE2X10-4-2NL](#) [36-00029-07](#)  
[T8003NLT](#) [CTX01-13663](#) [CTX66-19521-R](#) [RC212-0.5-10M](#) [RC112-0.4-15M](#) [RC212-0.6-6M8](#) [RC212-0.4-15M](#) [RC112-0.3-30M](#)  
[WTCF2012Z0M751PB](#) [PH9408.814NLT](#) [PAC6006.364NLT](#) [PAC6006.444NLT](#) [PAC6006.204NLT](#) [PH9407.204NLT](#) [PAC6006.264NLT](#)  
[PH9408.105NLT](#) [PH9408.494NLT](#) [PAC6006.104NLT](#)