



惠州市德立电子有限公司

HUI ZHOU DE LI ELECTRONICS CO., LTD

| | | | |
|--------------|-------------------|----------|-------------|
| CUSTOMER: | | REV NO: | A1.0 |
| DESCRIPTION: | COMMON MODE CHOKE | PAGE NO: | PAGE 1 OF 6 |
| PART NO: | WBA1812D系列 | SN. | |
| CUSTOMER NO: | | DATE: | 2021年8月10日 |

CATALOG

| | | |
|---------------------------------|-------|----|
| Resume | | P2 |
| Shape & Dimension | | P3 |
| Characteristic | | P3 |
| Part numbering ststem | | P3 |
| General specification | | P3 |
| Electrical Characteristics List | | P4 |
| Soldering Conditions | | P5 |
| Package Information | | P6 |



惠州市德立电子有限公司

HUI ZHOU DE LI ELECTRONICS CO., LTD

| | | | |
|--------------|-------------------|----------|-------------|
| CUSTOMER: | | REV NO: | A1.0 |
| DESCRIPTION: | COMMON MODE CHOKE | PAGE NO: | PAGE 3 OF 6 |
| PART NO: | WBA1812D系列 | SN. | |
| CUSTOMER NO: | | DATE: | 2021年8月10日 |

1. SHAPE & DIMENSION

UNIT:mm

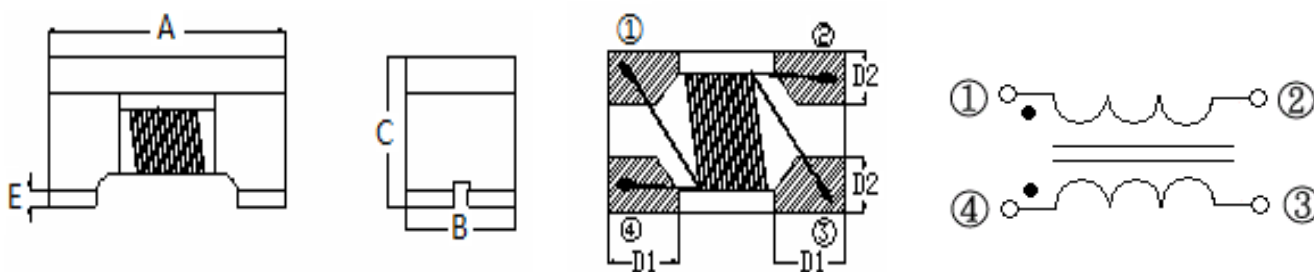

| CODE | A | B | C | D1 | D2 | E |
|-----------|-----------|-----------|----------|-----------|----------|----------|
| DIMENSION | 4.50±0.20 | 3.20±0.20 | 2.80±0.2 | 1.00 Typ. | 1.20Typ. | 0.50Typ. |
| | | | | | | |

2. PART NUMBERING SYSTEM

WBA □□□□ □ □□□ □ □ — □□
 1 2 3 4 5 6 7

- 1 PRODUCT SYMBOL (产品代号)
- 2 DIMENSIONS (规格尺寸)
- 3 MATERIAL CODE (材料代号)
- 4 IMPEDANCE (阻抗)
- 5 TOLERANCE (公差) : P±25%; N±30%
- 6 PACKAGING (包装方式) : T-编带盘装; B -散装
- 7 E.P. (环保) : LF—Lead Free HF—Halogen Free FP—Red Phosphor Free

3. GENERAL SPECIFICATION

a. Storage temp.: -10°C~+40°C, R.H.: 30% ~ 70%, Operating temp.: -40°C ~ +125°C.

| | | |
|-------------|------------|-------|
| APPROVED BY | CHECKED BY | DRAFT |
| 陈启善 | 黄志伟 | 胡俊平 |



惠州市德立电子有限公司

HUI ZHOU DE LI ELECTRONICS CO., LTD

| | | | |
|--------------|-------------------|----------|-------------|
| CUSTOMER: | | REV NO: | A1.0 |
| DESCRIPTION: | COMMON MODE CHOKE | PAGE NO: | PAGE 4 OF 6 |
| PART NO: | WBA1812D系列 | SN. | |
| CUSTOMER NO: | | DATE: | 2021年8月10日 |

4. Electrical Characteristics List

| NO. | Part Number | Z | Freq | Rdc | Idc | Rated Voltge | Insulation Resistance |
|-----|--------------------|------|-------|--------|---------|--------------|-----------------------|
| | | (Ω) | (MHz) | (Ω)Max | (mA)Max | Volts | (MΩ) Min |
| 1 | WBA1812D800PT-G-HF | 80 | 100 | 0.05 | 3000 | 50 | 10 |
| 2 | WBA1812D900PT-J-HF | 90 | 100 | 0.085 | 3000 | 50 | 10 |
| 3 | WBA1812D121PT-J-HF | 120 | 100 | 0.1 | 3000 | 50 | 10 |
| 4 | WBA1812D161PT-G-HF | 160 | 100 | 0.085 | 1500 | 50 | 10 |
| 5 | WBA1812D201PT-G-HF | 200 | 100 | 0.1 | 1500 | 50 | 10 |
| 6 | WBA1812D221PT-J-HF | 220 | 100 | 0.1 | 1300 | 50 | 10 |
| 7 | WBA1812D331PT-G-HF | 330 | 100 | 0.11 | 1100 | 50 | 10 |
| 8 | WBA1812D501PT-G-HF | 500 | 100 | 0.12 | 1000 | 50 | 10 |
| 9 | WBA1812D601PT-J-HF | 600 | 100 | 0.12 | 1000 | 50 | 10 |
| 10 | WBA1812D701PT-G-HF | 700 | 100 | 0.12 | 1000 | 50 | 10 |
| 11 | WBA1812D801PT-G-HF | 800 | 100 | 0.16 | 900 | 50 | 10 |
| 12 | WBA1812D102PT-G-HF | 1000 | 100 | 0.18 | 800 | 50 | 10 |
| 13 | WBA1812D142PT-G-HF | 1400 | 100 | 0.2 | 700 | 50 | 10 |
| 14 | | | | | | | |
| 15 | | | | | | | |
| 16 | | | | | | | |
| 17 | | | | | | | |
| 18 | | | | | | | |
| 19 | | | | | | | |
| 20 | | | | | | | |
| 21 | | | | | | | |
| 22 | | | | | | | |

| | | |
|-------------|------------|-------|
| APPROVED BY | CHECKED BY | DRAFT |
| 陈启善 | 黄志伟 | 胡俊平 |



| | | | |
|--------------|-------------------|----------|-------------|
| CUSTOMER: | | REV NO: | A1.0 |
| DESCRIPTION: | COMMON MODE CHOKE | PAGE NO: | PAGE 5 OF 6 |
| PART NO: | WBA1812D系列 | SN. | |
| CUSTOMER NO: | | DATE: | 2021年8月10日 |

5. SOLDERING CONDITIONS

Figure 1. Re-flow Soldering (Lead Free)

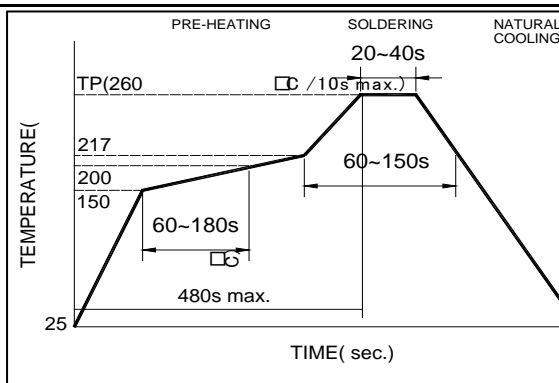

Note:

- Preheat circuit and products to 150°C
- 260°C tip temperature (max)
- Reflow times: no more than 2 times
- Solder paste thickness: the best 0.08mm is ,but max is 0.1mm

Figure 2. Wave Soldering

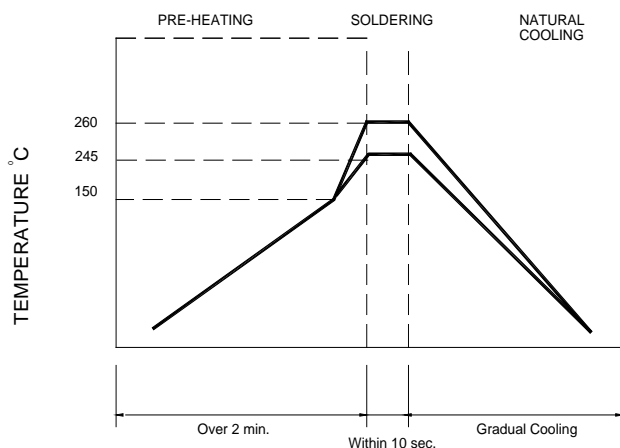

Note :

- Never contact the ceramic with the iron tip
- 1.0mm tip diameter (max)

Figure 3. Hand Soldering

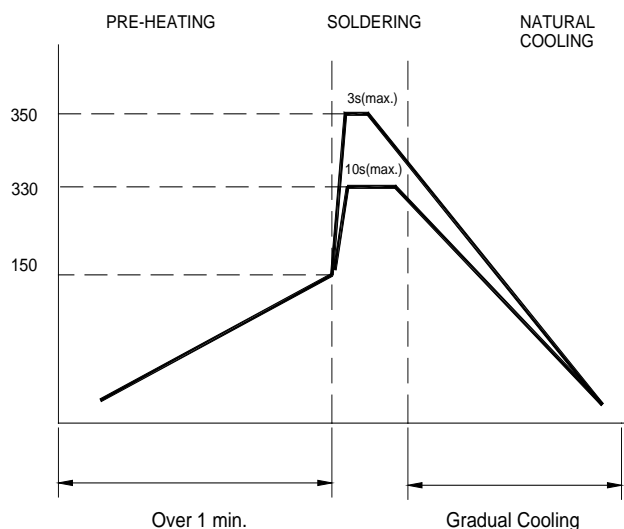

Note:

- Use a 20 watt soldering iron with tip diameter of 1.0mm
- Limit soldering time to 3 sec.

| | | |
|-------------|------------|----------|
| APPROVED BY | CHECKED BY | DRAWN BY |
| 陈启善 | 黄志伟 | 胡俊平 |



惠州市德立电子有限公司

HUI ZHOU DE LI ELECTRONICS CO., LTD

| | | | |
|--------------|-------------------|----------|-------------|
| CUSTOMER: | | REV NO: | A1.0 |
| DESCRIPTION: | COMMON MODE CHOKE | PAGE NO: | PAGE 6 OF 6 |
| PART NO: | WBA1812D系列 | SN. | |
| CUSTOMER NO: | | DATE: | 2021年8月10日 |

6. PACKAGING(unit: mm)

| | |
|----------|------|
| Type | 1812 |
| Quantity | 500 |

TAPING DRAWINGS

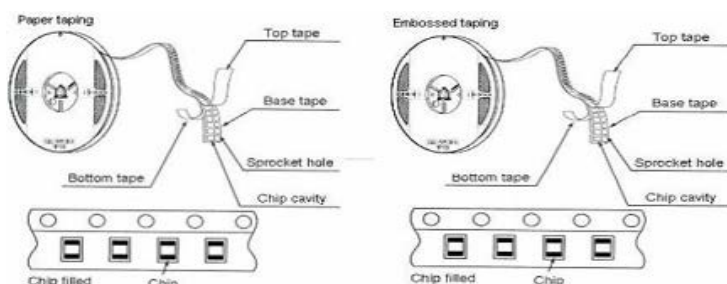

REEL DIMENSIONS(UNIT:mm)

| | A | B | C | N | G |
|-------|---------|--------|----------|--------|----|
| CF-12 | 178±2.0 | 22±2.0 | 12.5±1.5 | 98±2.0 | 12 |
| | | | | | |

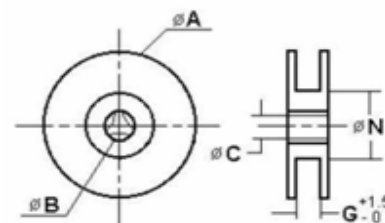

LEADER AND BLANK PORTION

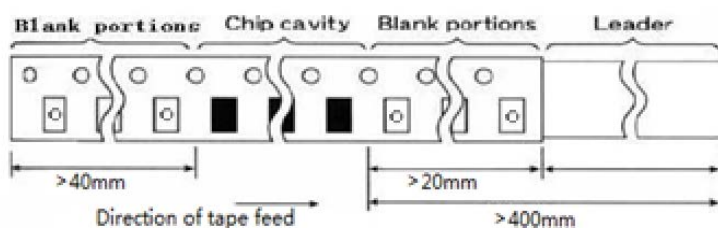

PEELLING OFF FORCE:0.05 to 0.7N in the direction show below.

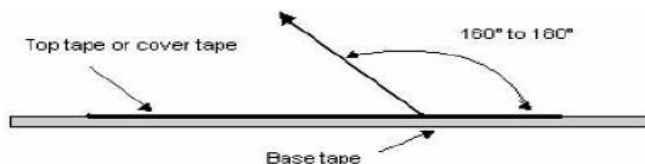

注意:

此物料不涉及汽车或相关产品方面的应用，否则，由此引起的一切品质和责任问题，我司将概不承担。

| | | |
|-------------|------------|-------|
| APPROVED BY | CHECKED BY | DRAFT |
| 陈启善 | 黄志伟 | 胡俊平 |

X-ON Electronics

Largest Supplier of Electrical and Electronic Components

Click to view similar products for [Common Mode Chokes / Filters](#) category:

Click to view products by [DDY](#) manufacturer:

Other Similar products are found below :

[PE-64683](#) [RD5122-6-9M6](#) [RD6137-6-7M5](#) [RD8147-16-3M0](#) [ST6118T-R](#) [FE3X025-10-7NL](#) [RD7147-25-0M7](#) [TCM0806G-350-2P-T](#)
[TCM0806G-650-2P-T](#) [IND-0110](#) [UAL21VR0802000](#) [UALSC023000000](#) [UALSC1020JH000](#) [UALSU10VD20010](#) [UALSU9VD070100](#) [36-00037](#) [UALW21HS072450](#) [UALSU9H0208000](#) [UAL24VK06450CH](#) [PLT10HH501100PNB](#) [PLT10HH401100PNB](#) [PLT10HH1026R0PNB](#)
[36-00029-01](#) [PE-67531](#) [TLH10UB](#) [113 0R5](#) [2752045447](#) [7351V](#) [CMF16-153131](#) [RD7147-6-6M0](#) [T8116NLT](#) [FE2X10-4-2NL](#) [36-00029-07](#)
[T8003NLT](#) [CTX01-13663](#) [CTX66-19521-R](#) [RC212-0.5-10M](#) [RC112-0.4-15M](#) [RC212-0.6-6M8](#) [RC212-0.4-15M](#) [RC112-0.3-30M](#)
[WTCF2012Z0M751PB](#) [PH9408.814NLT](#) [PAC6006.364NLT](#) [PAC6006.444NLT](#) [PAC6006.204NLT](#) [PH9407.204NLT](#) [PAC6006.264NLT](#)
[PH9408.105NLT](#) [PH9408.494NLT](#) [PAC6006.104NLT](#)